

Vertical Contact Toaster

Model: VCT-1000

Options: Butter Wheel,
Bun Feeder



VCT-1000

The Vertical Contact Toaster, Model VCT-1000, is designed for contact toasting of buns.

The toaster design allows the operator to place buns on both sides of the heated platen at the same time. Buns are placed into the top of the toaster and uniform, golden brown, warm buns are then retrieved at the bottom of the toaster.

Features:

- Produces Toasted Buns in Ten Seconds
- Bun Components, Heel, Crown, and Club Sections are Toasted with One Setting.
- Easy to Adjust Dial Thermostat
- Space Saving Vertical Design
- Continuously Moving Conveyor Allows For Immediate Toasting

Dimensions

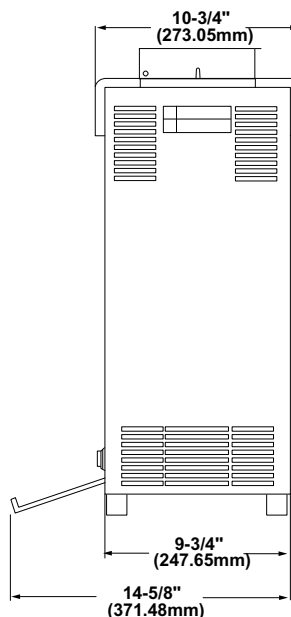
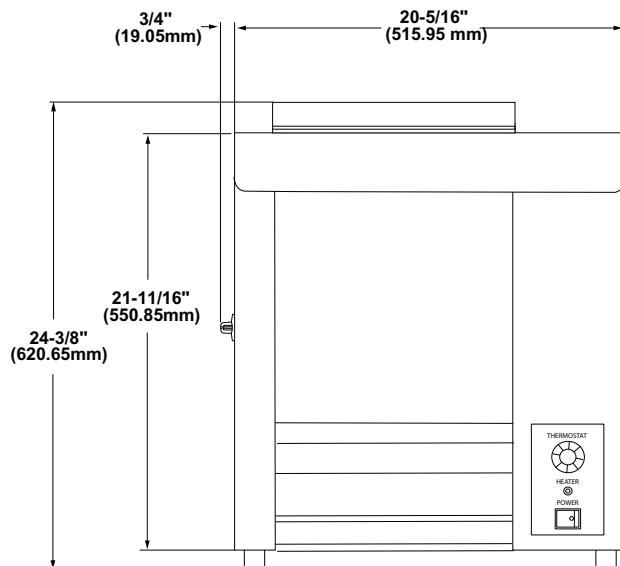

Accessories

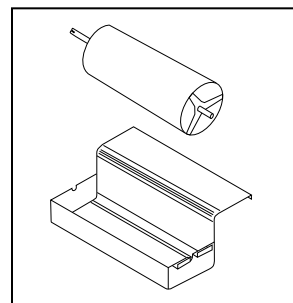

Butter Wheel
BW-1 7000238



Bun Feeder
BF-1 7000236

Electrical Cord & Plug Configurations

| Letter Code* | Description | Configuration |
|--------------|-----------------------------------|---------------|
| V | NEMA 6-20P 20 Amp, 250 VAC | |
| F | NEMA 5-15P 15 Amp, 120 VAC | |
| T | NEMA 5-20P 20 Amp, 120 VAC | |
| C | CEE 7/7 Schuko 16 Amp, 250 VAC | |
| I | IEC-309 16 Amp, 250 VAC | |
| H | Harmonized Cord | |
| C | Commercial Cord | |

* Used in Model Designation

*Electrical Ratings (All Models)

| Model | Manufacturing No. | VAC | Watts | Amp | Hz |
|--------------|-------------------|-----|-------|------|----|
| VCT-1000CF | 9210700 | 120 | 1800 | 15.0 | 60 |
| **with belts | 9210706 | | | | |
| VCT-1000CV | 9210702 | 208 | 2600 | 12.5 | 60 |
| with belts | 9210708 | | | | |
| VCT-1000HI | 9210704 | 230 | 1900 | 8.6 | 50 |
| with belts | 9210710 | | | | |

*Suffix indicates plug and cord combination.

**Optional belt wraps reduce chain marks on bun surfaces.