



## 500 OLD HAW CREEK ROAD

Haw Creek Brick Rancher on a Corner Lot



**MOSAIC**  
COMMUNITY LIFESTYLE REALTY

4 Bedrooms, 2 Bathrooms  
2,089 SF • 0.40 Acre  
MLS #4318510



## 500 OLD HAW CREEK ROAD ASHEVILLE, NC 28805

4 Bedrooms, 2 Bathrooms  
2,089 SF · 0.40 Acre  
MLS #4318510

### FEATURES

**Hardwood floors** throughout bedrooms and main living areas

**Large windows** and **wonderful natural light**

**Living room has gas logs** (can connect propane or natural gas)

Den has **wood-burning stove** insert

**Dining area** and **breakfast nook**

Vintage, **original retro kitchen** adds charm

**Jack-and-Jill-style primary suite** provides options for office, nursery, or guest room

**Lower-level garage** has **ductwork and vents in place** to easily add 865 SF of conditioned space

**Attic space** and **two-car garage** provide additional storage options

Thoughtfully **updated baths**

HVAC includes **heat pump and back-up furnace**

**Year-round mountain views** off front porch **AND** back deck

Front porch **views of Blue Ridge Parkway!**

**Rare corner lot** in Haw Creek with plenty of space for garden, pets, and play

**Walkable neighborhood**—under 10 minutes to downtown, Trader Joe's, Target, Whole Foods, and the Blue Ridge Parkway

**Easy access to the Mountains-to-Sea Trail** from Master's Park just half a mile away



Neighborhood includes **PennyCup Coffee, Rendezvous French Restaurant, The Whale Outpost, Creekside Taphouse, and East Asheville Rec Pool**

**Guest bath updates** include new **vanity, sinks, and mirrors** in 2025 and new **shower insert, tile, and toilet** in 2009

**Primary bath updates** include new **vanity, sink and toilet** in 2012

**New interior paint** throughout in 2025

**New interior solid-core doors** in 2025

**New roof** in 2023

**New sewer line** from house to main in 2025

**New attic insulation** in 2024

**New front and back exterior doors and storm doors** in 2022

**New concrete driveway** in 2022

**New front walk, steps, and railing** in 2022

**Lifetime warranty on crawlspace work, including sump pump and commercial grade dehumidifier** in 2013

**New composite back deck** in 2012—built to withhold addition off kitchen—includes **Sunsetter® awning**

Gutters include **gutter guards**

**New chimney liner for wood stove** in 2011

**Consistent semi-annual HVAC service** - last service was Oct 2025



**MOSAIC**  
COMMUNITY LIFESTYLE REALTY

46 Orchard Street, Suite 100, Asheville, NC 28801  
[WWW.MYMOSAICREALTY.COM](http://WWW.MYMOSAICREALTY.COM)





**500 OLD HAW CREEK ROAD**

Haw Creek Brick Rancher on a Corner Lot

Asheville, NC 28805





Anchored by year-round views of the Blue Ridge Parkway, this Haw Creek brick ranch sits on a rare 0.4-acre corner lot. With 4 bedrooms and 2 full baths, you'll appreciate the space this home provides. Larger windows bring wonderful natural light and gleaming hardwood floors are found throughout bedrooms and main living areas. Charming, original vintage-style kitchen with eat-in breakfast nook leads to spacious back patio with additional mountain views. Gathering areas include a living room with gas logs and a cozy, paneled den with woodstove insert. The Jack-and-Jill-style primary suite provides options for an office, nursery, or additional guest space. The two-car garage has additional storage space and in-place HVAC ducts/vents for an easy conversion to 865 SF of additional conditioned living space. Enjoy morning coffee and/or afternoon cocktails on the rocking chair front porch while taking in views of the surrounding mountains. Many recent updates including newer roof, windows, interior/exterior doors, interior paint, guest bath vanity/sinks, concrete driveway, main sewer line, front brick walkway, and attic insulation. (Please see MLS for full list of updates.)

This property is less than 10 minutes to downtown Asheville, Trader Joe's, Target, Whole Foods, and the Blue Ridge Parkway. Access to the Mountains-to-Sea Trail from Master's Park, just half a mile away. This walkable neighborhood includes PennyCup Coffee, Rendezvous French Bistro, The Whale Outpost, Creekside Taphouse, and East Asheville Rec Pool. Haw Creek Elementary and Evergreen Charter School are just a mile away!



For more information, please contact:

**STEPHANIE CALDWELL**  
**828-231-6959**  
[STEPH@MYMOSAICREALTY.COM](mailto:STEPH@MYMOSAICREALTY.COM)

#### DIRECTIONS

FROM DOWNTOWN ASHEVILLE: Take I-240E. Use exit 7 to Tunnel Road. After half a mile, take a left onto Crockett Avenue and an immediate right onto New Haw Creek Road. Travel another half mile to the left on Trinity Chapel Road. After 0.4 mile, take a right at the end of the road onto Old Haw Creek Road. Go one mile; home is on the right.

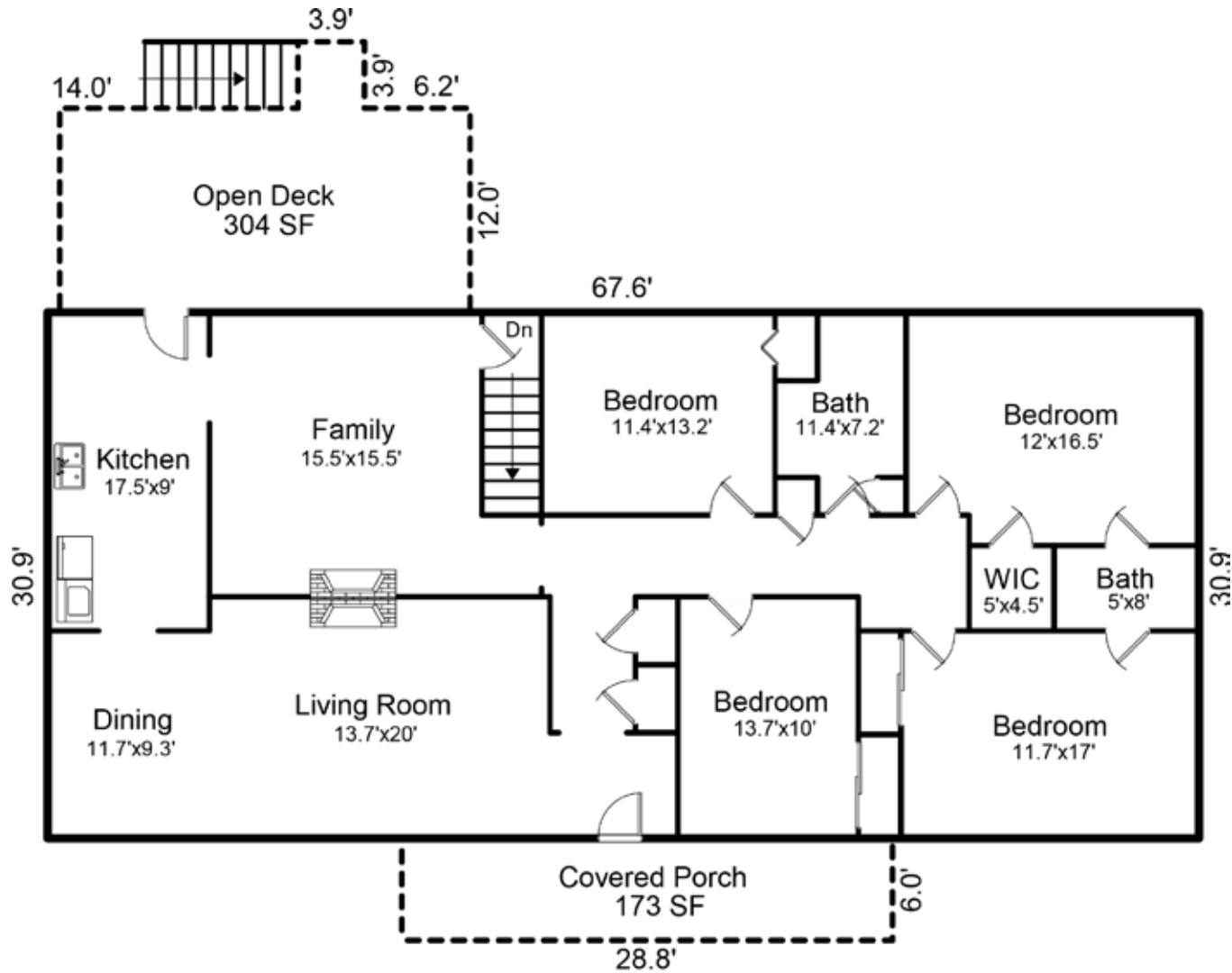

FLOOR PLAN