



MOSAIC
COMMUNITY LIFESTYLE
REALTY

WEST ASHEVILLE



88 NEVADA AVENUE | ASHEVILLE, NC 28806

88 NEVADA AVENUE
ASHEVILLE, NC 28806



WEST ASHEVILLE



LIVE THE BEST OF BOTH WORLDS

... in this rustic, custom-outfitted, Craftsman-style family homestead that sits on a large, sunny lot on a quiet, dead-end street in the heart of West Asheville, within walking distance to everything Haywood Road has to offer. With outstanding gardens, a custom chicken coop, and an inground trampoline, this is the perfect mini-farm where the kids can play while you tend to the garden and chickens. Completely redone in 2010 — including plumbing and electrical — the home now features a chef's kitchen with a Bertazzoni six-burner stove and other high-end appliances. There's a huge, shady front porch with custom stone work, an upstairs sleeping porch, and an expansive wraparound back deck that overlooks a spacious, flat, sunny, fully fenced backyard. A detached single-car garage and two driveways provide plenty of parking (garage could be converted to an ADU). Come see this classic WAVL beauty for yourself!

4 BEDS | 3 BATHS | 2,168 SF | 0.38 ACRES | MLS #4171056



LAURA MOYE
828-301-4518
LAURA@MYMOSAICREALTY.COM

88 NEVADA AVENUE ASHEVILLE, NC 28806



88 NEVADA AVENUE | ASHEVILLE, NC 28806
4 BEDS | 3 BATHS | 2,168 SF | 0.38 ACRES | MLS #4171056

FEATURES

- Fully renovated, rustic, Craftsman-style family homestead with copper gutters, custom windows and doors, Trex decking; kitchen cupboards, built-in kitchen nook, and bookshelves by Chris Bifaro Woodworks
- Large, flat, sunny lot, located on a quiet, dead-end street; walkable to everything Haywood Road/West Asheville
- Completely renovated in 2010 — everything was redone, including electrical and plumbing
- Living room has a vaulted ceiling, plus a custom stone gas fireplace
- Super-high-end kitchen for the master chef:
 - » Most of the appliances, all stainless steel, have never been used
 - » Bertazzoni six-burner gas stove; dual oven
 - » Miele warming drawer, built-in microwave
 - » Coffeeshop-quality espresso machine
 - » The espresso machine, warmer, steamer, and microwave are all wall units
 - » Gorgeous, soft-stone countertops
 - » Undermount Shaw's Original apron farm sink
 - » Spacious pantry
 - » Nook with bench seating and storage
- Kitchen opens to the covered wraparound deck that overlooks the flat, sunny backyard and gardens
- Large, private primary suite opens to back deck and overlooks backyard
- Custom “princess house” in upstairs in bedroom
- Daybed and custom built-in bookshelves
- Main level features three bedrooms, two full bathrooms, laundry and mudroom
- One bedroom and one full bathroom upstairs

FEATURES CONTINUE ON NEXT PAGE >



88 NEVADA AVENUE | ASHEVILLE, NC 28806

4 BEDS | 3 BATHS | 2,168 SF | 0.38 ACRES | MLS #4171056

FEATURES (CONTINUED FROM PREVIOUS PAGE)

- Loft area upstairs makes a perfect game room, second office, or second entertainment area; pre-plumbed for wet bar
- Enjoy quality finishes throughout the home:
 - » Gorgeous tile work
 - » Recessed lighting
 - » Custom ceiling fans
 - » Beautiful hardwood floors
 - » Custom windows and doors
- Full-house fan
- Full-house water purifier
- Large, shaded front porch with handmade stone pillars
- Huge wraparound deck in the back
- Large, wraparound, screened sleeping porch with custom hanging bed on second level
- Flat, sunny, fully fenced yard has a custom chicken coop with electric door, a stone fire pit, and an in-ground trampoline
- Custom treehouse matches the big house!
- Fenced-in garden
- Specimen trees in backyard are placed for privacy from neighbors
- Single-car detached garage; long, flat driveway and additional second driveway for off-street parking; garage could be converted to an ADU

DIRECTIONS

FROM DOWNTOWN ASHEVILLE: Take I-240 W to Haywood Road. Turn right at the end of the ramp and follow Haywood Road to the left at Nevada Avenue (at Itto Ramen Restaurant) to home on the left.



88 NEVADA AVENUE | ASHEVILLE, NC 28806
 4 BEDS | 3 BATHS | 2,168 SF | 0.38 ACRES | MLS #4171056

MAIN LEVEL

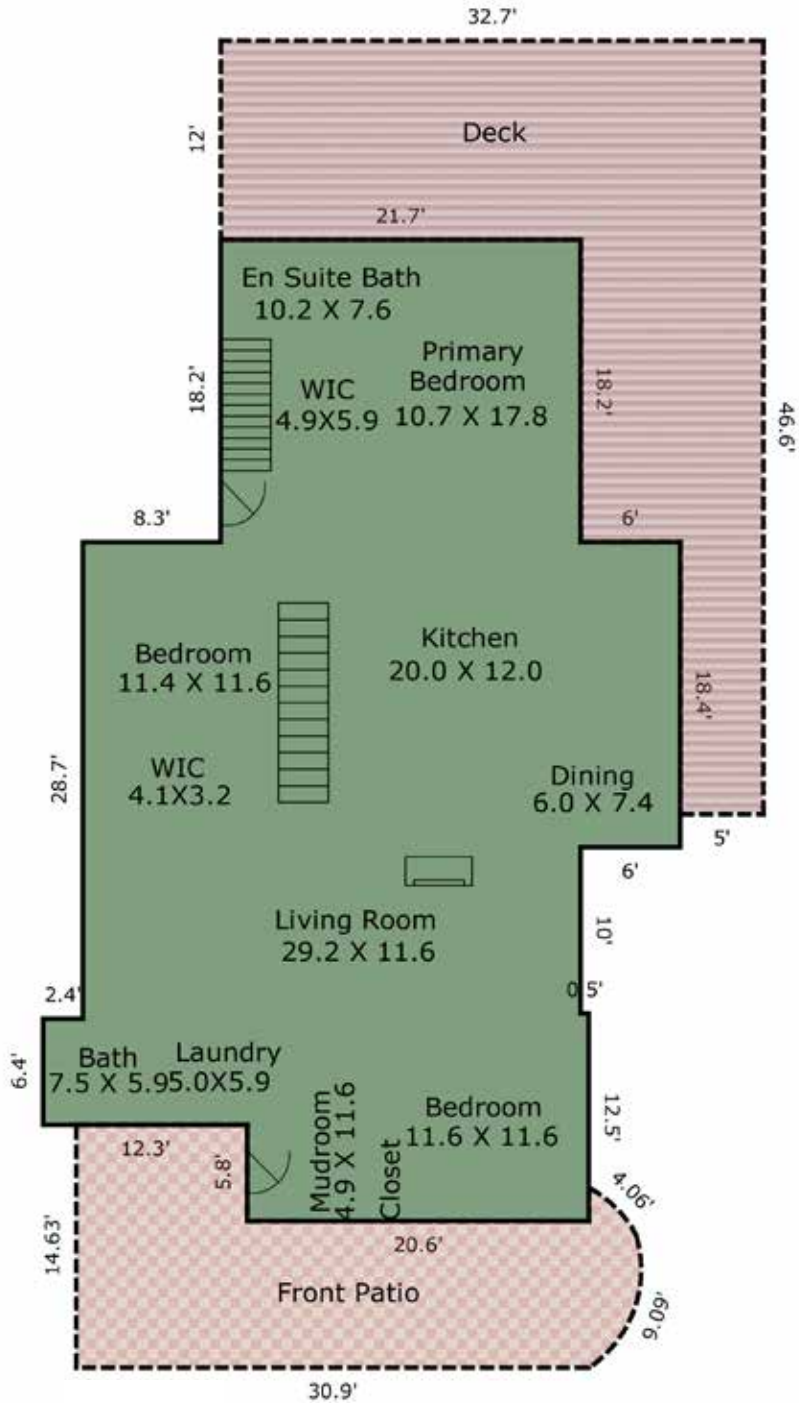

88 NEVADA AVENUE | ASHEVILLE, NC 28806
4 BEDS | 3 BATHS | 2,168 SF | 0.38 ACRES | MLS #4171056

UPPER LEVEL

