



**MOSAIC**  
COMMUNITY LIFESTYLE  
**REALTY**

**MONTFORD**



**178 MONTFORD AVENUE | ASHEVILLE, NC 28801**

178 MONTFORD AVENUE  
ASHEVILLE, NC 28801



MONTFORD



### OWN A PIECE OF ASHEVILLE'S HISTORY!

This beautifully renovated Montford showpiece is in the heart of downtown and one minute's walk from renowned restaurants Tall John and Nine Mile. Easy stroll to Montford Park for tennis or Shakespeare in the Park; under one mile to downtown Asheville. Enjoy the welcoming front porch and historic charm of the spacious foyer. All the rooms are generously sized and there are four renovated bathrooms, all in the classic designer style of the era. Great for entertaining, especially with the updated chef's-style kitchen, two covered porches, a huge backyard with a firepit, and a place for dining al fresco on the concrete patio. The eat-in kitchen has abundant maple cabinetry and lovely quartz countertops. Second level has three very large bedrooms including the primary suite with its walk-in closet and large primary bath. The gorgeous guest/hall bathroom has marble floors and a huge soaking tub. Enjoy the gorgeous sunset view from the sunroom—perfect as an office, art or yoga studio, or sleeping area. Third floor is an awesome hangout room and bedroom that's just right for an office or guest area. In addition to the amazing main levels, there is a 500+ SF super-sweet studio/bonus area (not contiguous) with a separate entrance. It has a spacious bathroom with new clawfoot tub. Must see this lovely home to appreciate its class and charm. RM8 zoning. Amazing Montford location!

4 BEDS | 4 BATHS | 3,164 SF | 0.25 ACRE | MLS #4349325

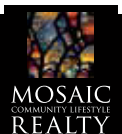

VANESSA BYRD  
828-275-8534  
VANESSA@MYMOSAICREALTY.COM

# 178 MONTFORD AVENUE ASHEVILLE, NC 28801



# 178 MONTFORD AVENUE | ASHEVILLE, NC 28801

4 BEDS | 4 BATHS | 3,164 SF | 0.25 ACRE | MLS #4349325

## FEATURES

- Beautifully renovated historical Montford home
- Just minutes from to downtown Asheville
- Walkable to neighborhood restaurants and parks
- Covered “rocking chair” front porch
- Inviting and enticing foyer area
- Spacious living room with original hardwood floors
- Home has so much historical character and charm
- Stunning chef’s kitchen with maple cabinetry, beautiful tile backsplash
- Sunroom is great for entertaining, yoga, or just reading a book
- Sunroom has a lovely sunset view and tons of natural light
- Laundry room on the main level with storage
- Second level has three bedrooms, including the primary suite
- Beautiful primary bath has a custom shower, a dual vanity and a walk-in closet
- A separate entrance to the finished basement makes it a perfect office or an additional sleeping space for guests
- Third floor bedroom has great hangout room would work great as office or playroom
- Two of the bathrooms have claw foot soaking tubs
- Original hardwood floors
- Fireplaces throughout are decorative/non-functional but could be converted to gas
- Basement studio has open floor plan and one bath
- Huge fenced in back yard with fire pit offers privacy
- Giant fenced level back yard with covered space
- Ample parking in driveway and on the street
- Relaxing outdoor living: Sunny deck, privacy fencing, a firepit area, and room for play or gardening
- RM8 zoning

## DRIVING DIRECTIONS

FROM DOWNTOWN ASHEVILLE: Take I-240 W to Exit 2/Haywood Street/Montford. Turn right on Montford Avenue—Number 178 will be on the left.



# 178 MONTFORD AVENUE | ASHEVILLE, NC 28801

4 BEDS | 4 BATHS | 3,164 SF | 0.25 ACRE | MLS #4349325

## MAIN LEVEL



# 178 MONTFORD AVENUE | ASHEVILLE, NC 28801

4 BEDS | 4 BATHS | 3,164 SF | 0.25 ACRE | MLS #4349325

## SECOND LEVEL



# 178 MONTFORD AVENUE | ASHEVILLE, NC 28801

4 BEDS | 4 BATHS | 3,164 SF | 0.25 ACRE | MLS #4349325

## BASEMENT LEVEL

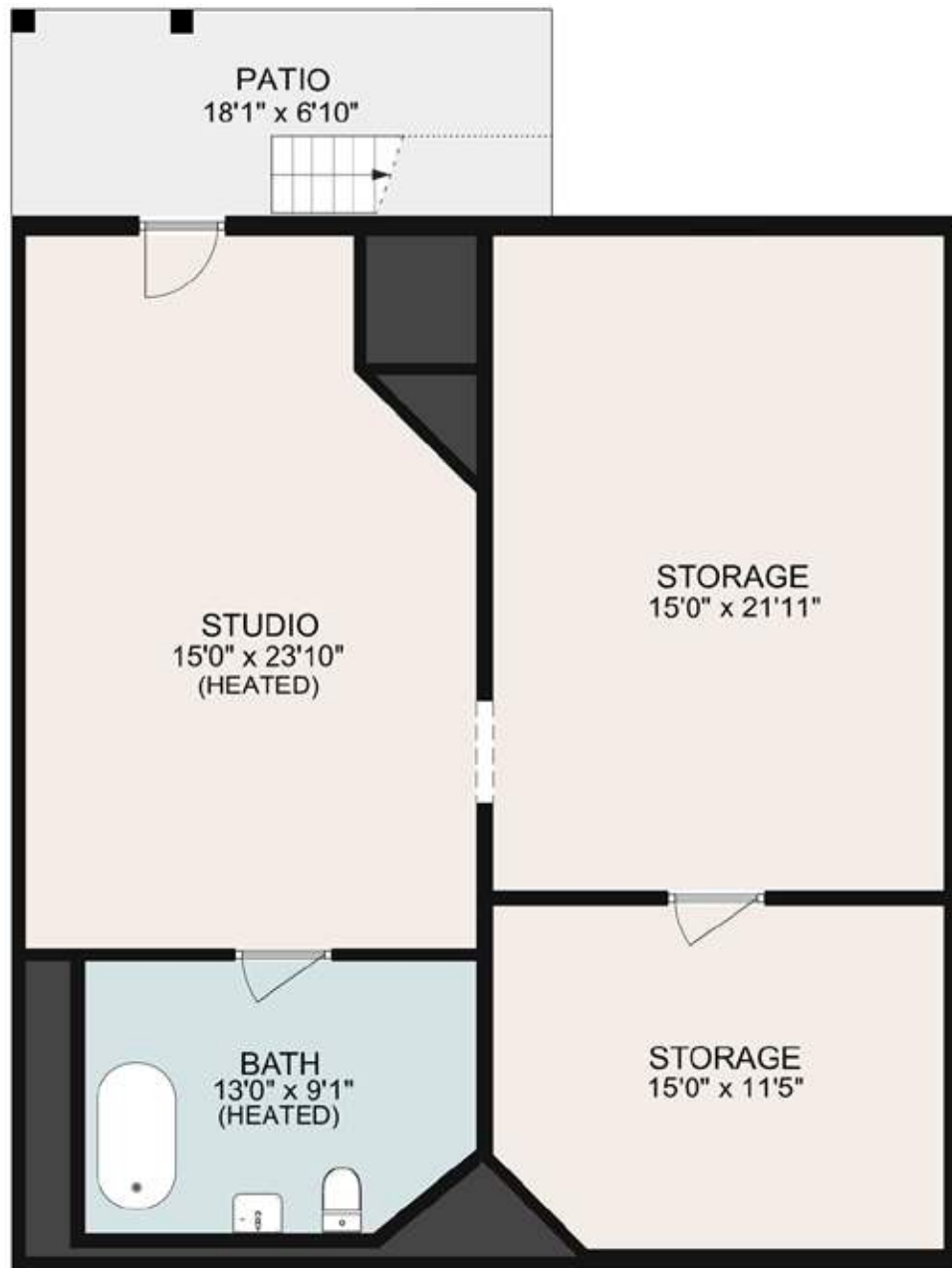

# 178 MONTFORD AVENUE | ASHEVILLE, NC 28801

4 BEDS | 4 BATHS | 3,164 SF | 0.25 ACRE | MLS #4349325

## ATTIC LEVEL

