

BEAUTIFULLY DESIGNED ONE-LEVEL LIVING IN THE VILLAGE OF COUNTRY CREEK



COMFORT, FUNCTIONALITY, AND THOUGHTFUL DETAILS THROUGHOUT

29 Hillcreek Drive, Asheville, NC 28804
3 Beds | 2.5 Baths | 2,302 SF | 0.46 Acre

Located in a vibrant neighborhood with access to a community pool and clubhouse as well as hiking/walking trails, this spacious home combines convenience, connection, and easy living. The open floor plan seamlessly connects the living and dining areas, creating an inviting space ideal for both everyday living and entertaining. Skylights throughout the home fill the interior with abundant natural light, enhancing the bright and welcoming atmosphere. The well-appointed kitchen features a breakfast nook, gas range, wall oven, dishwasher, and ample workspace for cooking and gathering. The expansive primary suite serves as a private retreat with a cozy gas fireplace, oversized dual walk-in closets, soaking tub, dual vanities, and a separate shower. A versatile third bedroom easily functions as a home office, complete with built-in bookshelves and dual pocket doors for added flexibility and privacy. Additional highlights include a two-car garage, backup generator, and generous storage throughout. Step outside to enjoy the expansive deck with a retractable cover overlooking the large, private backyard—an ideal setting for relaxing, entertaining, or taking in Asheville's beautiful seasons.

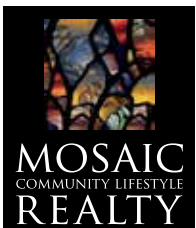

FOR MORE INFO:

CASEY CONNER
828-777-0583

CASEY@MYMOSAICREALTY.COM

29 HILLCREEK DRIVE | ASHEVILLE, NC 28804

3 BEDS | 2.5 BATHS | 2,302 SF | 0.46 ACRE

FLOOR PLAN

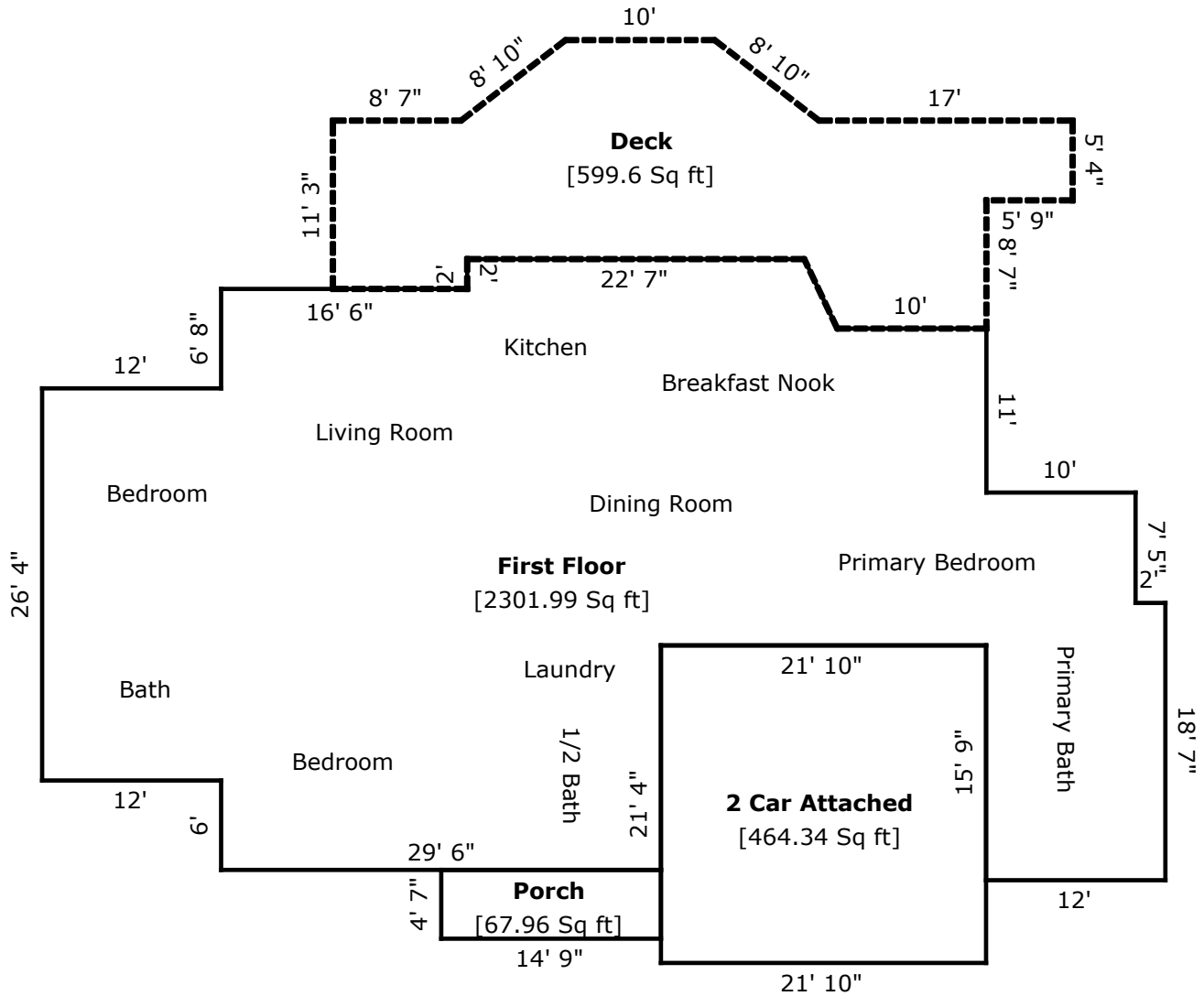

DRIVING DIRECTIONS

FROM DOWNTOWN ASHEVILLE: Take I-26 W to exit 21 for New Stock Road. Turn left onto New Stock Road. In 1.3 miles, turn left onto Hillcreek Drive. House is on the right.