

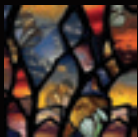

21 CRAIG CIRCLE

Expertly Renovated Quintessential 1920s Bungalow



MOSAIC
COMMUNITY LIFESTYLE REALTY

Main Home: 2 BD/2 BA | 1,365 SF
ADU: 1 BD/1 BA | 263 SF
0.13-Acre Lot | MLS #4359482



21 CRAIG CIRCLE ASHEVILLE, NC 28805

Main Home: 2 BD/2 BA | 1,365 SF
ADU: 1 BD/1 BA | 263 SF
0.13-Acre Lot | MLS #4359482

FEATURES

Quintessential 1920s bungalow with high-end finishes, located in a private pocket neighborhood of East Asheville; **close to the Blue Ridge Parkway and minutes from downtown Asheville**

Well-appointed and lovingly designed, this whimsical property invites you in and entices the senses with charm around every turn, nook, and cranny

Expert interior renovations by the current owner, a local craftsman and builder

Thoughtfully designed landscaping is bursting with springtime flora and includes a **backyard privacy fence**, substantial **perennial plantings**, wood crib and **small raised garden beds**, **stacked stone landscaping border**, **built-in grill station**, and **deck area with shade kite**

MAIN HOUSE

Seamless blend of period details and modern amenities—renovations include **heat pump installation**, **upgraded insulation**, **replacement of most windows**, and a **newer roof with half-round gutters**

Abundant natural light abounds with **two skylights** in the primary suite + **stairwell sun tunnel**

Gleaming oak floors throughout the main level + **great flow** through the home

Covered, Southern-style front porch with a **beadboard ceiling** and a **swinging bench**



Warm living room with **brick-surround**, **wood-burning fireplace insert**, **built-in display/entertainment shelves**, **crown molding**, and **wide trim**

Expanded, eat-in kitchen reflects the master craftsman's vision and features **exposed beam ceiling**, **walnut and quartz countertops**, **Fisher & Paykel paneled refrigerator** and **dish drawers**, an **induction cooktop** with **built-in wall oven below**, **full inset cabinets** with **built-in organization**, **soft-close drawers**, **display shelves**, and a **pantry closet** under the stairs

Large quartz-topped island with **Vigo farm-style sink**, lots of storage, and **breakfast bar** for casual meals

The **dining area** off the kitchen gets **great natural light**

Main-level bedroom with **crown molding** + **ample closet space**

Tastefully renovated full bath with a **solid-surface countertop**, **above-counter Duravit sink**, **tiled wall accent** + **half wall**, a **tiled shower + tub with sliding glass doors**, and **upgraded fixtures**



MAIN HOUSE (CONTINUED)

The **pass-through flex area** connects the living room and the kitchen

Mudroom area at rear entrance + **storage/laundry station** on main level

Spa-like primary suite features a **flat-top vault and nickel-gap shiplap ceiling, skylight**, large closet with **built-in organization + walk-through closet**, and an ensuite full bath that includes a granite-topped, solid wood vanity, and frosted glass enclosed tiled, walk-in shower with skylight

Thoughtful storage solutions throughout the home include a hall linen cabinet and attic storage areas

Basement with exterior access has great storage or workshop potential

Plenty of off-street parking includes an **added one-vehicle driveway** and a **stone parking pad in the backyard**

GUEST SUITE/ADU + DETACHED GARAGE

Multiple uses: Income-producing STR (permitted with the City of Asheville; buyer to confirm potential of obtaining a permit as the new owner), a **perfect guest suite** for family and friends, or a **home office/studio**

Bedroom suite with hardwood floors and crown molding

Renovated full bath that includes a sliding barn door, wall-mounted sink, tile half wall, and **tiled, walk-in shower**

Kitchenette with bar counter

Deck with pergola and fire pit; replaced decking and stairs to the guest entrance

Mini-split heat and air conditioning

A **garage with a convenient automatic door opener** is great for smaller vehicles, or tool + toy storage

Durable LP Smart/cedar shake siding + half-round gutter and rustic rain barrel





MOSAIC
COMMUNITY LIFESTYLE REALTY

46 Orchard Street, Suite 100, Asheville, NC 28801
WWW.MYMOSAICREALTY.COM





MOSAIC
COMMUNITY LIFESTYLE REALTY

46 Orchard Street, Suite 100, Asheville, NC 28801
WWW.MYMOSAICREALTY.COM





21 CRAIG CIRCLE
Expertly Renovated Quintessential 1920s Bungalow
Asheville, NC 28805





MOSAIC
COMMUNITY LIFESTYLE REALTY

46 Orchard Street, Suite 100, Asheville, NC 28801
WWW.MYMOSAICREALTY.COM





Tucked into a quiet pocket of East Asheville, this enchanting 1920s bungalow is a true celebration of master craftsmanship and timeless whimsy—just minutes to downtown and to the Blue Ridge Parkway. Thoughtfully reimaged by a local craftsman/builder, every detail has been carefully curated to blend historic charm with elevated design. From the moment you arrive, the home invites you in with its welcoming front porch and continues to delight with gleaming oak floors, abundant natural light, and artisan touches throughout. The heart of the home is a stunning, expanded kitchen where an exposed beam ceiling, rich walnut and quartz countertops, and custom inset cabinetry showcase exceptional skill and vision. Premium appliances and clever built-ins make the space as functional as it is beautiful. The living room exudes warmth with a brick-surround, wood-burning fireplace insert and custom shelving, while the spa-like primary suite offers a peaceful retreat with a flat-top, vaulted shiplap ceiling, skylights, and a thoughtfully designed bath. Outside, the magic continues with lush, layered landscaping, perennial blooms, stone accents, garden beds, and inviting outdoor living spaces—from the shaded deck to the built-in grill area—creating a private oasis that feels both inspired and serene. A permitted guest suite/ADU adds versatility and income potential, completing this truly special Asheville property.



For more information, please contact:

CHARLES TRIBER
828-772-1349

CHARLES@MYMOSAICREALTY.COM

DRIVING DIRECTIONS

FROM DOWNTOWN ASHEVILLE: Take I-240 E to Exit 7. Turn left onto US-70 E (Tunnel Road). Turn left onto Craig Circle. 21 Craig Circle is on the right. Sign in the yard.



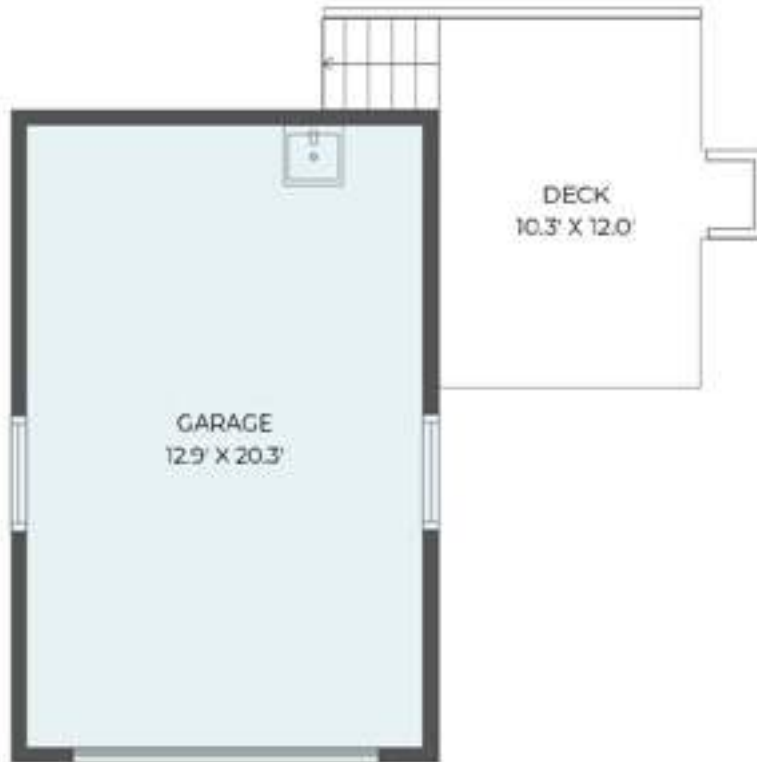

LOWER LEVEL



UPPER LEVEL