



## 196 BLACKBIRD LANE

Spacious Home on 2.96 Acres in Tryon



**MOSAIC**  
COMMUNITY LIFESTYLE REALTY

**4 Bedrooms, 3 Bathrooms, 2 Half Bathrooms**  
**4,767 SF • 2.96 Acres**  
**MLS #4366022**



## 196 BLACKBIRD LANE TRYON, NC 28782

4 Bedrooms, 3 Bathrooms, 2 Half Bathrooms  
4,767 SF · 2.96 Acres  
MLS #4366022

### FEATURES

**2.96-acre private lot**, located in the Red Fox neighborhood

**More than 4,000 SF; three levels** of living space

**Flexible layout**; option for multi-generational living

**Newer HVAC units (2020 + 2025)**—receipts/invoices are available

**Well updates, 2024:** new pressure tank, tank tee, well replacement - receipt/invoice available

**UV water filter system** was installed in 2023, receipt/invoice available

### EXTERIOR & STRUCTURE

**Fiber cement siding**

**Covered front porch entry**

**Two-car garage**

**Additional storage** below garage

**New deck installed in 2026** with Foothills General Contracting, receipt/invoice available



### MAIN LEVEL

**Primary bedroom and bathroom on main level;** walk in closet

**Hardwood floors** in living room and primary suite

**Light-filled living room** with expansive windows

**Gas fireplace** in living room

**Open kitchen layout**

**Tiled countertops**

**Built-in oven and microwave**

**Gas cooktop range**

**Spacious sunroom** with direct deck access

### UPPER LEVEL

**Open family/bonus area** with hardwood flooring

**Two additional bedrooms** with carpet and laminate flooring

**Full bathroom** with tiled shower

### LOWER LEVEL (WALKOUT BASEMENT)

**Tile flooring**

**Gas fireplace**

**Bedroom suite** with a full bathroom

**Half bathroom**

**Wine cellar**





**196 BLACKBIRD LANE**  
Spacious Home on 2.96 Acres in Red Fox  
Tryon, NC 28782



**196 BLACKBIRD LANE**  
Spacious Home on 2.96 Acres in Red Fox  
Tryon, NC 28782



**MOSAIC**  
COMMUNITY LIFESTYLE REALTY

46 Orchard Street, Suite 100, Asheville, NC 28801  
[WWW.MYMOSAICREALTY.COM](http://WWW.MYMOSAICREALTY.COM)





**MOSAIC**  
COMMUNITY LIFESTYLE REALTY

46 Orchard Street, Suite 100, Asheville, NC 28801  
[WWW.MYMOSAICREALTY.COM](http://WWW.MYMOSAICREALTY.COM)



**196 BLACKBIRD LANE**  
Spacious Home on 2.96 Acres in Red Fox  
Tryon, NC 28782



With room for everything you need and more, this spacious home offers a private, wooded retreat on almost three acres in the desirable Red Fox neighborhood—and more than 4,000 SF of thoughtfully designed living space. A covered front porch welcomes you into an inviting entryway that flows seamlessly into a light-filled living room and open kitchen. Hardwood floors run through the living room and main-level primary suite, while expansive windows fill the space with natural light and the serenity of its woodland surroundings.

The kitchen is both functional and spacious, featuring tiled countertops, a built-in oven and microwave, and a gas cooktop. Also on the main level, a generous sunroom provides additional living space and direct access to a brand-new deck (2026), perfect for entertaining or relaxing in the peaceful setting.

The main-level primary suite offers comfort and convenience, while the upper level includes an open family area with hardwood flooring, two additional bedrooms, and a full bathroom. The lower-level walkout basement adds incredible flexibility with a bedroom, full bathroom, half bathroom, wine cellar, tiled flooring, and a second gas fireplace—ideal for guests, recreation, or additional living space.

With three levels, a two-car garage, and additional storage below, this home offers versatility for a variety of lifestyles, including the option for multi-generational living...and all in a tranquil refuge to call your own.



For more information, please contact:

**HOLLY ARACICH**  
**828-335-0688**

[HOLLY@MYMOSAICREALTY.COM](mailto:HOLLY@MYMOSAICREALTY.COM)

#### DRIVING DIRECTIONS

FROM LANDRUM ROAD: After 1.5 miles, turn left onto Red Fox Road. After 1.4 miles, turn right onto Bluebird Lane, and then after 0.2 mile, turn left onto Blackbird Lane. The property is on the right.

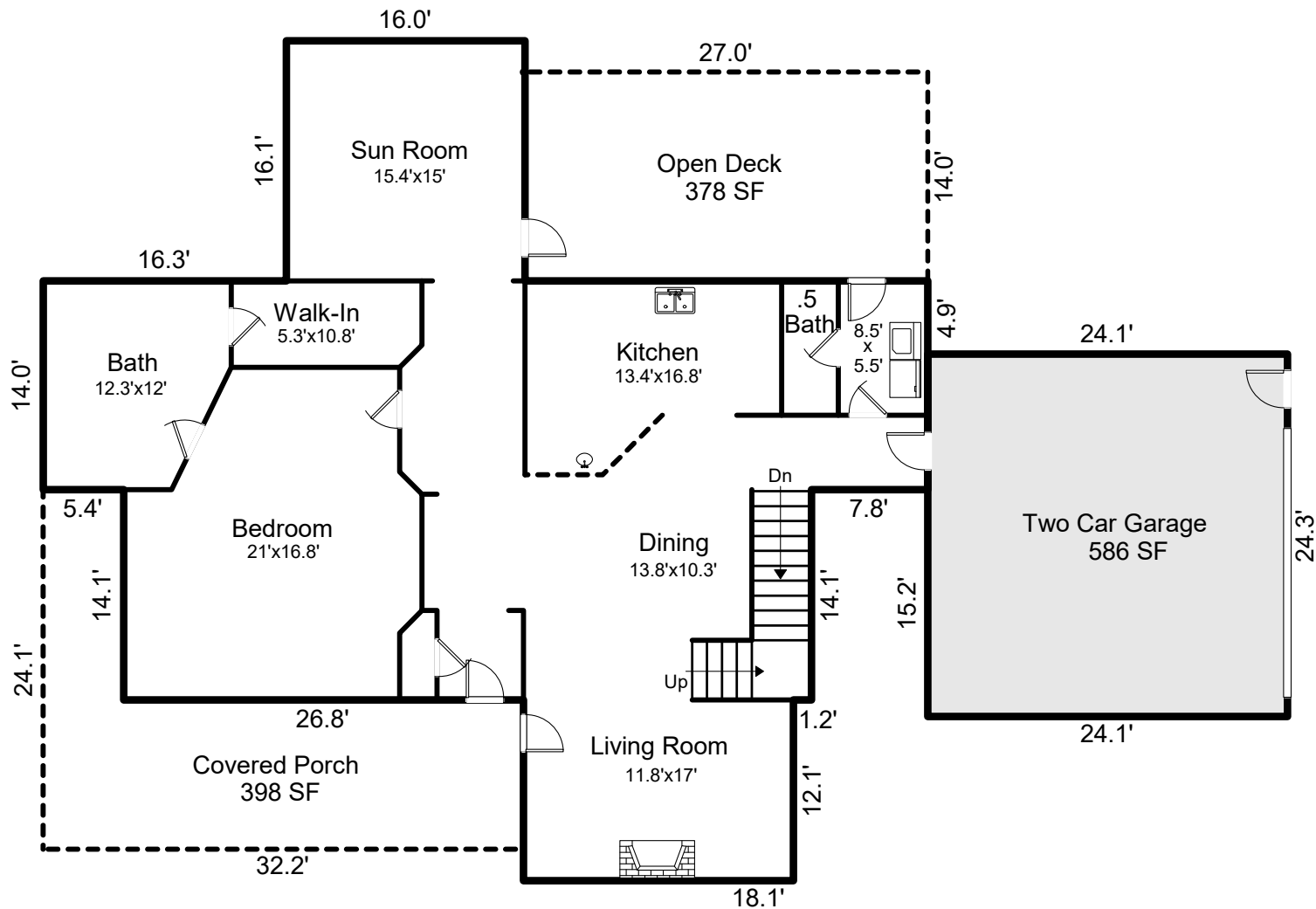

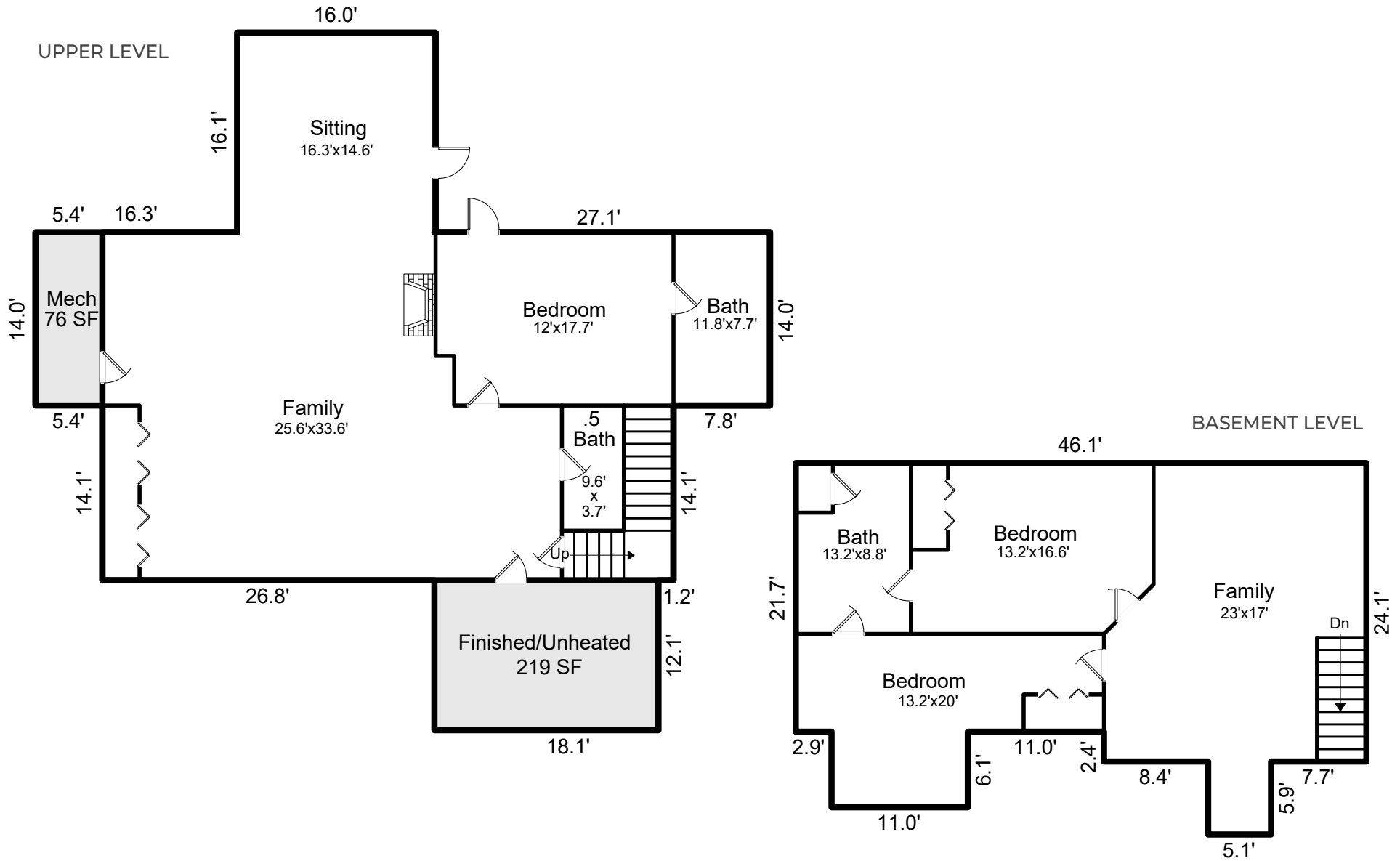

UPPER & BASEMENT LEVELS