



MOSAIC
COMMUNITY LIFESTYLE
REALTY

FLETCHER



31 BRADFORD VISTAS DRIVE | FLETCHER, NC 28732

31 BRADFORD VISTAS DRIVE
FLETCHER, NC 28732



FLETCHER



WELCOME TO WATERFORD LAKES

... one of Fletcher's most desirable communities, perfectly positioned between Asheville and Hendersonville. This established neighborhood offers a balance of convenience and mountain living, with scenic walking trails, views of the Blue Ridge Mountains, and rolling pastureland with horses in the backdrop. Remodeled in 2019 by Tyner Construction, this spacious home blends modern updates with timeless style. The airy open floor plan features a main-level primary suite with a one of kind custom walk-in closet and spa-like bath. The chef's kitchen boasts premium appliances, walk-in pantry, stylish finishes, and seamless flow for everyday living and entertaining. Upstairs, you'll find three spacious bedrooms, three full baths, and a large bonus room ideal for flex space, office, or playroom. The finished basement adds versatility with two bonus rooms, a workout area, full bath, and an expansive media room with kitchenette—perfect for multi-generational living or large gatherings.. Outdoor living shines with multiple decks showcasing mountain views, a sparkling pool, and a fire pit patio designed for fun. A 3-car garage provides ample space for vehicles, storage, and hobbies. City water, no city taxes, and highly regarded school districts (Fairview Elementary, Cane Creek Middle, A.C. Reynolds High) complete the package. Less than 15 miles from Asheville Regional Airport, Mission Hospital, Advent Hospital, downtown Asheville and Blue Ridge Parkway. Don't miss this exceptional home offering luxury, comfort, and lifestyle in one of the areas premier communities.

5 BD | 5 BA + 2 HALF | 5,875 SF | 1.48 AC | MLS #4303470



LEANN BOUND
828-713-2316
LEANN@MYMOSAICREALTY.COM

31 BRADFORD VISTAS DRIVE FLETCHER, NC 28732



31 BRADFORD VISTAS DRIVE | FLETCHER, NC 28732

5 BEDS | 5 FULL + 2 HALF BATHS | 5,875 SF | 1.48 ACRES | MLS #4303470

FEATURES

- 2014 Pool and hardspacing installed
- 2019 Full house remodel by tyner construction
- 2019 Mini-split
- 2020 New HVAC
- 2025 New roof
- Thermador appliances
- Tons of storage
- Three-car garage
- Primary suite has mountain views, soaking tub, tiled shower, custom closet, and dressing room w/ vanity
- Upper level includes three bedrooms, three full baths, and a large flex space perfect for a playroom, guest rooms, or office
- Lower level includes workout room, two bonus rooms, and a spacious media room with kitchenette (could easily convert into an in-law suite)

AREA AMENITIES

- Asheville Regional Airport, 9.4 miles
- Blue Ridge Parkway trails, 10.7 mi
- Biltmore House, 12.1 mi
- NC Arboretum (hiking, biking), 13.6 mi
- Mission Hospital, 13.3 mi
- Advent Hospital, 10.9 mi
- Grocery stores:
 - » Food Lion, 3 miles
 - » Trout Lily Organic Market, 3 mi
 - » Fairview Seafood, 3 mi
 - » Rooted in Wine, 4 mi
 - » Whole Foods, 9 mi
 - » Publix, 9.5 mi
- Shopping, restaurants, and gyms:
 - » Asheville Hot Yoga, 7 mi
 - » Biltmore Park, 9.2 mi
 - » Reuter Family YMCA, 10 mi
 - » Downtown Asheville, 13.6 mi
 - » Downtown Hendersonville, 16.4 mi
 - » Tanger Outlets, 17.4 mi

DRIVING DIRECTIONS

FROM DOWNTOWN ASHEVILLE: GPS is accurate from Cane Creek Road to Waterford Lakes Drive. Enter through the Waterford Lakes gate and roundabout, then continue on Waterford Lakes Drive. Turn right onto Bradford Vistas Drive. Home is on the right.



31 BRADFORD VISTAS DRIVE | FLETCHER, NC 28732

5 BEDS | 5 FULL + 2 HALF BATHS | 5,875 SF | 1.48 ACRES | MLS #4303470

MAIN LEVEL

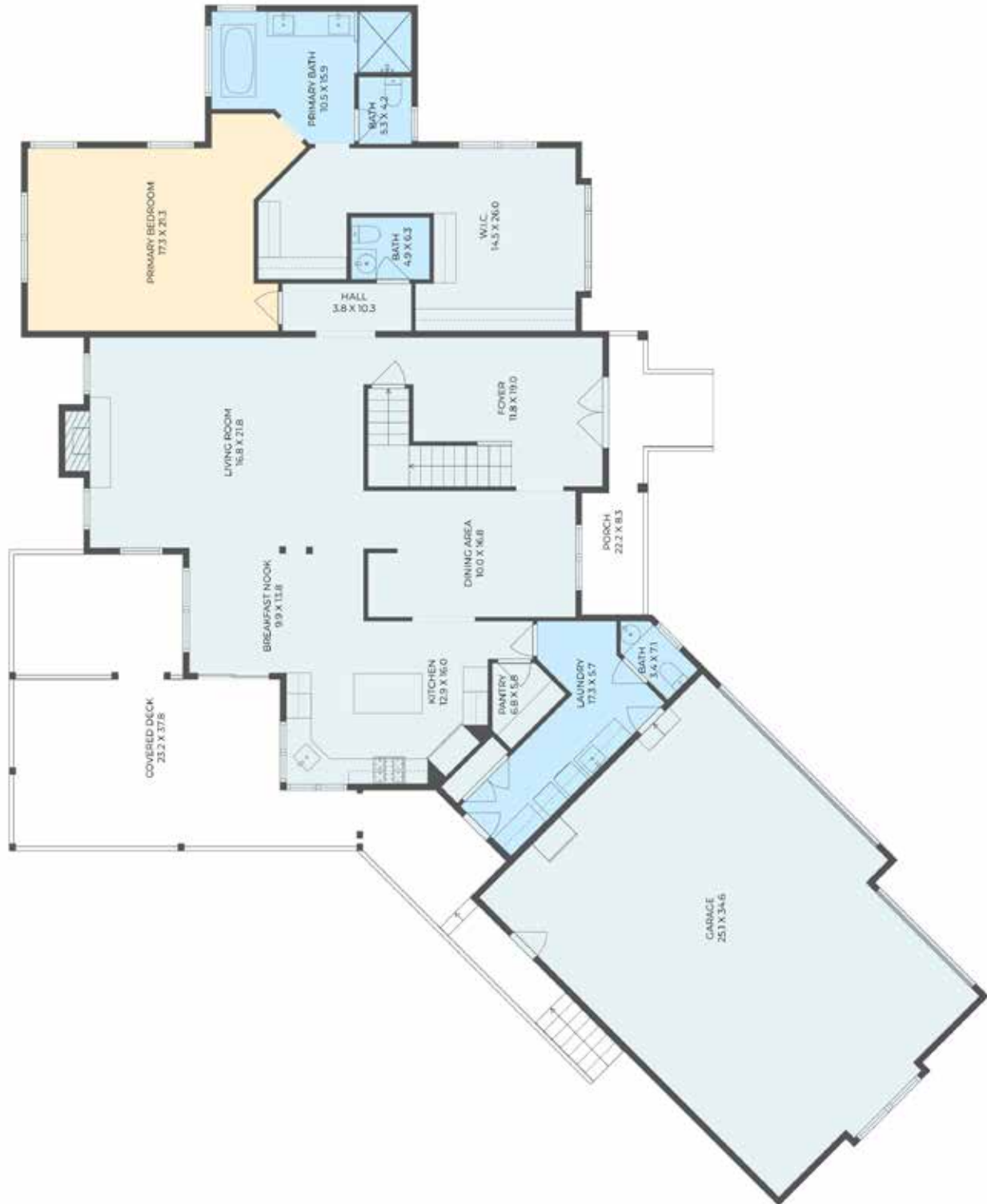

31 BRADFORD VISTAS DRIVE | FLETCHER, NC 28732

5 BEDS | 5 FULL + 2 HALF BATHS | 5,875 SF | 1.48 ACRES | MLS #4303470

UPPER LEVEL



31 BRADFORD VISTAS DRIVE | FLETCHER, NC 28732

5 BEDS | 5 FULL + 2 HALF BATHS | 5,875 SF | 1.48 ACRES | MLS #4303470

LOWER LEVEL

