



 VIRTUAL TOUR

339 CUMBERLAND AVENUE

Private Home in the Heart of Montford • Built in 2016



MOSAIC
COMMUNITY LIFESTYLE REALTY

2 Bedrooms, 2 Bathrooms
1,534 SF • 0.24 Acre
MLS #3914736



INFO

339 Cumberland Avenue, Asheville, NC 28801

2 Bedrooms, 2 Bathrooms

1,534 SF • 0.24 Acre

MLS #3914736

FEATURES

- Walking distance to downtown Asheville, Merrimon Avenue and Broadway amenities
- Directly across the street from the Montford Park that includes tennis courts, a picnic shelter, and a basketball court
- Property is steps from the Montford greenway along Broadway, leading downtown or the UNCA campus and Botanical Gardens
- 2016-Built home has been meticulously maintained
- Home sits below Cumberland Avenue, offering privacy away from the hustle of city living
- Modern open floor plan and easy one level living
- Beautiful kitchen includes lovely white cabinetry, oversized eat-in island, and granite countertops
- Abundant natural light and beautiful hardwood floors throughout
- Both bedrooms feature ensuite bathrooms
- Main primary suite includes a walk-in closet and spacious bathroom with walk-in shower and relaxing soaking tub
- Large attic space provides opportunity for expansion or storage
- All appliances to convey - laundry room off the back hall
- Screened-in cabin is hidden gem of property - sits in private backyard, ideal spot for reading, yoga, etc
- Fully encapsulated crawl space - no detail left unturned
- Ring Security System Included
- All furnishings negotiable for true move-in ready experience



Steps from Montford Park with Tennis, Pickleball and Basketball

RECENT IMPROVEMENTS

- Full Encapsulation of Crawl Space
- Dehumidifier added to crawl space
- River rock stones installed around house
- Screened in the cabin and added new structural supports
- New lighting and ceiling fans
- Surrounding trees pruned and maintained
- Installed ring security system
- New washer and dryer installed
- New window treatments



Ideal Floor Plan for Hosting Friends



Modern Open Floor Plan



All Furnishings Negotiable



Easy One Level Living



Sweet Office Nook



All Appliances to Convey



Lovely Dining Space Off the Kitchen



Beautiful Hardwood Floors



Spacious Kitchen Island



Crisp White Cabinetry and Stainless Steel Appliances



Ideal Floor Plan with Separate Suites



Both Bedrooms Feature Full Ensuite Bathrooms



Meticulously Maintained



Primary Bath Includes Walk-In Shower...



... and Relaxing Soaking Tub



Primary Bath w/ Large Double Vanity and Linen Cabinet



Second Bedroom Suite



Plenty of Bathroom Storage



Custom Walk-In Closet



Hidden Gem on Property



Screened Cabin in Private Backyard



Perfect Spot to Relax



Gravel Path to Screened Cabin



Flat Backyard for Play or Pets



Home Sits Privately Below the Road • Plenty of Parking Front and Back



Fully Encapsulated Crawlspace

Private and meticulously maintained 2016-built home in Asheville's popular Montford neighborhood. Just steps to downtown Asheville, UNCA campus and botanical gardens, and the Reed Creek Greenway. This lovely home sits close to the Montford Park and its recreational amenities. Home features two bedroom suites, a modern open floor plan, and beautiful finishes throughout. Attic space offers abundant storage or possible expansion opportunities, plus property has plenty of parking in front and back. Screened-in cabin is the hidden gem of the property, along with a flat backyard for play or pets. See brochure, floor plan, and walk-through tour video for more details. All furnishings are negotiable.



MEGAN SHOOK
828.450.6797
MEGAN@MYMOSAICREALTY.COM



TRIP HOWELL
828.450.4792
TRIP@MYMOSAICREALTY.COM



339 CUMBERLAND AVENUE - FLOOR PLANS

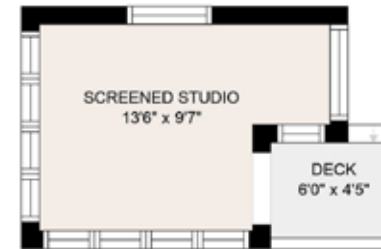

FLOOR 2