

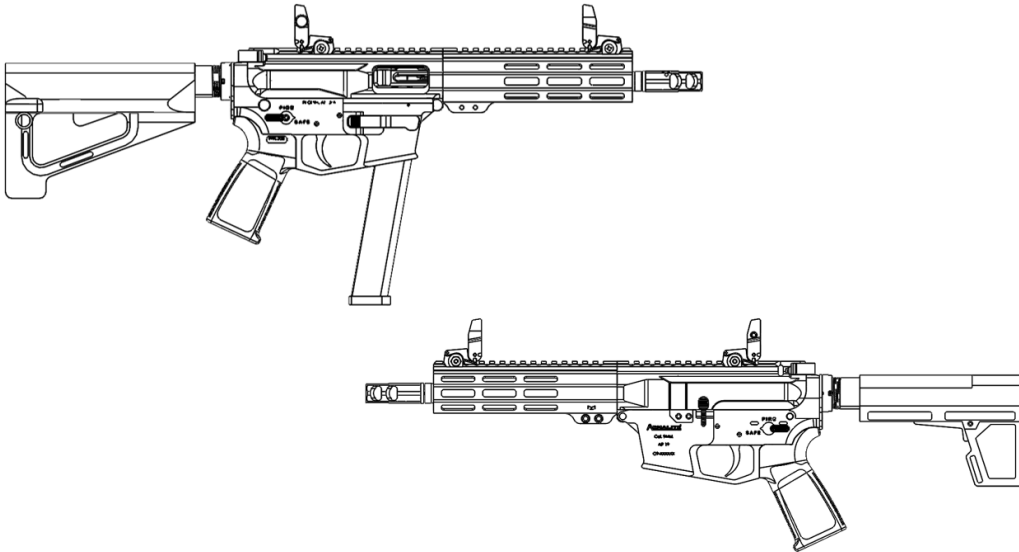

**ARMALITE®, INC  
OWNER'S MANUAL  
FOR  
AR-19 Pistol Caliber Carbine**



**⚠ READ THIS MANUAL THOROUGHLY, PARTICULARLY THE  
WARNINGS, BEFORE USING THIS FIREARM! IT'S IMPORTANT!**

**ArmaLite® Inc.  
525 E. Pinnacle Peak Rd  
Suite 100  
Phoenix, Arizona, USA 85024  
1-800-336-0184**

## 1. READ THIS FIRST!

Throughout this manual you will find WARNINGS, CAUTIONS and NOTICES printed in bold print. All WARNINGS, CAUTIONS and NOTICES must be read carefully and followed completely. WARNINGS indicate a situation, which, if not avoided, could result in death or serious injury. CAUTIONS indicate a situation, which, if not avoided, could result in minor or moderate injury. NOTICES indicate a situation that could result in damage to the firearm or other property.



**WARNING: IT IS YOUR RESPONSIBILITY TO ASSURE THAT YOUR FIREARM IS HANDLED, FIRED, AND STORED SAFELY AND RESPONSIBLY AT ALL TIMES.**

This manual provides instructions on the operation and maintenance of your ArmaLite® firearm. Read and understand it carefully before you try to use your firearm. Your safety, and that of those around you, depends on your knowledge of your firearm and on your knowledge of safety rules common to all firearms. Please study the common-sense safety rules noted in this manual. Your first responsibility as a gun owner is always safety!

Your second responsibility as a gun owner is security. Make sure that your firearm remains in responsible hands...YOURS! Don't become an unwitting partner in a crime or tragedy: make sure your firearm is properly secured. Lock it in a secure storage container or, if none is available, remove the bolt and bolt carrier assembly and store it separately. If you have more than one similar firearm, make sure that you specifically identify the removed assembly with its original firearm because the assemblies may not be interchangeable.

It is also your responsibility to assure that you comply with all federal, state, and local laws with regard to the purchase, ownership, use, and storage of your firearm.

This manual may serve several models of ArmaLite® firearms. If so, instructions which refer to specific models will be clearly marked.

### **\*\*NOTICE\*\***

ArmaLite® has no control over the use of your firearm, and shall not be responsible for injury, death, or damage to property resulting from either intentional or accidental discharge of this firearm. In addition, ArmaLite® shall not be responsible for proper function of the firearm when it is used for purposes or subjected to treatment for which it was not intended. ArmaLite® will not honor claims which may result from careless or improper handling, unauthorized adjustments or parts replacement, corrosion, neglect, use of the wrong type or caliber of ammunition, or the use of ammunition other than original, high quality commercially manufactured ammunition in good condition or any combination thereof.

## **2. SAFETY FIRST! IT'S YOUR RESPONSIBILITY!**

- \* Treat every gun as if it is loaded ...AT ALL TIMES!**
- \* Always keep the muzzle pointed in a safe direction.**
- \* Never point your firearm at anything that you do not intend to shoot.**
- \* Keep your finger off the trigger and out of the trigger guard until you are aiming at your target and ready to shoot.**
- \* Always keep the safety in the “SAFE” position, especially when the firearm is loaded and cocked, until you are ready to fire.**
- \* Always keep and carry your firearm with an empty chamber until you intend to shoot, so that your firearm cannot be fired unintentionally. Firearms should be unloaded when not actually in use.**
- \* Be sure of your target and backstop before you shoot. Ask yourself what your bullet will hit if it misses or goes through the target.**
- \* Never shoot at hard, flat surfaces or water...bullets can ricochet.**
- \* Always wear hearing and eye protection when shooting.**
- \* Discharging firearms in poorly ventilated areas, cleaning firearms, or handling ammunition may result in exposure to lead, a substance known to be associated with birth defects, reproductive harm, and other serious injury. Have adequate while firing and wash hands after firing and/or handling ammunition.**
- \* Be sure that your barrel is clear of obstructions, including excessive oil, grease, cleaning patches, etc. before shooting.**
- \* Use only clean, high quality factory loaded ammunition in good condition. ArmaLite® cannot condone the use of handloaded ammunition. Any such use voids the ArmaLite® warranty.**
- \* Do not alter or modify your firearm.**
- \* Do not try to change your firearm's trigger pull, because alterations of trigger pull can affect sear engagement and might cause accidental firing.**
- \* Store firearms and ammunition separately, and beyond children's reach.**



**WARNING: IN CASE OF MALFUNCTION, STOP! REVIEW THIS MANUAL TO IDENTIFY AND RESOLVE THE PROBLEM. IF YOU CANNOT RESOLVE IT, CONTACT ARMALITE®.**

**KEEP THIS MANUAL WITH YOUR FIREARM. IF YOU SELL THE FIREARM, GIVE THIS MANUAL TO THE NEW OWNER.**

### **3. TABLE OF CONTENTS**

<b>1. READ THIS FIRST!-----</b>	<b>2</b>
<b>2. SAFETY FIRST! IT'S YOUR RESPONSIBILITY!-----</b>	<b>3</b>
<b>3. TABLE OF CONTENTS -----</b>	<b>4</b>
<b>4. SAFE STORAGE-----</b>	<b>5</b>
<b>5. GENERAL INFORMATION-----</b>	<b>6</b>
<b>6. EXPLODED DRAWINGS AND PARTS LISTS -----</b>	<b>7</b>
<b>7. AMMUNITION-----</b>	<b>10</b>
<b>8. INITIAL ASSEMBLY, INSPECTION, AND CLEANING -----</b>	<b>11</b>
<b>9. LOADING AND FIRING -----</b>	<b>13</b>
<b>10. CLEARING / UNLOADING THE FIREARM -----</b>	<b>18</b>
<b>11. ZEROING THE SIGHTS-----</b>	<b>20</b>
<b>12. DISASSEMBLY-----</b>	<b>20</b>
<b>13. MAINTENANCE -----</b>	<b>24</b>
<b>14. TROUBLESHOOTING -----</b>	<b>30</b>
<b>15. WARRANTY, SERVICE, AND SUGGESTIONS-----</b>	<b>32</b>

## 4. SAFE STORAGE



**WARNING: ALWAYS ASSURE THAT YOUR FIREARM IS COMPLETELY UNLOADED BEFORE STORING IT. ALWAYS TREAT YOUR FIREARM AS IF IT WERE LOADED. ALWAYS STORE YOUR FIREARM IN A SAFE LOCATION, SEPARATE FROM THE AMMUNITION.**

Make certain that both the chamber and magazine of your firearm are unloaded before you store it. Store your firearm in a securely locked gun safe. If you do not have a safe, remove the bolt and bolt carrier assembly from your firearm, and store it separately from the firearm in a secure location. Store your ammunition separately from the firearm and from the bolt and bolt carrier assembly.



**WARNING: IF YOU HAVE MORE THAN ONE SIMILAR FIREARM, MAKE SURE THAT YOU SPECIFICALLY IDENTIFY THE REMOVED ASSEMBLY WITH ITS ORIGINAL FIREARM BECAUSE THE ASSEMBLIES MAY NOT BE INTERCHANGEABLE.**

## **5. GENERAL INFORMATION**



**WARNING: YOUR ARMALITE® FIREARM WAS DESIGNED TO FUNCTION PROPERLY WITH ITS ORIGINAL COMPONENTS. ALTERATIONS TO ITS ORIGINAL COMPONENTS OR REPLACEMENT OF THEM WITH AFTERMARKET (NON-ARMALITE®) COMPONENTS CAN CAUSE MALFUNCTIONS OR EVEN MAKE THE FIREARM UNSAFE. DO NOT ALTER ANY PART OR ADD / SUBSTITUTE PARTS NOT PROVIDED OR RECCOMENDED BY ARMALITE® INC.**

### **5.1 BARREL LIFE**

Barrel life depends on how fast the firearm is fired and how accurate the shooter insists it must be. Shooting the firearm as fast as the trigger can be pulled can ruin the barrel in just a few hundred rounds. Firing at controlled rates will allow a standard grade barrel to last for +10,000 rounds with accuracy acceptable for police use.

### **5.2 RECEIVER FIT**

The AR-19 is not a “custom” firearm. ArmaLite® requires a close fit between the receivers, but normal machining variations may result in play or slight side to side receiver mismatch. This is not a manufacturing defect and has no adverse effect on accuracy.

### **5.3 APPEARANCE**

Almost all complaints concerning appearance come from customers who forget that the AR-19 is a field grade weapon, not a polished commercial or collectors-grade firearms. It is an industrial product, not a “custom” firearm, and bears finishes appropriate for its intended purposes. ArmaLite® firearms are all thoroughly test fired before shipping. New firearms will normally show evidence of this firing. If the receiver looks light or uneven in color, it’s probably just dry. A light coat of oil on the metallic surfaces will improve its appearance.

## 6. EXPLODED DRAWINGS AND PARTS LISTS

The drawings and associated parts lists in this section will give you visual references to parts discussed in the text. In the text, you will note part numbers in parentheses behind some part names. Those part numbers are the same as part numbers shown in the exploded drawings and part lists. For example, a part numbered “U-7” in the text would refer to the part numbered “7” in the Upper Assembly exploded view.

### Upper Receiver Assembly

1	RA640	CHARGING HANDLE
2	5AX9UPP	UPPER RECIEVER
3	MAG248-BLK	FRONT SIGHT (MBUS)
4	MAG247-BLK	REAR SIGHT (MBUS)
5	5AXHG7	7" HANDGUARD
6	91251A340	#10-32X.375 SHCS
7	15105135	M15 STEEL BARREL NUT
8	BPDW9	9MM BOLT ASSEMBLY
9	CW-1	M15 CRUSH WASHER
10	ATB9	ARMALITE TAC BRAKE 9MM
11	15A910	9MM BARREL 8.5"

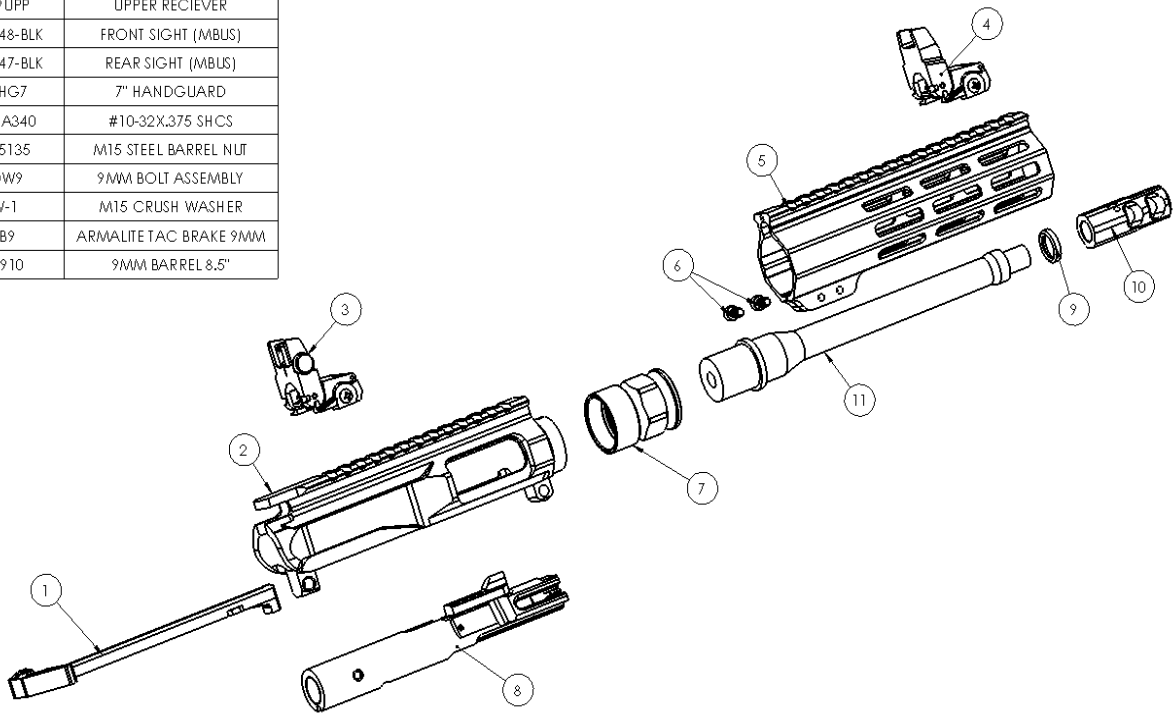

## Bolt Assembly

1	BPDW9-D	9MM PCC FIRING PIN SPRING ONLY
2	BPDW9-B	9MM PCC FIRING PIN ONLY
3	BPDW9-E	9MM PCC BOLT WEIGHT ONLY
4	BDPW9-F	9MM PCC BOLT WEIGHT RETAINING PIN ONLY
5	BPDW9-C	9MM PCC FIRING PIN RETAINING PIN ONLY
6	BPDW9-J	9MM PCC EXTRACTOR SPRING ONLY
7	BPDW9-G	9MM PCC EXTRACTOR ONLY
8	BPDW9-H	9MM PCC EXTRACTOR PIN ONLY
9	BPDW9-A	9MM PCC BOLT CARRIER ONLY

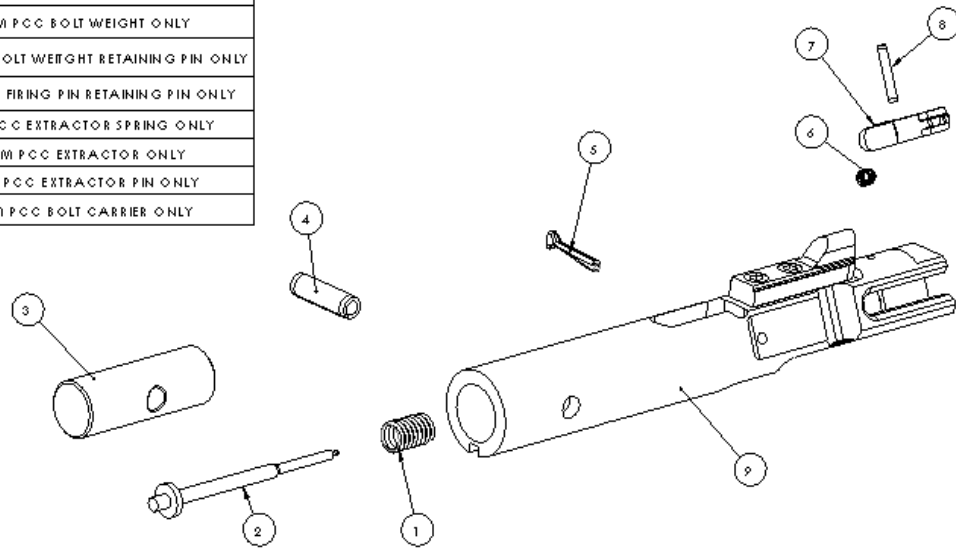



## Lower Receiver Assembly

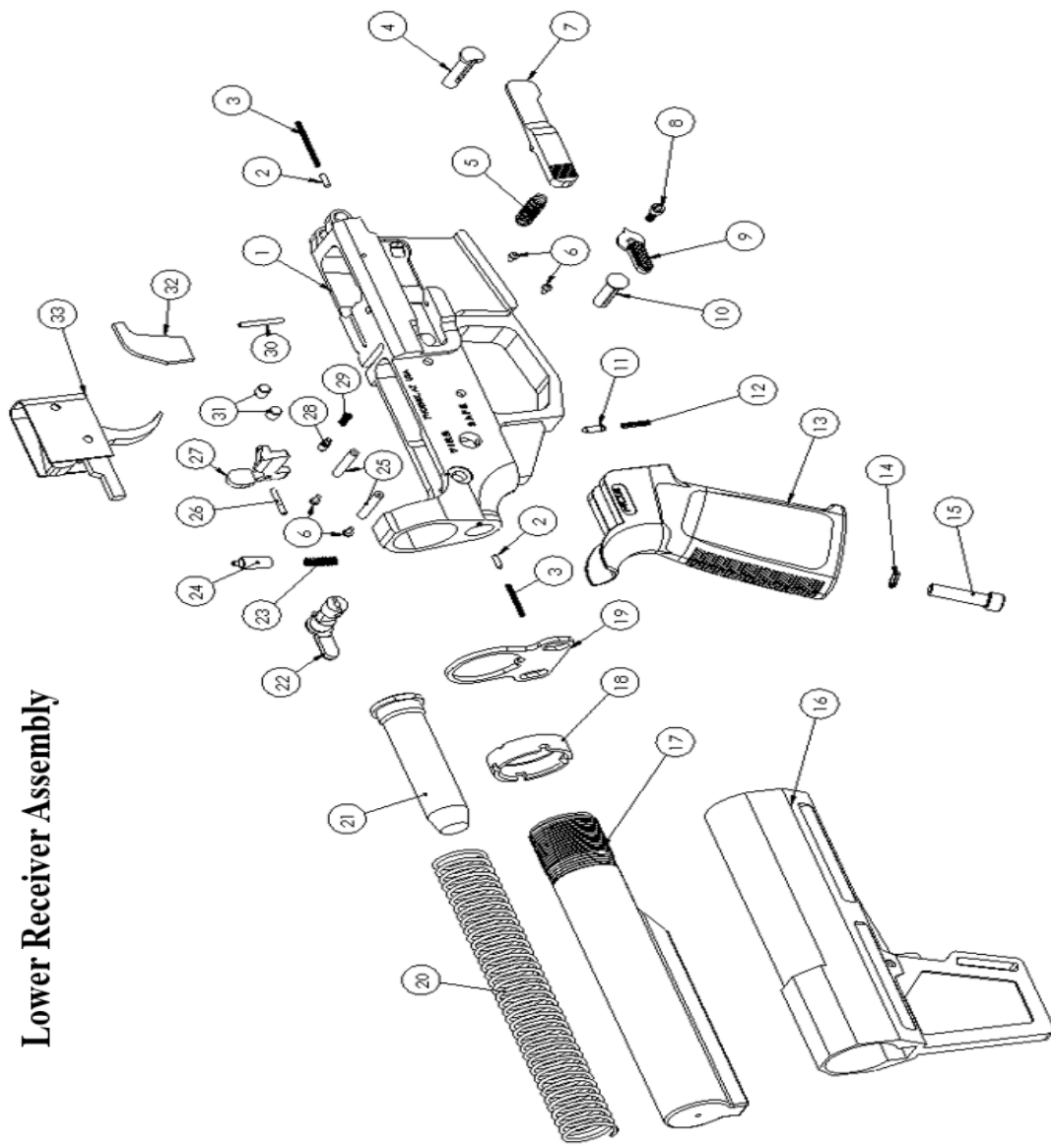

1	E400PDW	BULLET LOWER, 9MM GLOCK
2	E0150	DETENT, TAKE DOWN PIN (X2)
3	E0140	SPRING, DETENT TAKE DOWN PIN (X2)
4	E0170	PIVOT PIN
5	BHMMIS	MAGAZINE CATCH SPRING, 9MM
6	91401-B	ANTI-WALK PIN SCREW (X4)
7	BHMMIC	MAGAZINE CATCH, 9MM GLOCK
8	E00098	SOCKET HEAD CAP SCREW, AMBI SELECTOR
9	E00097-B	AMBI SELECTOR RH KNOB (SEM)
10	E0160	TAKE DOWN PIN
11	E0060	SAFETY DETENT
12	E00110	SAFETY DETENT/TARGET ELECTOR SPRING, 945"
13	MAG416-BLK	MAGPUL MOE+ PISTOL GRIP
14	E0020	GRIP SCREW WASHER
15	E0010	PISTOL GRIP SCREW
16	SWZM8LD	PISTOL BLADE STABILIZER
17	15207020	MILS RECEIVER EXTENSION TUBE 6POS
18	E0063A	COLLAPSING BUTTSTOCK LOCKING
19	E00057	AMBI RECEIVER END PLATE
20	E00040	MILS CARBINE BUFFER SPRING
21	90CA984	9MM BUFFER 8 oz
22	E0097A	AMBI SAFETY SELECTOR SWITCH
23	E0020	BUFFER DETENT SPRING
24	E0190	BUFFER DETENT
25	91401-A	ANTI-WALK HAMMER/TRIGGER PIN
26	BHMBCS	9MM PCC BOLT CATCH SCREW
27	E00230	MILS BOLT STOP CATCH
28	E00240	BOLT STOP CATCH PLINGER
29	E00250	BOLT STOP CATCH PLINGER SPRING
30	BHMMPS	9MM PCC MAG CATCH PIVOT SCREW
31	BHMMES	9MM PCC ELECTOR SCREW (X2)
32	ARM09	9MM PCC ELECTOR
33	CMC9CRV	TRIGGER, 9MM CMC CURVED

## 7. AMMUNITION

Nomenclature of cartridges can be confusing. It is vital that you understand cartridge nomenclature and only fire cartridges for which this firearm was designed. To assist you, the name of the appropriate cartridge will be etched on the receiver and/or barrel of each ArmaLite.



**⚠ WARNING: USE OF INCORRECT AMMUNITION CAN CAUSE FIREARM DAMAGE, PERSONAL INJURY, OR DEATH. MAKE ABSOLUTELY CERTAIN THAT YOU ARE USING CARTRIDGES DESIGNED FOR YOUR FIREARM. DO NOT FIRE OLD, CORRODED, DEFORMED, OR HANDLOADED AMMUNITION. IF YOU HAVE ANY QUESTIONS, CONTACT ARMALITE® BEFORE FIRING.**

In order to assure that you are using the correct cartridges for your firearm, you must look on the firearm itself. The caliber is marked on the barrel and/or upper receiver. If you have any questions regarding ammunition compatibility, CONTACT ARMALITE® BEFORE FIRING THE FIREARM!!!!!!

Your AR-19 firearm is chambered for 9mm Luger (9x19mm Parabellum) cartridges. Do not attempt to fire any other cartridges in this firearm.

**⚠ NOTICE: FIRING TRACER AND ARMOR PIERCING AMMUNITION REDUCES BARREL LIFE.**

NOTE: Some types/brands of ammunition have unique characteristics (e.g. extremely light or heavy projectiles, particularly soft cartridge cases, propellant that burns unusually slowly or rapidly) that reduce its reliability in any semiautomatic firearm. ArmaLite® recommends that you purchase and test a small quantity of any type of ammo in your firearm before you buy large quantities.

## 8. INITIAL ASSEMBLY, INSPECTION, AND CLEANING

Your ARMALITE® comes assembled with a number of commercially available components from various industry leaders. While Armalite stands behind the quality of these components, Armalite may not be able to service some of the components, however, Armalite can replace any item under warranty.

### 8.1 INITIAL ASSEMBLY

Your firearm is shipped to you completely assembled. However, the stabilizer may require adjustment in length to fit you.

#### ADJUSTING THE COLLAPSIBLE STABILIZER BLADE or COLLAPSIBLE BUTTSTOCK

To extend the collapsible stabilizer, depress the lever and pull the stock out until it locks into position. To collapse the stabilizer, depress the lever again and push forward until it locks into position.



#### INSTALLING/REMOVING SIGHTS ON RECEIVER PICATINNY RAIL

To install removable front/rear sights, viewing from the rear of the firearm, remove the screw on the right side of the sight (the nut on the opposite side can occasionally come out, be careful to secure it when removing sights). Next slide the rear sight to the rear until clear of the receiver, slide the front sight forward until clear of the handguard. Reverse for reinstallation. **DO NOT OVER TIGHTEN.** (for scope mounts, or other Picatinny rail mountable accessories), follow the instructions provided with the accessory.



**CAUTION: IF YOU MOUNT A SCOPE TO YOUR WEAPON, MAKE CERTAIN THAT THE SCOPE IS MOUNTED FAR ENOUGH FORWARD SO THAT IT WILL NOT IMPACT YOUR FACE DURING RECOIL. CHECK THE DISTANCE BETWEEN**

**THE SCOPE AND YOUR FACE WHEN YOU ARE IN THE FIRING POSITION. BEAR IN MIND THAT YOUR EYE WILL BE CLOSER TO THE SCOPE WHEN SHOOTING FROM PRONE OR FROM THE BENCH THAN WHEN SHOOTING OFF-HAND. WHEN IN DOUBT, INCREASE THE EYE RELIEF.**

### **8.3 INITIAL CLEANING**

Merely clean the bore of your firearm and lubricate the firearm as described in the Maintenance section below. Lubricate the firearm well before firing.



**WARNING: TO ASSURE ITS PROTECTION FROM CORROSION, YOUR ARMALITE® FIREARM HAS BEEN SHIPPED WITH PRESERVATIVE OIL IN THE BORE. FIRING THE FIREARM WITH PRESERVATIVE IN THE BORE CAN INCREASE PRESSURES, WITH POSSIBLE FIREARM DAMAGE OR PERSONAL INJURY OR DEATH. CLEAN AND DRY THE BORE BEFORE FIRING YOUR ARMALITE® FIREARM.**

### **8.4 BREAKING IN BARRELS**

ArmaLite® has spoken with several barrel manufacturers. NONE of them recommend breaking in barrels using abrasives. For optimum accuracy and barrel life, ArmaLite® recommends the following break-in procedure:

1. Fire 9 single shots. After each shot, push a cotton patch wet with solvent through the bore. Then wet a bronze brush with solvent and stroke the barrel five to ten round trips. Follow with another wet patch and then a dry patch or two. (We do NOT recommend nylon or stainless steel brushes.) After you finish, wash the solvent off your brush so that the brush won't deteriorate.
2. From 10 to 30 shots, clean as above after each five shots. Initial break-in should now be complete.

For subsequent, normal cleaning, it is suggested that you clean after each range session.

### **8.5 DRY FIRING**

Reasonable amounts of dry firing should not damage your firearm.

**NOTICE: NEVER DRY FIRE YOUR FIREARM WITHOUT THE BOLT CARRIER ASSEMBLY INSTALLED. THE FIRING PIN STOPS THE FALL OF THE HAMMER.**

**WITHOUT THE BOLT CARRIER ASSEMBLY INSTALLED, THE HAMMER CAN IMPACT ON THE LOWER RECEIVER AND/OR BOLT CATCH, DAMAGING IT.**



**WARNING: FOLLOW ALL OF THE RULES OF SAFE GUN HANDLING ANYTIME YOU DRY FIRE YOUR FIREARM**

## **9. LOADING AND FIRING**



**WARNING: ALWAYS KEEP THE SAFETY IN THE “SAFE” POSITION UNTIL YOU ARE READY TO FIRE THE FIREARM. REMEMBER THAT THE SAFETY IS SIMPLY A MECHANICAL DEVICE, AND AS SUCH, COULD POSSIBLY FAIL. NEVER DEPEND ON ANY SAFETY TO JUSTIFY UNSAFE GUN HANDLING. ALWAYS KEEP THE CHAMBER EMPTY AND THE FIREARM POINTED IN A SAFE DIRECTION EVEN WHEN THE SAFETY IS ON.**



**WARNING: INJURY, DEATH, OR FIREARM DAMAGE CAN RESULT FROM FIRING A FIREARM WITH AN OBSTRUCTION IN THE BORE. BEFORE YOU FIRE, MAKE SURE THAT THE BORE IS NOT OBSTRUCTED. NEVER ATTEMPT TO SHOOT OUT A BORE OBSTRUCTION.**



**WARNING: ALWAYS WEAR EYE AND EAR PROTECTION. MAKE SURE THAT NEARBY BYSTANDERS ALSO WEAR EYE AND EAR PROTECTION.**



**WARNING: HANDLING OF CARTRIDGES AND FIRING FIREARMS MAY EXPOSE YOU TO LEAD. ALWAYS ASSURE THAT THERE IS ADEQUATE VENTILATION. ALWAYS WASH YOUR HANDS AFTER HANDLING AMMUNITION OR FIRING YOUR FIREARM.**



**WARNING: THIS FIREARM WILL FIRE WITHOUT A MAGAZINE IN IT. ALWAYS ASSURE THAT THE CHAMBER IS EMPTY. THE FIREARM SHOULD NOT BE CONSIDERED TO BE SAFE UNLESS THE MAGAZINE IS REMOVED, THE SAFETY IS ON, AND THE BOLT IS OPEN, AND THE CHAMBER IS EMPTY.**



**CAUTION: THE FIRED CARTRIDGE CASE IS HOT WHEN IT IS EJECTED FROM THE FIREARM. DO NOT ALLOW IT TO BURN YOU, OR TO DISTRACT YOU FROM SAFE HANDLING OF THE FIREARM.**



**WARNING: IF THE FIREARM FAILS TO FIRE WHEN THE TRIGGER IS PULLED:**

- 1. KEEP THE FIREARM POINTED AT THE TARGET!!!**
- 2. WAIT 15 SECONDS TO ALLOW A POSSIBLE “HANGFIRE” TO GO OFF. THEN,**

3. CHECK TO SEE IF THE SAFETY IS ENGAGED BY MISTAKE. IF SO, PUSH THE SAFETY TO THE “FIRE” POSITION AND FIRE.
4. IF THE FIREARM STILL DOESN’T FIRE, BE CAUTIOUS AND ASSUME THAT THE CARTRIDGE WILL DISCHARGE WHEN THE BOLT IS OPENED.
5. OPEN THE BOLT QUICKLY AND UNLOAD THE FIREARM.
6. EXAMINE THE FIREARM AND CARTRIDGE CAREFULLY TO IDENTIFY THE CAUSE OF THE MALFUNCTION.



**WARNING: RAPID FIRING OF THE FIREARM MAY CAUSE SOME COMPONENTS TO BECOME HOT ENOUGH TO CAUSE INJURY. EXTENDED SESSIONS OF VERY RAPID FIRING MAY CAUSE A CARTRIDGE LEFT IN THE CHAMBER TO “COOKOFF”, FIRING ITSELF WITHOUT YOU PULLING THE TRIGGER. ALWAYS UNLOAD THE FIREARM IMMEDIATELY AFTER YOU FINISH FIRING.**

To prevent cookoffs and maximize barrel life, the rate of fire should not exceed the following:

- 2 minutes --- 40 rounds per minute
- 10 minutes --- 30 rounds per minute
- 20 minutes --- 20 rounds per minute
- 30 minutes or more --- 13 rounds per minute

## **9.1 LOADING THE MAGAZINE**

Set the cartridge on the follower, between the feed lips and pointing the same direction as the “bullet” on the follower and press it straight down until it’s held by the lips of the magazine.

**NOTICE: PROVIDED WITH YOUR ARMILITE PISTOL IS A GLOCK MANUFACTURED 30 ROUND MAGAZINE. THE MAGAZINES PROVIDED BY ARMALITE ARE CLASSIFIED AS GEN 4 MAGAZINES. THE ARMALITE AR-19 IS COMPATIBLE WITH ALL GENERATIONS OF GLOCK MAGAZINES. DO NOT EXCEED THE ANNOTATED MAGAZINE CAPACITIES STATED ON YOUR MAGAZINES. DUE TO VARIATIONS IN DIAMETERS OF VARIOUS BRANDS OF CARTRIDGES, IT MAY BE POSSIBLE TO FORCE AN ADDITIONAL CARTRIDGE INTO A MAGAZINE. DOING SO WILL DAMAGE YOUR MAGAZINE AND LEAD TO ELEVATED MALFUNCTION RATES.**

Keep magazines clean, dry and free from debris. Insert them smoothly then check to assure they're locked in the firearm by tugging downward.

1. Pull the charging handle rearward, lock the bolt carrier by depressing the bolt stop and releasing the charging handle and moving it to its normal forward locked position. Place the safety on SAFE. Check to see that the chamber is clear, and the bore is free of obstructions.
2. Push upward on the magazine until the magazine catch engages and holds the magazine. Pull down on the magazine slightly to make sure that it is locked in place.



## **9.2 CHAMBERING AND FIRING A ROUND, STARTING WITH THE BOLT OPEN AND MAGAZINE INSERTED**

1. Depress the upper portion of the bolt stop to release the bolt.



2. With the weapon pointed in a safe direction, move the safety to “FIRE”.
3. Squeeze the trigger and fire.



### **9.3 CHAMBERING AND FIRING A ROUND, STARTING WITH THE BOLT CLOSED AND MAGAZINE INSERTED**

1. Pull the charging handle fully to the rear.

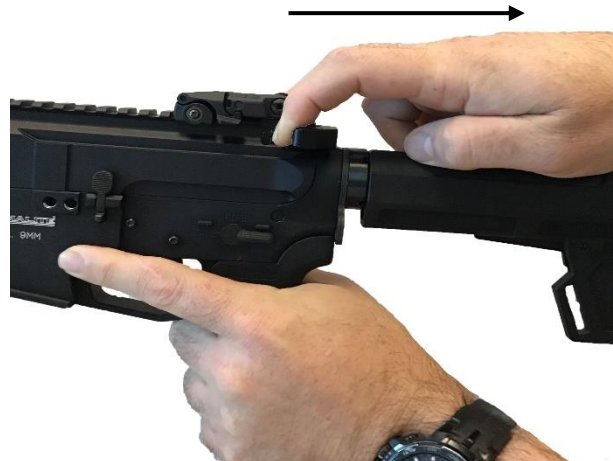

2. Release the charging handle completely and let it slide forward at full speed; never “ride” the charging handle. Assure it is latched in the forward position after it is released.





4. Set the safety to “FIRE”, grip the firearm firmly, and squeeze the trigger.



**WARNING: GRIPPING THE WEAPON LOOSELY WHEN FIRING CAN CAUSE THE SHOOTER TO FIRE TWO SHOTS (THE SECOND AS THE TRIGGER STRIKES THE SHOOTER’S TRIGGER FINGER DURING COUNTER-RECOIL.) THIS IS A SHOOTER ERROR, NOT A WEAPON MALFUNCTION.**

**NOTICE: DO NOT REST THE WEAPON ON ITS MAGAZINE WHEN YOU ARE LOADING OR FIRING IT. DOING SO CAN FORCE THE MAGAZINE UP INTO THE WEAPON, REDUCING THE RELIABILITY OF FEEDING CARTRIDGES.**

## 10. CLEARING / UNLOADING THE FIREARM

 **WARNING: ALWAYS ASSUME ALL FIREARMS ARE LOADED. ANYTIME YOU HANDLE A FIREARM, YOU SHOULD IMMEDIATELY INSPECT IT TO ASSURE THAT IT IS COMPLETELY UNLOADED. EVEN IF YOU ARE SURE IT WAS CLEAR THE LAST TIME YOU HANDLED IT, AND EVEN IF YOU ONLY SET IT DOWN MOMENTS PRIOR! MAKE IT A HABIT!**

 **WARNING: IF YOU KNOW NOTHING ELSE ABOUT YOUR ARMALITE® FIREARM, YOU MUST KNOW HOW TO UNLOAD IT AND CLEAR IT TO MAKE IT SAFE.**

**Keep your weapon cleared when not in use.**

### **1. Place safety lever on “SAFE”.**

NOTE: If the weapon is not cocked, the lever cannot be pointed toward SAFE.



### **2. Remove the magazine by depressing the magazine catch button and pulling the magazine down.**



**NOTICE: THE MAGAZINE WILL FALL FREE WHEN THE MAGAZINE CATCH IS PRESSED. DON'T ALLOW THE MAGAZINE TO FALL ONTO A HARD SURFACE. DOING SO MAY DAMAGE THE MAGAZINE.**

3. **Extract the cartridge (if any) from the chamber.** To lock the bolt carrier open, pull the charging handle rearward, press the lower portion of the bolt catch, and then allow the bolt to move forward until the bolt stop retains it. Return the charging handle forward, to its locked position.



4. Look into the receiver and chamber to ensure that these areas contain no ammunition.



**WARNING: NEVER ASSUME THAT THE CHAMBER IS EMPTY UNTIL YOU HAVE VISUALLY EXAMINED IT AND SEE THAT IT IS EMPTY.**

5. Empty all remaining cartridges out of your magazines.



**WARNING: THE STEPS IN UNLOADING YOUR FIREARM MUST BE FOLLOWED IN THE EXACT ORDER GIVEN. THE MAGAZINE MUST BE REMOVED BEFORE THE CHAMBER IS INSPECTED. IF YOU CLEAR THE**

**CHAMBER BEFORE REMOVING THE MAGAZINE, YOU MAY REMOVE ONE CARTRIDGE FROM THE CHAMBER AND THEN, UPON CLOSING THE BOLT, CHAMBER ANOTHER CARTRIDGE FROM THE MAGAZINE. THE FIREARM WILL STILL BE LOADED. REMEMBER THAT A CARTRIDGE IN THE CHAMBER CAN STILL BE FIRED EVEN AFTER THE MAGAZINE IS REMOVED.**

## **11. ZEROING THE SIGHTS**

Your ArmaLite® AR-19 is supplied with Magpul MBUS front and rear sights. The rear sight is adjustable for windage by turning the adjustment knob located on the right side of the sight. The front sight is adjustable for elevation by use of a front sight tool (not provided) adjustment of the front sight is usually not necessary, the sight height is set from ArmaLite for 50m. If these sights are to be removed and replaced with a different type of sight, make sure to follow the instructions in replacement accessory's owner's manual.

## **12. DISASSEMBLY / REASSEMBLY**



**WARNING: ALWAYS UNLOAD YOUR FIREARM BEFORE CLEANING, LUBRICATION, DISASSEMBLY, OR REASSEMBLY.**

**1**



**WARNING: ALWAYS WEAR SAFETY GLASSES WHEN DISASSEMBLING, MAINTAINING, OR ASSEMBLING YOUR FIREARM. IN PARTICULAR, THE OPERATING SPRING IS UNDER HIGH COMPRESSION. IF IT SLIPS FROM YOUR GRASP, IT COULD CAUSE INJURY.**

### **12.1 CLEAR THE WEAPON**

**IMPORTANT: Put the safety on "SAFE". Remove the magazine, THEN pull back the charging handle and check the chamber.**

### **12.2 UPPER AND LOWER RECEIVERS**

1. From the left side of the weapon, push the takedown pin as far as it will go.
  - a. From the right side of the weapon, pull the takedown out until it stops.



2. Pivot the upper receiver assembly from the lower receiver assembly slowly.
3. from the left side of the receiver, push the receiver pivot pin as far as it will go.
  - a. **(Firmly grasp both upper and lower assemblies)** From the right side, pull the pivot pin out until it stops.



4. Separate the upper and lower receivers.

## 12.3 UPPER RECEIVER DISASSEMBLY

1. Pull back the charging handle and bolt carrier assembly.



2. With the charging handle approximately half way to the rear you can remove the bolt carrier assembly.



3. Pull the charging handle back aligning the tabs on the charging handle with the cut outs on the inside of the receiver and bring it down to remove it.



## **FIRING PIN REMOVAL**

4. To remove the firing pin, using fingers, pull out the firing pin retaining pin to the left of the bolt, use caution as the firing pin is under spring tension. Install in reverse.

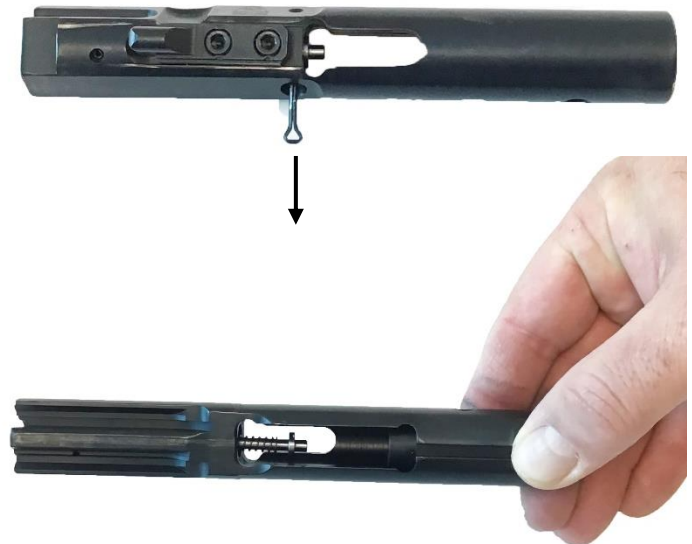

**\*\* For normal cleaning this is as far as the bolt carrier needs to be disassembled\*\***

**It is not recommended to remove the bolt weight or the carrier key, or extractor, if damaged and in need of replacement, call Armalite Customer Service.**

## 12.4 LOWER RECEIVER ASSEMBLY

1. **\*\*CAUTION-THE BUFFER IS UNDER SPRING TENSION\*\***

Cock the hammer with your thumb. Push in the buffer and depress the buffer detent to release the buffer.



2. Remove the buffer and the operating spring. Install in reverse.

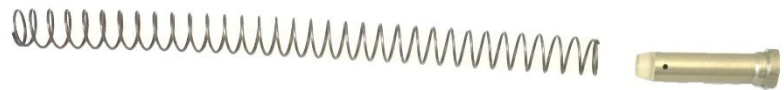

**\*\*\* FOR NORMAL MAINTENANCE, NO FURTHER DISASSEMBLY OF THE FIREARM IS REQUIRED. \*\*\***



## 13. MAINTENANCE

 **WARNING: ALWAYS UNLOAD YOUR FIREARM BEFORE CLEANING, LUBRICATION, DISASSEMBLY, OR REASSEMBLY.**

 **WARNING: DO NOT APPLY LUBRICANT OR PRESERVATIVE TO YOUR AMMUNITION. DOING SO MAY CAUSE THE CARTRIDGE TO PARTIALLY MALFUNCTION, LEAVING THE BULLET LODGED IN THE BORE, CREATING A BORE OBSTRUCTION.**

### 13.1 CLEANING SOLVENTS AND LUBRICANTS

The Military Services generally use a multipurpose chemical called CLP (cleaner, lubricant, and preservative) sold commercially as “Break Free.” Although it is useful if nothing else is available, armament engineers prefer individual, specialized products. A combination of military RBC ( bore cleaner) and LSA (lubricant, semifluid, automatic firearms) is superior. High quality cleaning solvent like Hoppes No. 9 removes metal fouling from the bore excellently; and Teflon bearing lubricants, such as Bore Cote, are outstanding lubricants. For maximum reliability and service life, lubricate your firearm (especially the highly stressed bolt and bolt carrier assembly) generously with high quality firearms lubricants.

Under NO conditions should any lubricant containing graphite be used with your firearm. Graphite can encourage rapid corrosion to the aircraft-grade aluminum used in your firearm.

In addition to cleaning solvents and lubricants, the basic cleaning equipment you will need includes a cleaning rod, brass bore brush, chamber brush, toothbrush, patches, pipe cleaners, and the most important item: a lint-free cloth.

### 13.2 CLEANING UPPER RECEIVER AND BARREL ASSEMBLY

**! NOTE! IMAGES IN THIS SECTION MAY NOT REPRESENT YOUR SPECIFIC WEAPON HOWEVER, THE STEPS FOR CLEANING ARE THE SAME.**

1. Use cleaning solvent on the bore and chamber, the upper receiver and barrel assembly, locking lugs and all areas of powder fouling, corrosion, dirt or dust.

 **WARNING: LEAD MAY BE PRESENT IN THE FOULING OF A DIRTY FIREARM. AVOID CONTACT WITH IT, WEAR EYE PROTECTION AND PROTECTIVE LATEX GLOVES (OR SIMILAR) AND DISCARD AFTERWARD TO AVOID INGESTING LEAD.**

2. Use a cleaning rod, bore brush and cleaning solvent. Run the rod through the chamber completely through past the muzzle several times.

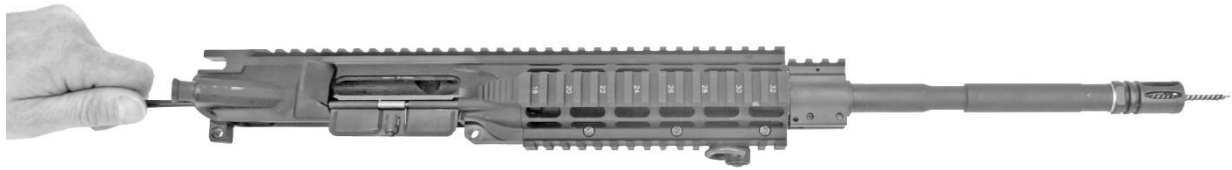

A3062

**\*\*NOTICE: DON'T REVERSE THE DIRECTION OF THE BORE BRUSH WHILE IT'S IN THE BORE.\*\***

3. Install the chamber brush on the cleaning rod, dip it in cleaning solvent, and insert it into the chamber and locking lugs. Clean by pushing and twisting the cleaning rod.

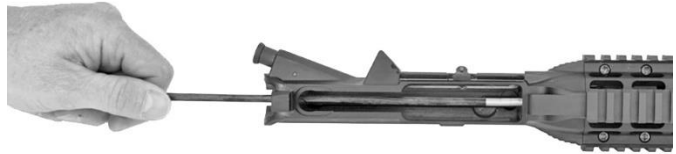

A3063

4. Take the bore brush off the rod and install a swab holder and a swab. Apply cleaning solvent to the swab; then run it through the chamber and out the flash suppressor (if applicable). To remove carbon build up, let the solvent sit, then wipe clean. A bore brush may be used with care to remove heavy carbon buildup. Wipe the bore dry by running clean swabs all the way through from the chamber to the flash suppressor repeating until the swab comes out clean. REMEMBER, do not change directions in the bore.
5. Inspect the barrel, gas tube, and hand guards for cracks, bends, or breaks. Be sure the barrel has no obstructions.
7. Lightly lubricate the bore and chamber and outer surface of the barrel, and the surfaces under the handguard.



**\*\*DO NOT OVER LUBRIBATE THE BORE AND CHAMBER, AFTER APPLYING A LIGHT COAT OF OIL, RUN A DRY SWAB BACK THROUGH THE BARREL TO REMOVE ANY ACCESS. DO NOT ALLOW LUBRICANT TO “POOL” IN THE CHAMBER OR BORE, THIS CAN CAUSE EXCESSIVE PRESSURE AND THE POTENTIAL FOR DAMAGE TO PERSON OR PROPERTY\*\***

### 13.3 LOWER RECEIVER ASSEMBLY

**NOTICE: DO NOT USE A WIRE BRUSH OR ANY TYPE OF ABRASIVE MATERIAL TO CLEAN ALUMINUM SURFACES**

1. Wipe dirt from the trigger area with a swab.
2. Use a swab and cleaning brush to clean powder fouling, corrosion, and dirt from the lower receiver.
3. Use a pipe cleaner to clean the hole in the rear of the buttstock tube.

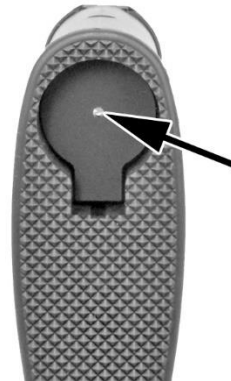

A3088

4. Clean the buffer, recoil spring, and inside lower receiver with a swab dipped in solvent.
5. Lightly lubricate the buffer and operating spring.



A3059

6. Examine the lower receiver assembly for a broken or bent trigger, buttstock, corroded or deformed lower receiver, cracked or damaged grip, and bent or damaged safety. Look at the inside parts for cracks, dents, or breaks.



A3090

7. Generously lubricate the takedown and pivot pins and the inside parts of the lower receiver assembly.

## 13.5 LONG TERM STORAGE

Clean your firearm well and apply a good quality preservative.

It is at least theoretically possible for some springs to take a set during prolonged storage. To preclude this possibility, ArmaLite offers the following recommendations regarding long term storage of your firearm.



**WARNING: FOLLOW ALL OF THE RULES OF SAFE GUN HANDLING ANYTIME YOU HANDLE A FIREARM.**

Clear all cartridges from your firearm. Remove the magazine. Then pull back the charging handle and visually confirm that the chamber is empty and that there is no cartridge held to the bolt face by the extractor. Then check it again. Then dry fire the firearm to allow the hammer to rotate to the fired position.

When you're taking your firearm out of long-term storage, remove the preservative and lubricate as stated elsewhere in this manual.

## FUNCTIONAL CHECK

1. Pull the charging handle to the rear and then manually return it forward while depressing the lower part of the bolt stop. The bolt should remain to the rear against the bolt stop. Remove the magazine. Press in on the bolt stop. The bolt carrier assembly should be propelled forward by the operating spring.



A2996

2. Place the safety on "SAFE". Squeeze the trigger. *The trigger should not fall.*

3. Place the safety on "FIRE". Squeeze the trigger and hold the trigger to the rear; *the hammer should fall.* Pull the charging handle to the rear and release it. Release the trigger. *You should hear a click as you release the trigger.* Squeeze again; *the hammer should fall.*



A3009a



**CALL ARMALITE® AT (623)780-1050 BEFORE FIRING IF YOUR FIREARM FAILS THIS FUNCTION TEST.**



## 14. TROUBLESHOOTING

<b><u>PROBLEM</u></b>	<b><u>CHECK FOR</u></b>	<b><u>WHAT TO DO</u></b>
WON'T FIRE	Selector lever on "SAFE"	Put it on "FIRE".
	Improper assembly of firing pin	Assemble correctly. NOTE: the retaining pin goes in back of large shoulder of firing pin.
	Oil or fouling in bolt	Clean with pipe cleaner.
	Defective ammunition	Remove and discard.
	Too much carbon on firing pin	Clean.
	Bolt not fully locked.	Extract cartridge, clean area.
WON'T EXTRACT	Broken extractor spring	Replace.
	Inner spring or reinforcement ring missing from extractor spring	Replace.
	Dirty, corroded, or reloaded ammunition	Remove and discard.
	Carbon in chamber	Clean chamber.
	Frozen or worn extractor	Remove and clean.
	Restricted buffer assembly	Remove and clean.
	Restricted movement of bolt carrier	Remove, clean and lubricate.
WON'T FEED	Short recoil	See below.
	Dirty, corroded, or reloaded ammunition	Remove and discard.
	Dirty or defective magazine	Clean and lubricate or replace.

## **TROUBLESHOOTING (CONTINUED)**

<b><u>PROBLEM</u></b>	<b><u>CHECK FOR</u></b>	<b><u>WHAT TO DO</u></b>
	Too many rounds in magazine	Remove excess rounds.
	Buffer assembly is restricted	Take out and clean buffer and spring.
	Short recoil	See below.
DOUBLE FEED	Defective magazine	Replace.
WON'T CHAMBER	Dirty corroded or defective ammunition.	Remove and discard.
SHORT RECOIL	Weak or reloaded ammunition	Replace
	Dirty Action	Clean.
	Improper lubrication	Lubricate generously.
SELECTOR LEVER BINDS	Needs oil	Lubricate.
	Dirt or sand under trigger.	Clean.

## 15. WARRANTY, SERVICE, AND SUGGESTIONS

Specific warranty provisions for your ArmaLite® firearm are shown on the warranty card shipped with your new firearm. Be sure to complete your warranty card and return it to ArmaLite®.

If no warranty card and sales receipt are on file, all work will be billed at shop rates. Custom work will be billed at ArmaLite®'s shop rates, as will work on firearms submitted with no warranty problem existing. Shipping to and from ArmaLite® is the owner's responsibility, except that ARMALITE® will return the firearm to the customer shipping prepaid if the return was covered under warranty.

Returns for any reason will NOT be accepted without a Return Merchandise Authorization (RMA) number issued by ArmaLite. Please call 1-800-401-7369 to receive your RMA number. After you receive your RMA number, print it on the outside of the box and include a short note in the box. The note should include the RMA number, your name, address, email, phone number, the model and serial number of the firearm you're returning, and a detailed explanation of the problems that you're having with the firearm. If you wish to put your note on our RMA form, you can print out our RMA form by clicking on the link in the Policies or Contact Us sections of our website.

Remove any accessories (scope, scope mount, sling, bipod, cleaning equipment, etc) that don't pertain to your problems before you send the firearm in. If you have any functional problem with the firearm, do send the magazines with it.

Firearms that you wish to return for warranty or out-of-warranty repair may be returned directly to ArmaLite. Before seeking warranty service: use the troubleshooting guide in this Operator's Manual to attempt to solve the problem, perform all instructed maintenance, and assure that ammunition and magazines are correct and in good condition. **Shop rates plus the cost of return shipping will be applied if no covered defect is found.**

Include a note explaining, in as much detail as possible, the nature of the problem or service needed. The note should include the RMA number, your name, address, email, phone number, and the reason for return. If you wish to put your note on our RMA form, you can print out our RMA form found in the "Contact Us" and "Policies" sections of our website (www.ArmaLite.com). Keep your shipping receipt and the serial number of the firearm for your records in case of loss in shipment.



**WARNING: MAKE ABSOLUTELY SURE THAT THE FIREARM IS UNLOADED!!! BELIEVE IT OR NOT, WE SOMETIMES GET FIREARMS BACK THAT ARE LOADED!!!**



**WARNING: NEVER SHIP LIVE AMMUNITION WITH ANY FIREARM THAT YOU ARE RETURNING TO ARMALITE® FOR SERVICE.**





**WARNING: IT IS THE OWNER'S RESPONSIBILITY TO ASSURE THAT ANY PARTS THAT ARE PURCHASED FROM ARMALITE® ARE CORRECTLY FITTED AND INSTALLED. IMPROPER FITTING OR INSTALLATION MAY RESULT IN INJURY, DEATH, OR DAMAGE/MALFUNCTION OF THE FIREARM.**

To answer any questions you may have about the firearm, or to offer suggestions for improvements, please contact us at:

**ArmaLite, Inc**  
**525 E Pinnacle Peak Rd**  
**Suite 100**  
**Phoenix, AZ 85024**

**Phone: 1-800-401-7369 or 623-780-1050**

**Fax: 623-780-2967**

**Email: [info@ArmaLite.com](mailto:info@ArmaLite.com)**

## **PATENTS & TRADEMARKS**

“ArmaLite®”, “AR-10®”, and “SPR®”, are registered trademarks of ArmaLite, Inc.

“M-15™”, “AR-30™”, “AR-50™”, and other model variants are trademarks of ArmaLite, Inc.

The AR-10® Series Rifles and Carbines (including the SuperSASS™) are protected by U.S. Patents 5,638, 626 and 5,911,173 and 6,044,748.

The M-15™ Series Rifles and Carbines are protected by U.S. Patents 5,911, 173 and 6,044,748.

The AR-30™ and AR-50™ Series Rifles are protected by U.S. Patents 6,487,805 and 6,637,142.

The AR-23 Subcaliber Device for the Mk-19 Grenade Machine Gun is protected by U.S. Patents 5,983,772 and 6,202,533.

The Blank Firing Adapter for the Mk-19 Grenade Machine Gun is protected by U.S. Patent 5,438,907.

Other patents granted or assigned to ArmaLite include:

Weapons Operating System, U.S. Patent 6,591,535

Cartridge for a Firearm, U.S. Patents 6,367,389 and 6,959,647 and 6,976,431 and 7,458,332

Light Weight Weapon Operating System and Cartridge Feed, U.S. Patent 6,591,535