

8-2055-4

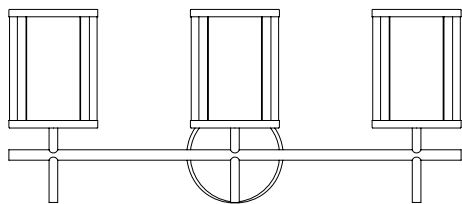

8-2055-3

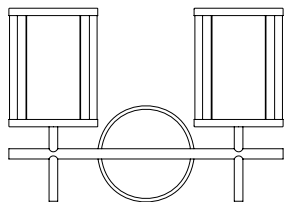

8-2055-2

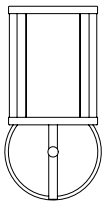

9-2055-1

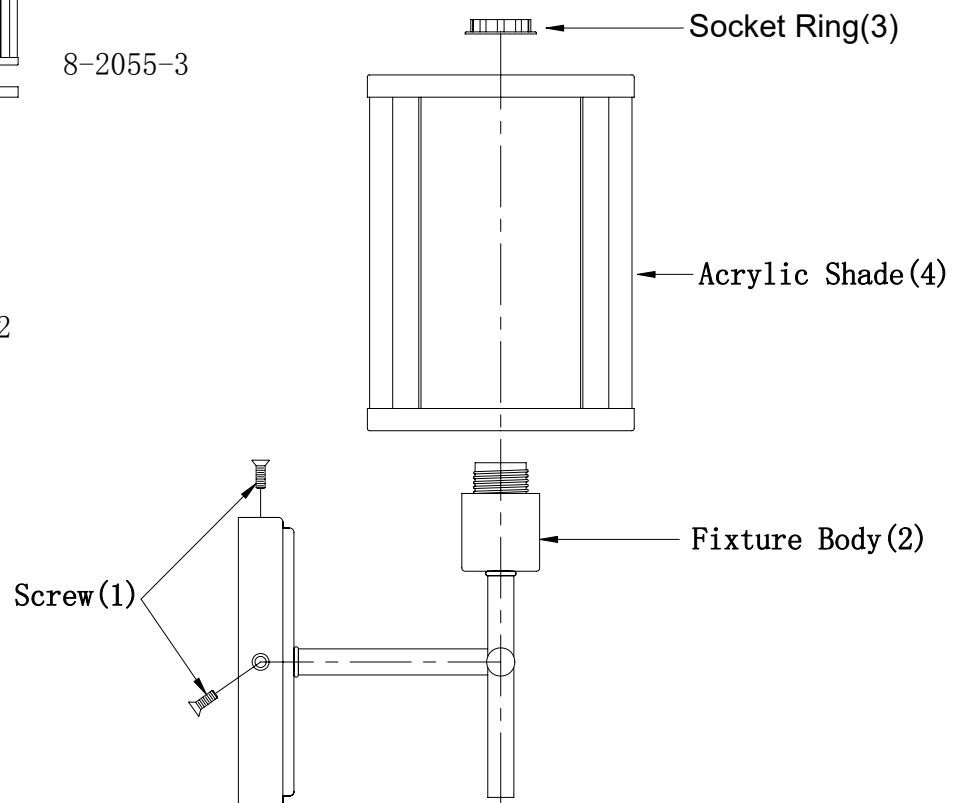

## ASSEMBLY INSTRUCTIONS

- 1 Carefully unpack and identify all parts referring to illustration for parts identification.
- 2 Turn the power to the installation point OFF.
- 3 Install the acrylic shade (4) onto the fixture body (2) securing with the socket ring (3).
- 4 Refer to the additional installation instructions included with the product for wiring and installation.
- 5 Install proper bulbs (not included) into each socket referring to the markings and/or labels on the fixture for maximum wattage.
- 6 Restore power to the installation point and retain this sheet for future reference.