

Parts Included:

Mounting Bracket

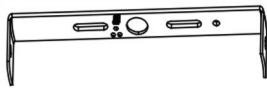

Outlet Box screw



Wire Connector

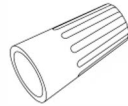

Mounting Screw



CSA / UL Safety Requirements

CSA/UL requires that these IMPORTANT SAFETY INSTRUCTION be listed:

- ☐ Before starting installation of this fixture or removal of a previous fixture, disconnect the power by turning off the circuit breaker or by removing the fuse at the fuse box.

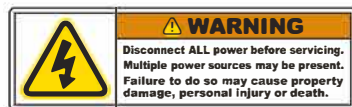

- ☐ Consult a qualified electrician if you have any electrical questions or need to replace the driver.

Care Instructions

Arnsberg suggests using only a micro fiber cleaning cloth to clean this fixture. If required, a slightly damp cleaning cloth may be used to spot clean. Do not use common household cleaners on this fixture, as the final finish may be damaged as a result. Enjoy your new Arnsberg fixture.

Mounting Instructions

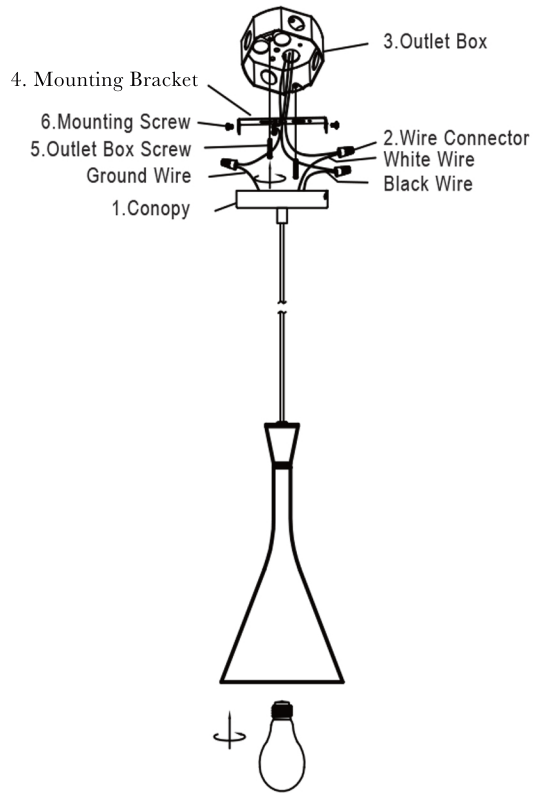

ASSEMBLY INSTRUCTIONS

RODDIK

301190178

Assembly Instructions

1. Turn off the power to the outlet by switching the breaker in the electrical panel to off.
2. Screw the two mounting screws (#1) into the mounting bracket (#2). Mount the mounting bracket (#2) to the outlet box (#3) using the two mounting screws. Make sure the heads of the mounting screws (#6) are facing outside when the mounting bracket (#2) is attached to the outlet box (#3).
3. Connect the ground wire from the fixture to the ground wire from the outlet box (#3). Connect the white wire from the fixture to the white wire (neutral wire) from the outlet box (#3). Connect the black wire from the fixture to the black wire (live wire) from the outlet box (#3). Cover the connections using the wire connectors (#4). Wrap the wire connections with electrical tape for a more secure connection. Position the wires back inside the outlet box (#3). Note: If you have electrical questions, consult your local electrical code for approved grounding methods.
4. Place the canopy (#5) over the mounting bracket. Attach the screws (#6) to secure the canopy.
5. Installation is complete. Turn on the power at the circuit breaker or fuse box. Turn the light switch on to activate the fixture.