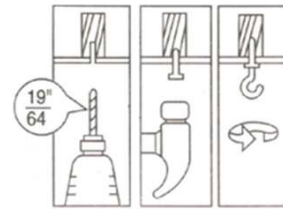
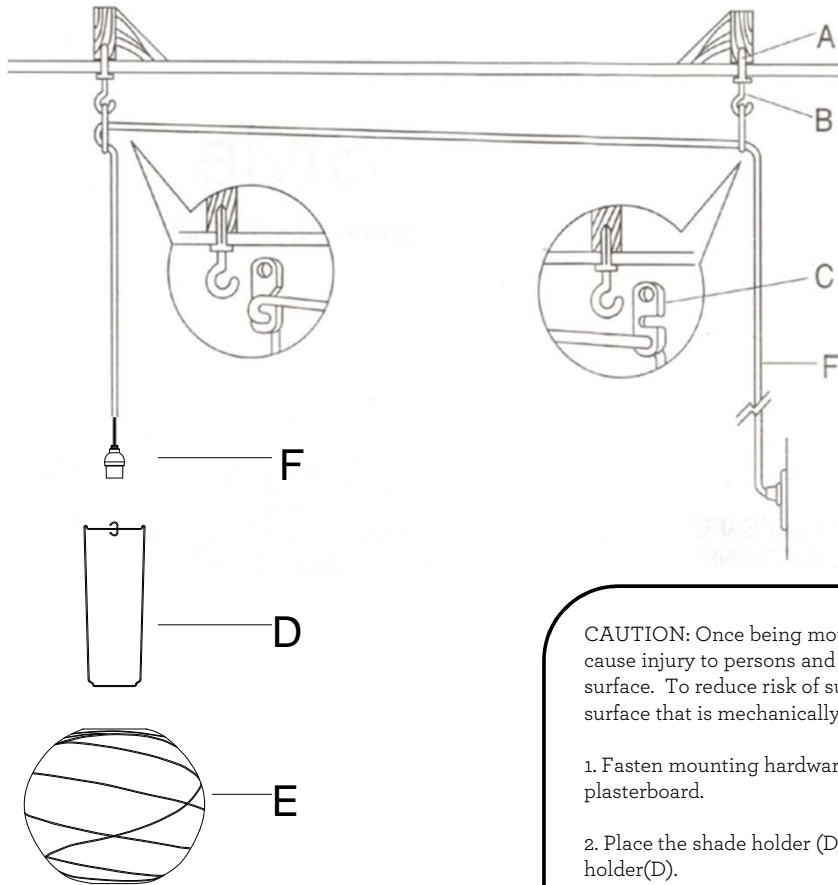

ORB PENDANT

Model#4160-12/ 4161-12 / 4162-12

**NOTE:**

For mounting to a solid ceiling, screw hooks directly to the ceiling.

CAUTION: Once being mounted, do not pull on lamp as this may cause injury to persons and damage to the lamp and mounting surface. To reduce risk of such injury or damage, mount on a surface that is mechanically solid.

1. Fasten mounting hardware to wooden ceiling support beams only. Do not mount to plasterboard.
2. Place the shade holder (D) through the socket of the wire (F), then insert shade(E) onto shade holder(D).

WARNING: Do not use cord in wet conditions.

PARTS DIAGRAM

- (2) * Screw Anchors(A)
- (2) *Screws (B)
- (2) *Hangers (C)
- (1) *Shade holder(D)