

# ASSEMBLY INSTRUCTIONS FOR Hubble LED Pendant

3684-22 1.0

Model # 3684-22

1.

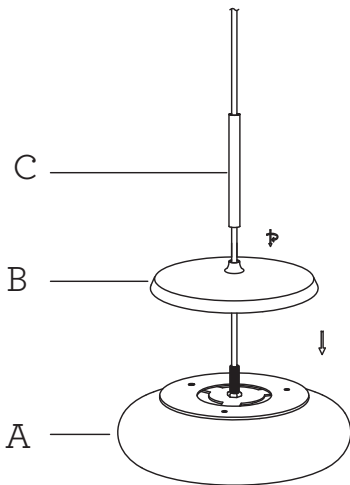

2.

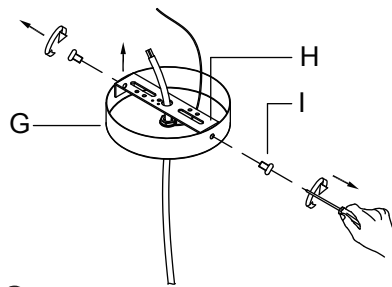

3.

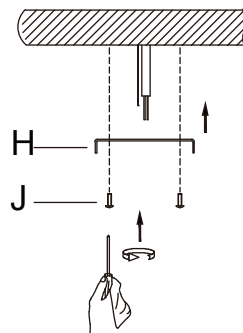

4.

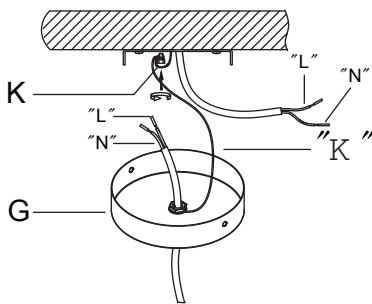

5.

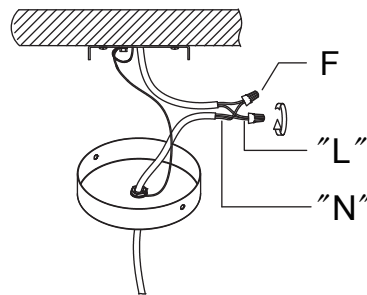

6.

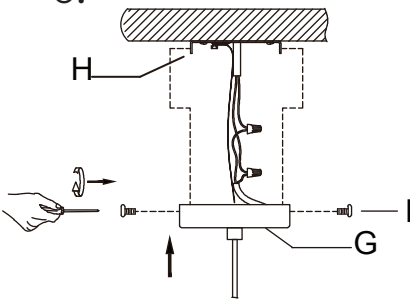

7.

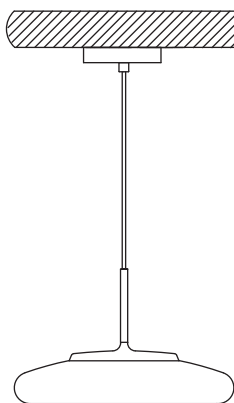

## BEFORE STARTING- SHUT OFF BREAKER AT MAIN DISCONNECT

Make sure all power is disconnected at existing fixture and that there are no live wires in the junction box. Not all junction boxes include simple wiring. If you are unsure or have doubts of electrical connection, call an electrician for assembly.

1. Remove all items from the packaging. Set metal plate (B) onto shade (A) with pole (C) clockwise to tighten.
2. Twist both ground wire in your home and in canopy to green screw (K). Fasten screw (K) to bracket to tighten. Remove 2 (I) screws from the canopy (G). Remove Bracket (H).
3. Find your ground wire, hot wire and neutral wire in your junction box and pull them through the central round hole of bracket. Fasten Bracket (H) into junction box with 2 screws (J) to tighten.
4. Twist both ground wire in your home and in canopy to green screw (K). Fasten screw (K) to bracket to tighten.
5. Attach the neutral fixture wire (N) from the pendant to the neutral wire in junction box (usually white). Attach the hot fixture wire (L) from the pendant to the hot wire in junction box (usually black). Cover the connected wires with part (F) - tighten each connection by turning clockwise.
6. Push up the canopy (G) to cover Bracket (H) properly and fasten with the 2 screws (I) separately to tighten.

## GENERAL PRODUCT INFORMATION:

This product is suitable for dry locations only.



LED: (1) 30 watt LED included.

## PARTS DIAGRAM:

- (2) Part (F)
- (2) Screws (J)

## Dimmer Recommended

Brand	Parts No.
Lutron	SKYLARK SELV-300P
Lutron	DIVA DVELV-300P
Leviton	lllumaTech IPE04

Assembly Instructions (English)

# ADESSO

21 Penn Plaza Suite 909 New York, NY 10001

Tel: (212) 736 4440 Fax: (212) 736 4806

www.adessohome.com