



325 COMMERCE DRIVE  
MT VERNON, OH 43050  
800-253-8236

## SPECIFICATION DATA SHEET

DATE: 8-5-13  
PREPARED BY: RL

# MODEL NO. 671

## END BOOT

SPECIAL MODEL W/ 1/4" HEM ON "B" DIM. & 3/4" SLITS IN CORNERS

### DIMENSIONS

SIZE							
A	B	C	D	E	F	G	H
2 1/4" x	10" x	5"	2 1/2" 2"-HEM	12 7/8"	7 11/16"	4 3/16"	
2 1/4" x	12" x	6"	2 1/2" 2"-HEM	14 3/4"	9"	4 1/2"	
4" x	10" x	5"	2 1/2" 2"-HEM	13 3/4"	8 9/16"	5 3/16"	
4" x	10" x	6"	2 1/2" 2"-HEM	13"	8 9/16"	4 1/2"	
4" x	10" x	7"	2 1/2" 2"-HEM	12 7/8"	9 7/8"	4 1/2"	
4" x	10" x	8"	2 1/2" 2"-HEM	13 1/8"	11"	4 1/2"	
4" x	12" x	6"	2 1/2" 2"-HEM	14 3/4"	9"	4 1/2"	
4" x	12" x	7"	2 1/2" 2"-HEM	14 7/8"	9 7/8"	4 1/2"	
4" x	12" x	8"	2 1/2" 2"-HEM	14 7/8"	11"	4 1/2"	
6" x	10" x	6"	2 1/2" 2"-HEM	13 1/4"	8 5/8"	4 1/2"	
6" x	10" x	7"	2 1/2" 2"-HEM	13 1/4"	9 9/16"	4 1/2"	
6" x	12" x	6"	2 1/2" 2"-HEM	15 1/4"	8 5/8"	4 1/2"	
6" x	12" x	7"	2 1/2" 2"-HEM	15 1/4"	9 9/16"	4 1/2"	
6" x	12" x	8"	2 1/2" 2"-HEM	15 3/4"	10 5/8"	5"	
6" x	14" x	8"	2 1/2" 2"-HEM	17 3/4"	10 5/8"	5"	

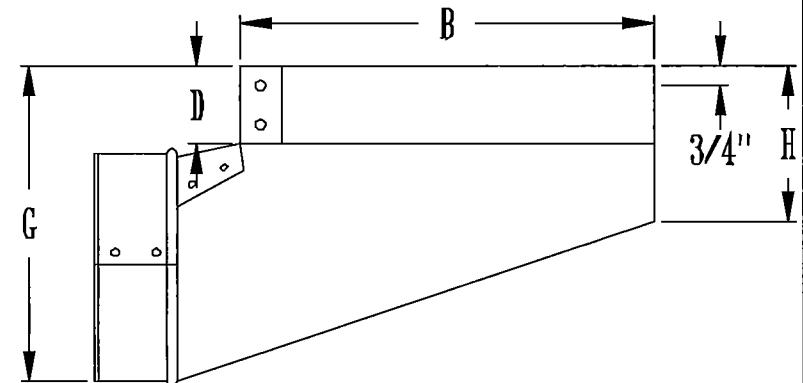
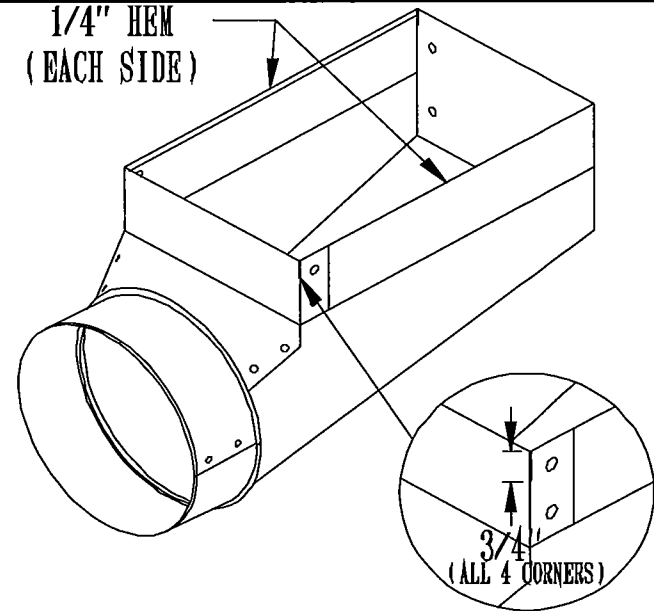
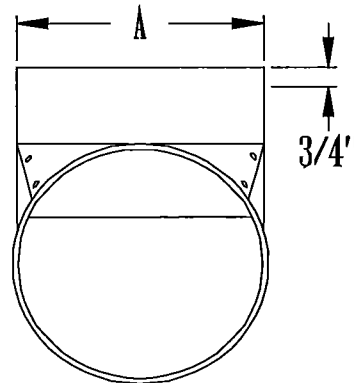
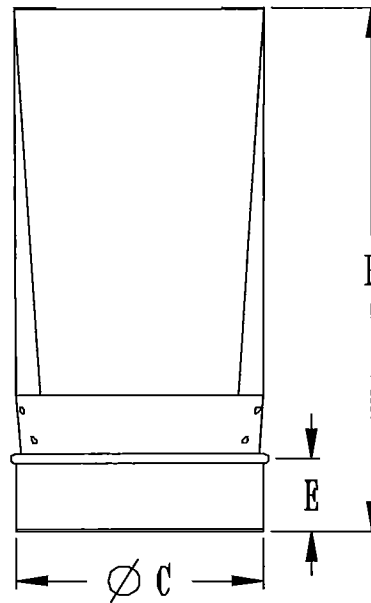

### SPECIFICATIONS

HOT DIPPED GALVANIZED STEEL.  
PER ASTM A 653 CSB.

BODY & COLLAR = 4"-8" COLLAR SIZE: STD GAUGE  
9" - 10" COLLAR SIZE: 28 GAUGE

ASSEMBLED WITH 1/8" ZINC COATED RIVETS.

### OPTIONS

JOB: \_\_\_\_\_  
LOCATION: \_\_\_\_\_  
CONTRACTOR: \_\_\_\_\_  
ENGINEER: \_\_\_\_\_  
NOTES: \_\_\_\_\_