



325 COMMERCE DRIVE  
MT VERNON, OH 43050  
800-253-8236

## SPECIFICATION DATA SHEET

DATE: 5-10-13  
PREPARED BY: RL

## MODEL NO. 124 STARTING COLLAR

STANDARD MODEL

### DIMENSIONS

| SIZE | A   | *B |
|------|-----|----|
| 4"   | 4"  | 4" |
| 5"   | 5"  | 4" |
| 6"   | 6"  | 4" |
| 7"   | 7"  | 4" |
| 8"   | 8"  | 4" |
| 9"   | 9"  | 4" |
| 10"  | 10" | 4" |
| 12"  | 12" | 4" |
| 14"  | 14" | 4" |
| 16"  | 16" | 4" |
| 18"  | 18" | 4" |
| 20"  | 20" | 4" |

\*BODY LENGTH - NOT INCLUDING TABS.

### MATERIAL SPECIFICATIONS

HOT DIPPED GALVANIZED STEEL.  
PER ASTM A 653 CSB.

4"-8" STD GA  
9"-18" 28GA  
20" 26GA

OTHER GAUGES AVAILABLE.

ASSEMBLED WITH 1/8" ZINC COATED RIVETS.

### OPTIONS

AVAILABLE WITH DAMPER HOLES

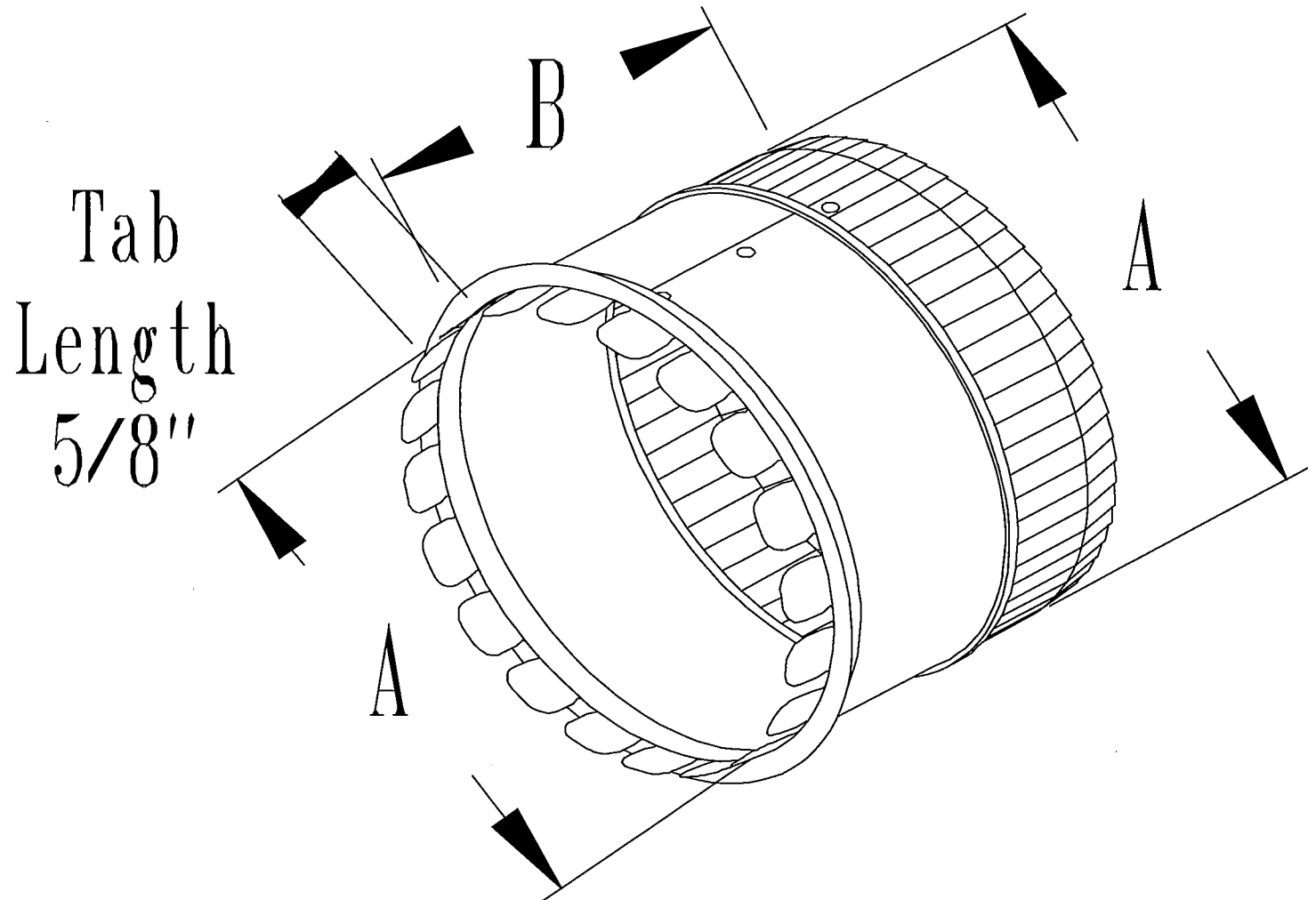

JOB: \_\_\_\_\_  
LOCATION: \_\_\_\_\_  
CONTRACTOR: \_\_\_\_\_  
ENGINEER: \_\_\_\_\_  
NOTES: \_\_\_\_\_