



# Lead Free\*

## 77CLF SERIES

### Bronze Full Port Ball Valve

Job Name:	Contractor:
Job Location:	P.O. Number:
Engineer:	Representative:
Tag:	Wholesale Distributor:

#### DESCRIPTION

The Apollo® 77CLF "Contractor Series" 2 piece ball valve features a de-zincification resistant, **Lead Free\*** bronze body, premium "multi-fill" MPTFE seats and stem packing, and a **Lead Free\*** "Solid Ball" design that delivers true full-port flow performance. Cast and machined in Apollo's South Carolina manufacturing plants using proven **Lead Free\*** materials.

#### FEATURES

- **Lead Free\*** Brass & Bronze Materials
- ANSI/NSF 61 Section 8, Annex F & G
- Easily Identifiable Blue "**Lead Free**" Hang Tag
- Multi-Fill PTFE Seats & Seals.
- Manufactured and 100% Factory Tested in the USA

#### PERFORMANCE RATING

- Maximum Pressure: 600 psi CWP, 150 SWP
- Maximum Temperature: 500°F
- Vacuum service to 29 in. Hg

#### MODELS

- ☐ 77CLF100/200 Series      Standard Trim  
☐ 77CLF140/240 Series      316 SS Ball & Stem

#### MATERIAL SPECIFICATION

Part Name	Material
Gland	B16 Brass
Nut	Zinc Plated Steel
Packing	MPTFE
Seat	MPTFE
Stem	C27451 <b>Lead Free*</b> Brass
Ball	C27451 <b>Lead Free*</b> Brass Cr. Plated
Retainer	C27451 <b>Lead Free*</b> Brass (1/4"-1/2")
	B584-C89836 <b>Lead Free*</b> Bronze (3/4"-2 1/2")
Body	B584-C89836 <b>Lead Free*</b> Bronze
Handle	Zinc Plated Steel w/ Vinyl Grip

#### OPTIONS

- ☐ (-01) Standard  
☐ (-04) 2 1/4" Stem Extension  
☐ (-07) Tee Handle  
☐ (-10) S.S. Handle and Nut  
☐ (-11) Thermo-Seal™ Insulating Tee Handle  
☐ (-27) Locking Handle  
☐ (-92) Standard lever with Balancing Stop  
☐ (-94) 2 1/4" Stem Extension with Balancing Stop

\* **LEAD FREE:** The wetted surfaces of this product shall contain no more than 0.25% lead by weighted average. Complies with CA AB1953, VT Act 193, MD HB372, LA HB471 and Federal Public Law 111-380.



#### DIMENSIONS

Part #	Size (in.)	Dimensions (in.)								Wt.*** (lbs.)
		A	B	C	D	E	F	G	Cv	
NPT										
77CLF10101	1/4"	0.37	0.95	1.97	1.76	3.74	-	-	4.5	0.6
77CLF10201	3/8"	0.37	1.07	2.09	1.76	3.74	-	-	7.2	0.6
77CLF10301	1/2"	0.50	1.15	2.25	1.79	3.74	-	-	15.5	0.6
77CLF10401	3/4"	0.75	1.32	2.65	2.00	4.88	-	-	35.6	1.1
77CLF10501	1"	1.00	1.53	3.07	2.19	4.88	-	-	68.1	1.8
77CLF10601	1-1/4"	1.25	2.04	4.08	3.13	7.06	-	-	125.0	4.4
77CLF10701	1-1/2"	1.50	2.12	4.23	3.29	7.06	-	-	177.0	4.6
77CLF10801	2"	2.00	2.43	4.85	3.83	7.06	-	-	389.0	7.9
77CLF10901	2-1/2"	2.50	3.12	6.37	4.51	8.06			503.0	16.2
SOLDER										
77CLF20201	3/8"	0.37	1.30	2.21	1.76	3.74	0.41	0.50	7.2	0.6
77CLF20301	1/2"	0.50	1.41	2.56	1.76	3.74	0.50	0.63	15.5	0.6
77CLF20401	3/4"	0.75	1.64	3.03	2.00	4.88	0.75	0.88	35.6	1.0
77CLF20501	1"	1.00	1.92	3.61	2.19	4.88	0.90	1.13	68.1	1.6
77CLF20601	1-1/4"	1.25	2.36	4.44	3.13	7.06	0.97	1.38	125.0	3.9
77CLF20701	1-1/2"	1.50	2.63	4.89	3.29	7.06	1.09	1.63	177.0	4.3
77CLF20801	2"	2.00	3.17	6.06	3.83	7.06	1.34	2.13	389.0	7.6
77CLF20901	2-1/2"	2.50	3.77	7.14	4.51	8.06	1.43	2.63	503.0	15.9

\*\*\* Weights based on Standard Configuration

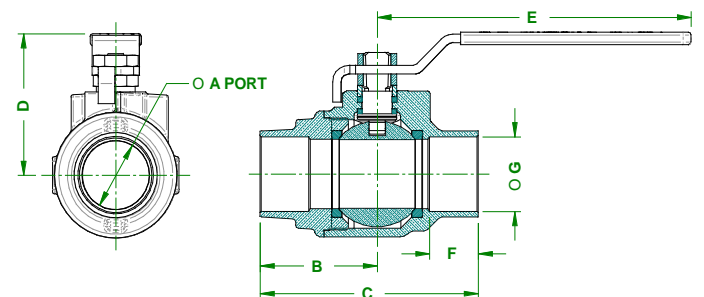

#### APPROVALS

- MSS SP-110; Ball Valves
- ANSI/NSF 61 Section 8, Annex F & G
- NSF 372 Drinking Water System Components
- ANSI 3<sup>rd</sup> Party Approval to 0.25% Lead Max.
- CSA B51 CRN: OC10908.5C
- IAPMO R&T / UPC - IGC 157
- City of Los Angeles DBS