



EVENT HOST CONTACTS

Larry Grundy
(860) 334-2095
rbgyguy@yahoo.com

Andrew Lefebvre (Director)
(860) 810-6899
alefebvre@groton.k12.ct.us

USBANDS CONTACTS

Mike Trehey
(484)-387-1136
mtrehey@usbands.org

Carissa Bryant
cbryant@yea.org

Robert E. Fitch High School
October 19, 2019**Contact:** Larry Grundy**Location:** Robert E. Fitch High School
101 Groton Long Point Road
Groton CT 06340**Schedule (Performance times are subject to change)**

Performance Class	Unit/Director	Location
12:55 PM	**All times approximate and subject to change**	
12:55 PM	ANNOUNCEMENTS/NATIONAL ANTHEM	
1:00 PM	Group II A Rockville High School (CT) Laura Ayer	Vernon CT
1:15 PM	Group II A Rocky Hill High School James Shuman	Rocky Hill CT
1:30 PM	Group II A East Lyme High School Angelica Fadrowski	East Lyme CT
1:45 PM	Group II A East Haven High School Co-op Marching Band Matt Laudano	East Haven CT
2:00 PM	Group III A Plainfield High School (CT) James Flynn	Central Village CT
2:15 PM	Group III A Westerly High School Sarah Ferry	Westerly RI
2:30 PM	INTERMISSION	
3:00 PM	Group I Open Joseph Case High School Richard Cordeiro	Swansea MA
3:15 PM	Group IV Open Norwich Free Academy Kristen Motola	Norwich CT
3:30 PM	Group IV Open Newtown High School Kurt Eckhardt	Sandy Hook CT
3:45 PM	Group III Open Robert E. Fitch High School Andrew Lefebvre	Groton CT
4:00 PM	Exhibition U.S. Coast Guard Academy Windjammers Drum & Bugle Corps	New London CT
4:15 PM	AWARDS	

Robert E. Fitch High School
October 19, 2019**Contact:** Larry Grundy**Location:** Robert E. Fitch High School
101 Groton Long Point Road
Groton CT 06340**Adjudicators**

Media: Digital

Position	Name
Fall 0.1 Chief Adjudicator	Thomas Beresford (Poughquag, NY)
Fall 1.1 - Individual Music 1	Steven Fasoli (Trumbull, CT)
Fall 2.1 - Ensemble Music 1	Joseph Guimaraes (Statham, GA)
Fall 3.1 - Visual 1	Antoine Blalark (Revere, MA)
Fall 4.1 - Overall Effect	Thomas Beresford (Poughquag, NY)
Fall 5.1 - Color Guard 1	Dana Saccomano (Vernon, CT)
Fall 6.1 - Percussion 1	Brian Ballard (Waterford, NY)

Staff

Position	Name
1.1 - Event Coordinator 1	James O'Neil (Thomaston, CT)
2.1 - Assistant Event Coordinator 1	Silas Holden (Pawcatuck, CT)
3.1 - Tabulator 1	Allison Chamberlin (Boston, MA)

**Robert E. Fitch High School
October 19, 2019**

Contact: Larry Grundy

Location: Robert E. Fitch High School
101 Groton Long Point Road
Groton CT 06340



Directions

Directions

1. From Points South:

- * Go north on I-95 North
- * Take the CT-117 exit, EXIT 88, toward Noank/Groton Long Point
- * Turn right onto North Road / CT-117 and follow to the end (approx. 1 mile).
- * Turn left onto Fort Hill Road / US-1 North (Henny Penny Convenience Store is on the left)
- * Nearing the top of Fort Hill bear to the right onto Groton Long Point Road / CT-215
- * Approximately 0.2 miles Fitch High School Entrance will be on the right

2. From Points North:

- * Go South on I-95 South
- * Take the CT-117 exit, EXIT 88, toward Downtown Groton
- * Turn left onto North Road / CT-117 and follow to the end (approx. 1 mile).
- * Turn left onto Fort Hill Road / US-1 North (Henny Penny Convenience Store is on the left)
- * Nearing the top of Fort Hill bear to the right onto Groton Long Point Road / CT-215
- * Approximately 0.2 miles Fitch High School Entrance will be on the right

Venue Notes

Providence TF Green (PVD) 47 Miles, 50 Minutes North
Hartford Airport (BDL) 66 Miles, 75 Minutes South

Parking: Buses will park in the front lot of the school and equipment trucks will park and unload behind the gym. Spectators will park in the student lot that is to the right of the school. Note: Handicap parking is available at Fitch High School.

Restrooms: Upon arrival, band members may use the restrooms inside the school. Volunteers may use the restrooms in the field house at the stadium, or in the school building, depending upon the volunteer's assignment. Spectators may use the restrooms in the field house at the stadium or portable toilets and hand washing stations.

Member Re-Entry: Band members' tour shirts or band uniforms/coats will allow them access to the stadium following their band's performance

Tickets: Tickets will be \$10 per person, and will include a program. Tickets can be purchased at the ticket booth or the path leading up to the stadium.

Warm Up: Bands will warm up in designated areas on the school campus (please refer to maps). There will be guides leading bands from location to location.

Field Surface: The field is grass, and will have high school hashes present. Upon entering the field, there is a large drive-through gate with a slight slope. Bands will encounter a slight downhill half way down to the field from the ensemble warm up area. This will be an uphill when returning to the pit trucks and buses.

Power on field: A power source will be located on the track near the 50 yard line.

Competition Suite: Adjudicator commentary for all USBands ensembles can be located in Competition Suite shortly after the conclusion of each ensemble's performance. Directors may grant access to the ensemble's portal with staff/instructors, and may request help from USBands representatives to resolve any issues accessing Competition Suite.

Retreat/Critique: For retreat, drum majors (or assigned student leaders) report to the end of the field closest to the field house near the flag pole following Fitch's performance. An announcement will be made over the public address system. Critique will be on stage with tables and chairs set up. Stage is directly across the side hall from the hospitality room.

Awards: Trophies will be given out. There will also be a most outstanding pit crew award given.

Concessions: Concessions will be at the outdoor concessions stand located at the end of the field near the stadium entrance.

Credentials/Access: Only band staff credentials in the hospitality room. Chaperones and pit crew must have a USBands credentials to re-enter the show. All other spectators will have to pay the admission fee.

Robert E. Fitch High School, Dorr Field

101 Groton Long Point Road
Groton, CT 06340

From Points South:

- * Go north on I-95 North
- * Take the CT-117 exit, EXIT 88, toward Noank/Groton Long Point
- * Turn right onto North Road / CT-117 and follow to the end (approx. 1 mile).
- * Turn left onto Fort Hill Road / US-1 North (Henny Penny Convenience Store is on the left)
- * Nearing the top of Fort Hill bear to the right onto Groton Long Point Road / CT-215
- * Approximately 0.2 miles Fitch High School Entrance will be on the right

From Points North:

- * Go South on I-95 South
- * Take the CT-117 exit, EXIT 88, toward Downtown Groton
- * Turn left onto North Road / CT-117 and follow to the end (approx. 1 mile).
- * Turn left onto Fort Hill Road / US-1 North (Henny Penny Convenience Store is on the left)
- * Nearing the top of Fort Hill bear to the right onto Groton Long Point Road / CT-215
- * Approximately 0.2 miles Fitch High School Entrance will be on the right

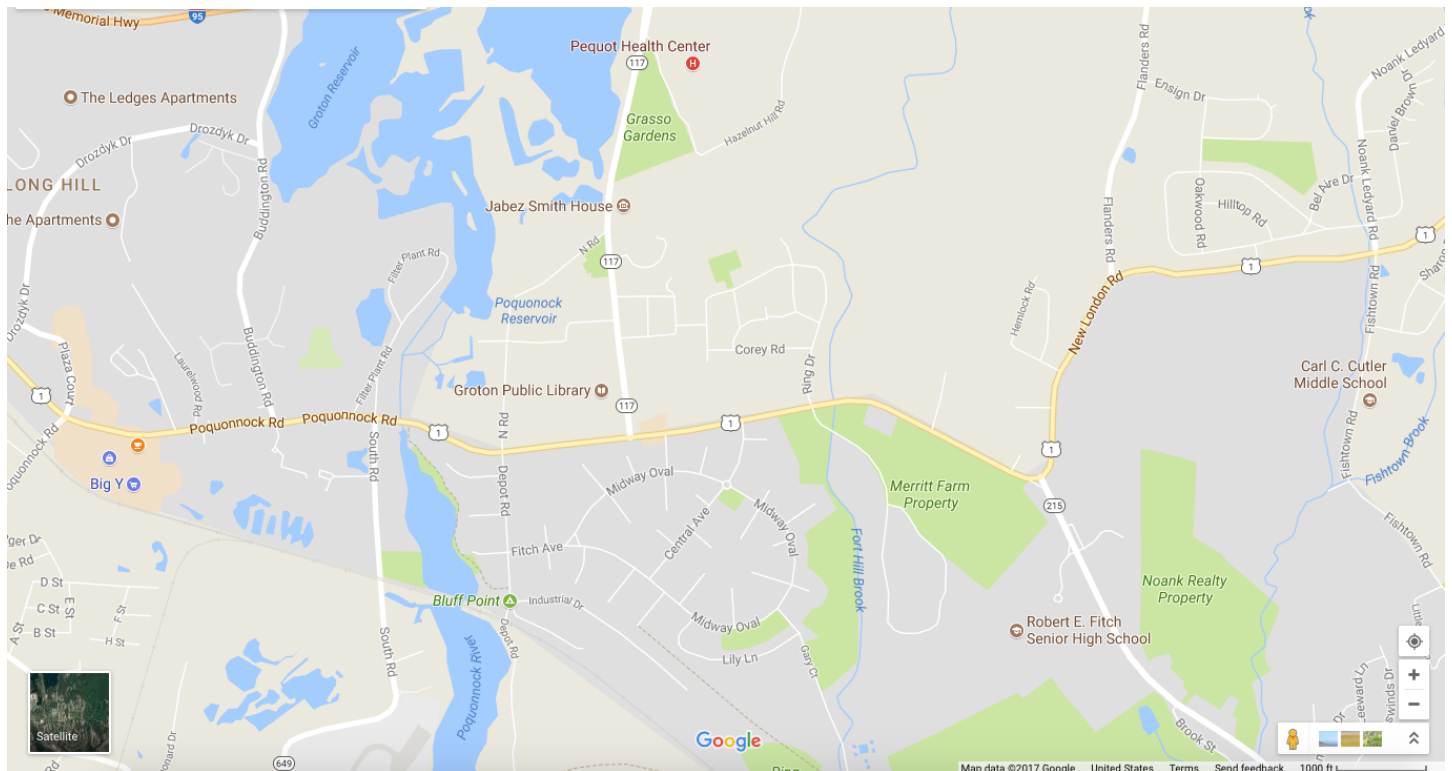



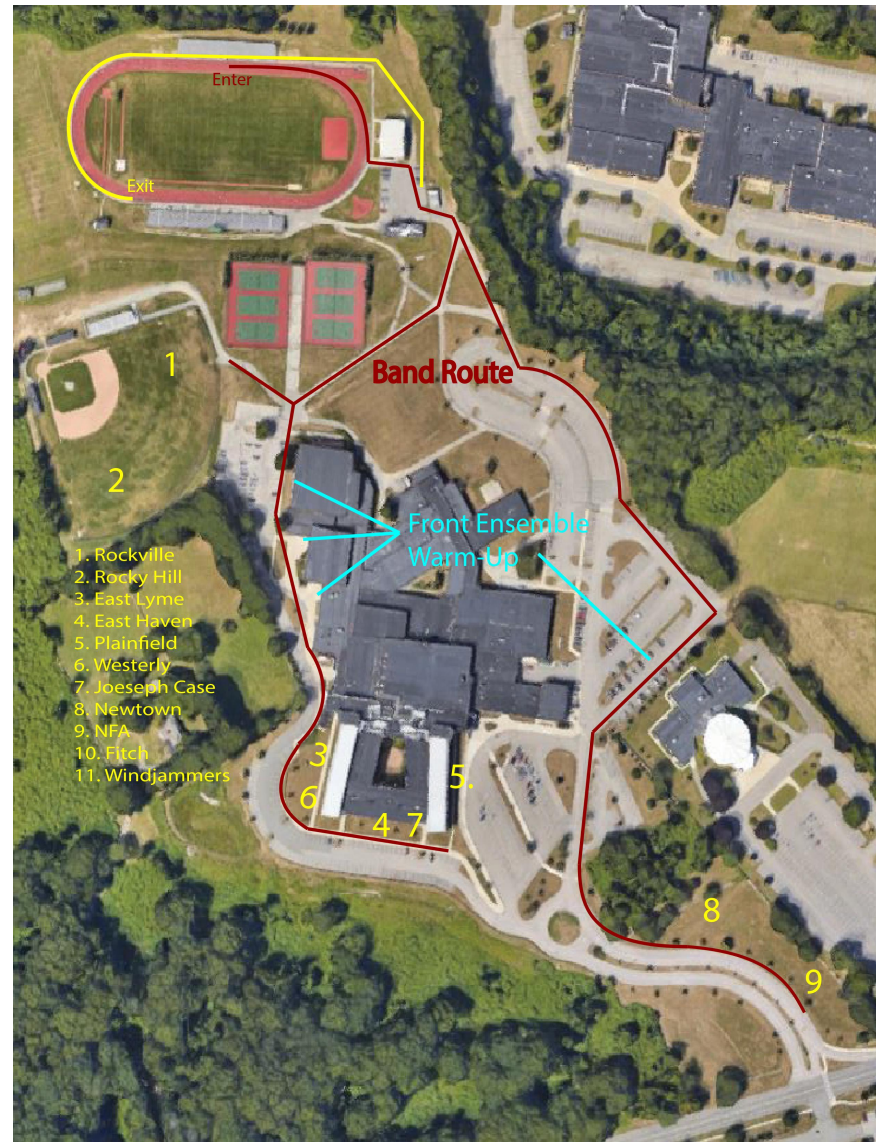

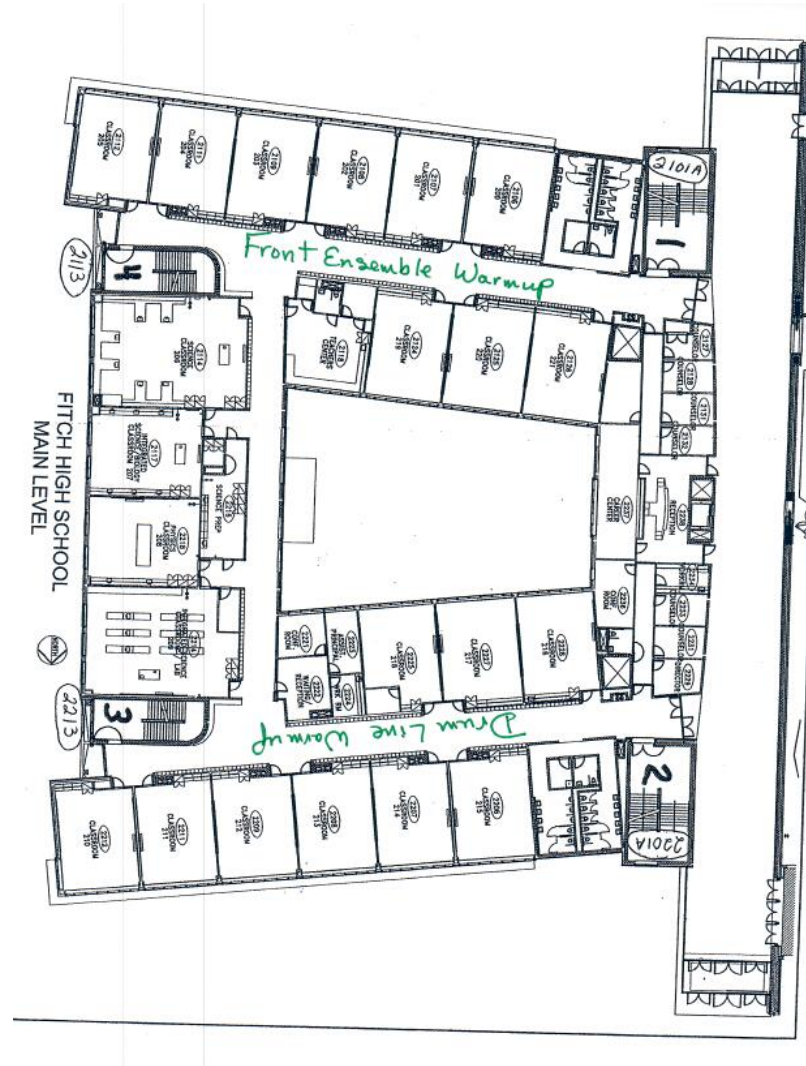

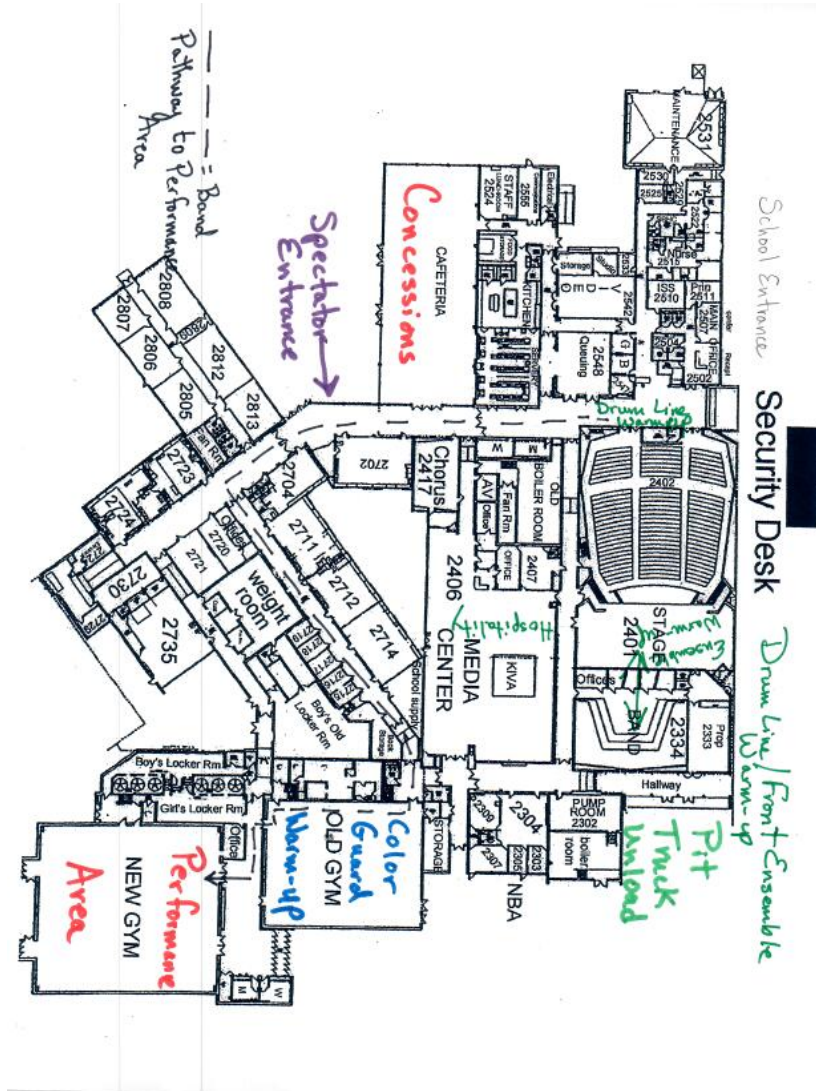

Parking: Buses will park in the front lot of the school and equipment trucks will park and unload behind the gym. Spectators will park in the student lot that is to the right of the school. Note: Handicap parking is available at Fitch High School

Restrooms: Restrooms in the school will be open and available to all show participants and spectators.

Member Re-Entry: Band members' tour shirts or band uniforms/coats will allow them access to the stadium following their band's performance

Tickets: Tickets are \$10 per person, and will include a program. Tickets can be purchased at the main entrance to the school.

Warm Up: Bands will warm up in designated areas in the building. There will be guides leading bands from location to location. Front ensembles will set up in the Art hallway.

Performance: Stand still performances (including Color Guard) will be in the large gym. The staging area will be located in the small gym across the hall from the large gym. Power will be available.

Competition Suite: Adjudicator commentary for all USBands ensembles can be located in Competition Suite shortly after the conclusion of each ensemble's performance. Directors may grant access to the ensemble's portal with staff/instructors, and may request help from USBands representatives to resolve any issues accessing Competition Suite.

Retreat/Critique: For retreat, drum majors (or assigned student leaders) report to the main hallway directly outside of the large gym. An announcement will be made over the public address system. Critique will be on stage with tables and chairs set up. Stage is directly across the side hall from the hospitality room.

Awards: Trophies will be given out. There will also be a most outstanding pit crew award given.

Concessions: Concessions will be located in the school cafeteria.

Credentials/Access: Only band staff credentials in the hospitality room. Chaperones and pit crew must have a USBands credentials to re-enter the show. All other spectators will have to pay the admission fee.