



Urbana High School

3471 Campus Drive

Ijamsville, MD 21754

Saturday, September 15th, 2018



EVENT HOST CONTACTS

Mike Harrison (Director)
(240) 236-7721
michael.harrison@fcps.org

Laura Schaefer
(240) 421-4351
lauraschaefer@hotmail.com

USBANDS CONTACTS

Mike Trehey
(484)-387-1136
mtrehey@usbands.org

Eric James
(484)-387-1142
ejames@usbands.org

Urbana High School
September 15, 2018

Contact: Mike Harrison
Location: Urbana High School
 3471 Campus Dr
 Ijamsville MD 21754

**Schedule (Performance times are subject to change)**

Performance	Class	Unit/Director	Location
5:00 PM	**THIS IS A PRELIMINARY SCHEDULE- SUBJECT TO CHANGE**		
6:00 PM	NATIONAL ANTHEM		
6:05 PM	Group II A	Middletown High School (MD) Matt Shearer	Middletown MD
6:20 PM	Group III A	Williamsport High School (MD) Lauren Bond	Williamsport MD
6:35 PM	Group III A	Thomas S. Wootton High School Susan Eckerle	Rockville MD
6:50 PM	Group III A	Century High School Stan Jones	Sykesville MD
7:05 PM	Group III Open	Oakdale High School Benjamin Zamostny	Ijamsville MD
7:20 PM	INTERMISSION		
7:50 PM	Group V Open	West Shore Marching Band Rob Starrett	Lewisberry PA
8:05 PM	Group VI Open	Westfield High School (VA) Alan Johnson	Chantilly VA
8:20 PM	Group VI Open	Freedom High School (VA) Joel Galway	South Riding VA
8:35 PM	Group IV Open	Urbana High School Mike Harrison	Ijamsville MD
8:50 PM	AWARDS		

Urbana High School
September 15, 2018

Contact: Mike Harrison
Location: Urbana High School
3471 Campus Dr
Ijamsville MD 21754

**Adjudicators**

Position	Name
Fall 1.1 Chief Adjudicator	
Fall 1.1 - Music Individual 1	Rachel Ewaniuk (Coopersburg, PA)
Fall 2.1 - Music Ensemble 1	Gretchen Shyne (Selkirk, NY)
Fall 3.1 - Visual Performance 1	Judy Ulchinsky (Branchville, NJ)
Fall 4.1 - Overall Effect 1	Sue Nicholson (Brandon, MS)
Fall 5.1 - Color Guard	Virginia Kraft (Washington Crossing, PA)
Fall 6.1 - Percussion	Kimberly Burja (Glen Ridge, NJ)

Staff

Position	Name
1.1 - Event Coordinator	Ben Regalado (Severna Park, MD)
2.1 - Assistant Event Coordinator	Laura Martinez (Germantown, MD)
3.1 - Tabulator	Alyson D'Alessandro (Limerick, PA)



IMPORTANT EVENT INFORMATION

Parking: Buses will park in front of the main entrance of the school. Spectators will park around the field hockey field near the stadium. There is no charge for parking

Restrooms: Restrooms will be open inside the auditorium entrance of the school and are located inside of the stadium

Member Re-Entry: Band members will be marked with a hand stamp and should enter the stadium through the main gate.

Tickets: Adults \$12.50, Students and Seniors \$10, Children 10 and under are free with a paying adult.

Warm Up: Warm up areas will be located in front of the main entrance and in front of the auditorium entrance. Ensembles will have an usher helping to travel between locations

Field Surface: Field surface is turf and is marked with high school hash marks

Power on field: A power source will be located on the field near the 50 yard line

Competition Suite: Adjudicator commentary for all USBands ensembles can be located in Competition Suite shortly after the conclusion of each ensemble's performance. Directors may grant access to the ensemble's portal with staff/instructors, and may request help from USBands representatives to resolve any issues accessing Competition Suite.

Retreat/Critique: Drum majors only, report to the center of the track. The critique will happen in the press box in the stadium

Awards: Trophies for each class will be awarded- first, second and third place as needed.

Souvenirs/Merchandise: Outside vendors may be on site for this event

Concessions: Outdoor concessions will be located inside the main entrance of the stadium and a smaller stand will be on the visitor side of the field. Candy and small snacks will be sold next to the Grams booth

Credentials/Access: Persons with USBANDS credentials can enter the critique areas. USBANDS staff can enter the hospitality area. Band members with hand stamps can enter the main gate.

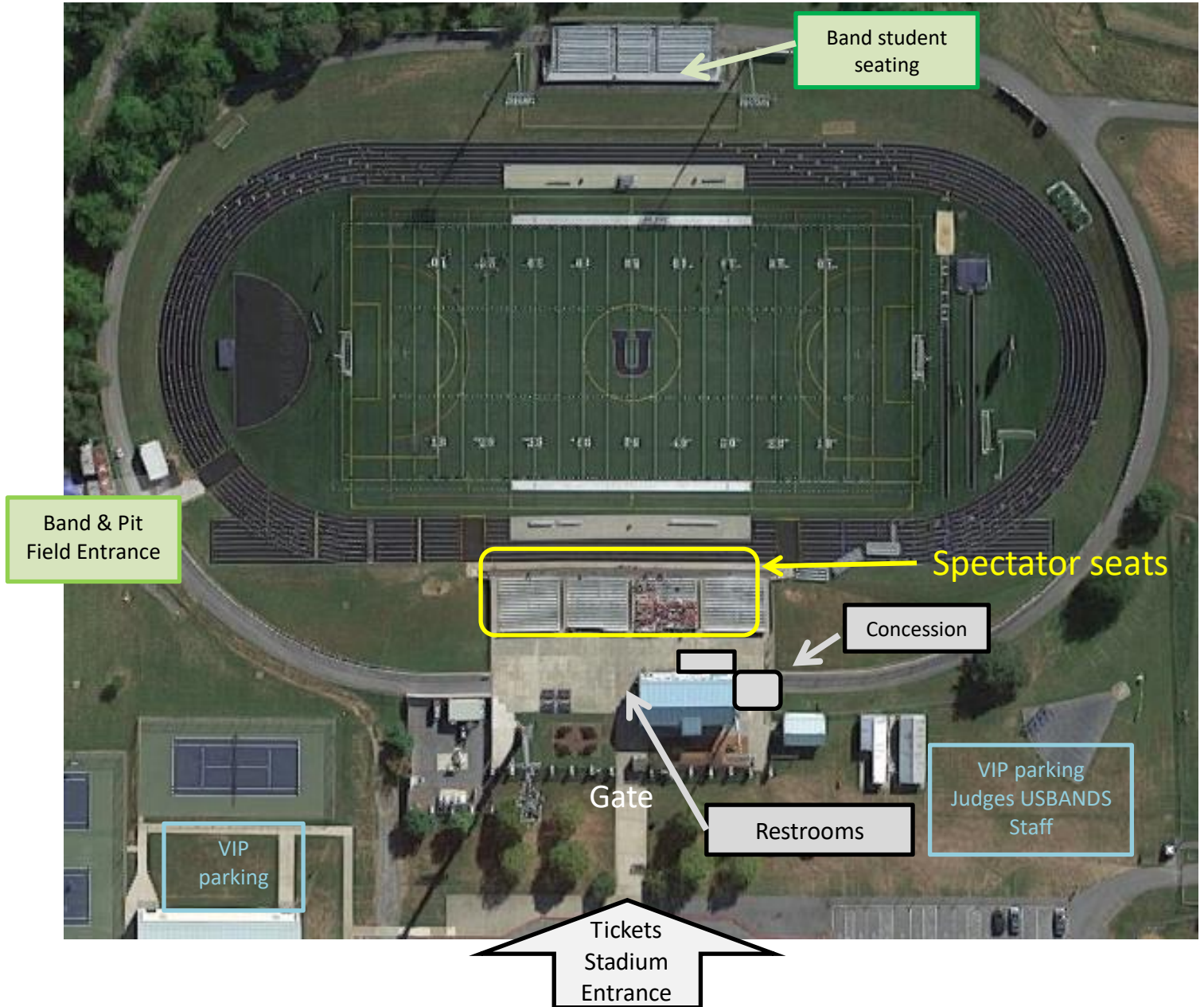

ENSEMBLE PARKING & WARMUP

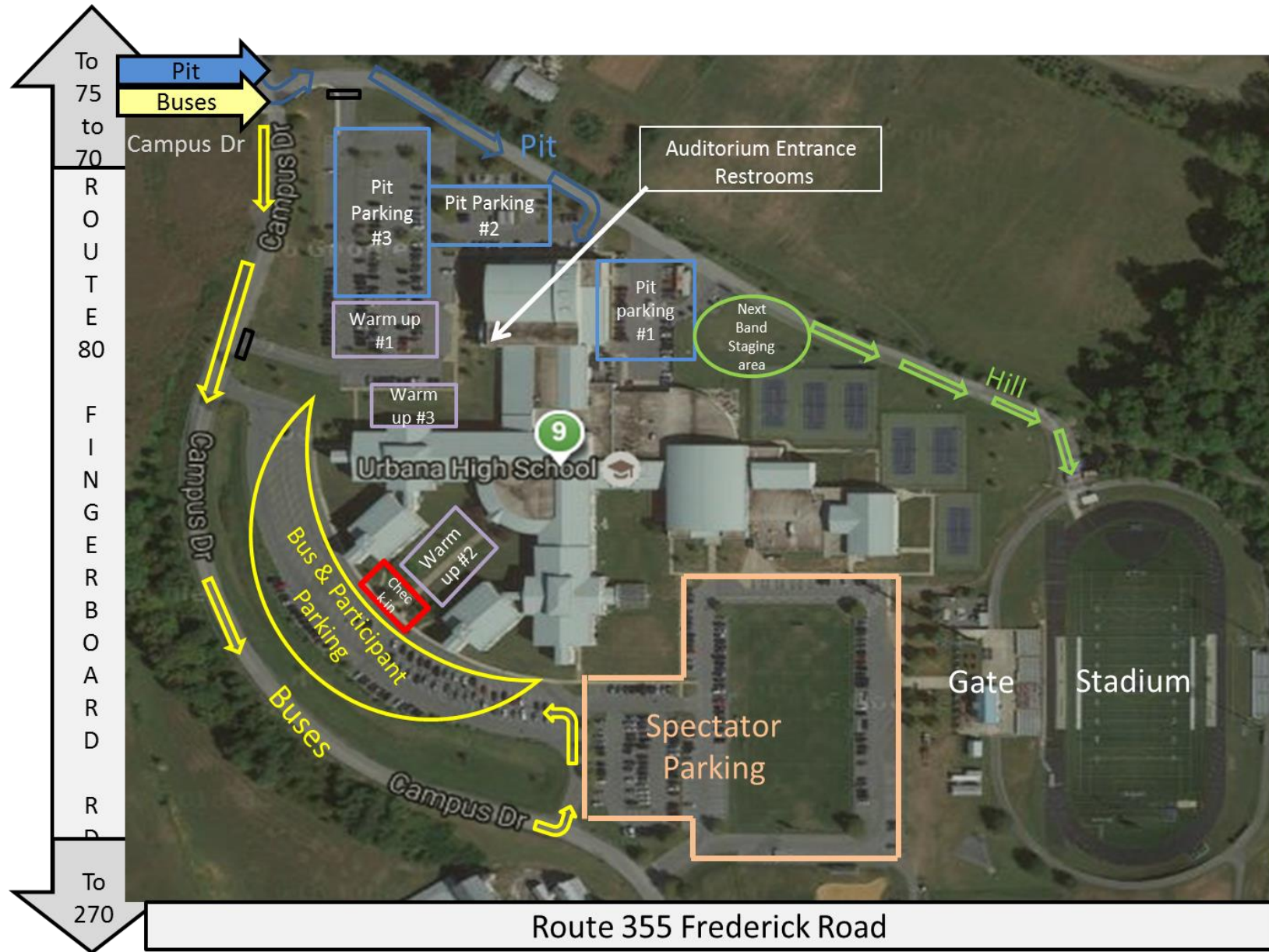

ENSEMBLE FLOW MAP



SEVERE WEATHER MAP

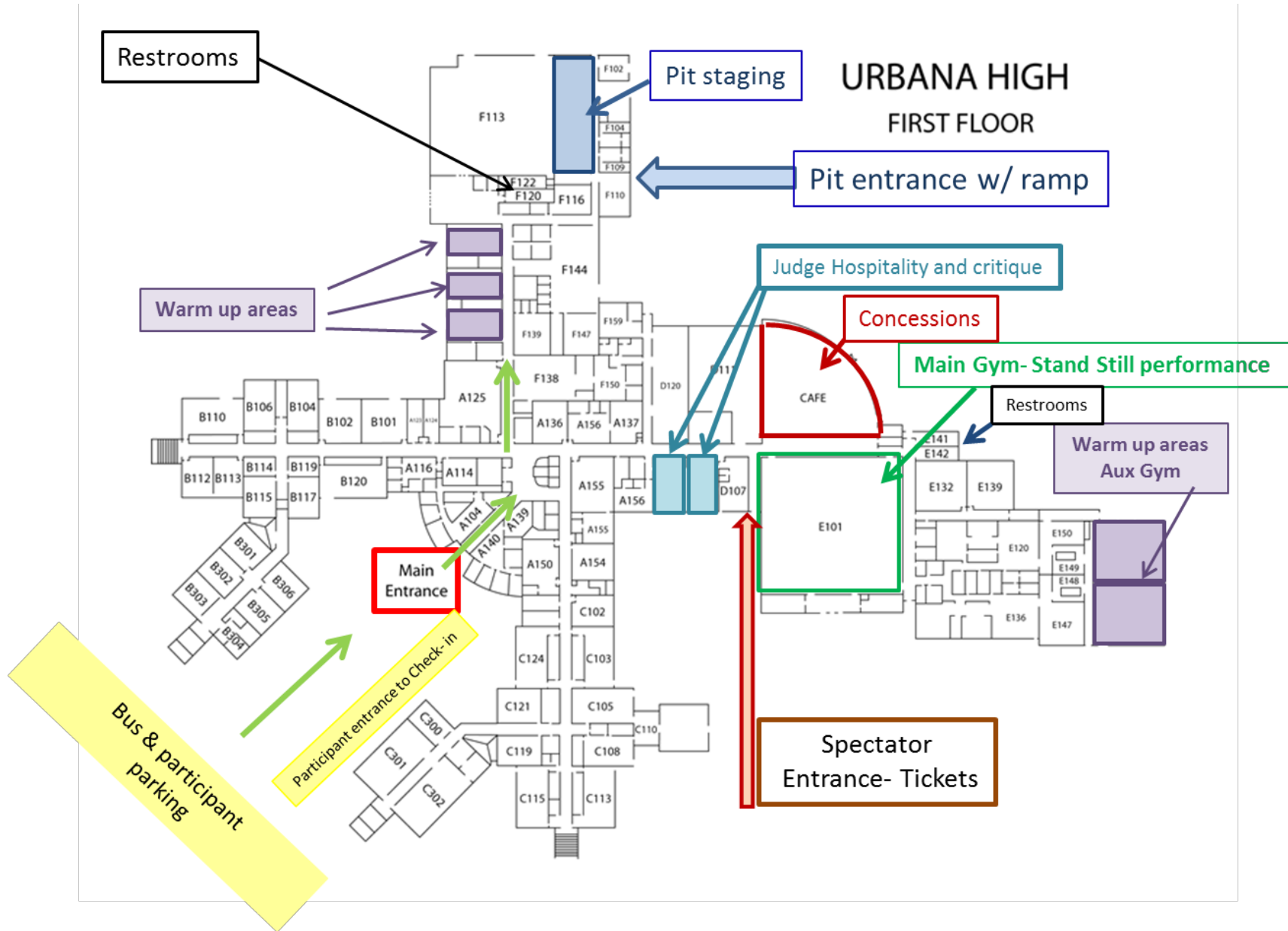



SEVERE WEATHER PLAN

Parking: Buses will park in front of the main entrance of the school. Spectators will park around the field hockey field near the stadium. There is no charge for parking

Restrooms: Located inside the auditorium entrance

Member Re-entry: Band members will be marked with a hand stamp and should enter the auditorium or pit crew entrance.

Warm-up: Bands will warm up in class rooms, the auxiliary gym and over flow into separated larger hallways as needed

Performance Area: Stand still performance in the main gym

Retreat/Critique: Drum majors will report to the main gym for retreat. Critique will be in a designated classroom.

Tickets: Adults \$12.50, Students and Seniors \$10, Children 10 and under are free with a paying adult

Concessions: Concessions will be located in the cafeteria.