



Heritage High School

Heritage High School
520 Evergreen Mill Road SE
Leesburg, VA 20175
September 29, 2018



EVENT HOST CONTACTS

George Herrmann
(571) 252-2803
Herbert.herrmann@lcps.org

USBANDS CONTACTS

Mike Trehey
(484)-387-1136
mtrehey@usbands.org

Eric James
(484)-387-1142
ejames@usbands.org

Heritage High School
September 29, 2018**Contact:** George Herrmann**Location:** Heritage High School
520 Evergreen Mills Rd SE
Leesburg VA 20175**Schedule (Performance times are subject to change)**

Performance	Class	Unit/Director	Location
7:30 PM	**THIS IS A PRELIMINARY SCHEDULE- SUBJECT TO CHANGE**		
7:25 PM	NATIONAL ANTHEM		
7:30 PM	Group III A	Clarksburg High School Charles Orifici	Clarksburg MD
7:45 PM	Group IV A	Loudoun County High School Darron Young	Leesburg VA
8:00 PM	Group IV A	Loudoun Valley High School Rick Reaves	Purcellville VA
8:15 PM	INTERMISSION		
8:45 PM	Group II A	Annapolis Area Christian School Jennifer Tylavsky	Severn MD
9:00 PM	Group II A	Riverside High School (VA) Bram Smith	Leesburg VA
9:15 PM	Judged Exhibition (II A)	Heritage High School (LEE) George Herrmann	Leesburg VA
9:30 PM	AWARDS		

Heritage High School
September 29, 2018

Contact: George Herrmann
Location: Heritage High School
520 Evergreen Mills Rd SE
Leesburg VA 20175



Adjudicators

Position	Name
Fall 1.1 Chief Adjudicator	Robert Glover (Virginia Beach, VA)
Fall 1.1 - Music Individual 1	Robert Mattera (Lexington Park, MD)
Fall 2.1 - Music Ensemble 1	Nicholas Bavani (Baltimore, MD)
Fall 3.1 - Visual Performance 1	Chris Healey (Edgewood, MD)
Fall 4.1 - Overall Effect 1	Robert Glover (Virginia Beach, VA)
Fall 5.1 - Color Guard	Jonathan Colvin (North Chesterfield, VA)
Fall 6.1 - Percussion	Ben Norman (JACKSONVILLE, FL)

Staff

Position	Name
1.1 - Event Coordinator	Terence Barber (Richmond, VA)
2.1 - Assistant Event Coordinator	
3.1 - Tabulator	Kent Gall (manakin sabot, VA)



IMPORTANT EVENT INFORMATION

Parking: Please see the map for clarification, but buses and equipment vehicles will park in the bus loop via the south lot entrance (Entrance #2). All spectators will park in the regular parking lot via the north entrance (Entrance #1/traffic light).

Restrooms: Spectator restrooms are available inside the stadium. Restrooms for performers are available inside the school (prior to performance) and inside the stadium afterwards.

Member Re-Entry: Directors will be provided wristbands in their packets for all members and should distribute at their convenience prior to re-entry.

Tickets: Tickets can be purchased at the stadium entrance. It is \$5 per person.

Warm Up: Ensembles will be warming up behind the school, and front ensembles can warm up on the side of the building. See the enclosed map for more information.

Field Surface: The field surface is artificial turf with a rubberized track around it. There are no direct obstacles to getting on the field (curbs or otherwise). The gate can open wide enough for 4 wind players side by side.

Power on field: There is power near the 50-yard line on the sideline, and near the goal line on the sideline on both sides of the field.

Competition Suite: Adjudicator commentary for all USBands ensembles can be located in Competition Suite shortly after the conclusion of each ensemble's performance. Directors may grant access to the ensemble's portal with staff/instructors and may request help from USBands representatives to resolve any issues accessing Competition Suite.

Retreat/Critique: Retreat is intended for drum majors and captains only. These students will be asked to report to the scoreboard field entrance 15 minutes prior to retreat. Critique will be held in the school media center/library, which is located inside the building very close to where the registration table is located. It is a very short walk from the field and is located near where buses are parked.

Awards: We plan to have trophies for 1st and 2nd place in class, as well as 1st and 2nd in each caption.

Souvenirs/Merchandise: There will be no souvenirs available this year.

Concessions: Concessions will be located at the main concessions stand (by the end of the stadium near the bathrooms) and at tables near the edge of the bleachers.

Credentials/Access: Only staff credentials will be permitted to critique. All other areas are available to all performers, staff with badges and paying guests

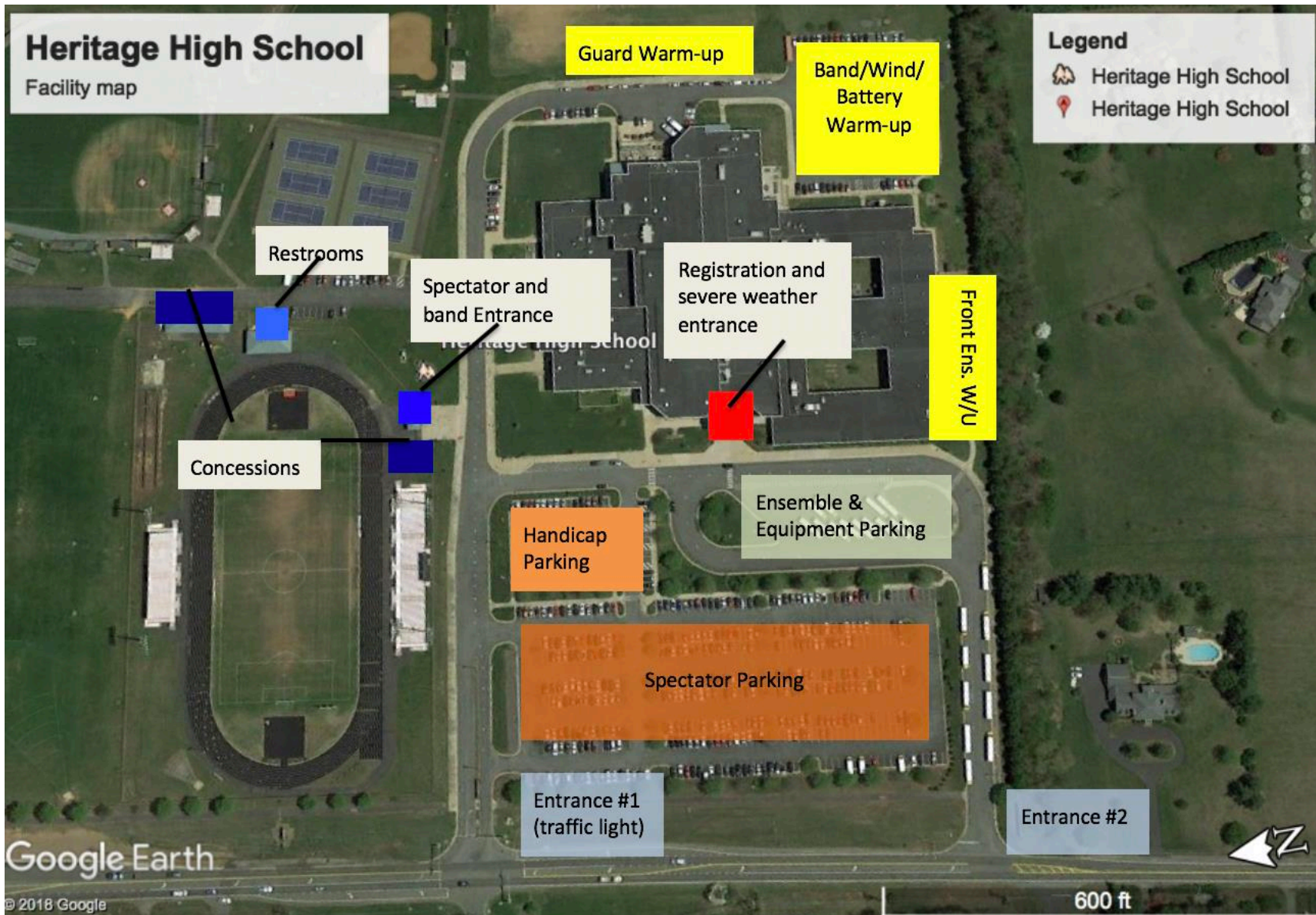

ENSEMBLE PARKING & WARMUP

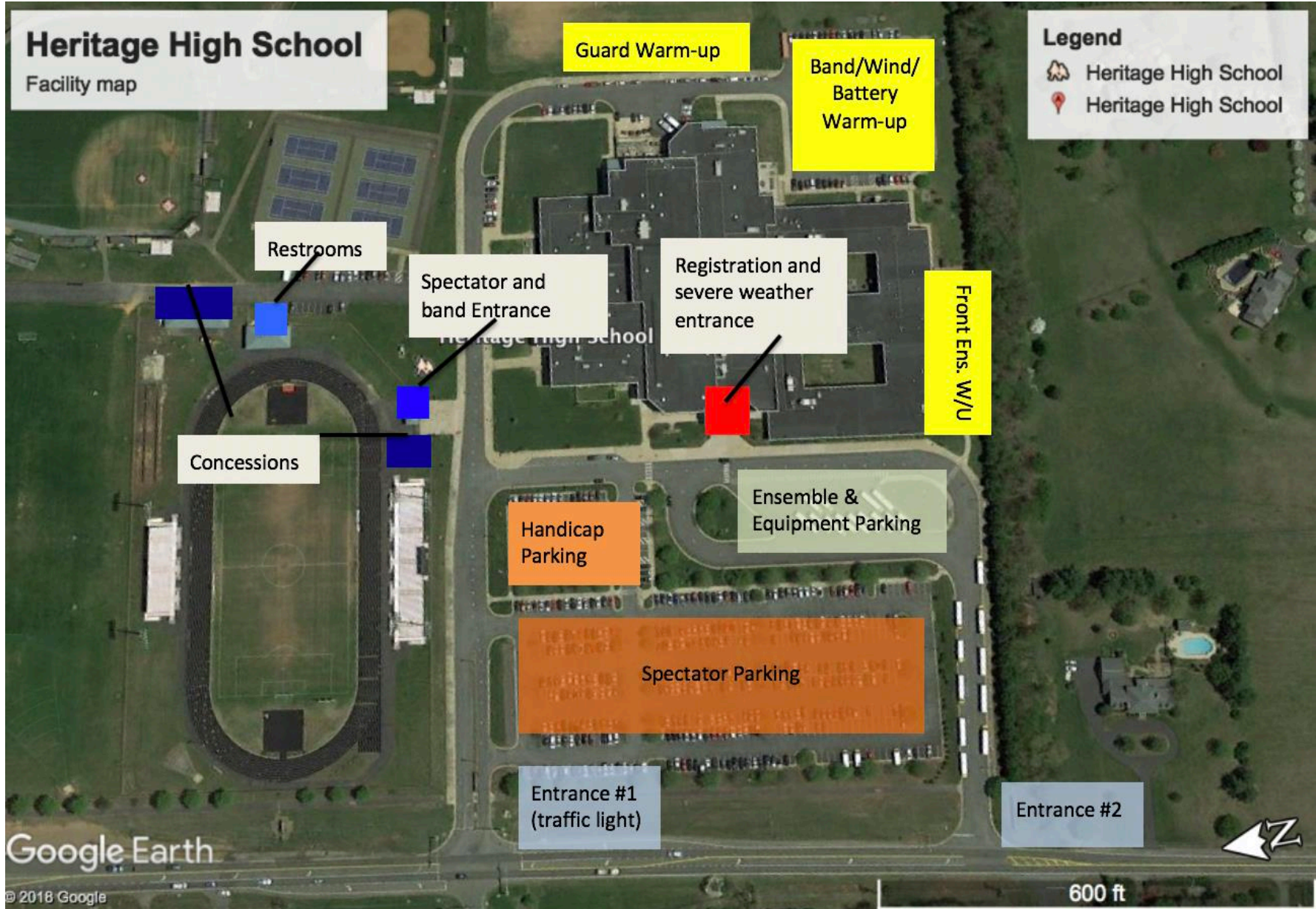

ENSEMBLE FLOW MAP

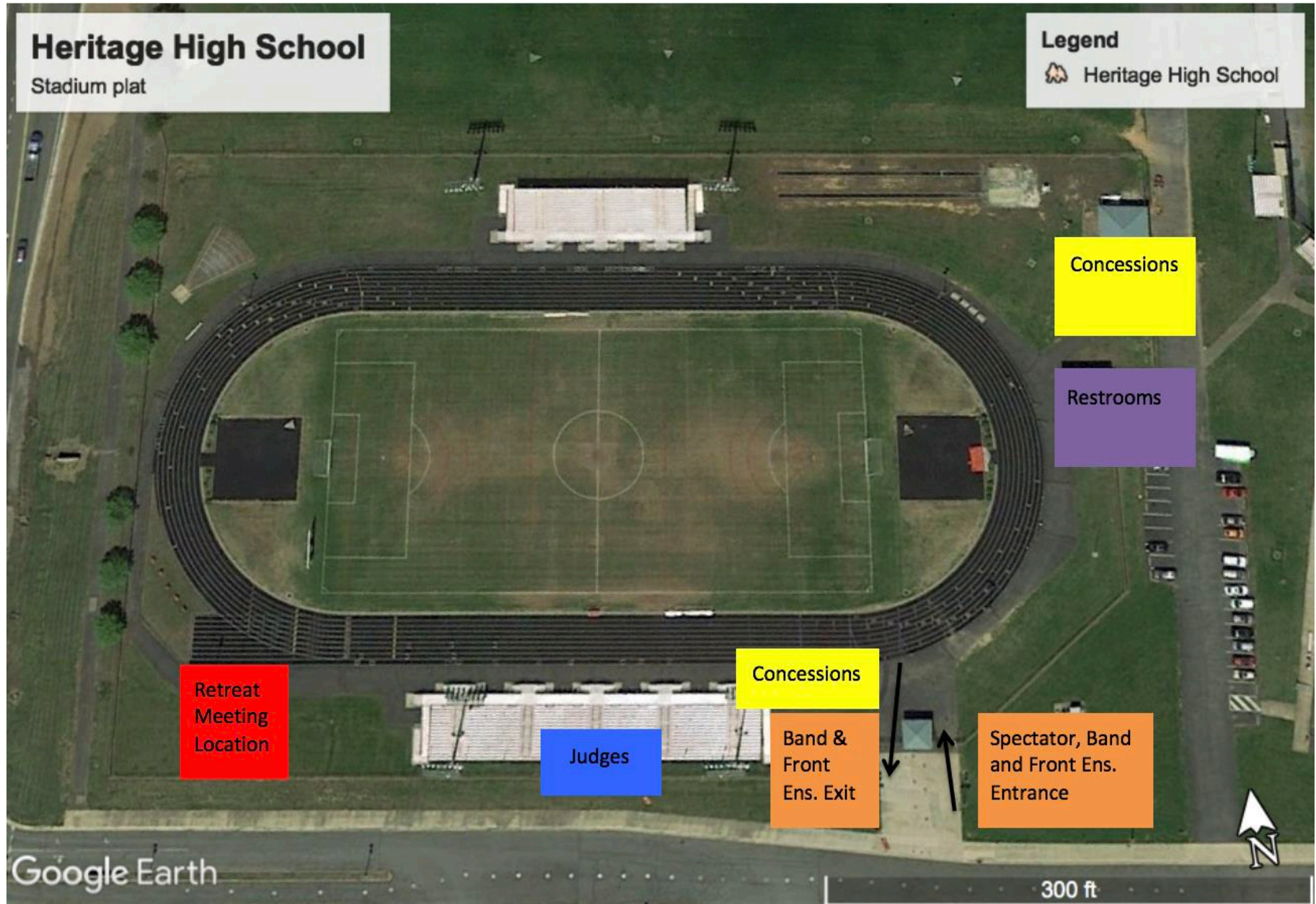

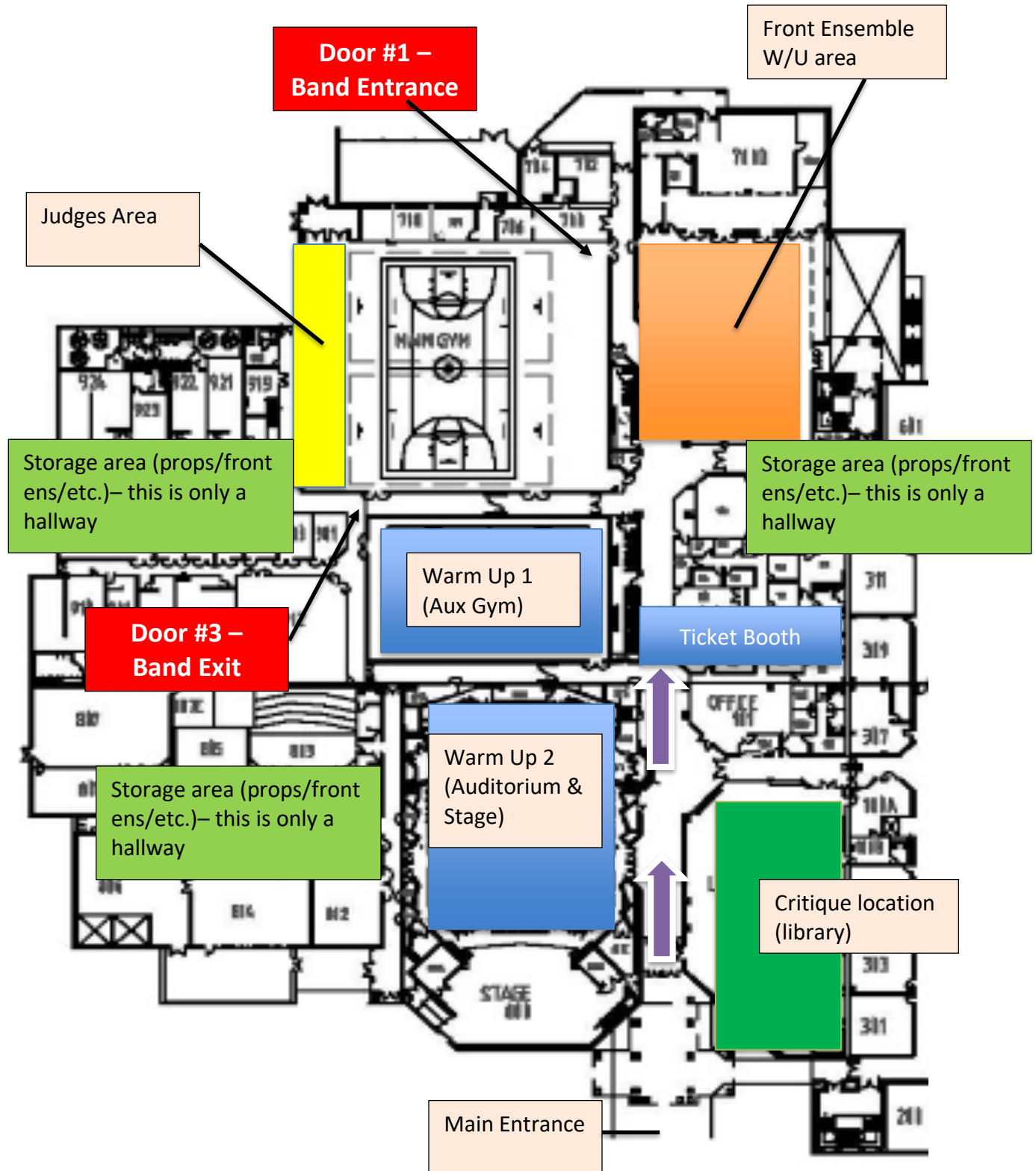

Arrival: Buses and equipment trucks should enter through the south school entrance (Entrance #2). All passenger cars/vans should enter through the north school entrance with the traffic light (Entrance #1). Large equipment trucks with a liftgate will be allowed to unload at the freight dock in the event of active severe weather.

Parking: There is no fee to park. See the enclosed map for parking areas.

Restrooms: There are restrooms available to ensembles inside the building.

Member Re-entry: Directors will be supplied with wristbands for all of their performers.

Warm-up: Ensembles will receive a guide for indoor performances. Warm up facilities will include our cafeteria (front ensembles), auxiliary gym (guard) and auditorium.

Performance Area: The performances will be in the main gym. Groups will enter and exit through specific doors (see school map).

Retreat/Critique: Drum majors only for indoor retreat and should report to door #1 at least 15 minutes prior to retreat.

Tickets: Tickets are \$5 and are available inside of the building.

Concessions: Concessions will be located directly across from the gym.