



Northern Valley Regional HS at Old Tappan

140 Central Ave

Old Tappan, NJ 07675

Saturday, September 14th, 2019



EVENT HOST CONTACTS

Amy Wilcox (Director)
(908) 295-0974
wilcox@nvnet.org

USBANDS CONTACTS

Eric James
(484)-387-1142
ejames@usbands.org

Northern Valley Regional High School at Old Tappan
September 14, 2019**Contact:** Amy Wilcox**Location:** Northern Valley Regional High School at Old Tappan
140 Central Ave.
Old Tappan NJ 07675**Schedule (Performance times are subject to change)**

Performance Class	Unit/Director	Location
4:45 PM	**All times approximate and subject to change**	
4:55 PM	NATIONAL ANTHEM	
5:00 PM	Group I A	Delaware Valley Regional High School Thomas Hayden
5:15 PM	Group II A	North Rockland High School Daniel Orban
5:30 PM	Group II A	Northern Valley Regional High School at Demarest Lauren Delesky
5:45 PM	Group II Open	West Essex Regional High School Anthony Fabrizio
6:00 PM	Group III A	Rome Free Academy Keller Shelton
6:15 PM	INTERMISSION	
7:00 PM	Group V A	Fort Lee High School Harry Welte
7:15 PM	Judged Exhibition (VI A)	Bergenfield High School Brian Timmons
7:30 PM	Group IV A	Vernon Township High School Max Taylor
7:45 PM	Judged Exhibition (IV A)	Northern Valley Regional High School at Old Tappan Amy Wilcox
8:15 PM	AWARDS	

Northern Valley Regional High School at Old Tappan
September 14, 2019**Contact:** Amy Wilcox**Location:** Northern Valley Regional High School at Old Tappan
140 Central Ave.
Old Tappan NJ 07675**Adjudicators**

Media: Digital

Position	Name
Fall 0.1 Chief Adjudicator	Thomas Beresford (Poughquag, NY)
Fall 1.1 - Individual Music 1	Rick Bullock (Dingmans Ferry, PA)
Fall 2.1 - Ensemble Music 1	Mike Schmitt (Lake Hopatcong, NJ)
Fall 3.1 - Visual 1	Thomas Beresford (Poughquag, NY)
Fall 4.1 - Overall Effect	Marc Sylvester (Brooklyn, NY)
Fall 5.1 - Color Guard 1	Myrna Lopez (Brooklyn, NY)
Fall 6.1 - Percussion 1	Joe Marrella (Marlton, NJ)

Staff

Position	Name
1.1 - Event Coordinator 1	Jeff Miedowski (Wappingers Falls, NY)
2.1 - Assistant Event Coordinator 1	Ruth Marrella (Marlton, NJ)
3.1 - Tabulator 1	Christopher Zwarych (Blairstown, NJ)



IMPORTANT EVENT INFORMATION

Parking: Buses will be parked approximately .25 miles away at a large parking lot. Spectators will be parking on campus in the front of the school and to the right of the school. There will be no charge for parking.

Restrooms: Restrooms for volunteers and band members will be located inside the front of the school. There will be porta-potties for spectators as well as bathrooms open within the school, close to the stadium.

Member Re-Entry: Band members will receive a wrist band in their event packet.

Tickets: Tickets are \$10 per adult and \$5 per child under 12. They can be purchased at the gate beginning at 3 pm on the day of the competition.

Warm Up: Ensembles will be warming up on our grass fields behind our school. There will be guides bringing the bands to both visual and music warm up areas.

Field Surface: Field is turf and high school hashes are present.

Power on field: There will be an extension cord with a power strip giving power at the fifty-yard line.

Competition Suite: Adjudicator commentary for all USBands ensembles can be located in Competition Suite shortly after the conclusion of each ensemble's performance. Directors may grant access to the ensemble's portal with staff/instructors, and may request help from USBands representatives to resolve any issues accessing Competition Suite.

Retreat/Critique: Drum majors will report to the band entrance of the stadium before the last band performs. The critique will be located inside the school. Once you leave the stadium and walk towards the school, you will see signs for the critique.

Awards: Trophies will be provided as well as small trophies for all caption awards.

Concessions: Concessions are located in an outdoor concession stand next to the home stands.

Credentials/Access: Only staff credentials will be allowed in the critique room.

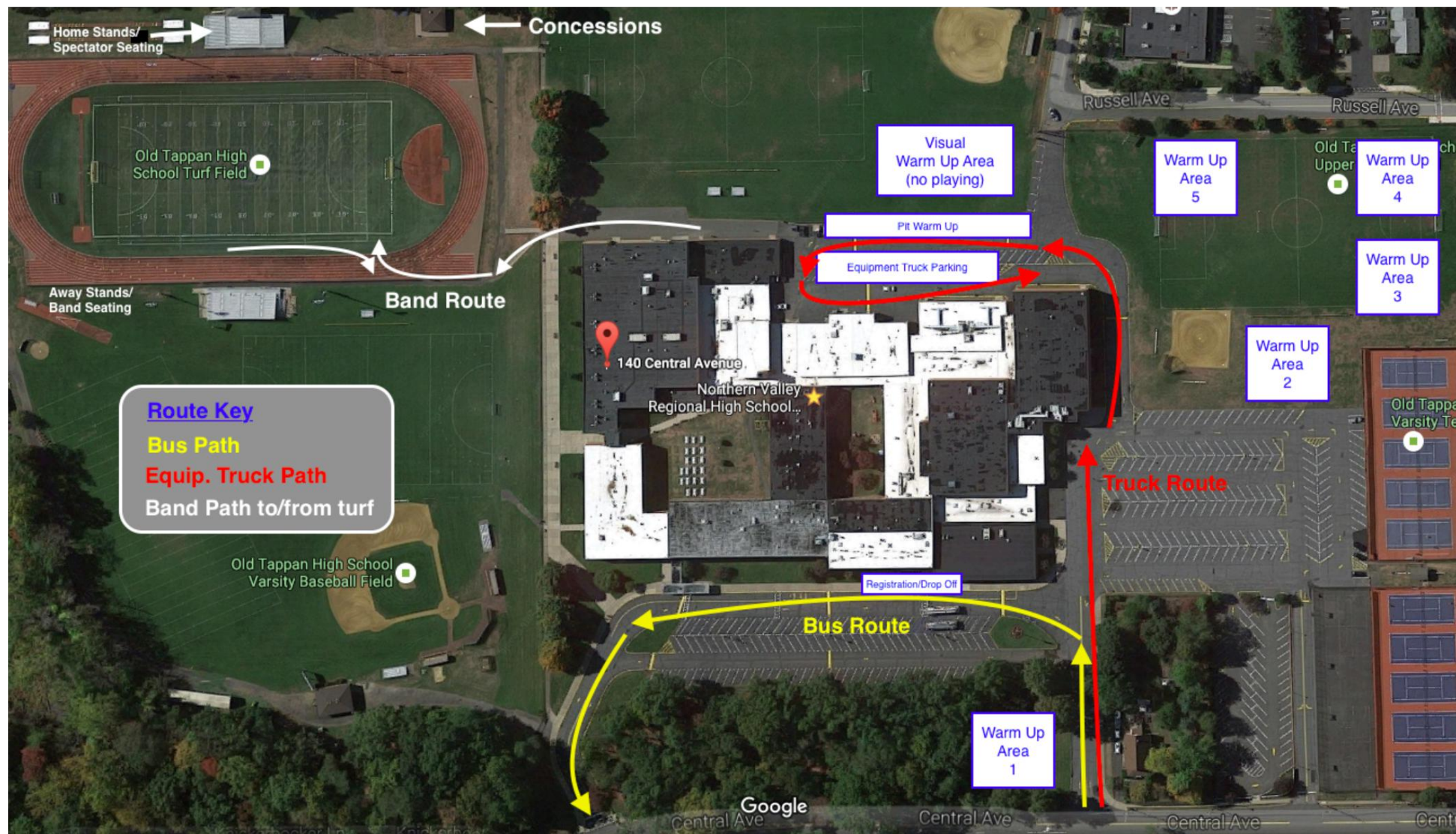

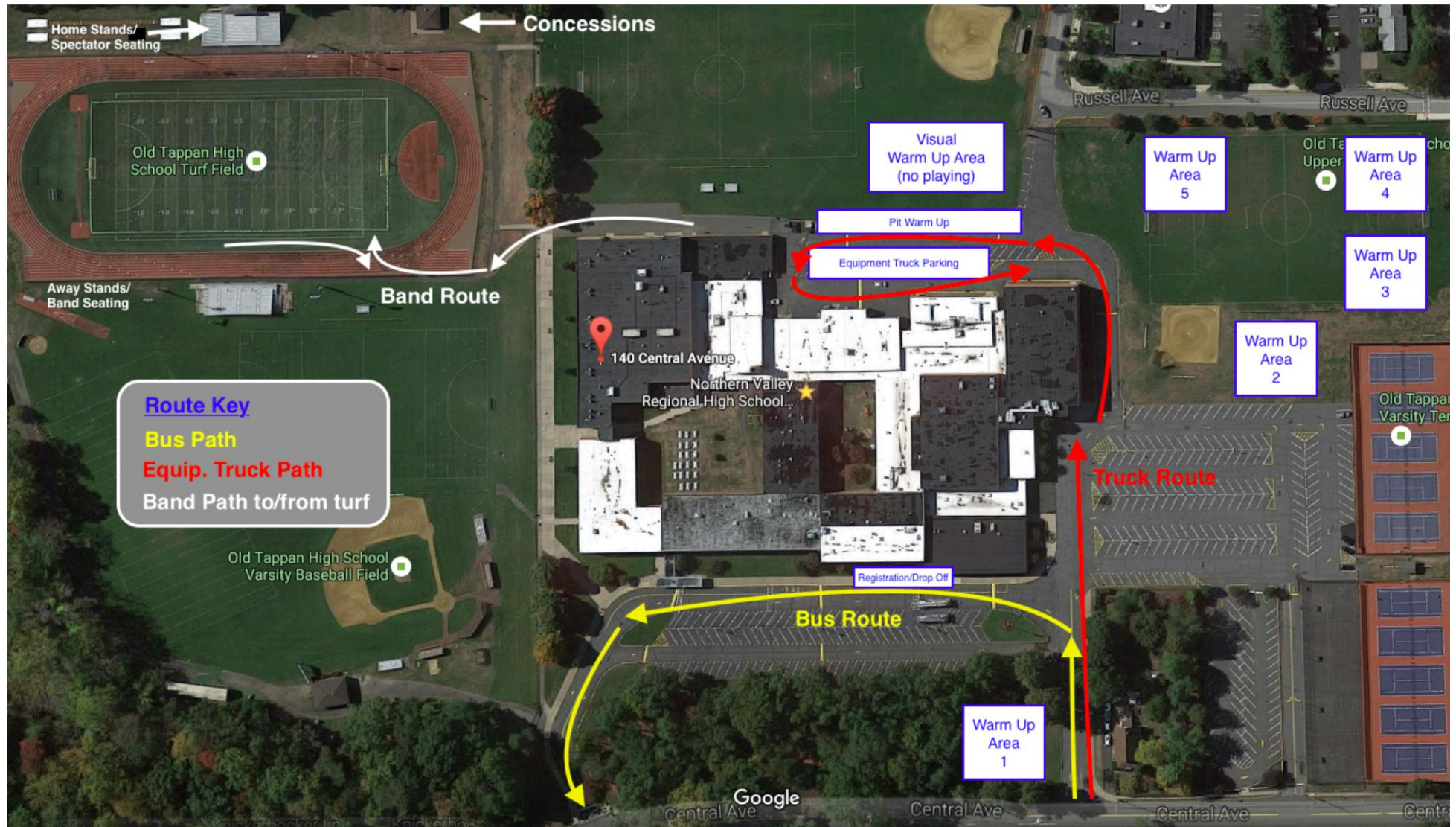

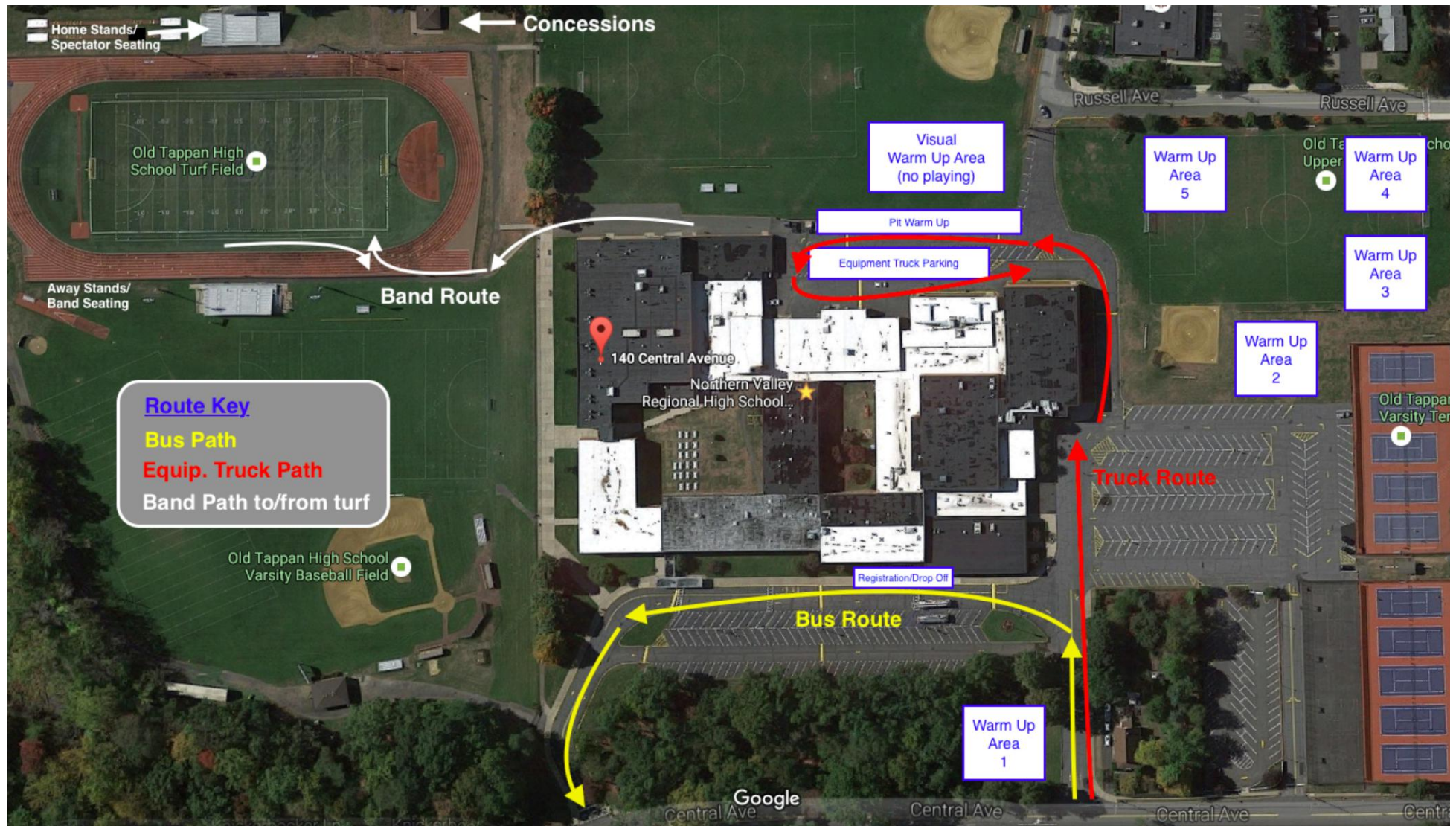

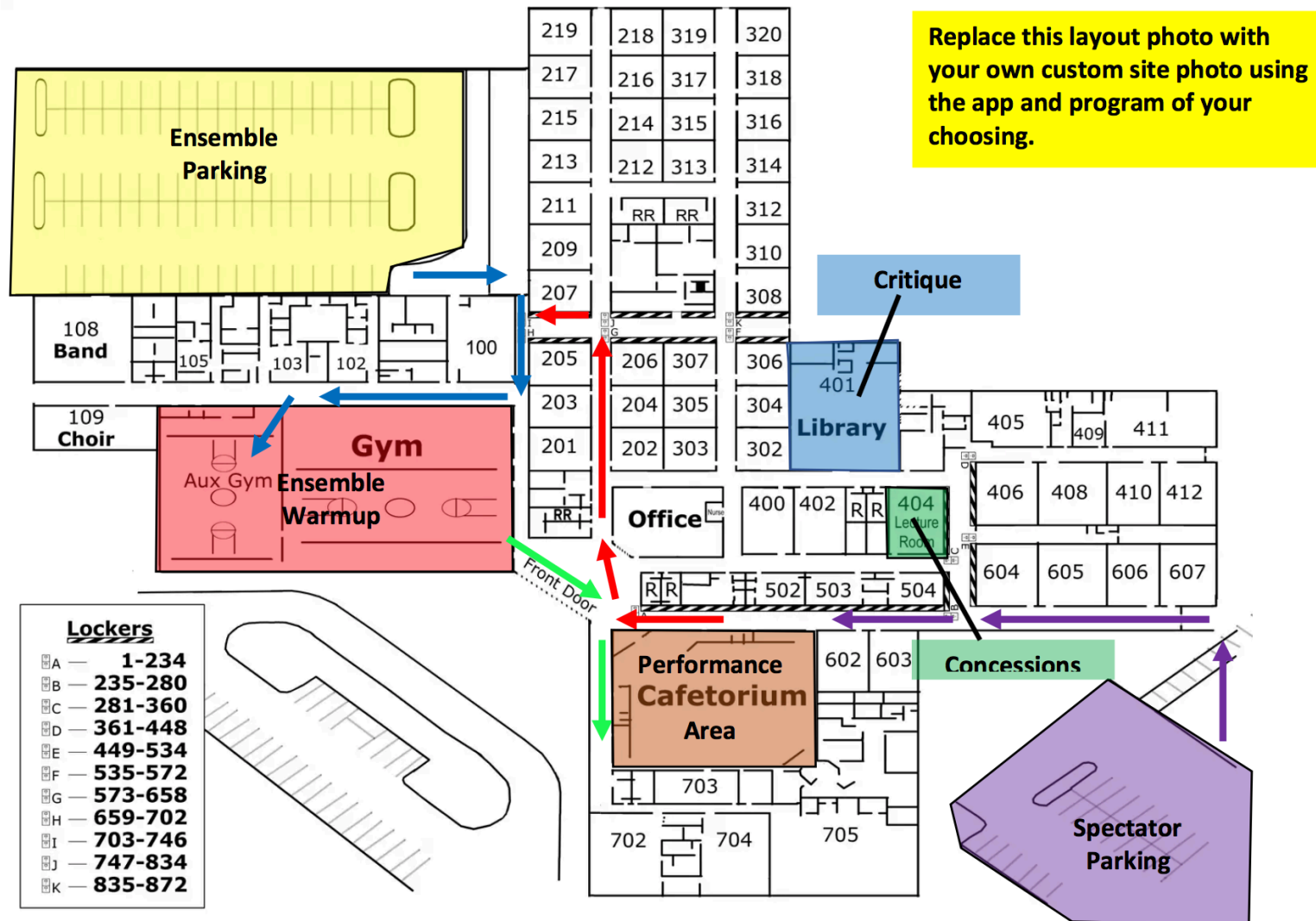



SEVERE WEATHER PLAN

Parking: Buses will be parked approximately .25 miles away at a large parking lot. Spectators will be parking on campus in the front of the school and to the right of the school. There will be no charge for parking.

Restrooms: Restrooms for volunteers and band members will be located inside the front of the school.

There will be bathrooms open near the gym for spectators.

Member Re-Entry: Band members will receive a wrist band in their event packet.

Tickets: Tickets are \$10 per adult and \$5 per child under 12. They can be purchased at the gate beginning at 3 pm on the day of the competition.

Unloading Area: Ensembles will unload equipment near the entrance closest to our warm up rooms.

There is no ramp, and no ramp will be needed as there are no stairs.

Warm-Up: Bands will be warming up in one of our gyms or one of our large cafeterias.

Performance Location: Gym

Power: Yes

Retreat/Critique: Drum majors can report to the band entrance before the last band performances. The critique will be located in a classroom in the same wing of the school as the gym and signs will direct directors there.

Concessions: Concessions will be located in the hallway prior to entering the gym.

Credentials/Access: Only staff credentials will be allowed in critique room.