



ELITE™

WORLD'S MOST SHOOTABLE BOW™

## 2014 TECHNICAL MANUAL

TUNING AND TECHNICAL INFORMATION FOR THE  
ENERGY 32, ENERGY 35, SPIRIT AND TOUR COMPOUND BOWS

**DISCLAIMER OF LIABILITY:** Elite Archery is not liable for any personal injury, death or property damage that may result from your use of this bow. By using this product, the user assumes all risks of property damage, death or injury to yourself and others that may arise from its use. By using this product, the Buyer also agrees to hold Elite Archery harmless and indemnify Elite Archery for any personal injury, death, or property damage that may result, for any reason, from the use of this product. Use of this product binds the user to the terms and provisions of this disclaimer of liability.

Please read the following safety information before using your bow. Failure to follow these warnings may cause serious injury or death to yourself or to others and may cause damage to your bow.

**1. Always Remember Safety is Your Highest Priority.** Make sure you are properly trained in the use of your bow before using it unless you are using the bow under the supervision of a qualified instructor. Failure to receive proper instruction for the use of your bow can result in serious injury or death. Wear safety glasses when working on or shooting your bow. Please note the location of others when using your bow. Keep out of the reach of children unless under adult supervision. Do not run while carrying arrows. Never draw, aim or fire your bow to the direction of another person and never shoot an arrow straight up.

**2. Do Not Permanently Remove the Draw Stop Post.** Elite recommends that you only shoot an arrow if the point of the arrow is at least 2 inches past the shelf of the bow. The use of an overdraw that allows a shooter to draw the point of the arrow past the shelf of the bow significantly increases the risk of injury to the shooter. The Draw Stop Post is used to ensure that you do not overdraw your bow. Do not permanently remove the Draw Stop Post as this can cause bodily injury or death and will void any warranties for this product.

**3. Carefully Inspect Your Bow Before Each Use.** Carefully note the condition of the bow before you shoot. Replace all frayed bowstrings. Report damaged cams, risers, limbs or other parts of your bow to your local dealer for inspection or replacement. Using a damaged bow may result in serious injury or additional damage to the bow.

**4. Inspect All Arrows.** Before shooting, inspect your arrows for defects and discard cracked, splintered or dented shafts. Never assume any arrow is safe-even a new arrow. To inspect an arrow, grasp it on both ends and flex it away from yourself and others with a deflection of 1 to 2 inches while visibly and audibly checking for splinters, cracks or knicks. Visually inspect the entire arrow (including the nock) and never shoot a damaged arrow as this can cause serious damage to your bow and may injure the shooter or others nearby. Also, a cracked nock can break when fired and cause the bow to dry-fire.



**5. Replacement or Installation of Parts:** We recommend replacement or installation of any item on your bow (such as a stabilizer, bow string, etc.) by a local dealer properly qualified and trained to install such part(s). Use of your bow after faulty installation of a component part may cause personal injury or damage to your bow. It is strictly the responsibility of the user to assure that your bow is used correctly.

**6. Never Dry Fire Your Bow.** Dry firing means to draw and release the bowstrings without an arrow on the string. This can cause severe damage to your bow and possible injury to yourself or others. Let down the bow slowly and carefully from any drawn position. Never draw a bow that does not fit your size or strength. Damage caused by dry fire will not be covered under warranty. If, however, you dry fire your bow for any reason, please inspect it for damage, cracking or splintering and replace any damaged parts. Also, make sure your arrow's nock is properly on the string before firing your bow as an improperly nocked arrow may cause your bow to dry fire.

**7. Minimum Arrow Weight.** Shooting underweight arrows has the same effect as dryfiring a bow and can cause serious injury. Do not use an arrow that is less than 5 grains per pound of bow draw weight.

**8. Types of Arrows:** Do not use wooden or fiberglass arrows. They are not designed for use with this bow and may cause serious injury.

**9. Never Expose Your Bow to Extreme Heat or Prolonged Moisture.** Excessive heat, such as a sunny day inside a closed vehicle, may cause component failure. Store the bow properly when not in use. Damage caused by extreme exposure will not be covered under warranty.

**10. Be Sure of Your Backstop.** Since an arrow can travel a great distance, make sure that your backstop is large enough to catch a stray arrow and that it is thick enough to fully stop the arrow. Make sure to position your backstop in a safe direction away from people, livestock, buildings and roads.

**11. Be Sure of Your Target.** Always be aware of the location of other people. Hunters often wear camouflage and can be difficult to identify. Never aim at anything you do not intend to shoot and never draw or shoot when anyone is between you and your target. Also make sure that there are no people, livestock, buildings, roads or other objects behind or near your target. Be absolutely sure of your target when shooting in low light conditions

**12. Never Modify Your Bow.** Never modify any part of the bow or its components. This voids any and all warranties for your bow and may cause safety risks.

**13. Read and Heed All Warnings.** Always read the warning labels of any other product being used in conjunction with this bow and adhere to those safety guidelines.

# ENERGY 32™

**AXLE-AXLE** 31 3/4" +/- .125"  
**BRACE** 7" +/- .125"  
**STRING** 54 3/8"  
**CABLE** 36 7/8"  
**CENTERSHOT** 3/4" - 13/16"  
**PEAK WTS** 40, 50, 60, 65, 70, 80  
**MASS WEIGHT** 4.3 LBS



ENERGY Cam EN Mod	Speed Rating #70 350 grain arrow
#1 – 30"	332-335 fps
#2 – 29.5"	327-330 fps
#3 – 29"	323-325 fps
#4 – 28.5"	317-320 fps
#5 – 28"	313-315 fps
#6 – 27.5"	307-310 fps
#7 – 27"	303-305 fps
#8 – 26.5"	297-300 fps
#9 – 26"	293-295 fps

Deduct 2-3 fps from rating for #60 peak weight

Limb Deflection	Sub-Deflection Range	Poundage of Bow
150	149-154	80
135	132-135	70
125	123-126	65
115	114-116	60
95	94-96	50
70	69-72	40



This product may be covered by one or more U.S. or foreign pending or issued patents. For details, go to <http://www.elitearchery.com/patents>



# ENERGY 35™

AXLE-AXLE 34 3/4" +/- .125"  
 BRACE 7" +/- .125"  
 STRING 57 1/4"  
 CABLE 39 5/8"  
 CENTERSHOT 3/4" - 13/16"  
 PEAK WTS 40, 50, 60, 65, 70, 80  
 MASS WEIGHT 4.5 LBS



HUNTING



3D



INDOOR



FIELD

ENERGY Cam EN Mod	Speed Rating #70 350 grain arrow
#1 - 31"	334-337 fps
#2 - 30.5"	331-333 fps
#3 - 30"	327-330 fps
#4 - 29.5"	322-325 fps
#5 - 29"	317-320 fps
#6 - 28.5"	312-315 fps
#7 - 28"	307-310 fps
#8 - 27.5"	302-305 fps
#9 - 27"	297-300 fps

Deduct 2-3 fps from rating for #60 peak weight

Limb Deflection	Sub-Deflection Range	Poundage of Bow
150	149-154	80
135	132-135	70
125	123-126	65
115	114-116	60
95	94-96	50
70	69-72	40



This product may be covered by one or more U.S. or foreign pending or issued patents. For details, go to <http://www.elitearchery.com/patents>

1 (877) 503-5483 • [WWW.ELITEARCHERY.COM](http://WWW.ELITEARCHERY.COM)

# ENERGY 35™ w/ENS CAMS

AXLE-AXLE 34 3/4" +/- .125"

BRACE 7" +/- .125"

STRING 54 1/2"

CABLE 39"

CENTERSHOT 3/4" - 13/16"

PEAK WTS 50, 60, 65, 70

MASS WEIGHT 4.5 LBS



HUNTING



3D



INDOOR



FIELD

ENS Cam ENS Mod	Speed Rating #70 350 grain arrow
#10 - 26.5"	293-297 fps
#11 - 26"	288-292 fps
#12 - 25.5"	283-287 fps
#13 - 25"	278-282 fps
#14 - 24.5"	273-277 fps

Deduct 2-3 fps from rating for #60 peak weight

Limb Deflection	Sub-Deflection Range	Poundage of Bow
150	149-154	70
140	140-144	65
135	132-135	60
115	114-116	50
95	94-96	40



This product may be covered by one or more U.S. or foreign pending or issued patents. For details, go to <http://www.elitearchery.com/patents>



# SPIRIT™

AXLE-AXLE 31 7/8" +/- .125"  
 BRACE 7" +/- .125"  
 STRING 52 3/8"  
 CABLE 36 1/4"  
 CENTERSHOT 3/4" - 13/16"  
 PEAK WTS 30, 40, 45, 50, 60  
 MASS WEIGHT 3.9 LBS



SPIRIT Cam SP Mod	Speed Rating #60 300 grain arrow
#1 - 28"	304-307 fps
#2 - 27.5"	299-302 fps
#3 - 27"	294-297 fps
#4 - 26.5"	289-292 fps
#5 - 26"	284-287 fps
#6 - 25.5"	279-282 fps
#7 - 25"	274-277 fps
#8 - 24.5"	269-272 fps
#9 - 24"	264-267 fps

Deduct 2-3 fps from rating for #50 peak weight

Limb Deflection	Sub-Deflection Range	Poundage of Bow
135	132-135	60
115	114-116	50
105	104-106	45
95	94-96	40
70	69-72	30



This product may be covered by one or more U.S. or foreign pending or issued patents. For details, go to <http://www.elitearchery.com/patents>

1 (877) 503-5483 • [WWW.ELITEARCHERY.COM](http://WWW.ELITEARCHERY.COM)

# TOUR™

**AXLE-AXLE** 38" +/- .125"  
**BRACE** 7 7/8" +/- .125"  
**STRING** 58 5/8"  
**CABLE** 41 15/16"  
**CENTERSHOT** 7/8" - 13/16"  
**PEAK WTS** 40, 50, 60, 65, 70  
**MASS WEIGHT** 4.3 LBS



HUNTING



3D



INDOOR



FIELD

TOUR Cam TR Mod	Speed Rating #70 350 grain arrow
#5 - 30"	305-308 fps
#6 - 29.5"	300-303 fps
#7 - 29"	295-298 fps
#8 - 28.5"	290-293 fps
#9 - 28"	285-288 fps
#10 - 27.5"	280-283 fps
#11 - 27"	275-278 fps

Deduct 2-3 fps from rating for #60 peak weight

Limb Deflection	Sub-Deflection Range	Poundage of Bow
B135	132-137	70
B115	112-115	65
B115	108-112	60
B95	91-94	50
B85	82-85	40



This product may be covered by one or more U.S. or foreign pending or issued patents. For details, go to <http://www.elitearchery.com/patents>





# TOUR™ W/ESX CAMS

AXLE-AXLE 38" +/- .125"  
 BRACE 7 7/8" +/- .125"  
 STRING 60 5/8"  
 CABLE 42 3/8"  
 CENTERSHOT 7/8" - 13/16"  
 PEAK WTS 50, 55, 60, 65, 70  
 MASS WEIGHT 4.3 LBS



TOUR Cam TRS Mod	Speed Rating #70 350 grain arrow
#1 – 32"	325-328 fps
#2 – 31.5"	320-323 fps
#3 – 31"	315-318 fps
#4 – 30.5"	310-313 fps

Deduct 2 fps from rating for #60 peak weight

Limb Deflection	Sub-Deflection Range	Poundage of Bow
B120	116-120	70
B115	108-115	65
B100	98-102	60
B95	91-94	55
B85	82-85	50



This product may be covered by one or more U.S. or foreign pending or issued patents. For details, go to <http://www.elitearchery.com/patents>

1 (877) 503-5483 • [WWW.ELITEARCHERY.COM](http://WWW.ELITEARCHERY.COM)

## ADJUSTING THE DRAW WEIGHT

Before making any adjustments to the limb bolts, the four pocket set screws need to be loosened about one full turn. After adjusting the limb bolts to the desired weight, make sure and tighten the four pocket set screws.

**WARNING: DO NOT TURN THE LIMB BOLTS OUT MORE THAN THE RECOMMENDED TWO (2) TURNS!** Doing so could damage the bow, cause limbs to break out of their pockets and result in bodily injury. It will also void your Elite warranty.

## CAM ADJUSTMENT AND TUNING

2014 Elite Archery bows use a modular based cam system. All Elite bows are set to peak performance from the factory. See cam adjustment basics chart for more information.

**NOTE:** Draw stop setting adjustments allow fine tuning to achieve individual draw length requirements, however adjusting the draw length will affect the let-off and the valley at the same time. Achieving an exact let-off at a specific draw length will require some trial and error of minor modifications and/or the use of a draw board and digital scale. See your local Elite dealer or pro shop for assistance.

## STRING, CABLES & TUNING FOR ALL ELITE BOWS...

- Elite recommends that you cycle the bow 100-125 times to settle the string and cables into the grooves. To adjust your peep sight, simply twist the string from the bottom in  $\frac{1}{2}$  turn increments until the peep sight aligns. In some cases, this may need to be repeated after cycling and an additional 150-200 shots.
- We recommend waxing the string often. To wax the string, apply wax liberally to the entire length of the string. Rub briskly with fingers until the string appears slick. Remove excess wax with a clean towel or cloth. Waxing every other time you shoot will lengthen the life of your string and cable sets.
- When setting the center shot on 2014 Elite bows, measure from the inside of the riser from the berger hole to the center of the arrow. This measurement should be  $3/4"$  -  $13/16"$ .
- We recommend shooting arrows that weigh no less than 5 grains per pound of draw weight. Using arrows with less than 5 grains per pound will void any and all warranties and could cause bodily harm to yourself or damage your bow.



# MODULAR CAM CHANGE INSTRUCTIONS

**These instructions are intended to be performed on a bow with no accessories installed. A bow press designed for use on a parallel limb bow is recommended. A draw board will be helpful for resetting the draw stop locations after the mods have been changed.**

1. Properly prepare the bow press to work on a parallel limb bow.
2. Place bow in press and deflect the limbs enough to relax the string and cables.
3. Work on one end of the bow at a time. Note the location of where each of the string and cable loops attach to their posts in order to avoid incorrect installation once the mod has been changed.
4. Remove cables from their post. Secure them in a manner which will prevent twists from being lost or added.
5. Using a size T15 Torx driver, remove the three screws that secure the mod to the cam.
6. Using a size 7/64" allen wrench, remove the draw stop.
7. Remove the mod from the cam and install the desired size mod.
8. Using a size 7/64" allen wrench, install the draw stop. Be sure not to over tighten as this could cause the damage to the screw.
9. Using a size T15 Torx driver, install the three screws that secure the mod to the cam. Be sure not to over tighten as this could cause damage to the screw, mod or cam.
10. Install the cables back onto their correct posts.
11. Repeat these steps on the opposite end of the bow.
12. Be sure to verify the string and cables are in their appropriate tracks. Carefully relax the limbs and remove the bow from the press.
13. Set the draw stop locations in order to achieve the desired draw length and holding weight.

# MODULAR CAM EXPLODED VIEWS

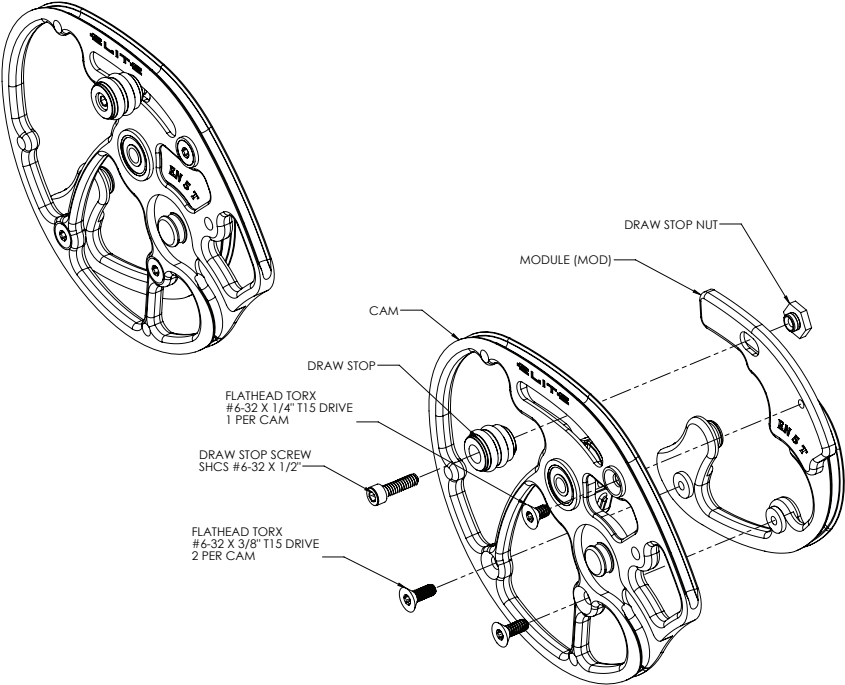

# ELITE ARCHERY CAM ADJUSTMENT BASICS

## Adjustment Results

Adjustment	Cam Rotation	Draw Length	Draw Weight	Valley / Let-Off	ATA	Brace Height
Twisting Cables	Advance	Increase	Increase	Slightly Increase	Decrease	Slightly Increase
Untwisting Cables	Retard	Decrease	Decrease	Slightly Decrease	Increase	Slightly Decrease
Twisting String	Retard	Decrease	Decrease	Slightly Decrease	Slightly Decrease	Slightly Increase
Untwisting String	Advance	Increase	Increase	Slightly Increase	Slightly Increase	Slightly Decrease
Move Draw Stops In	Slightly Retard	Slightly Decrease	_____	Shorten Valley, Decrease Let off	_____	_____
Move Draw Stops Out	Slightly Advance	Slightly Increase	_____	Lengthen Valley, Increase Let off	_____	_____



# THE ELITE PROMISE

Elite Archery announces a ground breaking new Guarantee on its bows as well as positive changes to its Limited Lifetime Warranty. Coupled together, this Elite Promise gives hunters and archers the peace of mind knowing Elite Archery stands behind its products, its dealers, and its customers.

## 1. LIFETIME TRANSFERABLE WARRANTY

Elite Archery stands behind the workmanship and overall quality of its bows through a Limited Lifetime Warranty. This Limited Lifetime Warranty is fully transferable and is valid no matter where the bow was purchased (new or used). This warranty covers the riser, pocket, limbs and eccentrics against defects in material and workmanship for the lifetime of the bow. The Limited Lifetime Warranty covers all bows manufactured by Elite Archery in the past and present.

The Elite Archery Limited Lifetime Warranty does not cover strings, cables, decoration and overall finish of the bow. Alterations or modifications to the bow by the consumer may void this Limited Lifetime Warranty. The Limited Lifetime Warranty does not cover misuse or abuse of the bow such as dry-firing, dropping, intentional or unintentional damage, etc. Elite Archery reserves the right to deny warranty coverage in the event that misuse is observed.

Elite Archery retains the right to replace components with equivalent components that may be of different design or decoration. Elite Archery may also request to visually inspect failed components prior to issuing parts and/or service.

There are no other warranties expressed or implied binding Elite Archery, Certified Elite Dealers and Certified Elite Distributors (International).

## 2. ELITE HUNT GUARANTEE

Elite Archery believes that our customers are top priority and we want our customers to be 100% confident in their bows. Elite Archery is comprised of dedicated and passionate bow hunters – for this reason we offer a unique guarantee for our hunting customers.

It happens. You are on the hunt of a lifetime and you accidentally touch your broadhead to your string. You are taking your one-week of vacation to hunt with your friends and your buddy dry-fires your bow. If there isn't a bow shop within driving distance, your hunt is over – but not if you're shooting an Elite bow. No matter where you are or what happened to your bow, Elite will send a bow to you at no charge the very next day so that you can finish your hunt. This bow is on loan from Elite Archery and not intended to replace your damaged bow. The loaner bow will arrive with the customers requested draw weight and length, with a rest, sight and peep installed. The bow will be tuned and ready to shoot. It will only need to be sighted in with the customer's arrows.

If something happens to your bow while on your hunt, please call us at 877-503-5483 and ask for the warranty department. The bows must be returned to us in the condition that they were shipped with all accessories. The loaner bow must be sent using a shipping company that provides package tracking. Our goal is to make sure you can finish your hunt, no matter where you are, no matter what happened.



## NOTES

This image shows a single sheet of white paper with horizontal ruling lines. The lines are evenly spaced and run across the width of the page. There are no margins, text, or other markings on the paper.





ELITE™

WORLD'S MOST SHOOTABLE BOW™

[WWW.ELITEARCHERY.COM](http://WWW.ELITEARCHERY.COM)



This product may be covered by one or more U.S. or foreign pending or issued patents. For details, go to <http://www.elitearchery.com/patents>