

Adding the Connect Tablet App to iOS and Android Tablet Devices

July 2020

For students on iOS

Students using New Connect on a tablet browser will see a message on the bottom of the screen that will give them directions to add the app to their tablet home screen.

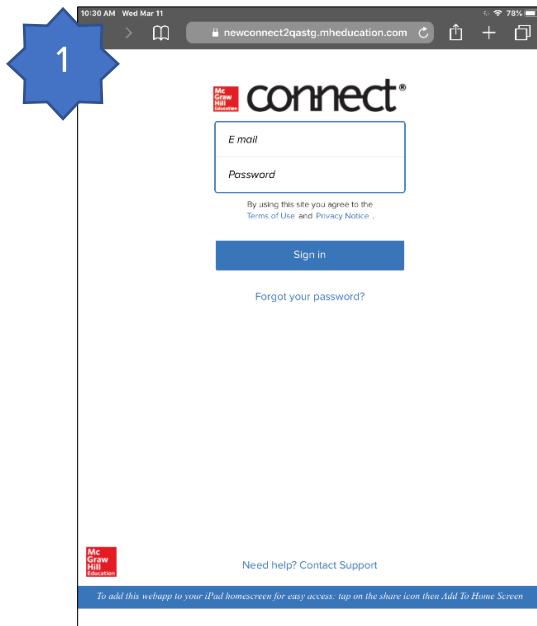

Once the app is added to home screen, students can access their New Connect account via the Connect app icon. It will not open Connect in the default browser but will “act” like an app, taking students directly to their account login page.

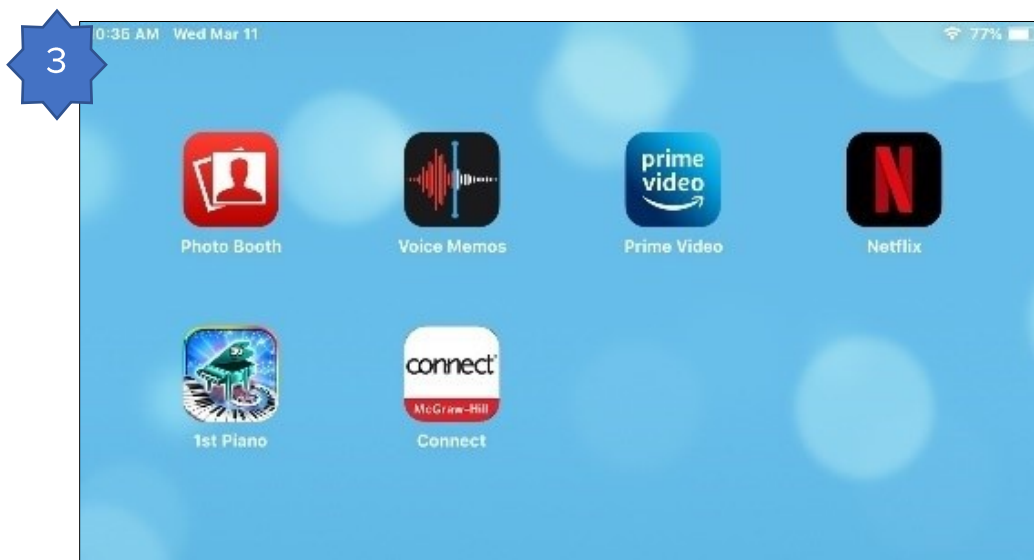

For students on Android

Students using Android tablet devices will get a message on the mobile browser to add the app to their home screen.

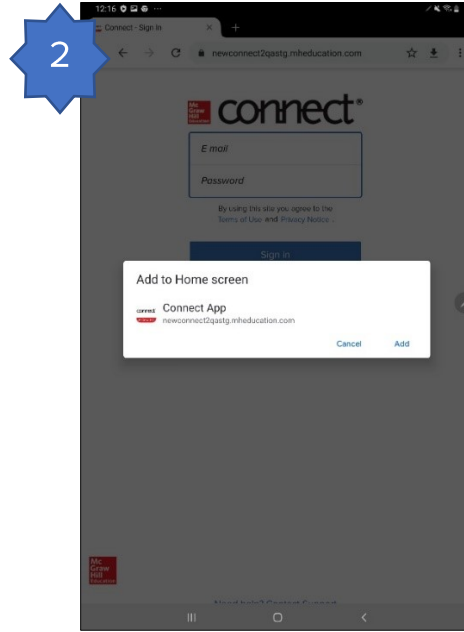
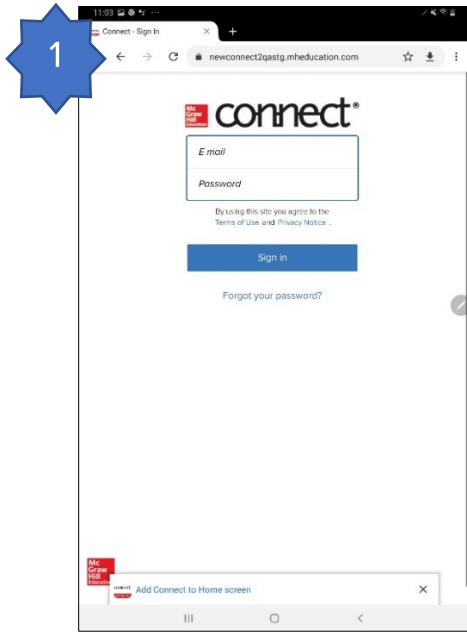

When the app is added they can access it via the Connect icon. It will not open Connect in the default browser but will “act” like an app, taking students directly to their account login page.

