

# The Archive

*Mount Dora Historical Society*

*Summer 2018*



Featured L to R: Carla Frey Tucker, Carl Tucker, Dale Tucker & Tim Totten

Our April program featured an interview with the Tucker family (Dale, Carl & Carla) by Tim Totten. The Tuckers are descendants of Dora Ann Drawdy, one of Mount Dora's earliest pioneer settlers. They graciously agreed to share their memories of growing up in Mount Dora with us. Carl and Dale's father Andrew owned and operated the Mount Dora Electric Shoe Shop which was located originally on 4<sup>th</sup> Avenue before relocating to 5<sup>th</sup> Avenue next to Royellou Lane.

They lived in several homes in downtown area, and also a home which their family built on Lake Joanna. Dale reminisced about their days on the lake saying, "We roamed the woods, fished and picked oranges. It was a wonderful life!"

During the 1940's through the 1970's, Carl said, "Mount Dora was the kind of town you just wanted to be in. It was just a good time to grow up in this town. In small town Mount Dora, everyone knew each other and neighbors helped each other. The American Legion would have fish fries once a month. The locals were active in Kiwanis, Jaycees, Lion and Rotary clubs. You behaved yourself, as a kid, because if you didn't your parents would know about it by the time you got home.

Carla Tucker Frey (Carl's daughter) filled us in on their family tree which also included the Rutherford's who owned Lake View Dairy in Eustis.

It was a very interesting interview of what Mount Dora was like in the mid-1900's. For those of you who missed it, you can view the taped interview [at this link](#) on our Facebook page.



Join us on  
Facebook



Our next program will feature an interview with teachers who taught in Mount Dora schools in the 1950's, 60's & 70's.

Their students are encouraged to bring their memories of their teachers.

Join us on Sunday, July 8<sup>th</sup>  
at 2pm at the W.T. Bland  
Public Library, 1995 N.  
Donnelly Street.

## Welcome Aboard New Members!

Nicholas and Carol Stroumtsos

William and Suzanne Carpenter

Clyde E. Mosteller (Life Member)

Jim & Alexandra Gunderson – Lakeside Inn (Life Member Business)

## The Origin of Fearon Avenue

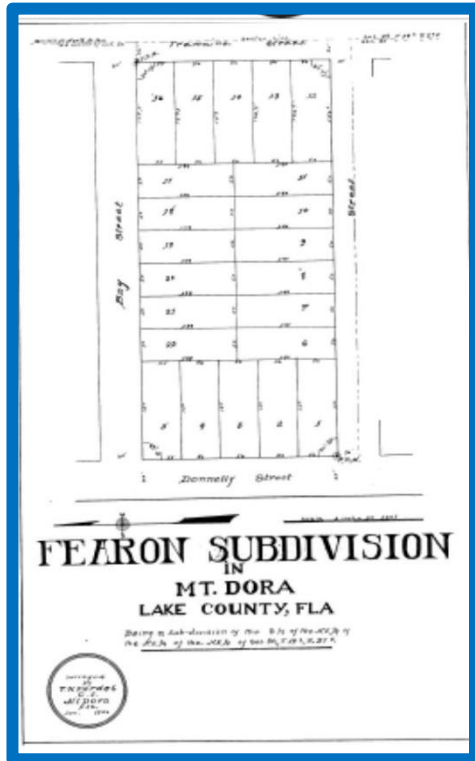

We received an email from a woman living in West Palm Beach looking for assistance in locating her maternal grandparent's land in Mount Dora. Her grandparents are: Frederick M. Fearon (born 1867, died 1928) and Lepha Lewis Fearon (born 1876, died 1945) from Prattshollow, New York.

She could vaguely remember visiting her grandparent's home as a very young child, but could not remember the location. She was planning to visit Mount Dora and was hoping we could help locate their land.

Thanks to one of our "lifetime members" Frank Driggers who was able to find the area where her ancestor lived. He used his expertise in land records to locate the Fearon Subdivision plot located between Fearon Avenue and 19<sup>th</sup> Avenue on Donnelly Street.

This inquiry for information, along with Frank's research provided us with the origin of this street name. Interestingly enough, the Fearon family also has a road named after them in Prattshollow, New York, as well.

### MUSEUM ADMISSION:

\$2.00 for adults, \$1.00 for students, kindergarten and under are free. Tour groups pay the same price.

~ Admission is always free for Members of the Historical Society.

~ Bring your group to visit the museum for a private one hour tour on Friday or Saturday morning. Arrangements must be made two weeks in advance. Call 352-383-0006 or e-mail: [mountdorahistory@gmail.com](mailto:mountdorahistory@gmail.com)

### DOCENT STAFF:

Tuesday – Rosemary Cliburn

Wednesday – Josette Blackwell

Thursday – Pat Wilson

Friday – Julia Goodwin

Saturday – Susan Bourrillion, Barnett Schwartzman & Simon Atkinson

Sunday – Linda Chase & Paula Weissman

Alternate – Sonya Jones

*Thank you to our docents who do a great job!!*



## Our Life Members List is Growing:

Mick & Connie Aldridge  
Marilyn & Dan Bafunno  
Dolores Bersell  
Elizabeth Brewer  
Ed Brooks-Mount Dora Community Trust  
Michael & Georgann Bukata  
Glenna Burch & Marshal Blum  
Deborah A. Burchill  
Betty Cook  
Joe & Janice DiFiore  
Frank Driggers  
Lynn Felts  
Jim & Alexandra Gunderson-Lakeside Inn  
Stephanie Haimes  
John & Cathy Hoechst  
James L. Homich  
James & Barbara Laux  
Al & Marlette Liveright  
William & Elizabeth Lowery  
Gary McKechnie & Nancy Howell  
Harlow & Michell Middleton  
Clyde E. Mosteller  
Susan Silkworth Myers  
Ann Whittington Neely  
Vivian Owens  
Gene Packwood  
Mary T. Pezzo  
Fred & Sandra Risley  
Brandon Wald  
Les & Janet Westlake  
Cooper & Vye Wise  
Michael Zealy & Angela Kelsey

## RECENT DONATIONS TO THE MUSEUM

Jane Leigh Rice Lassiter sent us a 1928 Mount Dora High School yearbook, along with two class play photos and a 1928 class ring that belonged to Howard James Rice, known to everyone as "Grits."

\_\_\_\_\_, a retired teacher gifted us with a large aerial map of Mount Dora that hung in her classroom, as well as some additional maps.

Judy Hadley gave us a box full of Villa Dora hotel and Garden Club paper memorabilia and newspaper clippings.

Henry Link sent us the following items:

- Scrapbook of Chamber of Commerce related articles
- Link Stationery ads
- Pristine copies of the "pink" Mount Dora Topic and supplements regarding Mount Dora history and the Honky Tonk Freeway movie
- A 1952 Chamber of Commerce newcomer's welcome handbook.

