



Calder Plaza: A Plaza Full of Options

Presentation of Master Plan

November 9, 2016



Project Sponsors:



Consultant Team:

DESIGNWORKSHOP

MARLON BLACKWELL ARCHITECTS



CLL . Concept Lighting Lab, LLC.

CALDER PLAZA | CONTEXT

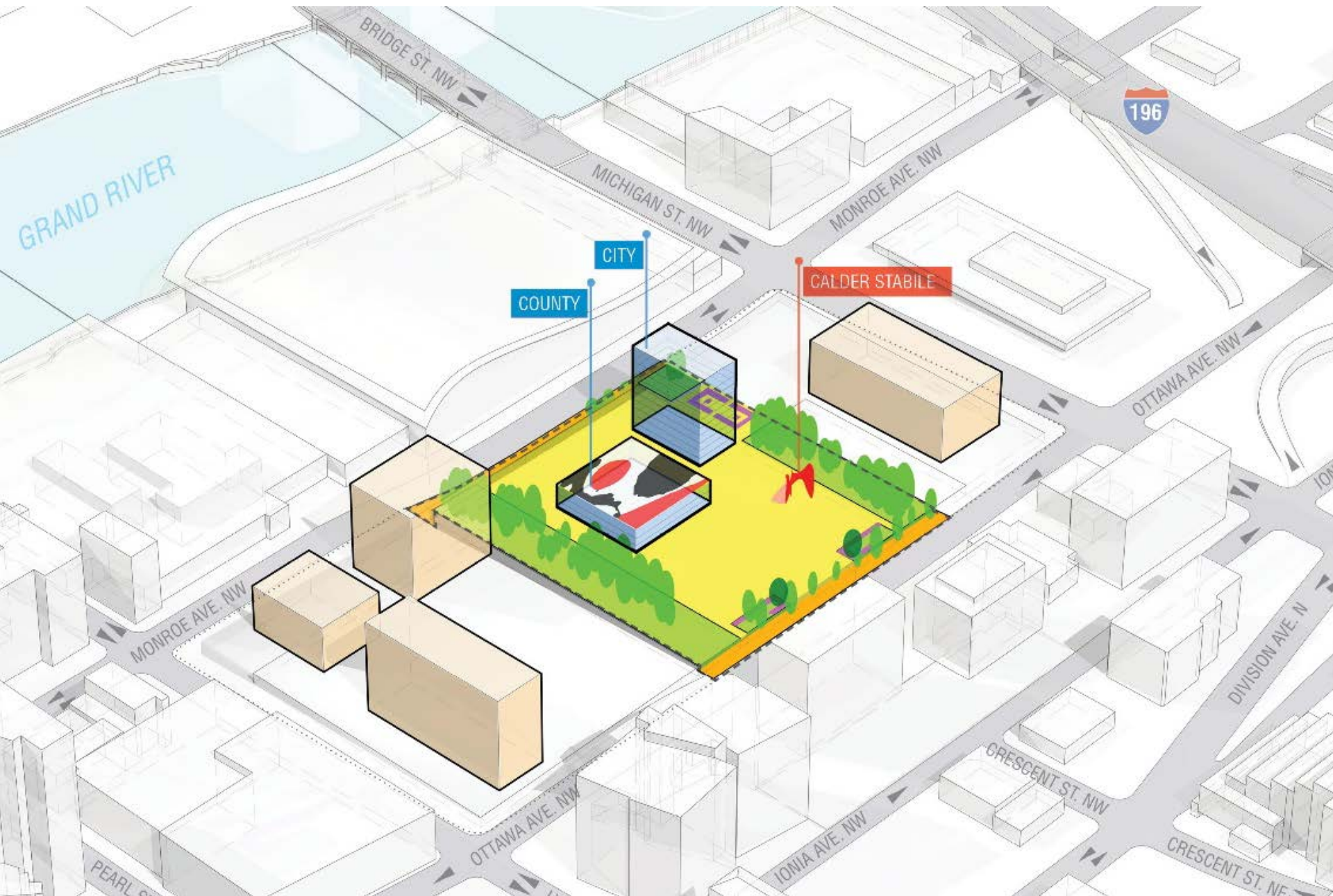

CALDER PLAZA | CONTEXT



OUR CHALLENGE

To create a world-class public space that...

leverages the space to its fullest potential

honors its cultural heritage

integrates its historic role as a governmental plaza

improves access and mobility

activates the space during all seasons

catalyzes future development

and creates iconic experiences

...for current and future generations.

SCHEDULE

MAY

*Project Kick-Off
and Historical
Research*

JUNE / JULY

*Imagine the
Possibilities:
A burst of ideas
from the
community.*

AUGUST

*Evaluate Options:
An exploration of
different
opportunities and
decisions.*

LATE SEPTEMBER

*Steering Committee
Review
(2 Meetings)*

TODAY

***Presentation of
Preferred Alternative
& Final Public
Meeting***

END OF NOVEMBER

*Final Concept Plan
Documentation
Complete*



Imagining the Possibilities:
Research

PAST VISIONS



SUGGESTED CIVIC CENTER DEVELOPMENT

STREETS: BRIDGE, DOUGLAS, BLUMRICH, ALLEN, PEARL, FRONT, SCUDMER, MONROE, CRESCENT, LYON, BOND, MICHIGAN.

EXPRESSWAY: I-490

LAND USES AND BUILDINGS:

- SAFETY BUILDING:** POLICE ADMINISTRATION & HEADQUARTERS, CITY COURTS, COUNTY COURTS, FIRE DEPT.
- CENTRAL MALL**
- ALTERNATE SITE FOR FEDERAL OR STATE OFFICE BUILDING**
- CITY-COUNTY ADMINISTRATIVE BUILDING (OR CITY HALL):** CITY OFFICES, COUNTY OFFICES
- HEALTH CENTER:** CITY-COUNTY HEALTH DEPTS.
- AUDITORIUM EXPANSION:** STORAGE AND EXHIBIT SPACE
- MUSIC HALL OR STATE OR FEDERAL BUILDING**
- PEDESTRIAN BRIDGE:** COVERED AND LIGHTED OUTDOOR SHOPS

Other Features: FUTURE PARKING, GRAND RIVER, VIEW, SCUDMER TOWER, LYON TOWER.

North Arrow: NORTH

PROPOSED CIVIC CENTER DEVELOPMENT

1965 VISION

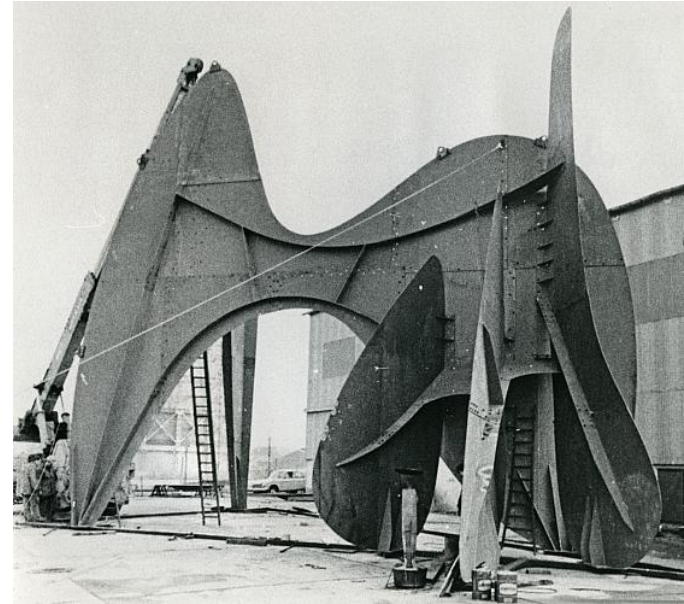
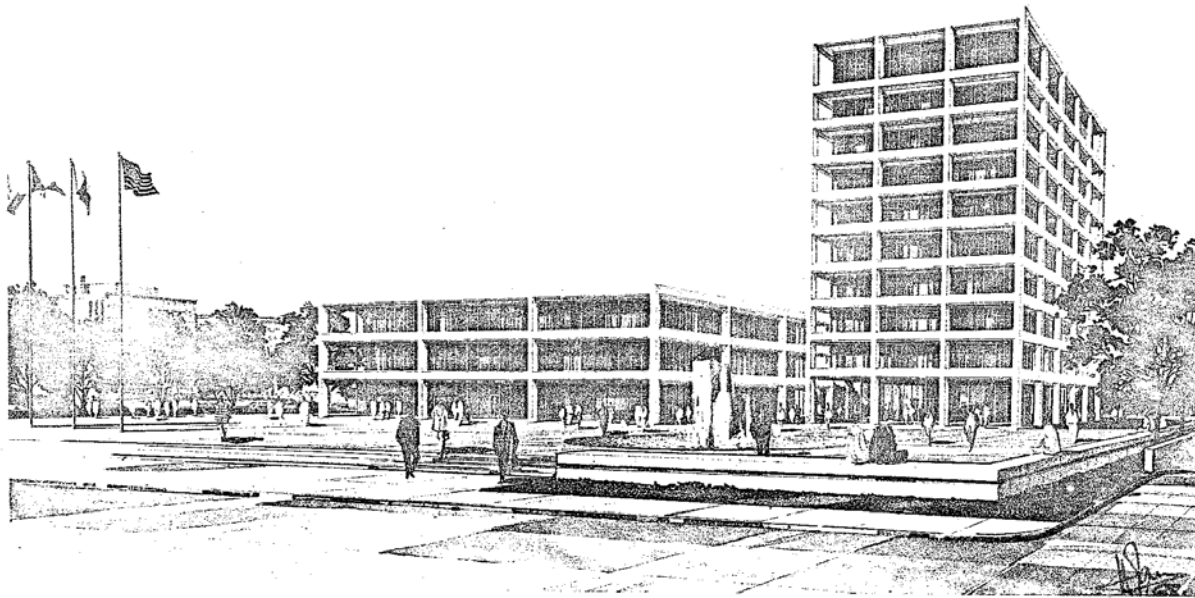

RELEVANCE OF THE PLAZA



Festival of the Arts, 2002



Festival of the Arts, 2002



Siciliano's Big Brew Day, 2014



Fiesta Mexicana, 2012



Al Gore Campaign, 2000



Gus Macker Tournament, 1996



Gull Wing Group Convention, 2007



Laughing Fest, 2011

TODAY





*Imagining the Possibilities:
Listening*

GR FORWARD VISION

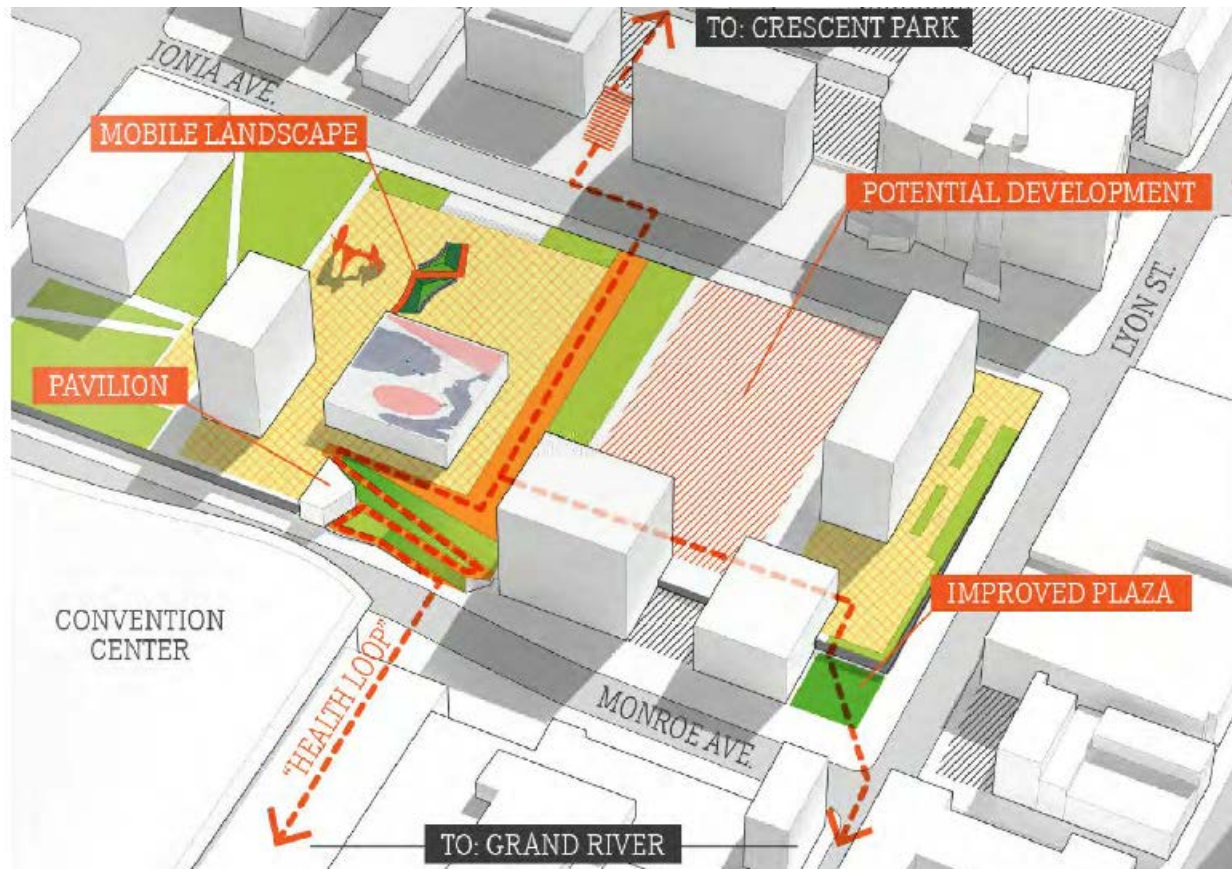

ACCESS

- Physical Connectivity
- Visual Connectivity
- ADA & Lighting
- Integrate Health Loop

ACTIVATE

- Mobile Landscapes
- Year-Round Activities
- Create Intimacy
- Establish a Human Scale

ATTRACT

- Downtown Vitality
- Inclusiveness
- Economic Development
- Visitors for Tourism

ACTIVATING CIVIC SPACE

CASE STUDY | SUNDANCE SQUARE, FORT WORTH, TX



Image source: MVL

CATALYZING ECONOMIC DEVELOPMENT

CASE STUDY | MILLENNIUM PLAZA, DENVER, CO



image source: christkindlemarket.com

CONNECTING THE CITY

CASE STUDY | PORTAL TO THE POINT, PITTSBURGH PA

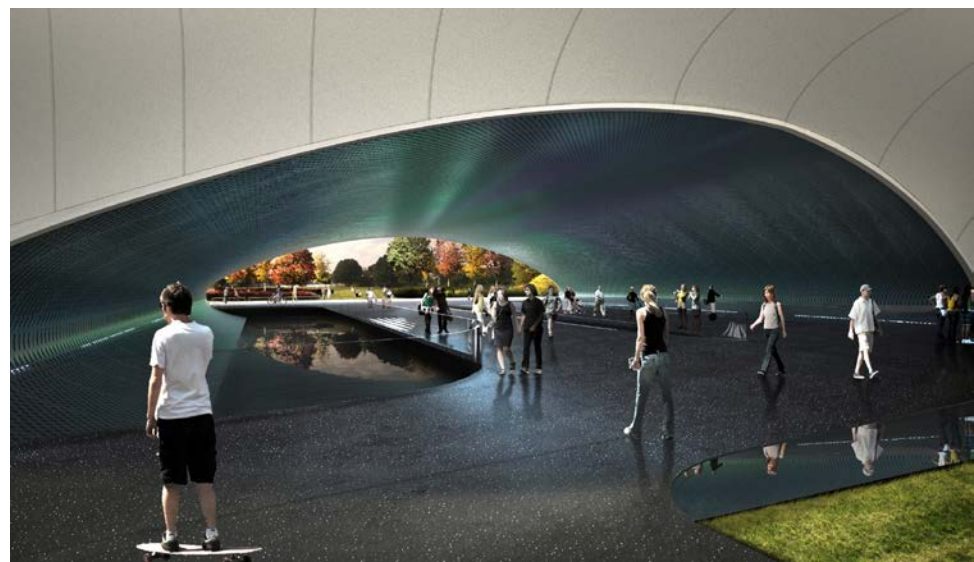

PUBLIC ENGAGEMENT SUMMARY \ EVENT #1

Only 10.74% of survey participants are satisfied or highly satisfied with the current design of the plaza.

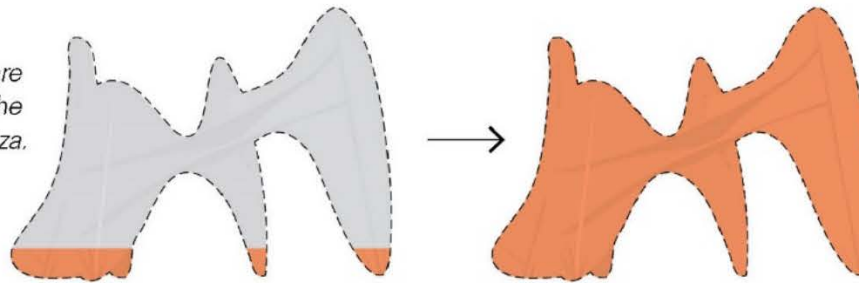

A PLAZA FULL OF POTENTIAL...

SURVEY PARTICIPANTS...

25

Steering Committee Members



40

Students from the Hispanic Center of West Michigan



60

Key Stakeholders participated in **six focus group meetings**



52

Participants at the public walking tour



AND...

Online survey responses



WHAT WE HEARD: PROJECT FOCUS

Are you interested in exploring the possibility of adding any of these elements to the Plaza?

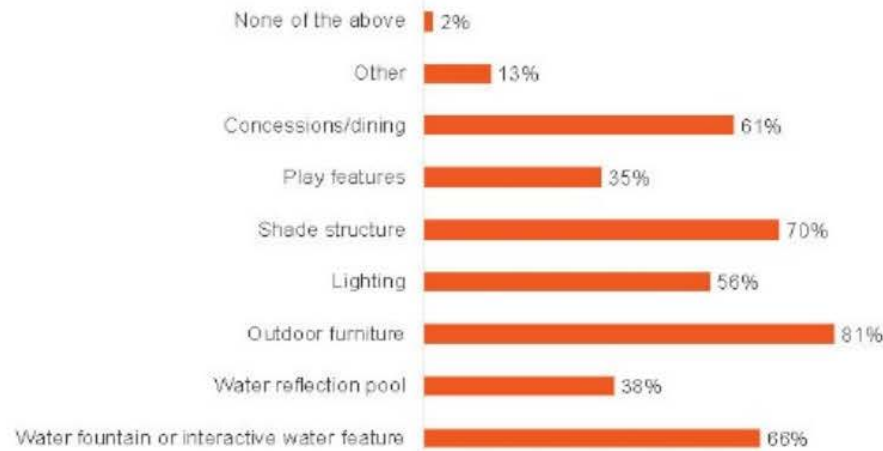

Which of these elements makes you most uncomfortable at Calder Plaza and needs to be addressed?

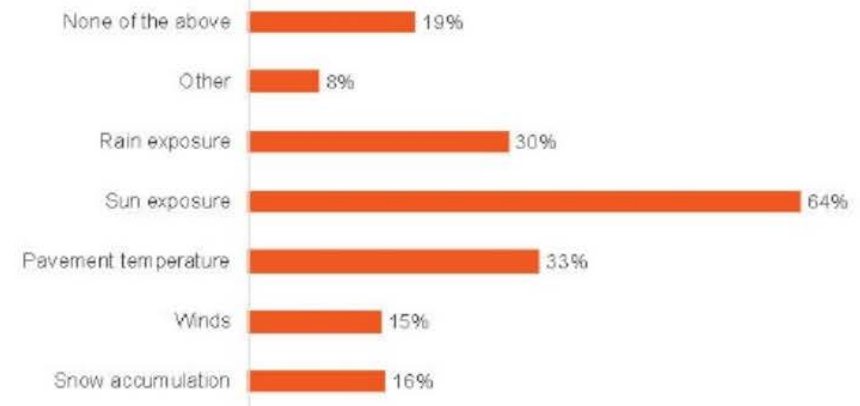

What types of events/activities do you feel are appropriate for Calder Plaza?

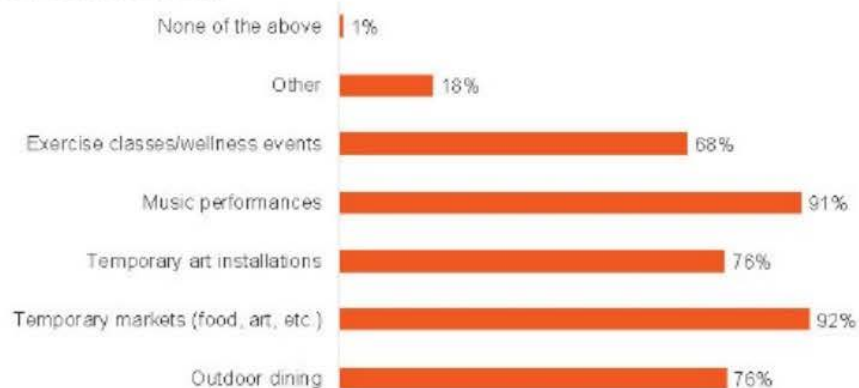

Which temporary or flexible elements are of interest?

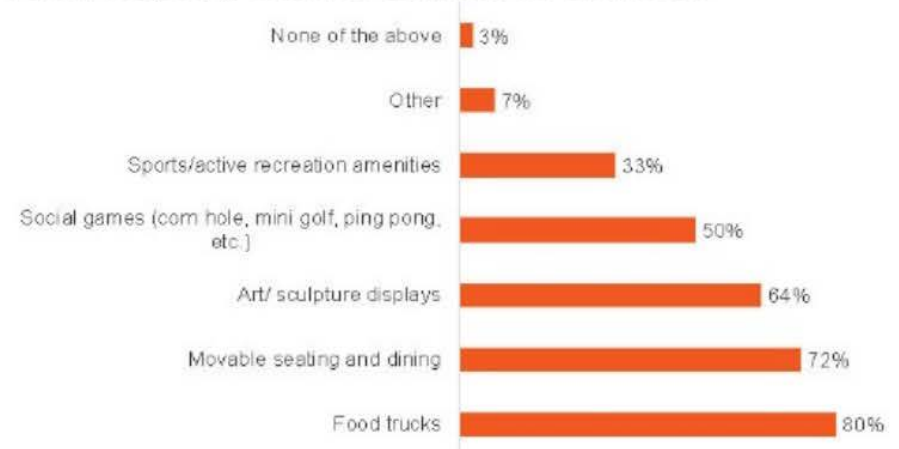



*Imagining the Possibilities:
Initial Alternatives*

CONSIDERATION OF ALTERNATIVES

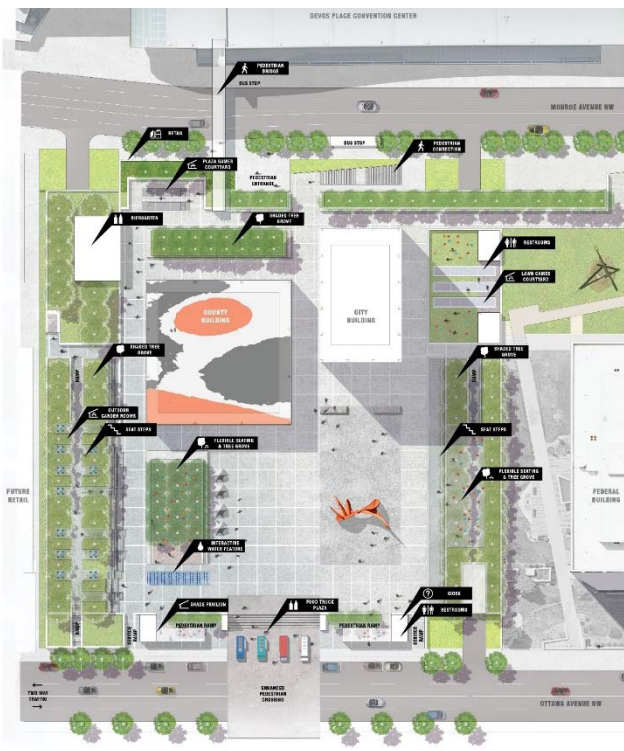

Modernist Lines

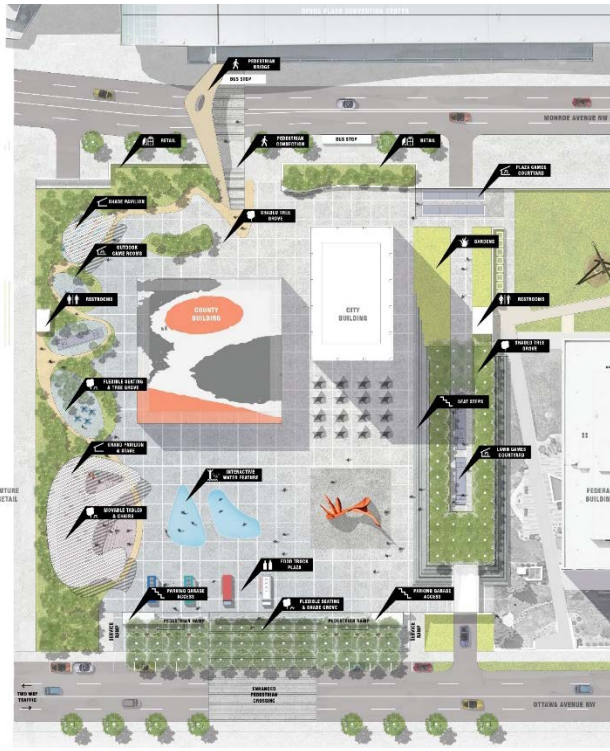

Garden & Grove

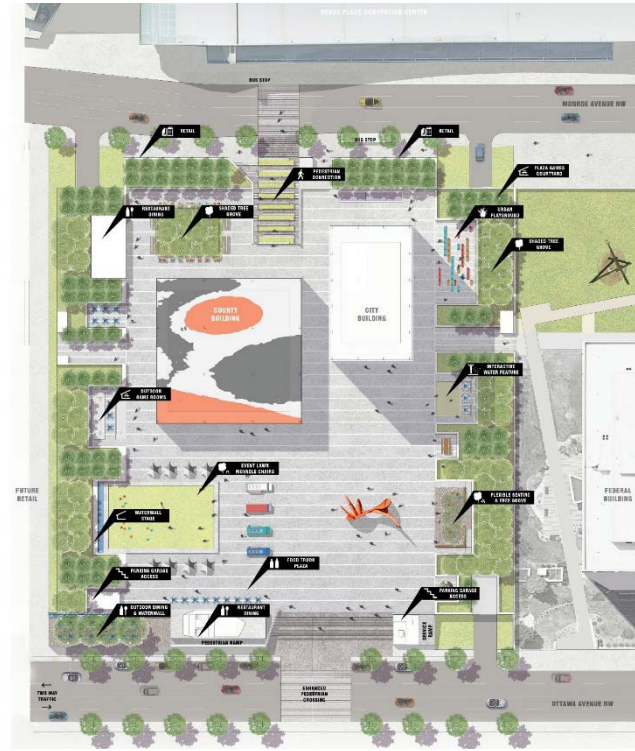

Urban Living Room



EXISTING CONDITIONS



MODERNIST LINES



EXISTING CONDITIONS



SCULPTURAL GROVE



EXISTING CONDITIONS



URBAN LIVING ROOM



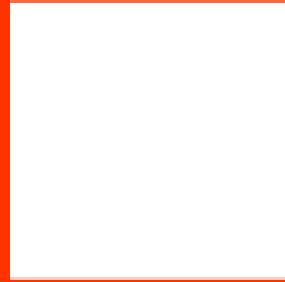

Preferred Alternative

[illegible]

MASTER PLAN | OTTAWA AVENUE VIEW

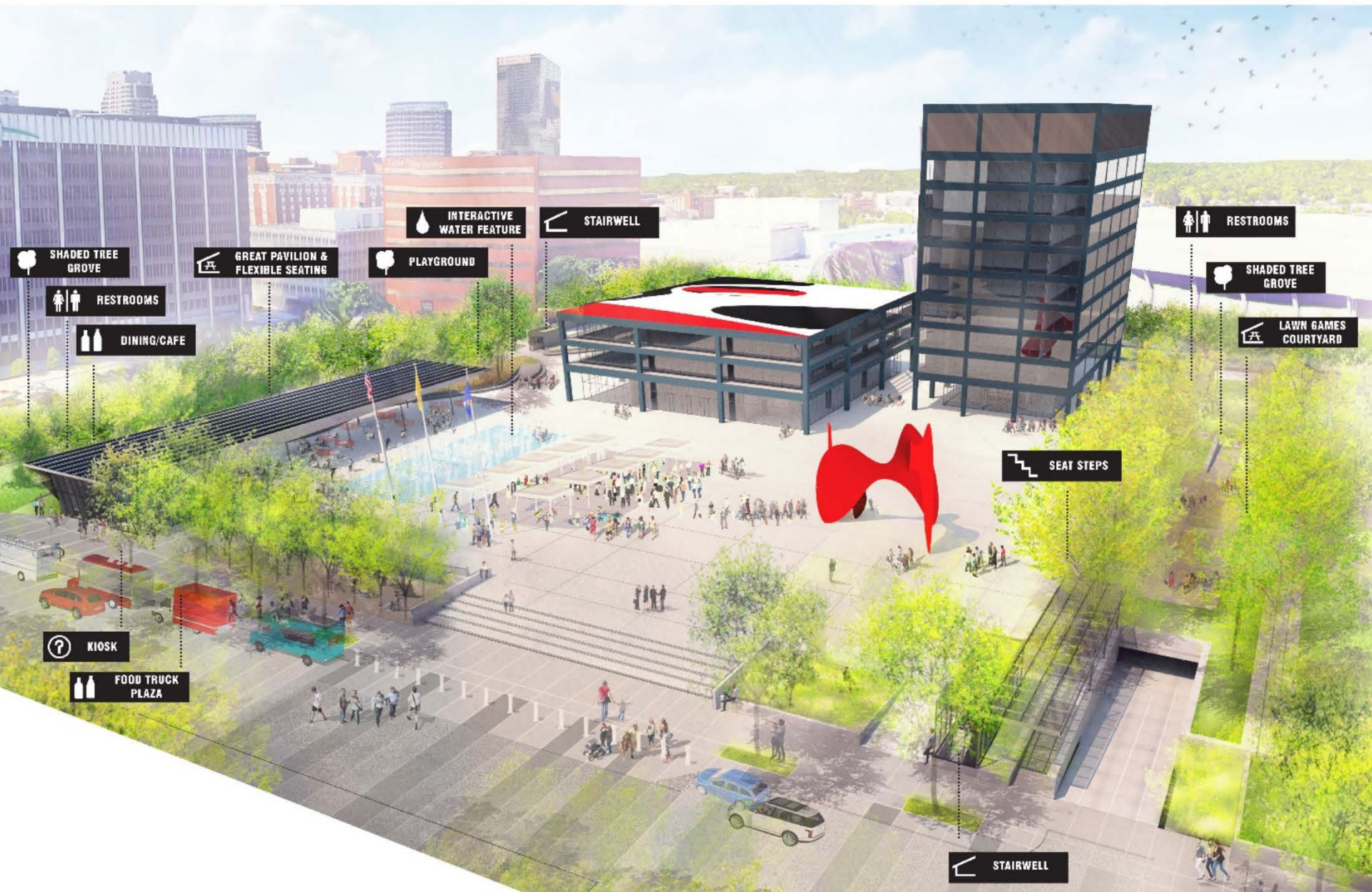

MASTER PLAN | OTTAWA AVENUE ENLARGEMENT

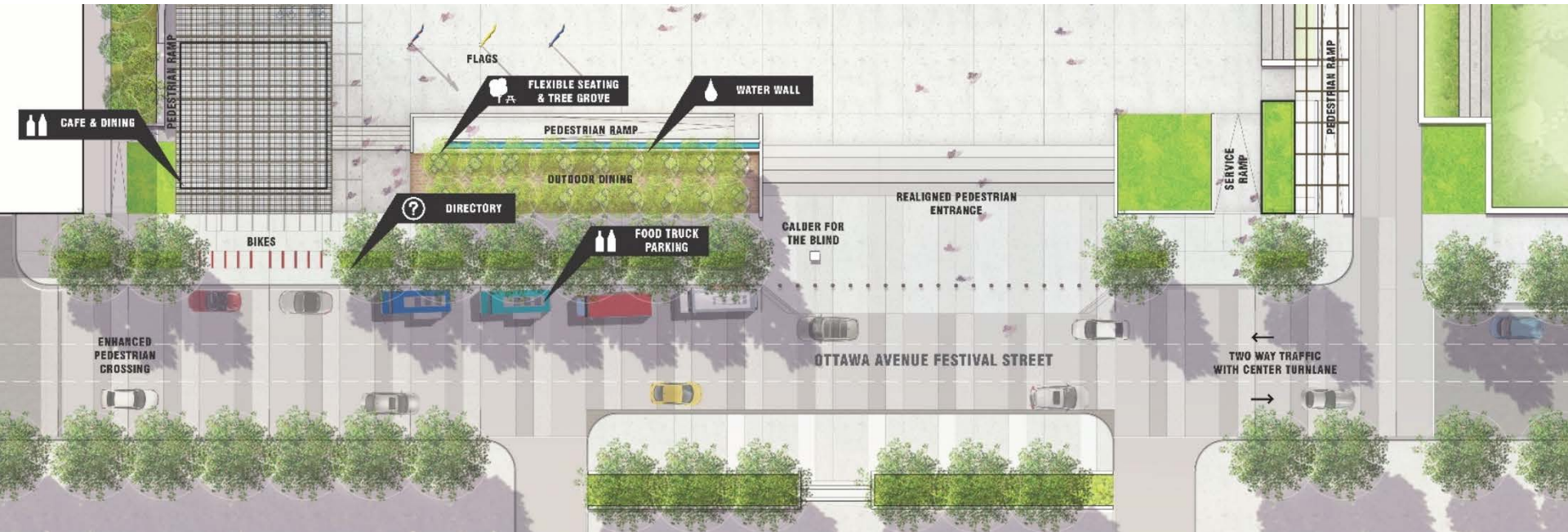

MASTER PLAN | SOUTHEAST CORNER

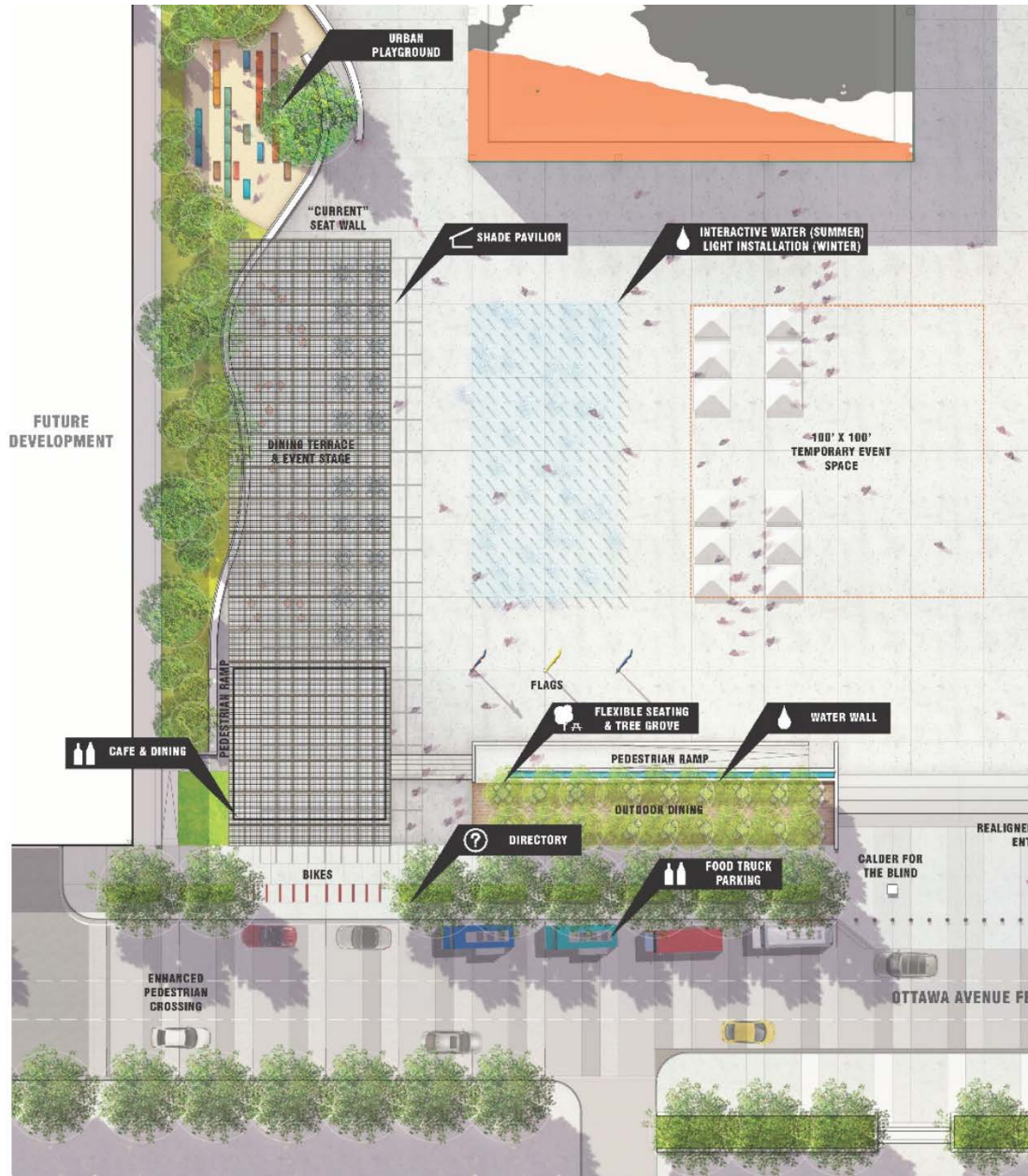

MASTER PLAN | SOUTHERN EDGE (EXISTING)



MASTER PLAN | SOUTHERN EDGE (PROPOSED)



MASTER PLAN | SOUTHERN EDGE (PROPOSED)



MASTER PLAN | NORTHEAST CORNER

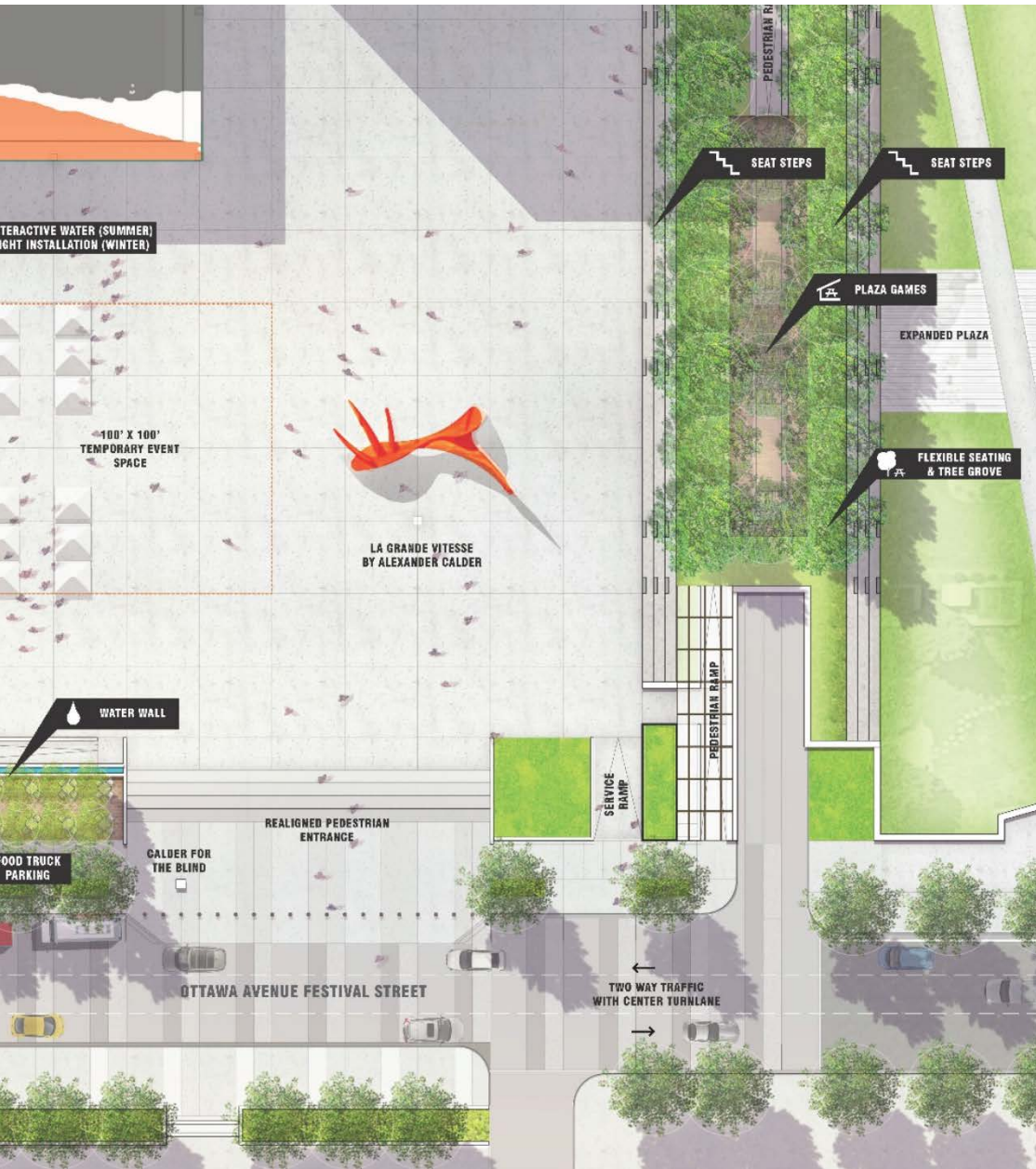

MASTER PLAN | NORTHERN EDGE (EXISTING)



MASTER PLAN | NORTHERN EDGE (PROPOSED)



DIAGRAM | HISTORICAL INTENT

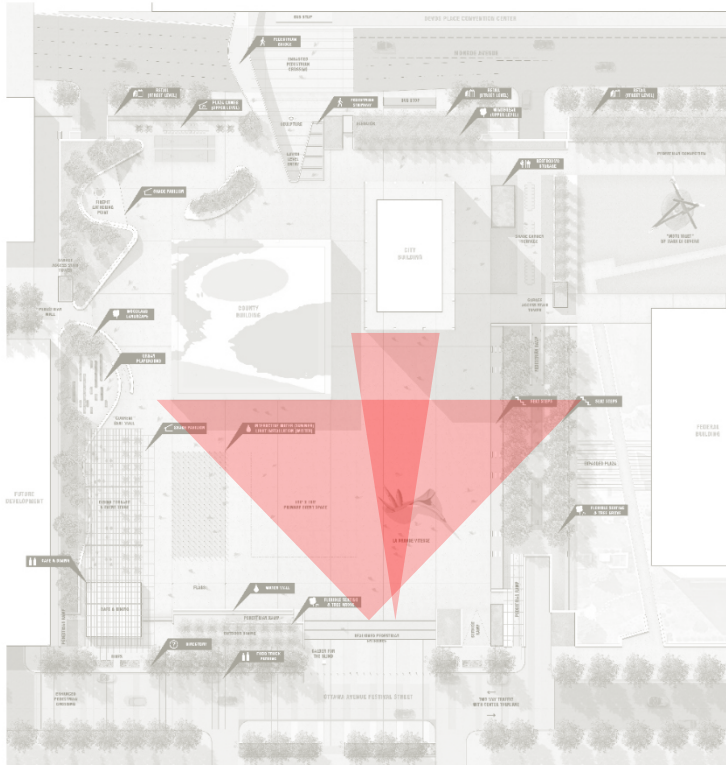

"This latest plan for the redevelopment of the plaza surrounding Calder's iconic sculpture *La Grande vitesse*, 1969, addresses the public's need to enjoy a more hospitable space as well as Calder's and SOM's modernist visions surrounding their respective masterpieces. The sight lines from the street onto the building and Calder's sculpture have been considered in the design, which I hope will reanimate this important public space for generations to come."

Alexander S.C. Rower
President
Calder Foundation, 11/4/2016

MASTER PLAN | MONROE AVENUE VIEW

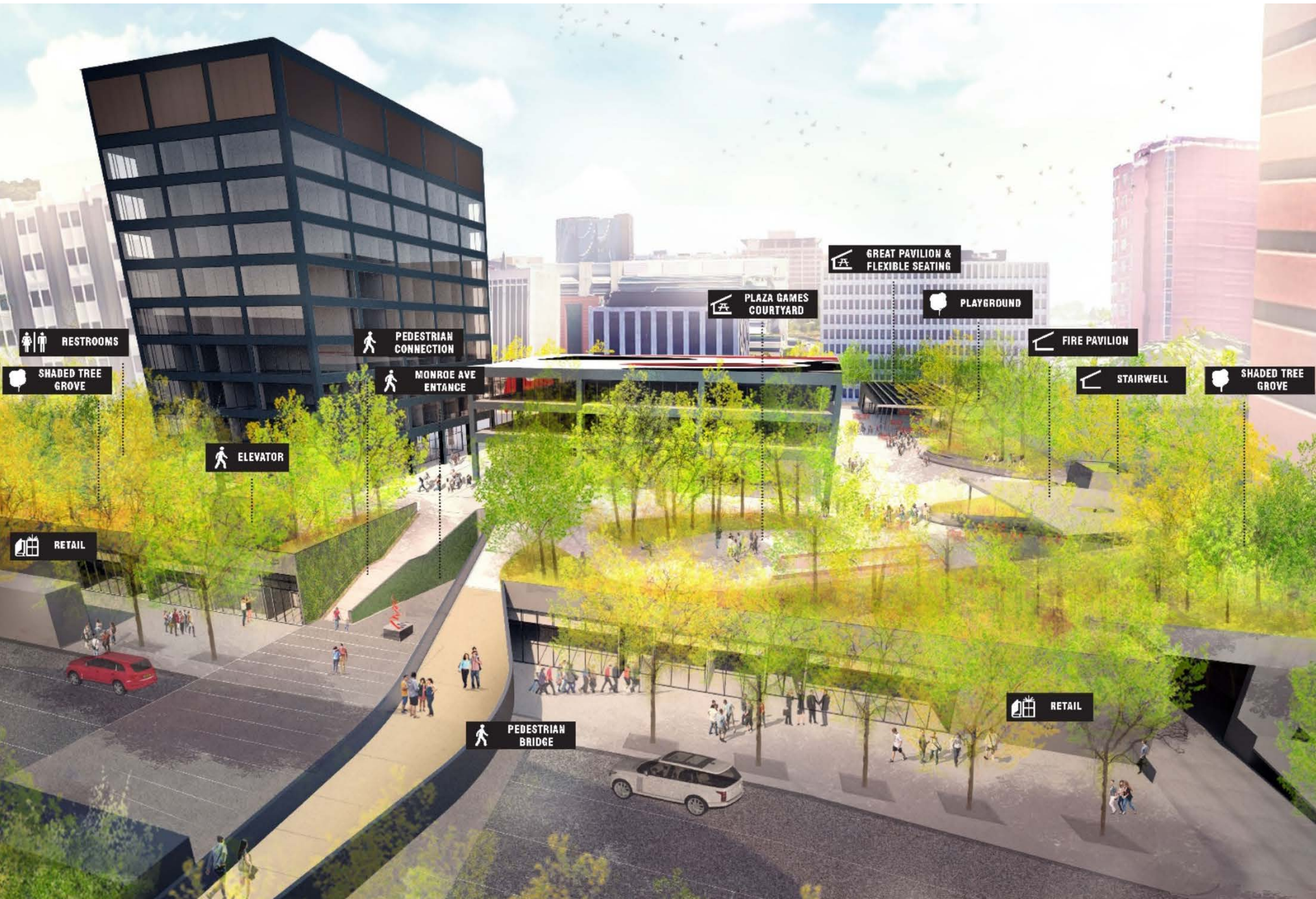

MASTER PLAN | SOUTHWEST CORNER

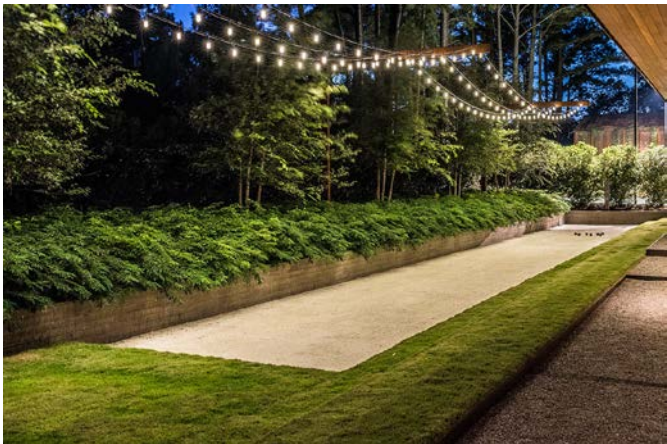

MASTER PLAN | SOUTHWEST CORNER



MASTER PLAN | SOUTHWEST CORNER



MASTER PLAN | NORTHWEST CORNER

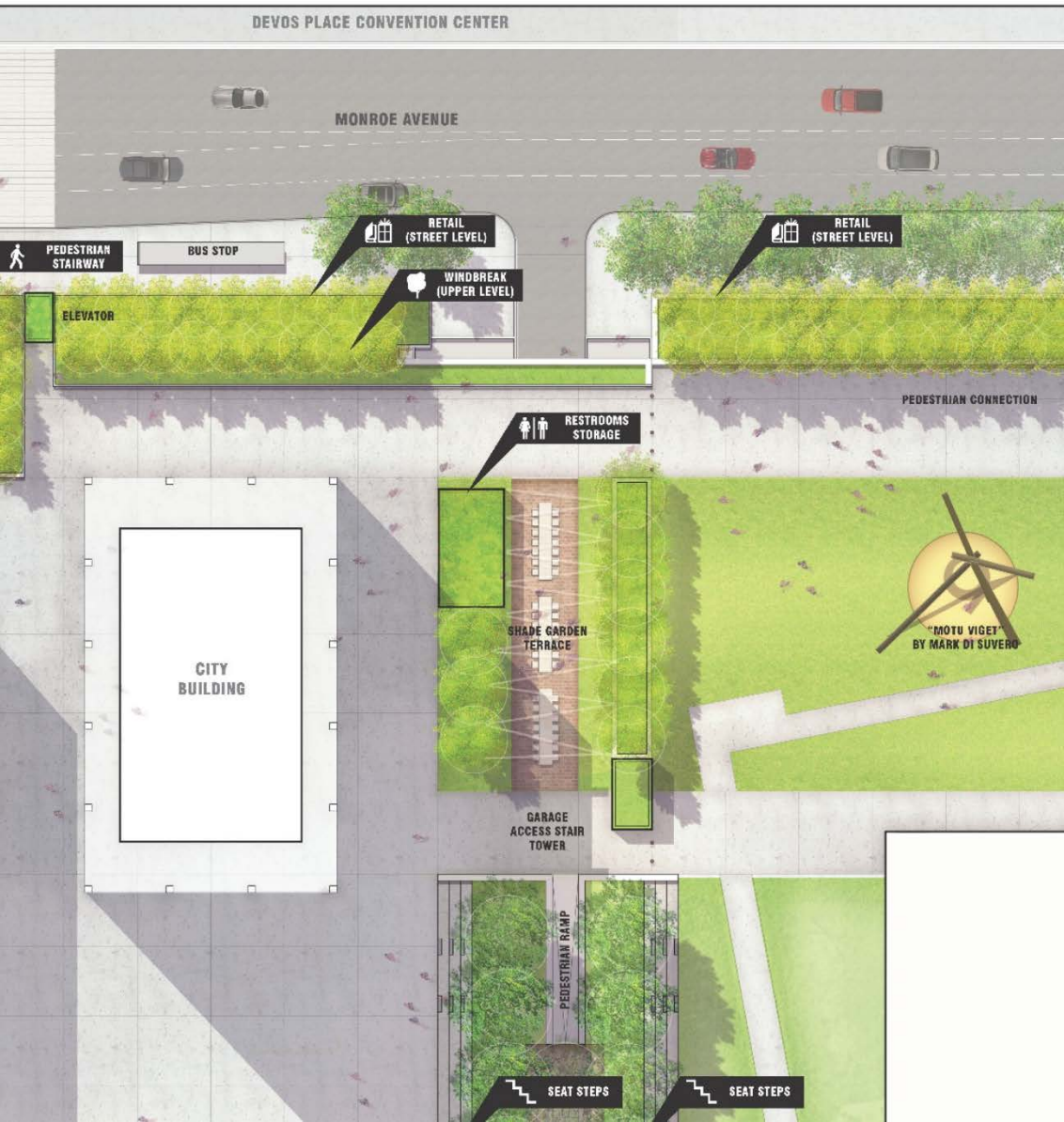

MASTER PLAN | MONROE AVENUE ENLARGEMENT

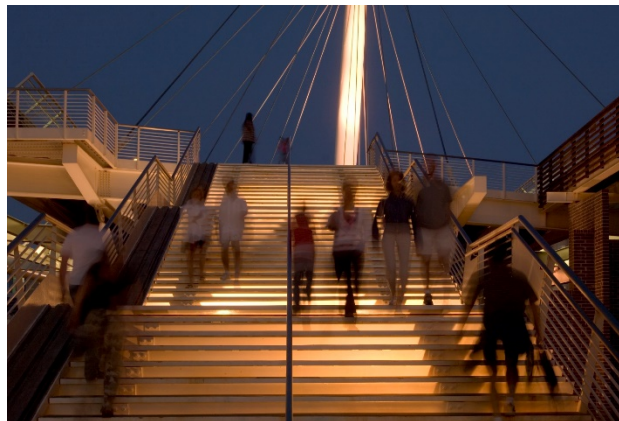
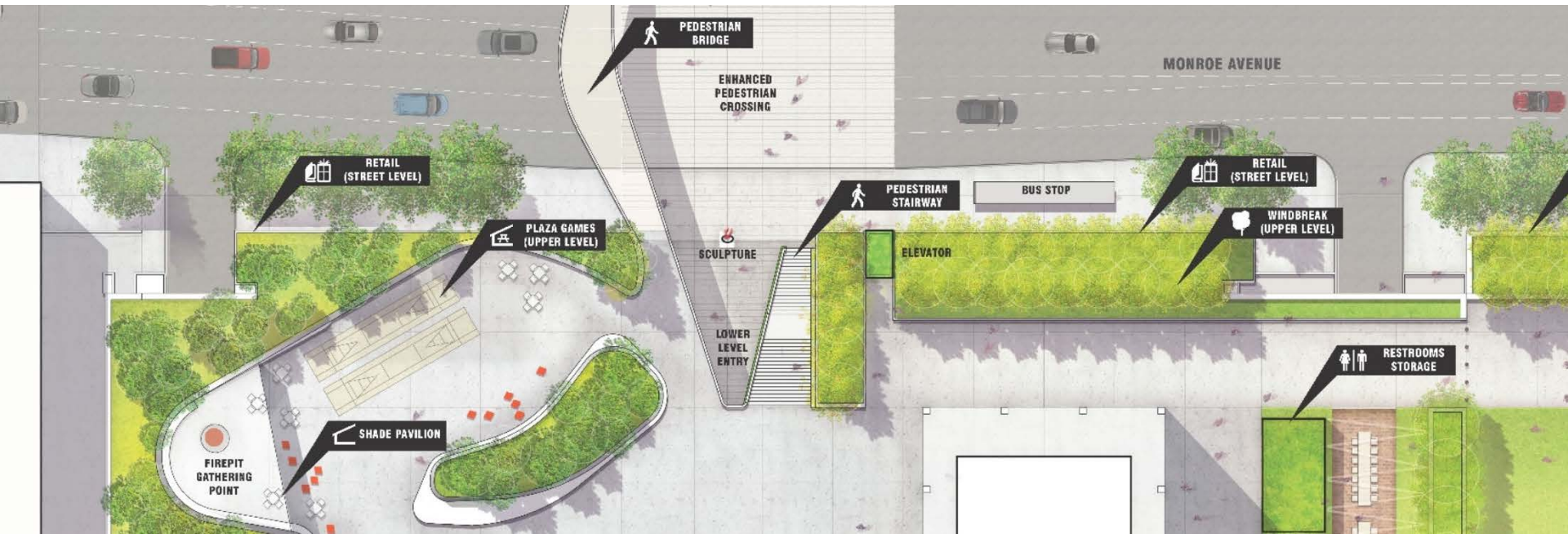

DIAGRAM | HEALTH LOOP

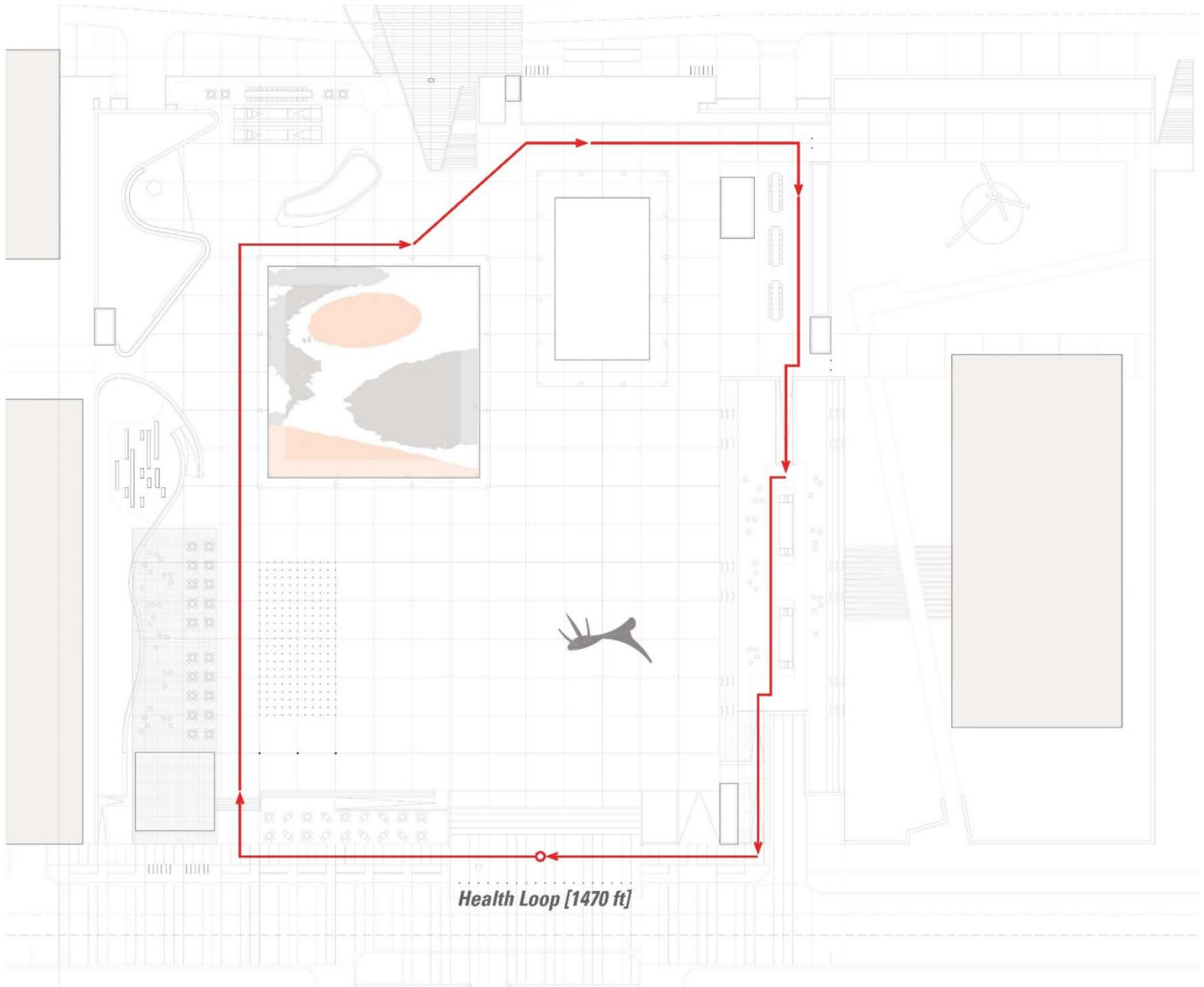
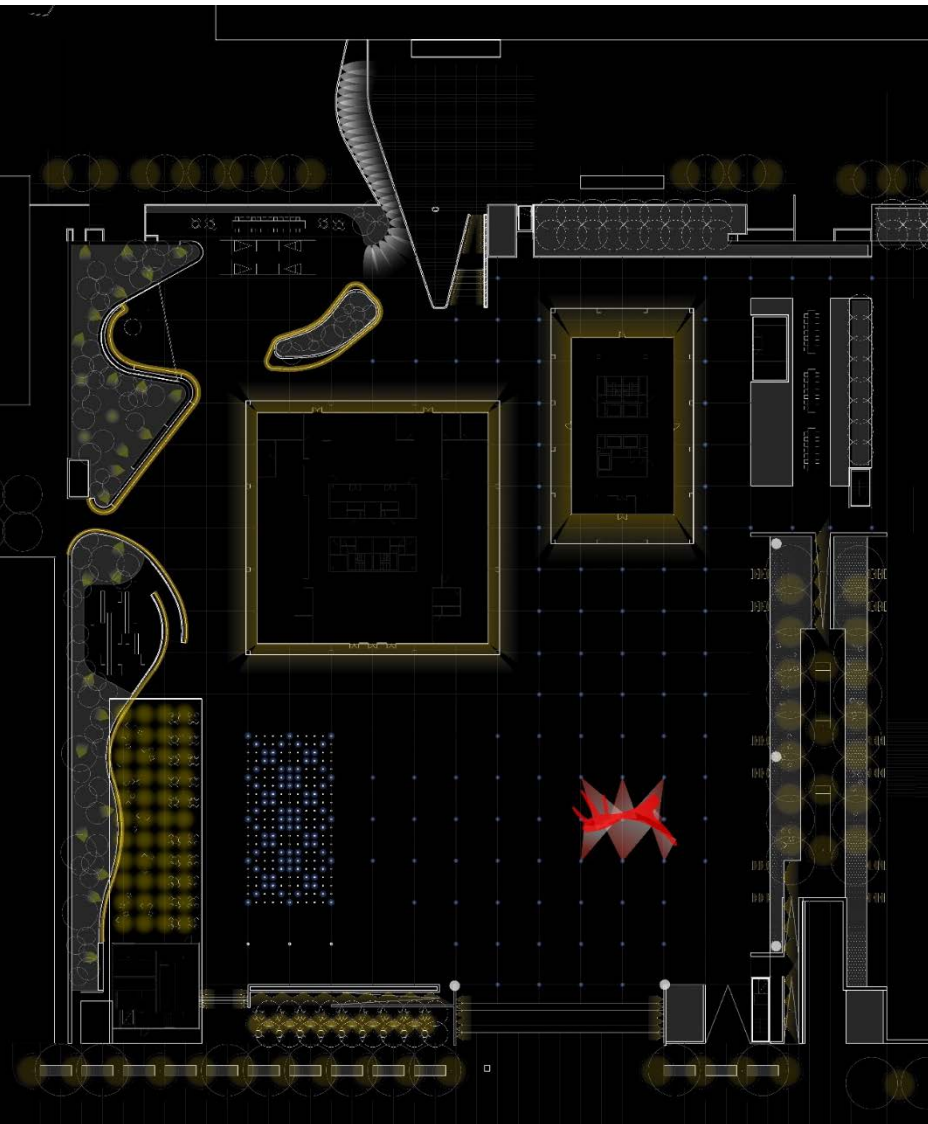
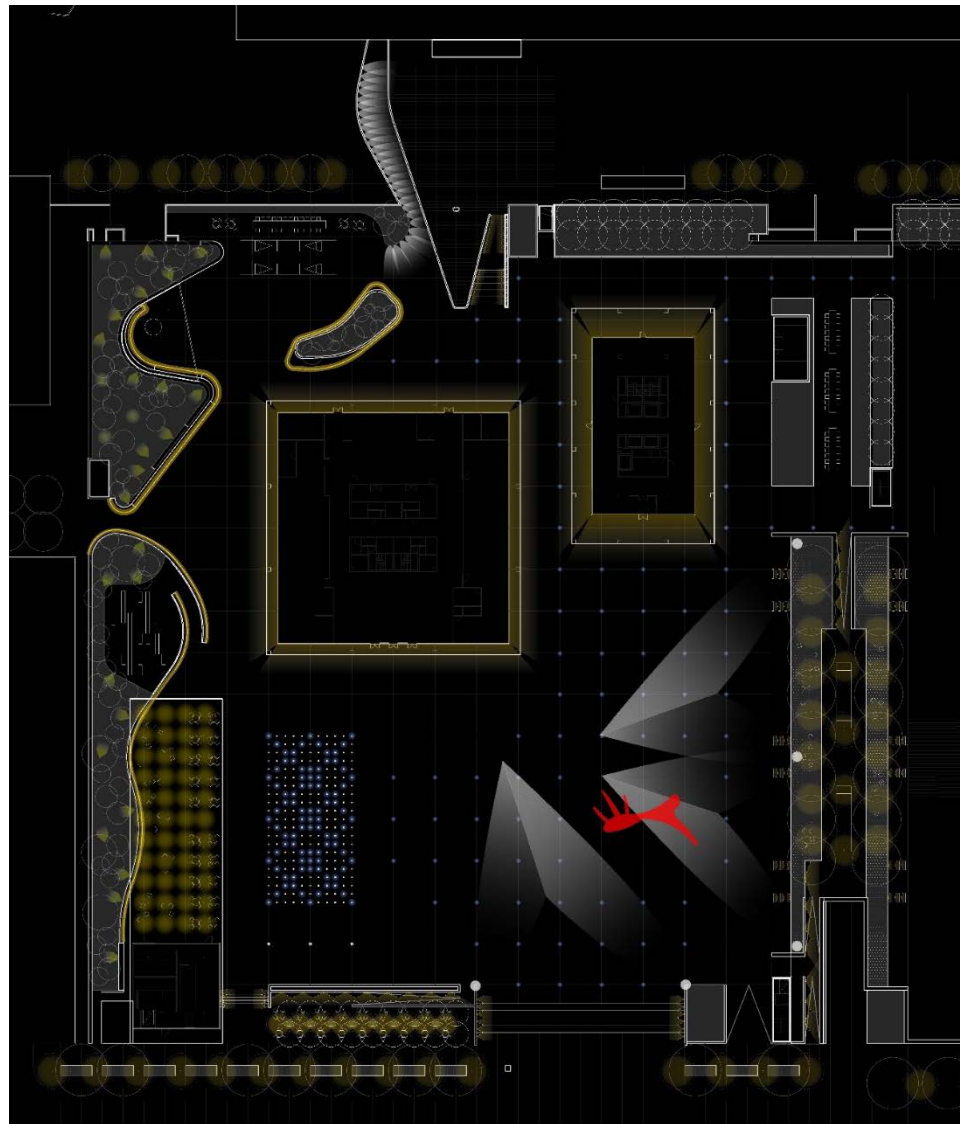

DIAGRAM | LIGHTING



Summer



Winter

DIAGRAM | LIGHTING

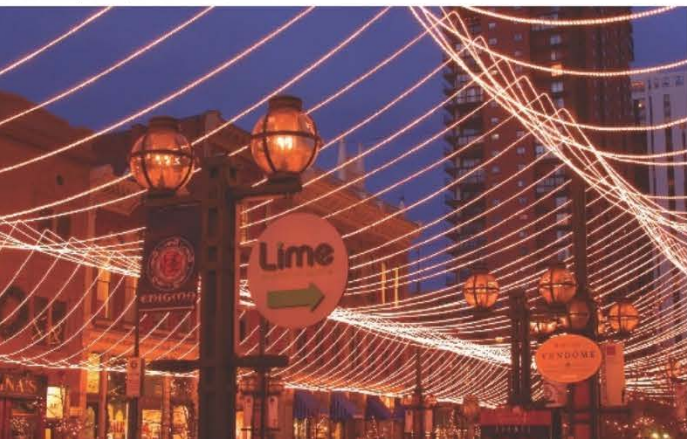
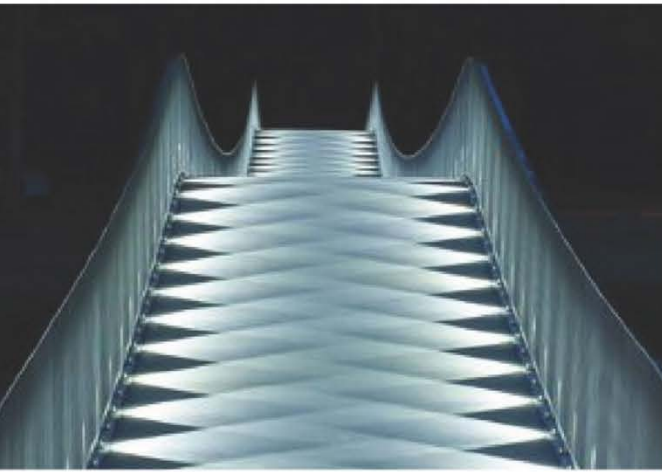

DIAGRAM | MATERIALS & PLANTING



Design by Hertz Schuadt; Photo by Hertz Schuadt (ASLA)



Photo by Hertz Schuadt; Photo by Hertz Schuadt (ASLA)



DIAGRAM & OVERVIEW | PROGRAMMING

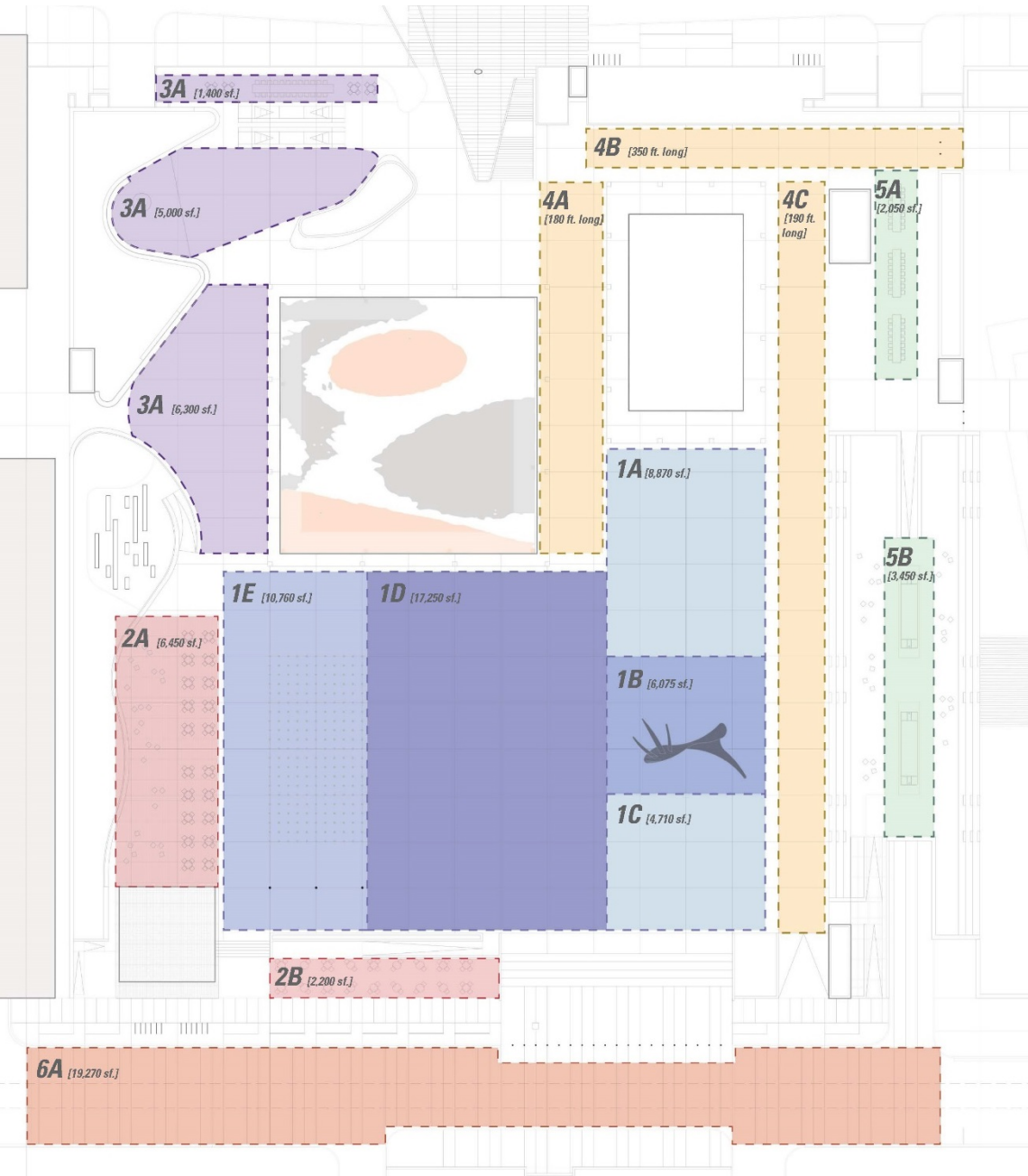

DIAGRAM | PROGRAMMING

Event Space ID	Space Description	Area or Dimensions	Usable Space (75%)	Non-usable Space (25%)	10 sf/person	15 sf/person	25 sf/person	Assumptions/Notes
1	Main plaza space	37,150	27,863	9,288	2,786	1,858	1,115	1A + 1B + 1C + 1D + 1E
1A	Plaza between sculpture and building	8,870	6,653	2,218	665	444	266	
1B	Sculpture area	6,075	3,645	2,430	365	243	146	Assumes 60% usable, 40% non-usable because of sculpture, not suitable for events with large setup, or limited tented events
1C	Between sculpture and	4,710	3,533	1,178	353	236	141	
1D	Entry plaza	17,250	12,938	4,313	1,294	863	518	Entry plaza can be served as an extension to 1E and 2A
1E	Water Feature Plaza	10,760	8,070	2,690	807	538	323	Water feature can be turned off for events and setup, 1E can also be served as an extension of 2A
2A	Informal Seating	6,450	4,838	1,613	484	323	194	
2B	Entrance Seating	2,200	1,650	550	165	110	66	
3A	Long table seating	1,400	1,050	350	105	70	42	Informal events (minimal setup)
3B	Plaza Space	5,000	3,750	1,250	375	250	150	Informal events (some setup allows), can be used with 3C
3C	Plaza Space by building	6,300	4,725	1,575	473	315	189	Informal events (some setup allows), can be used with 3B
4A	Space between buildings	180' long	135	45	10 tents	n/a	n/a	Assumes 14 lf per 10' x 10' tent
4B	Linear space along east edge of plaza	350' long	263	88	19 tents	n/a	n/a	Assumes 14 lf per 10' x 10' tent
4C	Linear space below bosque	190' long	143	48	10 tents	n/a	n/a	Assumes 14 lf per 10' x 10' tent
5A	Long table seating	2,050	1,538	513	154	103	62	Informal events (minimal setup), area may be reserved for private use
5B	Game area	3,450	2,588	863	259	173	104	Informal events (minimal setup), area may be reserved for private use
Totals		74,515	54,975	19,540	5,498	3,665	2,199	Excludes linear areas (4A-C)

Street Level

Event Space ID	Space Description	Area or Dimensions	Useable Space (75%)	Non-usable Space (25%)	10 sf/person	15 sf/person	25 sf/person	Assumptions/Notes
ST	Street	16,675	12,506	4,169	1251	834	500	ST1 + ST2, can be used as a "standalone", or an extension of the plaza for large events
ST1	Street plaza	10,000	7,500	2,500	750	500	300	Ideal for food trucks, or other large setup
ST2	Street plaza extension	6,675	5,006	1,669	501	334	200	
Totals		16,675	12,506	4,169	1,251	834	500	

DIAGRAM | WAYFINDING/SIGNAGE/FURNISHINGS

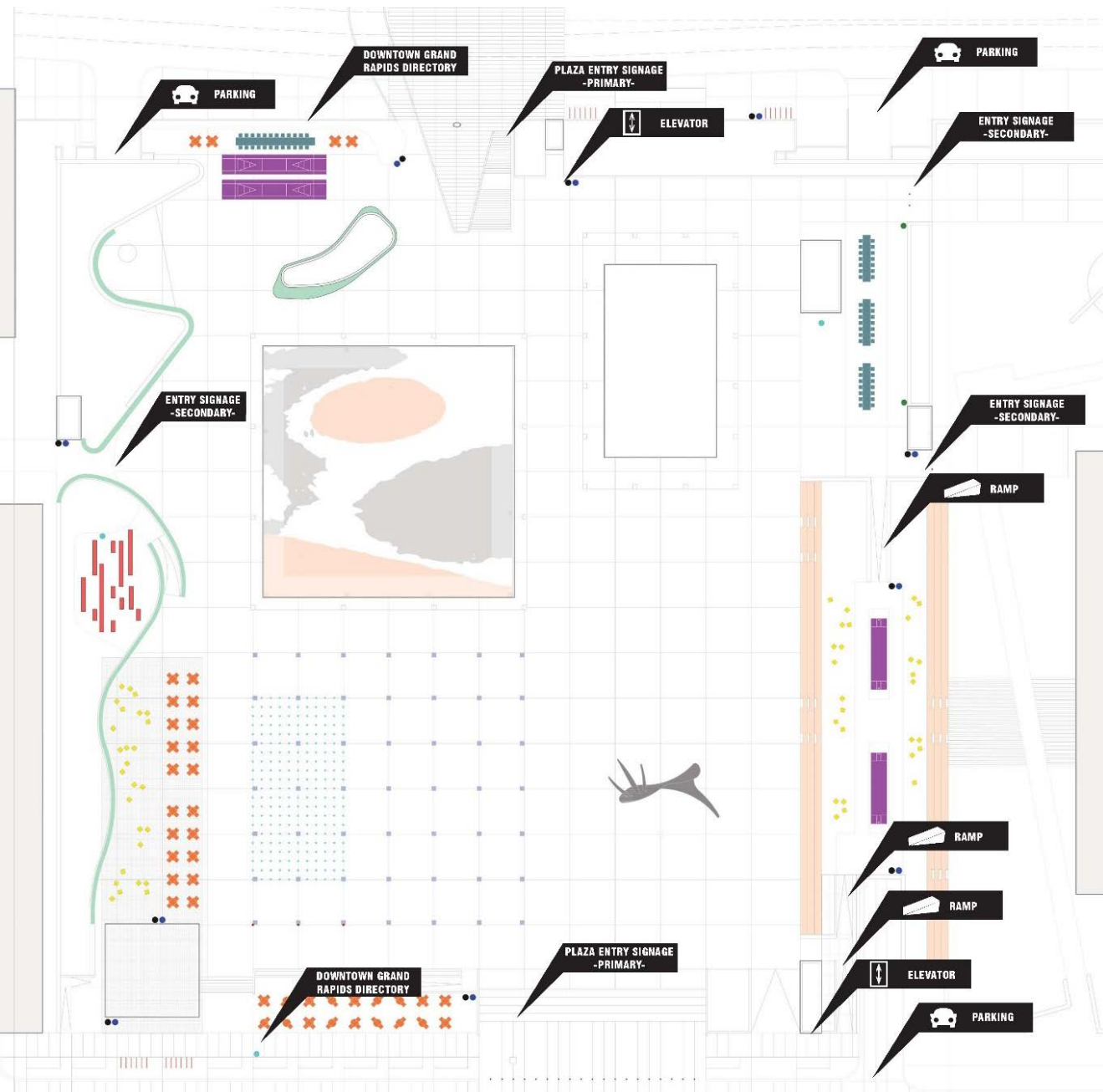

-  Linear Bench
-  Integrated Public Stairs
-  Moveable Chairs/Tables
-  Moveable Chairs
-  Games
-  Tent Tiles
-  Removeable Bollards
-  Playground
-  Bike Racks
-  Trash and Recycling Cans
-  Water Fountain and Bottle Filling
-  Dog Waste Bag Dispenser

NEXT STEPS

Provide Comments via Survey Cards or www.downtowngr.org next week

December 2016

Final Master Plan Booklet Complete

Winter 2017

Budgeting Discussion

Spring 2017

Development of Technical Documents

Spring 2018

Construction

