

EAI Pointoselect Three Device Stand Assembly Instructions

Detailed video instructions are available by scanning the QR code, or visiting this link:

<https://acubrain.com/stand-assembly-instructions>





Thank you for purchasing this customized stand for the EAI Pointoselect Digital Devices.

Video:



No tools are necessary to assemble this stand. Hand tighten each connection loosely to start, and increase pressure as needed to maintain a grasp for each individual connection point. Take care to not over-tighten any knobs, locks, clamps, or the like.

To assemble your stand, please follow these instructions:

		
1. Loosen the knob to extend the base legs, extend the legs until a stable base is achieved, then tighten the knob to hold that position.	2. Loosen the knobs on both the vertical extensions, extend these 4-6 inches each, and then tighten the knobs to hold the vertical position.	3. Loosen both knobs on the mid-pole clamp, swinging the side knob past the locking arm to allow the clamp to fully open.
		
4. Close the clamp around the top extension pole, near the connection with the vertical locking knob. Swing the side knob back into the locking arm and tighten to hold the clamp in place. Adjust the mid-mount knob on this clamp if needed to secure the position on the pole.	5. Install the hook onto the mid-pole clamp by threading the screw from the clamp into the receiver of the hook. Adjust the locking knob on the clamp to lock the hook in position with the hook point extending up.	6. Loosen the locking knob on the shelf to allow the shelf clamp to slip over the top extension pole. Place the clamp around the pole and tighten the knob to hold the shelf in place. This shelf should be installed immediately below the top silver “neck” of the stand.

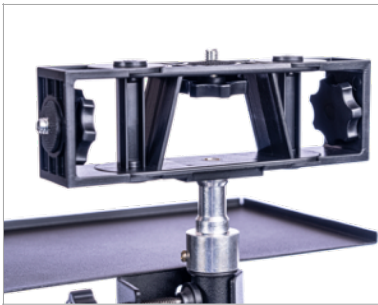

7. Remove the black screw cap from the very top of the stand pole, on the silver “neck” of the stand, to reveal the threaded screw extension. Install the rectangle three knob head on this extension by threading the receiver of the head onto the threaded screw of the neck. Tighten to firm.



8. Install the angle adapter onto the top of the head by screwing the middle threaded knob screw into the threaded receiver of the angle adapter.



9. Install 1 device clamp onto the top of the angle adapter by threading the device clamp onto the receiver screw. Important: This middle device clamp should use the threaded receiver on the long side of the device clamp. Use adjustment knobs on the angle adapter to tighten the device clamp and to secure the desired angle for the final position of the device.



10. Install 2 device clamps onto either side of the head by threading the locking screw knobs on either side of the head into the threaded receivers on the short side of the device clamps. Adjust the angle of these clamps to the desired angle for the final position for each device.



11. The stand is now setup and final adjustments can be made to final orientation for each of the accessories. Height can be set, the shelf should be rotated to the “back” of the head, and the cable hook can be set in the position for easiest accessibility.

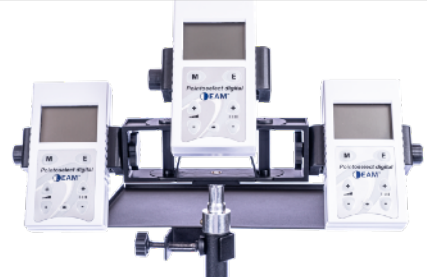

12. Mount the EAI Pointoselect devices into the device clamps by loosening the device clamp knob, inserting the device, and tightening the knob until the device is secure in the clamp. Repeat for each device until all devices are locked in place.



13. Plug into each EAI Pointoselect device the handset that will be used. Be sure to include the grounding bar with each Point Probe handset. The handsets can be positioned on the stand shelf, and the wires can be placed over the hook to allow them to hang cleanly from the stand.



14. Additional adjustments can be made by simply loosening, adjusting, and tightening the locking position of and of the adjustable knobs on the stand.