

# Wicket User Manual



**Version 1.1**

March 2017

## Hello.

This guide shows what your Dispel Wicket does, helps you set it up, and gets you up and running.

Your account is configured and ready to go, so you can start using your Wicket right out of the box.

## Table of Contents

Hello	2
Table of Contents	3
Your Dispel Wicket	4
Included in your box	6
Setting Up Your Wicket	7
Operating the Dispel Wicket	14

### Questions?

Email                      support@dispel.io  
Phone                      +1.917.740.0917

## Your Dispel Wicket

This section describes the Dispel Wicket body.

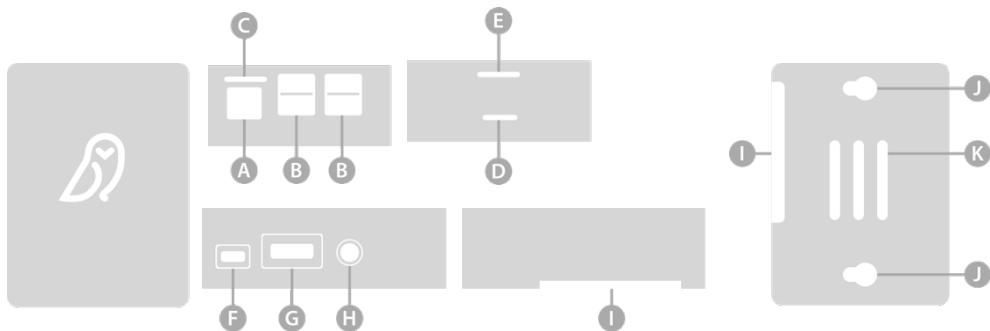

---

**A** **Ethernet port**  
Secured Internet output.

---

**B** **USB ports**  
External Internet input.

---

**C** **Air vent**

---

**D** **microSD slot**  
Please do not remove this chip. It contains the Dispel Wicket system.

---

**E** **Status light**

---

---

**F** **Power**  
A microUSB port.

---

**G** **HDMI**

---

**H** **Audio**

---

**I** **Air vent**

---

**J** **Wall mount**

---

**K** **Air vent**

---

## Included in your box

In addition to your Wicket, we have included the following:



L

microUSB-  
power supply



M

Ethernet cable



N

Ethernet-to-  
USB adapter

## Setting Up Your Wicket

Your Wicket will need, in the following order:

1. A connection from the External Internet;
2. A connection to whatever is being secured (a LAN or WiFi router, or your computer); and
3. Power.

The purpose here is to put the Wicket between the outside world and your devices.



## External Internet

The External Internet connection plugs into any one of the USB ports **B** on the Wicket. Please only plug one External Internet connection into the Wicket at a time.

You will need an Ethernet-to-USB adapter **N** for the external Internet connection. We have provided one in your setup box, but any will do.

- STEP 1 of 3** Connect an Ethernet cable to a LAN port on your External Internet (your modem). Please do not use the WAN port for connecting to the Wicket. It will not work.

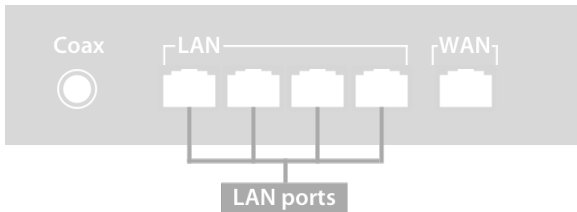



**STEP 2 of 3** Connect the Ethernet cable coming from the External Internet (your modem) into an Ethernet-to-USB adapter **N**.

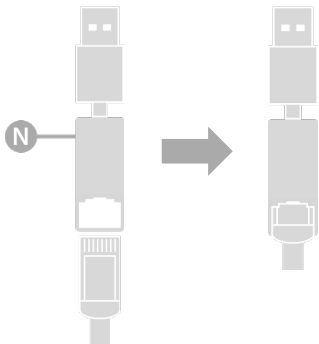

**STEP 3 of 3** Plug the Ethernet-to-USB adapter **N** into any of the USB ports **B** on the Wicket.

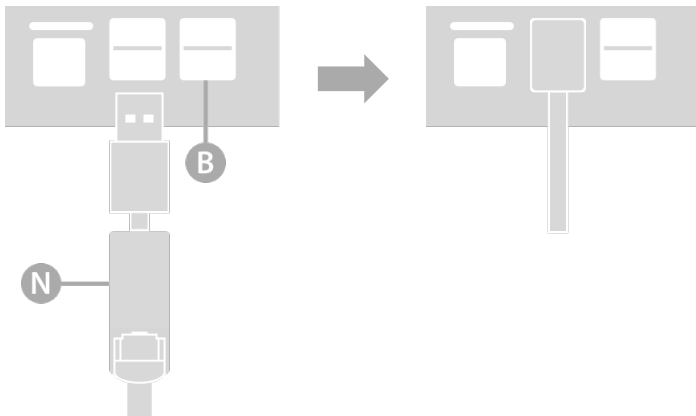

## Secured Internet Connection

Any devices connecting to the Ethernet port **A** will be protected by Dispel, and give the devices connected to that port access to Project resources the Wicket has access to.

**STEP 1 of 2** Connect the Ethernet cable **M** to the Ethernet port **A** on the Wicket.

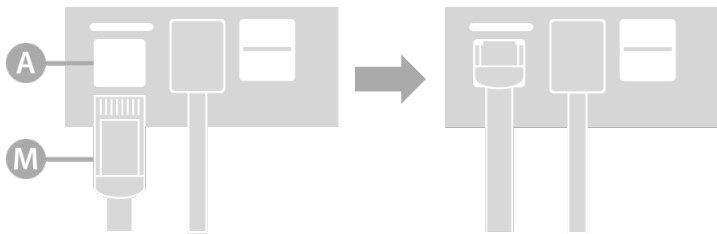

**STEP 2 of 2** Connect the Ethernet cable **M** from the Wicket to your router (LAN or Wi-Fi) or computer.

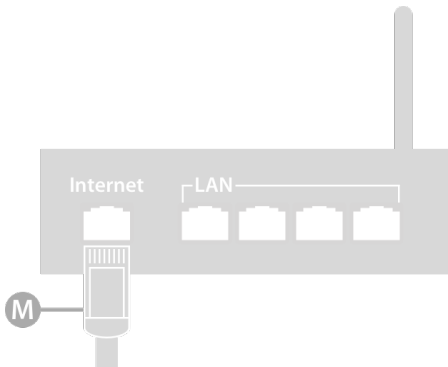

## Powering Your Wicket

Your Wicket uses a standard +5.1V, 2.5A, microUSB supply **L**. We have provided one in your setup box, but any will do.

**STEP 1 of 2** Please make sure you have plugged the Wicket into both the External Internet, and your router or computer.

**STEP 2 of 2** Plug the microUSB cable **L** into the Wicket's microUSB port **F**. When power is supplied to the cable, the Wicket will turn on.

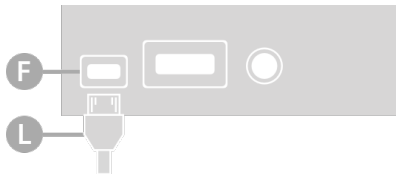

## Operating the Dispel Wicket

Once power is established, your Wicket will attempt to connect to the Dispel Project to which it is assigned as part of your license.

The Wicket status is shown by the status light at . A  icon means the light is solid.  means it is flashing.

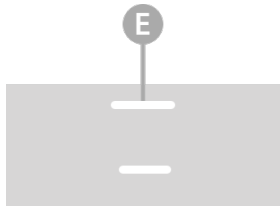

## Normal Startup

---



### System startup

While all the lights are turned on, green will appear to be the brightest. Humans see green better than all other hues.

---



### Looking for Internet connection



### Starting connection



### Connecting



### Connected

---

## Troubleshooting Startup

---



### **Error connecting**

1. Check you have an Internet connection.
2. Confirm your external and internal Ethernet cables are connected to their proper ports (external to USB, secured to the Ethernet port) prior to power-up. If they were not, just power down the Wicket, plug both Ethernet cables in, and power back up again.
3. If you have a firewall, please make sure it has been set to permit an outbound VPN connection.
4. Contact Dispel. Your Wicket may not be assigned to a Project.



Thank you.

Written in New York City. Printed in the United States of America.