

How to Change Settings as You Use a Project

Change the ID

Sometimes you must use an ID that is not the next ID in the set, an ID that is not in the ID set, or an ID you used before. You can change the ID on the **CHANGE ID** screen before you do a test or enter the ID on the **SAVE RESULT** screen after you do a test.

To use a different, unused ID from an ID set that has a first and last ID

If **Auto Save** is on or off:

- 1 On the home screen, tap the **Next ID** panel.
- 2 On the **CHANGE ID** screen, tap an ID in the list under **IDs Untested**, then tap **DONE**.
- 3 Do the test. After you save the results, the tester uses the next ID in the set for the next results.

If **Auto Save** is off:

- 1 Do the test, then tap **SAVE** if the test passed or **FIX LATER** if the test failed.
- 2 Enter the ID on the **SAVE RESULT** screen, then tap **SAVE**. After you save the results, the tester uses the next ID in the set for the next results.

To use an ID you used before

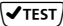
- If the test failed before,
 - 1 Turn on **Auto Save**.
 - 2 Select the saved result on the **RESULTS** screen.
 - 3 Tap **TEST AGAIN** or press .

- If the test passed before,
 - 1 Do the test again.
 - 2 Enter the ID on the **SAVE RESULT** screen.

To use an ID that is not in an ID set that has a first and last ID

If **Auto Save** is on or off:

- 1 On the home screen, tap the **Next ID** panel.
- 2 On the **CHANGE ID** screen, tap the panel that shows the **Next ID**.
- 3 Use the keyboard to enter an ID, then tap **DONE** on the keyboard.

The tester asks you if you want to create a new ID set.

- 4 Tap **YES** in the dialog box, then tap **DONE**.
- 5 Do a test.

The tester saves the results with the ID you entered. It saves subsequent results with the IDs from the new set.

To use IDs from the set you used before, go to the **CHANGE ID** screen, tap **CHANGE CABLE IDs**, tap the ID set, then tap **USE SELECTED**.

If **Auto Save** is off:

- 1 Do the test.
- 2 Then tap **SAVE** if the test passed or **FIX LATER** if the test failed.
- 3 Enter an ID on the **SAVE RESULT** screen, then tap **SAVE**.

The tester saves the result with the ID you entered. The next ID the tester uses is the next ID from the set.

If the ID you used is in another set in the project, the tester removes that ID from the **IDs Untested** list for the same type of test.

If the ID you used is not in any set in the project, and the project contains one or more sets that have first and last IDs, the % **Tested** value includes test you saved with the ID. For example, if you have one set with 10 IDs, and you save 1 result with an ID that is not on the set, the % **Tested** shows 9% (1 saved result divided by 11 IDs).

To change the ID when the set has only a next ID

You can change the ID on the **CHANGE ID** screen before you do the test. Or, you can turn off **Auto Save**, then enter an ID on the **SAVE RESULT** screen after you do the test. For both methods, the tester changes the set to use the ID you entered as the **Next ID**.

To Change the Tests in a Project

When you use a project, you usually do only the tests that the project specifies. You select these tests from the list on the **CHANGE TEST** screen in the project.

If necessary, you can add a test to the project or change the settings for a test in the project.

To select a different test in the project

- 1 On the home screen, tap the test setup panel.
- 2 On the **CHANGE TEST** screen tap the test you want to do.
- 3 Tap **USE SELECTED**.

To add a test to a project

- 1 On the home screen, tap the test setup panel or the **PROJECT** panel.

- 2 Tap **NEW TEST**.
- 3 On the **TEST TYPE** screen, tap a test.
- 4 On the **TEST SETUP** screen, change the test settings as necessary, then tap **SAVE**.

To include a fiber test in the % Tested value

If you add an OptiFiber Pro OTDR, CertiFiber Pro loss length, FiberInspector, or FaultMap test to a project, but do not select the test on the **CABLE ID SETUP**, **EDIT CABLE IDs**, or **IMPORTED IDs** screen, the results you save for the test do not affect the % **Tested** value. To include a test in the % Tested value

- 1 On the home screen, tap the **PROJECT** panel, then on the **PROJECT** screen, tap a fiber ID set that has a **First** and **Last ID**.
- 2 On the **EDIT CABLE IDs** screen, or the **IMPORTED IDs** screen (for ID sets downloaded from LinkWare PC or LinkWare Live), select the test under **Select Fiber Tests**.
- 3 Tap **SAVE**, then tap **DONE**, or for **IMPORTED IDs**, tap **DONE** then tap **DONE** again.

To Change the Project

To save results in a different or new project

- 1 Press home.
- 2 Tap the project panel.
- 3 Tap **CHANGE PROJECT**.
The **CHANGE PROJECT** screen shows on the display.
- 4 Select a different project, or tap **NEW PROJECT** to start a new project.

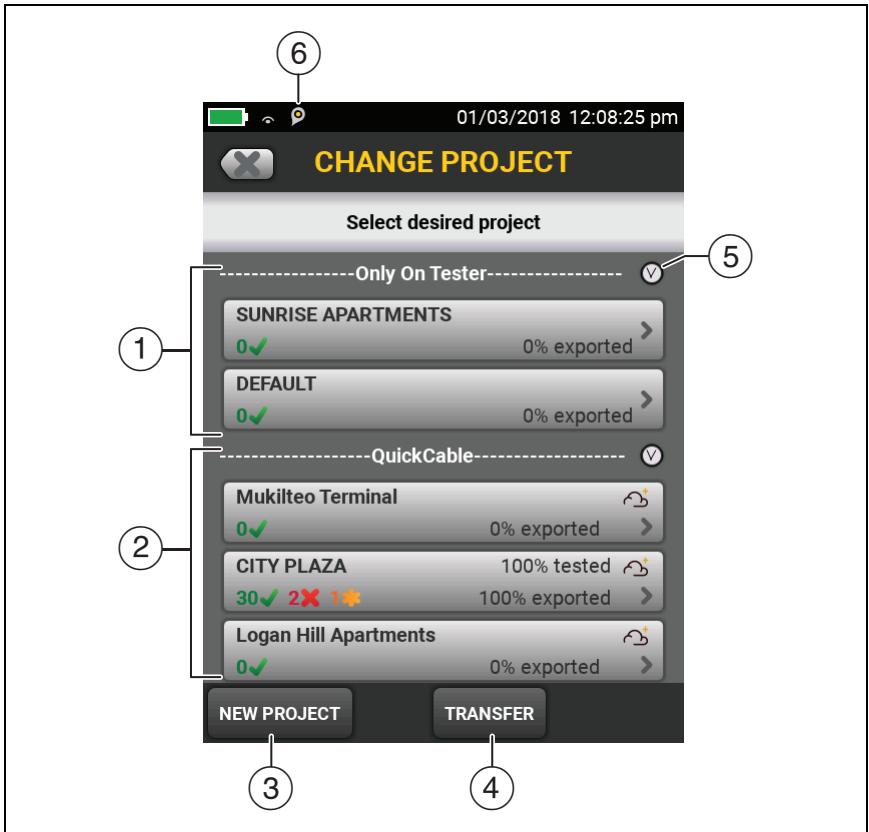

The CHANGE PROJECT Screen

- ① These projects are only on the tester. They have not been synced to LinkWare Live. The % **exported** value shows the percentage of the results that has been exported to a USB flash drive.
- ② These projects have been synced to the LinkWare Live organization shown ("QuickCable" in this example). The % **exported** value shows the percentage of the results that has been exported to LinkWare Live.

 The cloud and “+” icon shows that the project is on the tester and in LinkWare Live.

Note

*When the tester is signed in to LinkWare Live, this screen does not show projects that are only in LinkWare Live. To see those projects, tap **TRANSFER**, then tap the **LinkWare Live** panel.*

- ③ Tap **NEW PROJECT** to create a new project.
- ④ **TRANSFER** lets you sync projects with LinkWare Live, export or import results to or from a flash drive, and delete results on the flash drive. The **TRANSFER** function also lets you sync project setups and results with LinkWare Live.

- ⑤ Tap  to collapse or expand the list of projects.

Projects downloaded from LinkWare Live can include subprojects. On the tester, subproject names show with the project name: **Project Name>>Subproject Name**.

LinkWare Live will not use subproject names you create on the tester. If you use the format “**Project Name>>Subproject Name**” to enter names on the tester, then sync the project to LinkWare Live, LinkWare Live will use both names as the project name.

- ⑥  The asset management icon shows when the owner of a LinkWare Live account has enabled the asset management service for the tester.