



# **Network Card Installation Guide**

For ASUSTOR AS6704T/AS6706T NAS

## **Table of Contents**

1.	Introduction .....	3
1.1.	Notes and Precautions .....	3
1.2.	Parts and Tools Needed.....	3
2.	Installation Guide .....	4
2.1.	Removing the Cover .....	4
2.2.	Installing a Network Card .....	5
2.3.	Replacing the Cover .....	8
3.	Appendix.....	10
3.1.	Troubleshooting.....	10
3.2.	Contact ASUSTOR Technical Support.....	10

## 1. Introduction

---

### 1.1. Notes and Precautions

1. Your AS6704T and AS6706T supports the AS-T10G2 10-Gigabit Ethernet network card. Installation of the [AS-T10G2](#) requires use of the included bracket designed for the Lockerstor Gen2 series of NAS devices.
2. Your NAS must remain powered on for the duration of the switch between PCIe mode and M.2 mode. Interrupting the power while your NAS is switching PCIe modes may result in your NAS becoming inoperable. Your NAS will restart automatically to make the switch.

### 1.2. Parts and Tools Needed

- ✓ Phillips head screwdriver

## 2. Installation Guide

### 2.1. Removing the Cover

- Shutdown the NAS by selecting **[Shut down]** from the ADM User Menu.



- Disconnect all cables and devices connected to the NAS including the power cord.

AS6704T



AS6706T

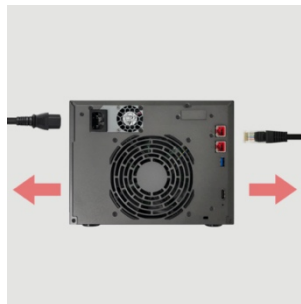

- Use a screwdriver to loosen the three screws found on the rear of the NAS as shown in the illustration.

AS6704T

AS6706T



- Grip the cover from both sides with two hands and then gently push it back to remove it from the chassis.

## 2.2. Installing a Network Card

1. To remove the M.2 card, undo the screws as shown below.

AS6704T

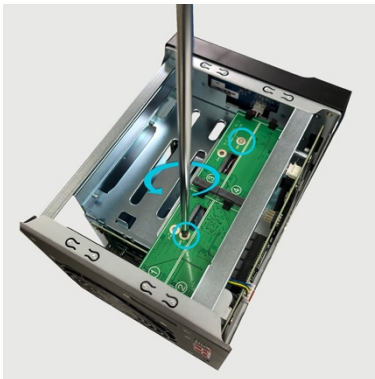

AS6706T



2. Gently pull the M.2 card from the PCIe slot as shown below.

AS6704T

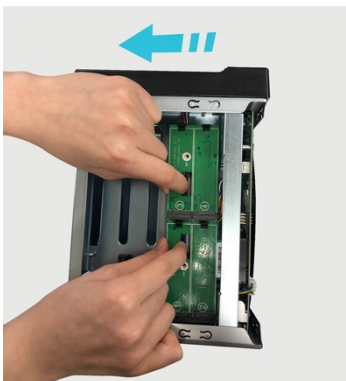

AS6706T



3. Undo the two screws that hold the bracket for the M.2 card in place.

AS6704T

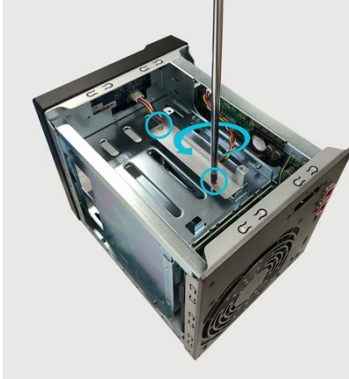

AS6706T



4. Lift the bracket out of the NAS.

AS6704T

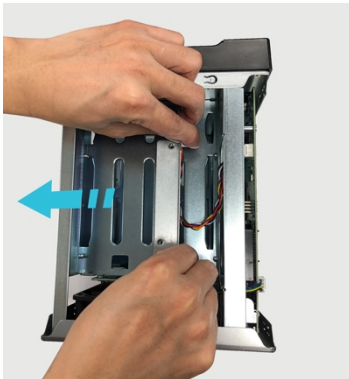

AS6706T



5. Remove both screws in the rear of the NAS and placeholder bracket.

AS6704T

AS6706T

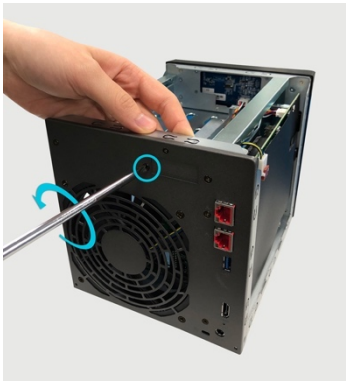

- 6. Unscrew and remove full-height bracket from AS-T10G2 NIC.

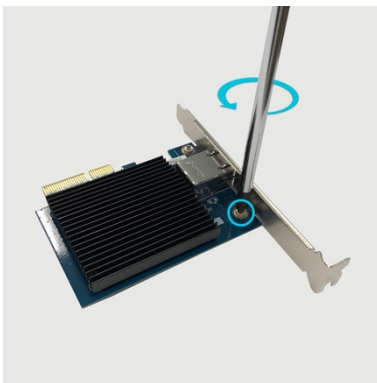

- 7. Attach NAS-specific bracket to the AS-T10G2 and fasten screws.

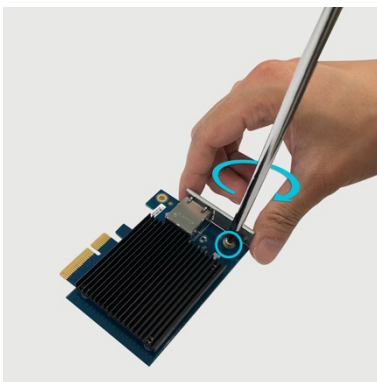

- 8. Gently insert the network card into the PCIe slot of your NAS.

**AS6704T**

**AS6706T**



9. Fasten the network card to the NAS with screws.

AS6704T



AS6706T



10. Follow these instructions in reverse order to reinstall the M.2 card.

### 2.3. Replacing the Cover

- Replace the cover and tighten the three screws that were removed previously.

AS6704T

AS6706T





- Reconnect all cables including the power cord and then start up the NAS.

**AS6704T**

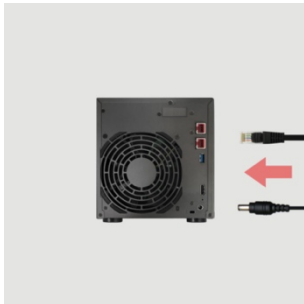

**AS6706T**



## 3. Appendix

---

### 3.1. Troubleshooting

Q: After installing network card my NAS won't start. What's wrong?

A: Please follow the steps below to resolve this issue:

1. Check if the LED indicators, system buzzer, and LCD display panel are operating normally.
2. If your NAS is unable to recognize the network card or cannot be started up properly, please check that you have used network card that is compatible with the system. Also, please reinstall the network card in order to confirm that it has been installed properly.
3. If your NAS still does not operate normally, please remove the newly installed network card, and then restart the NAS to see if it is able to operate normally.
4. If the previous steps have not solved your problem, please contact your local dealer or ASUSTOR customer service.

### 3.2. Contact ASUSTOR Technical Support

Contact us:

1. Email: [support@asustor.com](mailto:support@asustor.com)
2. Online Support Form: [http://www.asustor.com/service/online\\_support](http://www.asustor.com/service/online_support)
3. ASUSTOR Online Community: <http://forum.asustor.com/>