

# DIESEL EMISSIONS SERVICE

RETROFIT AND REPOWER SPECIALISTS

**Portland | Redding | Oakland | Ontario**

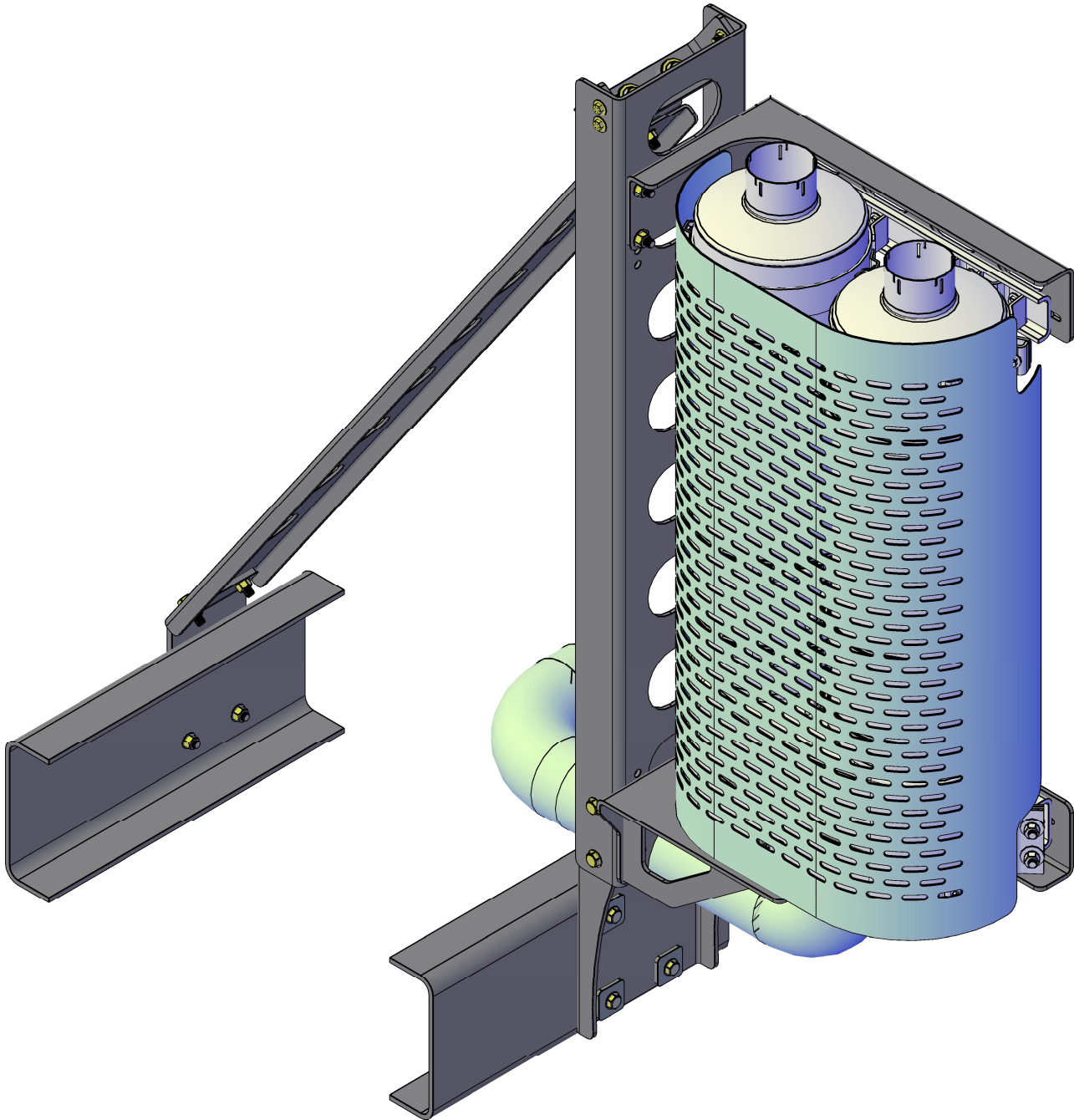

**DES M9019/M9020 DONALDSON 9.5" - 10.5"**

**ALL INSTALLATION INSTRUCTIONS AND GUIDELINES MUST BE THOROUGHLY READ AND UNDERSTOOD BEFORE INSTALLING A DIESEL EMISSIONS SERVICE PRODUCT**



## **PRODUCT GUIDELINES**

**Diesel Emissions Service recommends its products be installed by a trained technician with proper tools and safety equipment. In addition all Diesel Emissions Service mounting brackets should be installed using good judgment and sound mechanical principles. Since all installations are unique, it is the sole responsibility of the installer to determine the best fit and function of the DPF mounting brackets.**

## **PRODUCT SAFETY**

**Diesel Emissions Service products are designed for “ON-ROAD” applications only. Modifications to any Diesel Emissions Service product are not recommended and can compromise the bracket performance. Diesel Emissions Service claims no liability or responsibility for the improper application or installation of its products.**

## **PRODUCT WARRANTY**

**Diesel Emissions Service warrants to the original purchaser of its products that such products will be free from defects in material and workmanship under normal use. Diesel Emissions Service’s obligation under this warranty is solely and exclusively limited to repair and or replacement, at Diesel Emissions Service option, of the product (or components thereof) which Diesel Emissions Service’s examination proves to its satisfaction to be defective. Diesel Emissions Service SHALL HAVE NO OBLIGATION FOR CONSEQUENTIAL DAMAGES TO PERSONAL OR REAL PROPERTY, OR FOR INJURY TO ANY PERSON.**

**This warranty does not apply to products which have been subject to improper use, accident, negligence, abuse or misuse.**

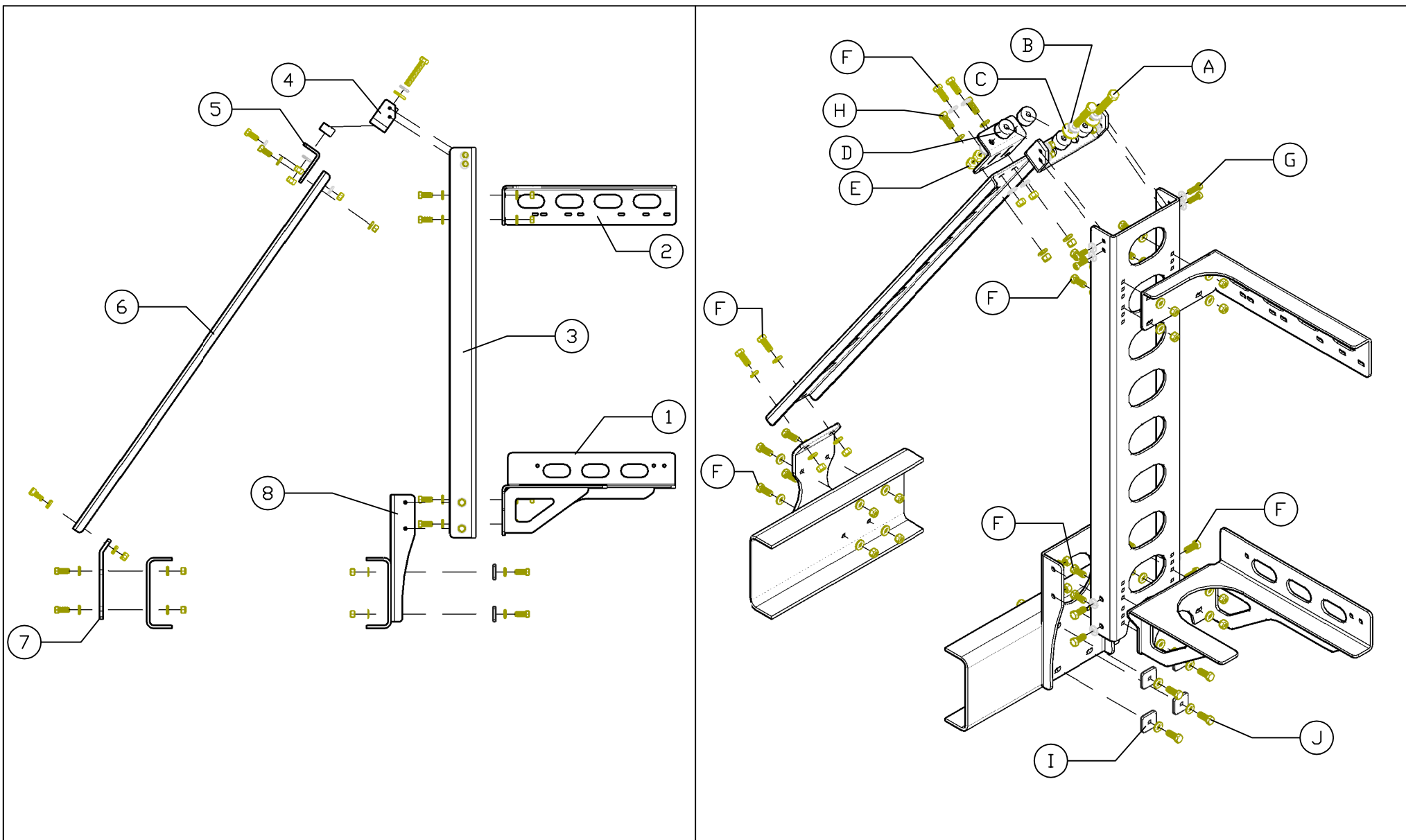

ITEM	QTY	COMPONENT DESCRIPTION	ITEM	QTY	HARDWARE DESCRIPTION	DIESEL EMISSIONS SERVICE PORTLAND REDDING OAKLAND ONTARIO 888-792-2922		
1	1	DUAL INLET MOUNTING BRACKET	A	2	5/8 -11 X 4 INCH BOLT	DONALDSON 9.5" - 10.5"		
2	1	DUAL OUTLET MOUNTING BRACKET	B	4	5/8 SAE WASHER			
3	1	VERTICAL STANCHION	C	2	5/8 USS WASHER	Size <b>A</b>  Drawing No. <b>DES M9019/M9020</b>		
4	1	UPPER ISOLATOR BRACKET	D	4	2" THICK POLY ISOLATOR			
5	1	UPPER CROSS BAR BRACKET	E	4	5/8 -11 HEX NUT	Scale NOT TO SCALE Sheet 1 OF 7		
6	1	CROSS BAR	F	20	1/2 - 13 X1-1/2 BOLT,NUT,WASHER,ASSY			
7	1	LOWER CROSS BAR BRACKET	G	4	3/8 - 16 X1-1/2 BOLT,NUT,WASHER,ASSY			
8	1	FRAME MOUNT STANCHION SUPPORT	H	2	7/16-14 X1-1/2 BOLT,NUT,WASHER,ASSY			
9	1	9.5" - 10.5" GUARD (NOT SHOWN)	I	4	1/4 X 2 X 2 BLACK SQUARE WASHER			
			J	4	1/2 - 13 X1-3/4 BOLT,NUT,WASHER,ASSY			
			K	4	5/16-18X3/4 FLANGE BOLT (NOT SHOWN)			
			L	4	5/16 NYLON WASHER (NOT SHOWN)			

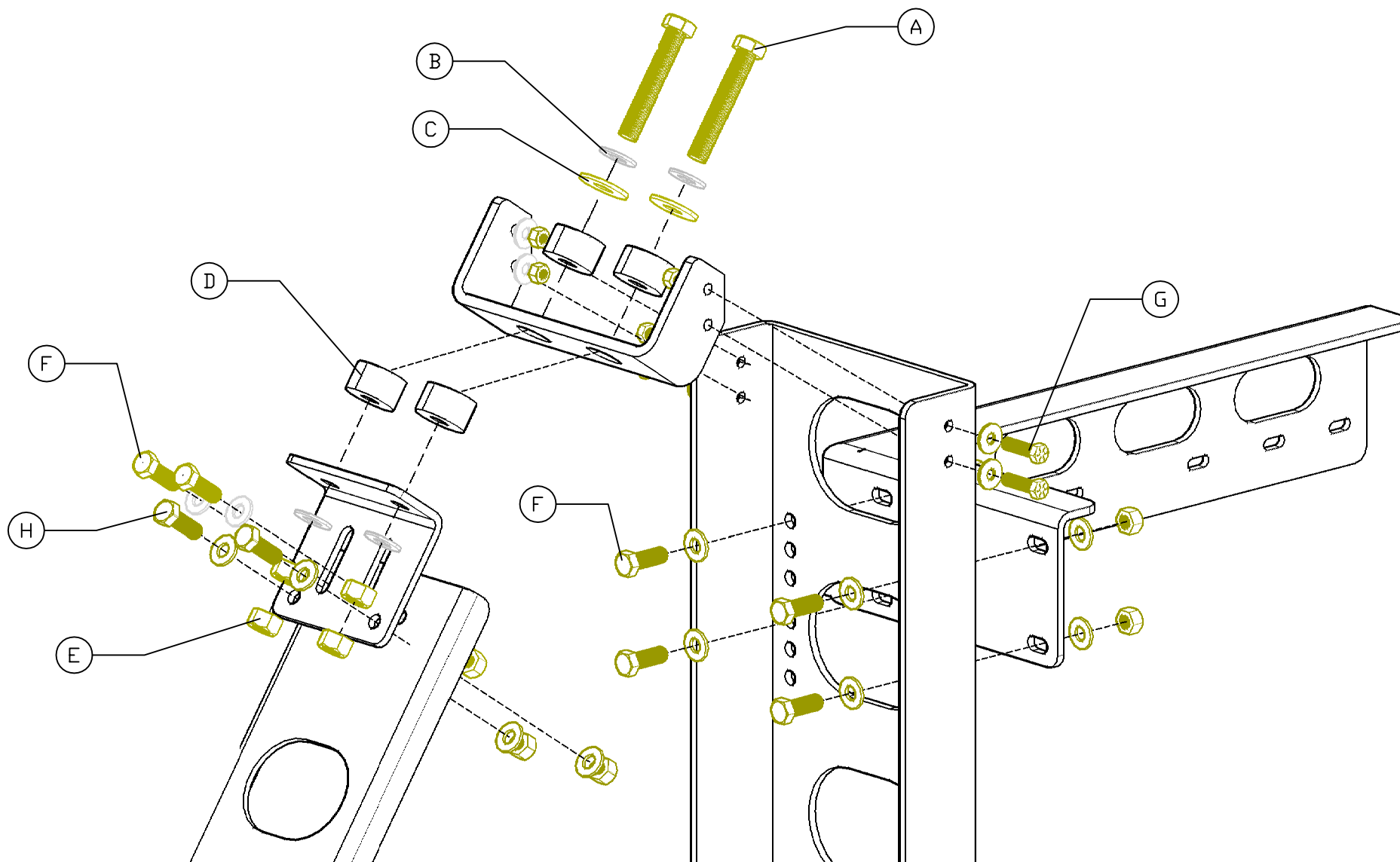

ITEM	QTY	HARDWARE DESCRIPTION
A	2	5/8 -11 X 4 INCH BOLT
B	4	5/8 SAE WASHER
C	2	5/8 USS WASHER
D	4	2" THICK POLY ISOLATORS
E	4	5/8 -11 HEX NUTS
F	20	1/2 - 13 X1-1/2 BOLT,NUT,WASHER,ASSY
G	4	3/8 - 16 X1-1/2 BOLT,NUT,WASHER,ASSY
H	2	7/16-14 X1-1/2 BOLT,NUT,WASHER,ASSY

**DIESEL EMISSIONS SERVICE**  
 PORTLAND REDDING OAKLAND ONTARIO  
 888-792-2922

**DONALDSON 9.5" - 10.5"**

Size **A** Drawing No. **DES M9019/M9020**

Scale NOT TO SCALE Sheet 2 of 7

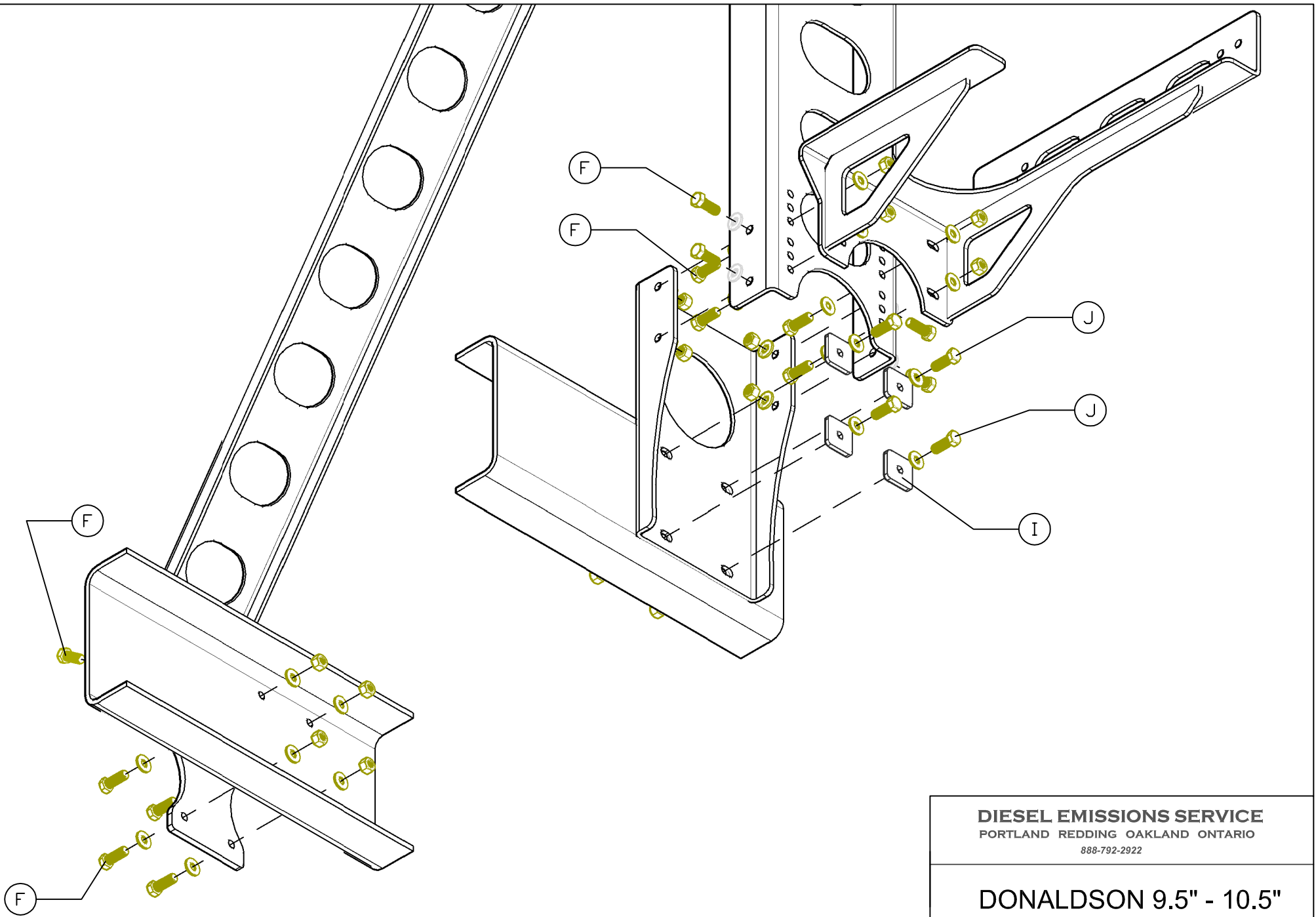

ITEM	QTY	HARDWARE DESCRIPTION
F	20	1/2 - 13 X1-1/2 BOLT,NUT,WASHER,ASSY
I	4	1/4 X 2 X 2 BLACK SQUARE WASHER
J	4	1/2 - 13 X1-3/4 BOLT,NUT,WASHER,ASSY

<b>DIESEL EMISSIONS SERVICE</b> PORTLAND REDDING OAKLAND ONTARIO 888-792-2922	
<b>DONALDSON 9.5" - 10.5"</b>	
Size <b>A</b>	Drawing No. <b>DES M9019/M9020</b>
Scale NOT TO SCALE	Sheet 3 of 7

## CORRECT

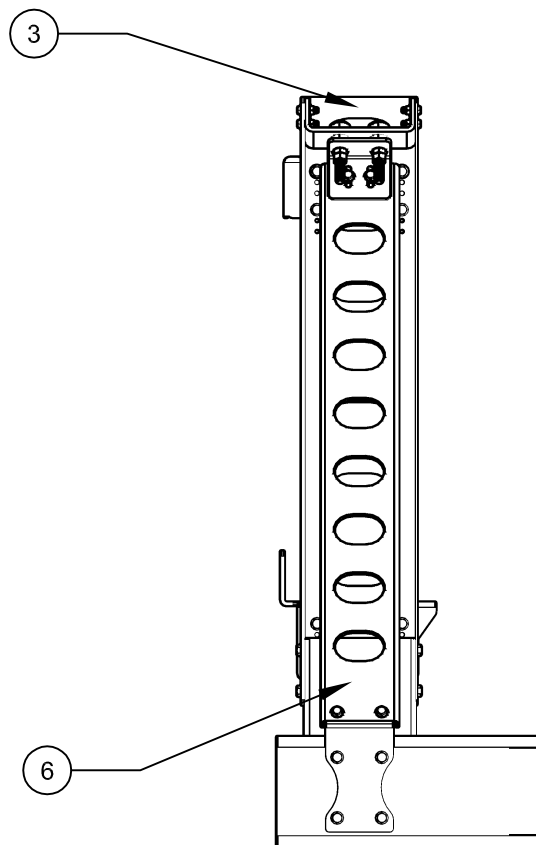

CROSS BAR(6) MUST BE PLACED  
PARALLEL TO VERTICAL STANCHION(3)

## INCORRECT

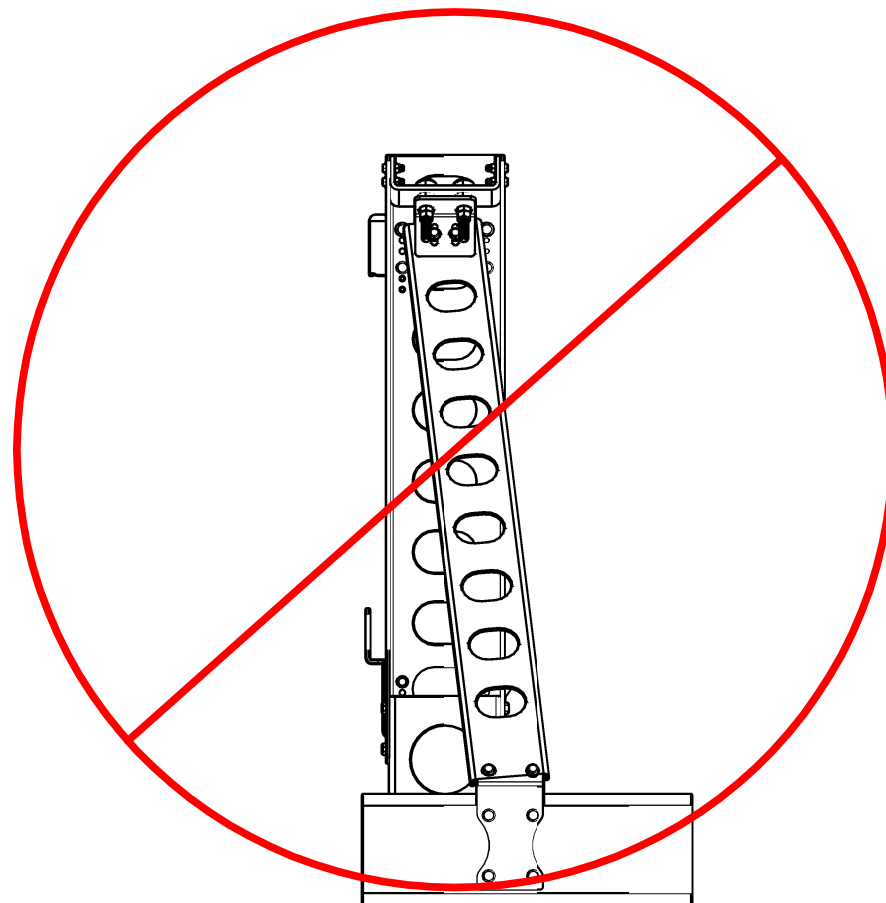

FAILURE TO INSTALL CROSS BAR (6) PARALLEL  
TO VERTICAL STANCHION (3) CAN COMPROMISE  
BRACKET INTEGRITY AND RESULT IN BRACKET  
FAILURE AND OR DAMAGE TO FILTER!

ITEM	QTY	COMPONENT DESCRIPTION
3	1	VERTICAL STANCHION
6	1	CROSS BAR

**DIESEL EMISSIONS SERVICE**  
PORTLAND REDDING OAKLAND ONTARIO  
888-792-2922

Drawing No.

**DES M9019/M9020**

Scale NOT TO SCALE

Size A

Sheet  
4 OF 7

# CORRECT

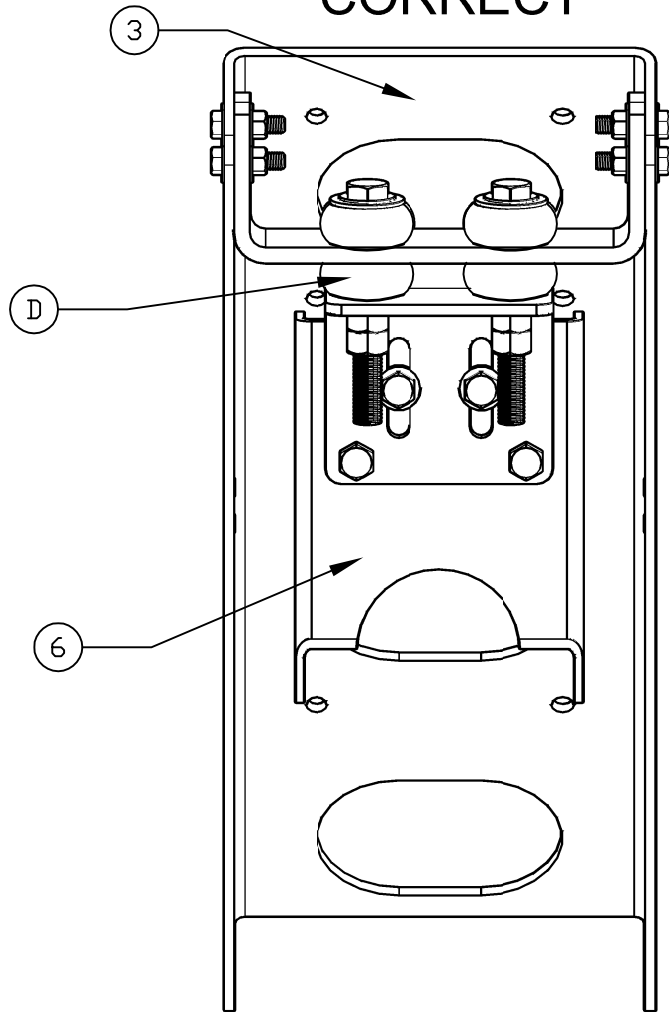

ISOLATORS (D) MUST BE COMPRESSED EQUALLY



ISOLATORS (D) SHOULD BE COMPRESSED APPROXIMATELY 25-30%

# INCORRECT

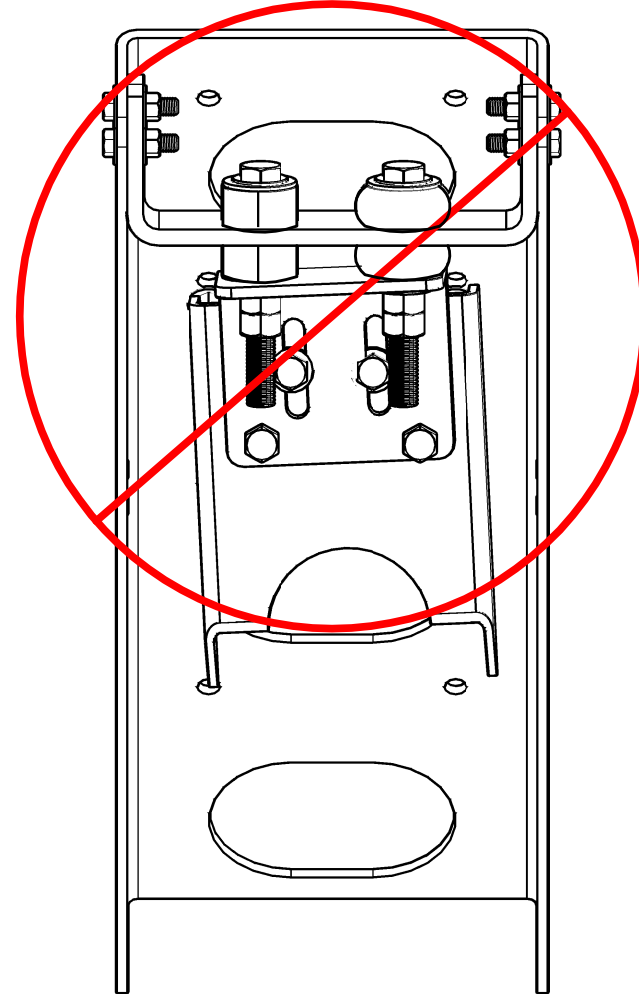

IMPROPER ISOLATOR COMPRESSION CAN LEAD TO ISOLATOR AND BRACKET FAILURE

**DIESEL EMISSIONS SERVICE**  
PORTLAND REDDING OAKLAND ONTARIO  
888-792-2922

Drawing No.

## DES M9019/M9020

Scale NOT TO SCALE

Size A

Sheet 5 OF 7

ITEM	QTY	COMPONENT DESCRIPTION	ITEM	QTY	HARDWARE DESCRIPTION
3	1	VERTICAL STANCHION	D	4	2" THICK POLY ISOLATORS
6	1	CROSS BAR			

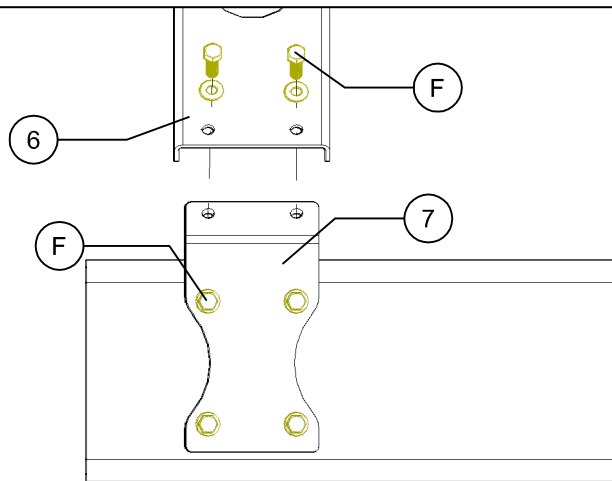

USE ALL PROVIDED GRADE 8 FASTENERS  
AND MANUFACTURED HOLES

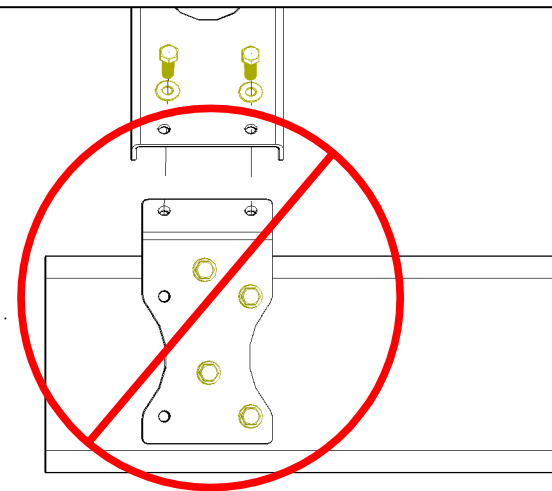

DO NOT ALTER BRACKET OR  
FASTENER HOLE LOCATIONS



LOWER CROSS BAR BRACKET (7) MUST  
SEAT FLUSH TO FRAME RAIL

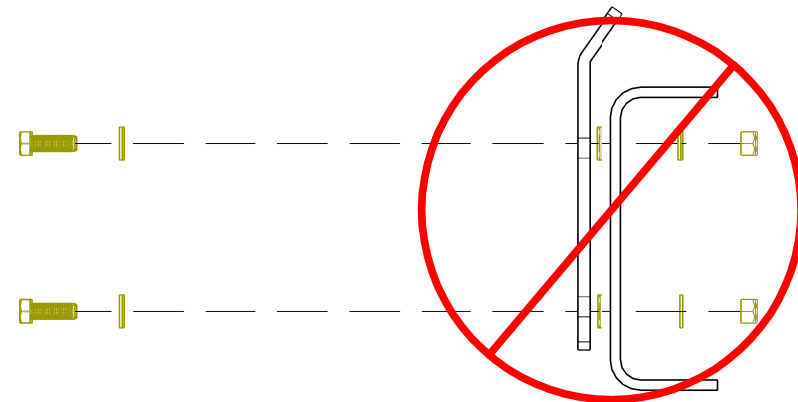

NEVER SPACE LOWER CROSS BAR  
BRACKET (7) AWAY FROM FRAME RAIL

**DIESEL EMISSIONS SERVICE**  
PORTLAND REDDING OAKLAND ONTARIO  
888-792-2922

Drawing No.

**DES M9019/M9020**

Scale NOT TO SCALE

Size A

Sheet  
6 OF 7

ITEM	QTY	COMPONENT DESCRIPTION	ITEM	QTY	HARDWARE DESCRIPTION
6	1	CROSS BAR	F	20	1/2 - 13 X1-1/2 BOLT,NUT,WASHER,ASSY
7	1	LOWER CROSS BAR BRACKET			



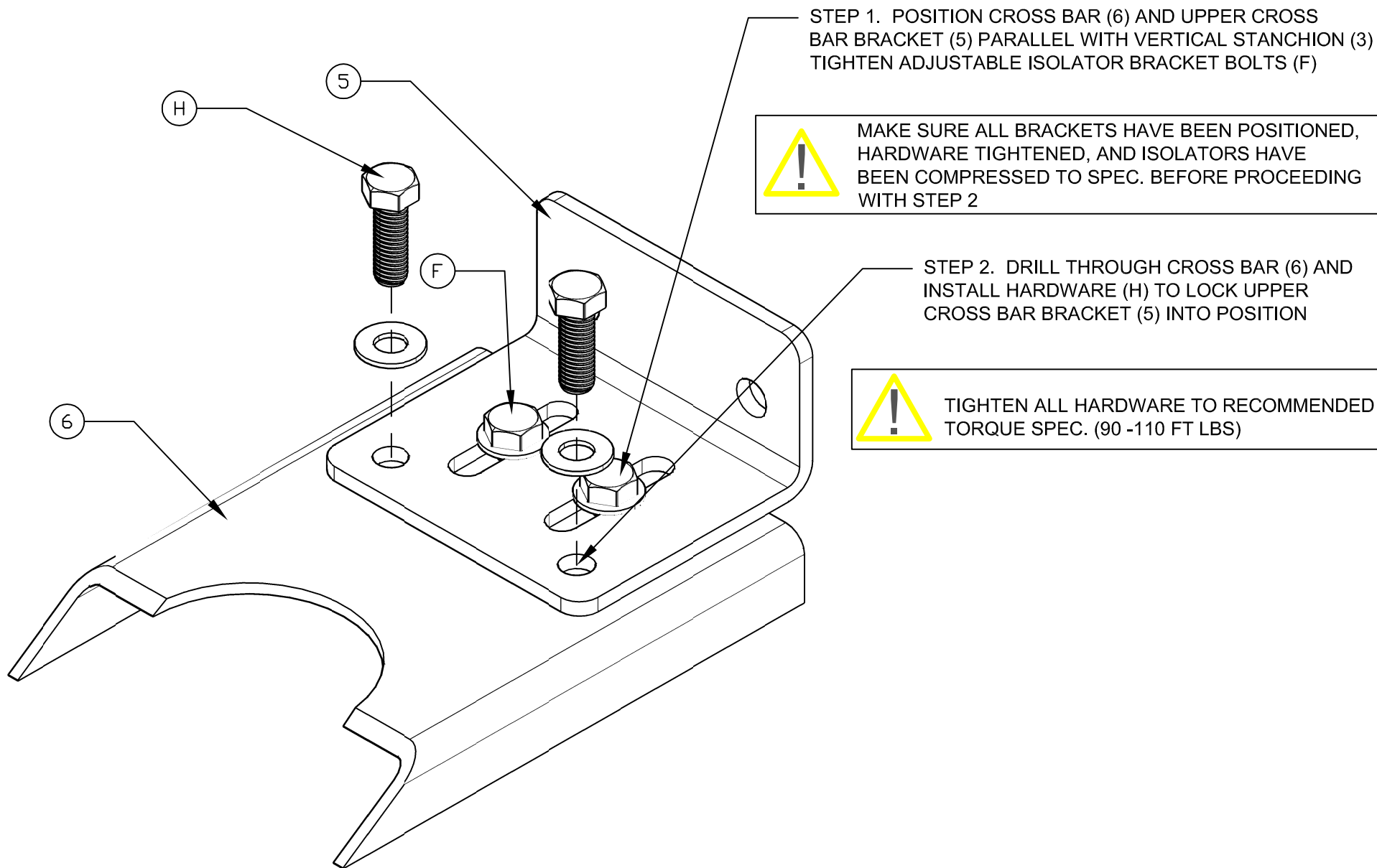

**DIESEL EMISSIONS SERVICE**  
 PORTLAND REDDING OAKLAND ONTARIO  
 888-792-2922

Drawing No.

**DES M9019/M9020**

ITEM	QTY	COMPONENT DESCRIPTION	ITEM	QTY	HARDWARE DESCRIPTION
5	1	UPPER CROSS BAR BRACKET	F	20	1/2 - 13 X1-1/2 BOLT,NUT,WASHER,ASSY
6	1	CROSS BAR	H	2	7/16-14 X1-1/2 BOLT,NUT,WASHER,ASSY

Scale NOT TO SCALE

Size A

Sheet  
7 OF 7