

# DIESEL EMISSIONS SERVICE

RETROFIT AND REPOWER SPECIALISTS

Portland | Redding | Oakland | Ontario

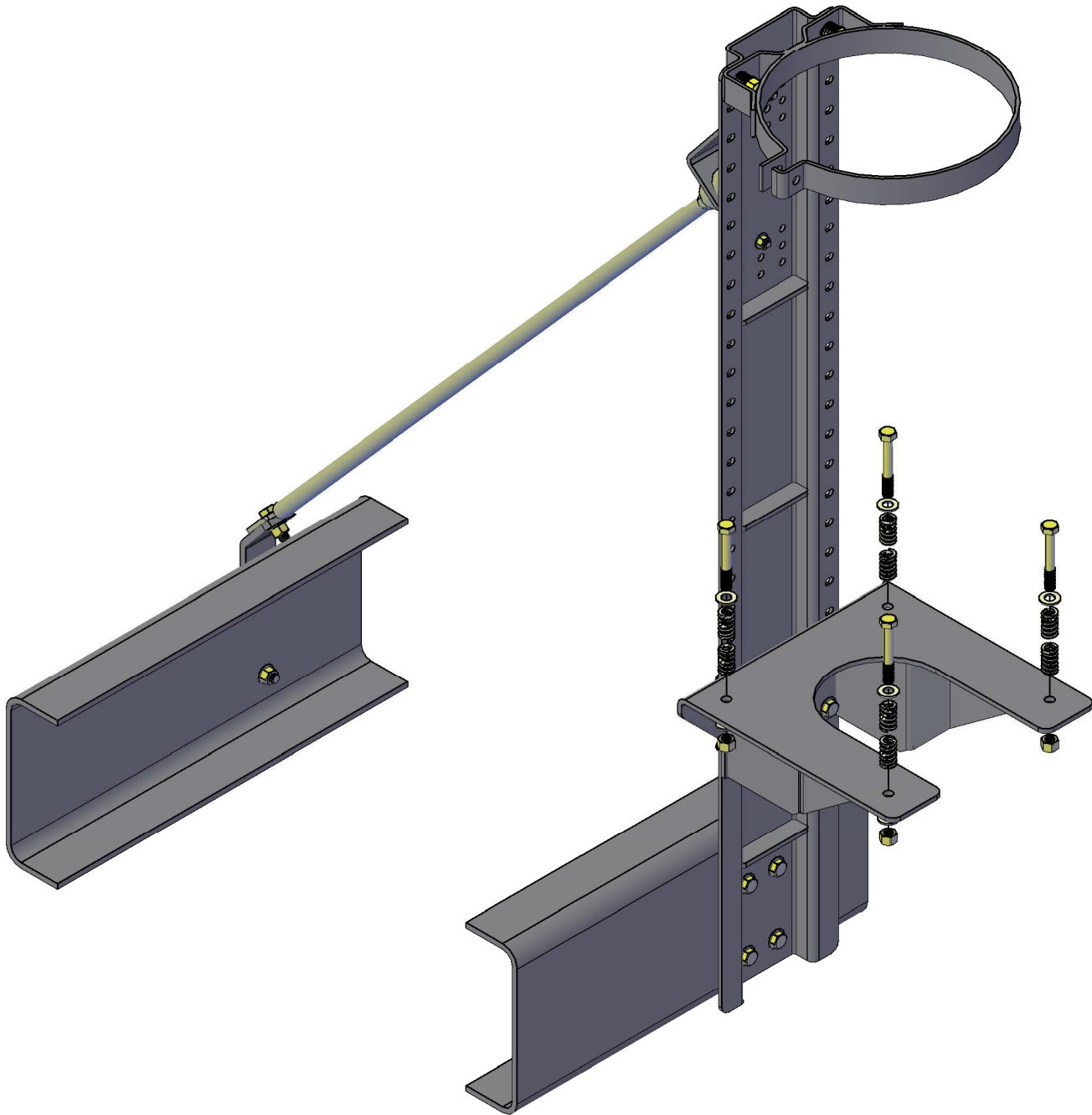

## DES VM6030 SCP 13/17/20 VERTICAL MOUNT

ALL INSTALLATION INSTRUCTIONS AND GUIDELINES MUST BE THOROUGHLY READ AND UNDERSTOOD BEFORE INSTALLING A DIESEL EMISSIONS SERVICE PRODUCT



## **PRODUCT GUIDELINES**

**Diesel Emissions Service recommends its products be installed by a trained technician with proper tools and safety equipment. In addition all Diesel Emissions Service mounting brackets should be installed using good judgment and sound mechanical principles. Since all installations are unique, it is the sole responsibility of the installer to determine the best fit and function of the DPF mounting brackets.**

## **PRODUCT SAFETY**

**Diesel Emissions Service products are designed for “ON-ROAD” applications only. Modifications to any Diesel Emissions Service product are not recommended and can compromise the bracket performance. Diesel Emissions Service claims no liability or responsibility for the improper application or installation of its products.**

## **PRODUCT WARRANTY**

**Diesel Emissions Service warrants to the original purchaser of its products that such products will be free from defects in material and workmanship under normal use. Diesel Emissions Service’s obligation under this warranty is solely and exclusively limited to repair and or replacement, at Diesel Emissions Service option, of the product (or components thereof) which Diesel Emissions Service’s examination proves to its satisfaction to be defective. Diesel Emissions Service SHALL HAVE NO OBLIGATION FOR CONSEQUENTIAL DAMAGES TO PERSONAL OR REAL PROPERTY, OR FOR INJURY TO ANY PERSON.**

**This warranty does not apply to products which have been subject to improper use, accident, negligence, abuse or misuse.**

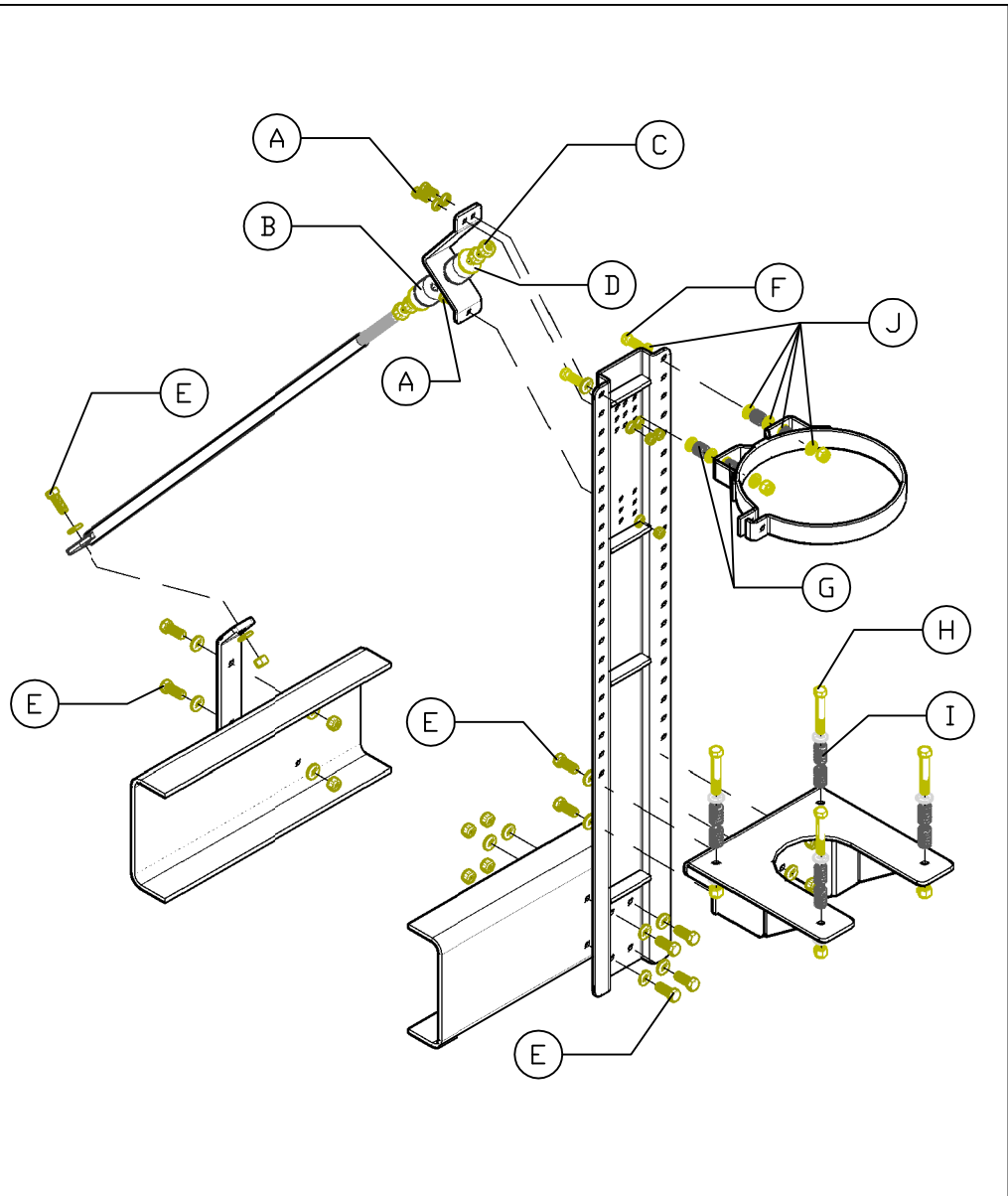
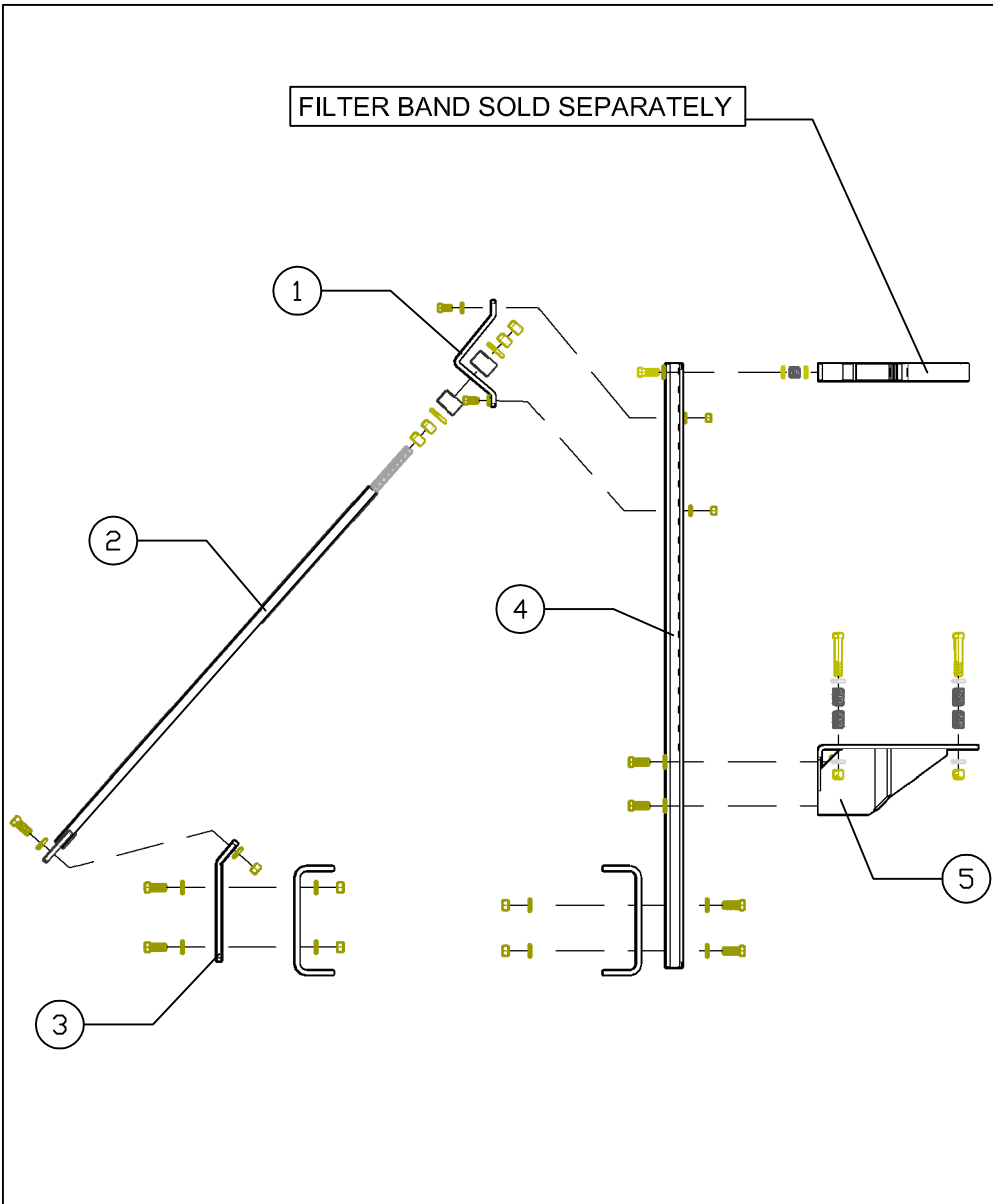

ITEM	QTY	COMPONENT DESCRIPTION	ITEM	QTY	HARDWARE DESCRIPTION
1	1	UPPER ISOLATOR BRACKET	A	3	3/8 - 16 X1-1/2 BOLT,NUT,WASHER,ASSY
2	1	CROSS BAR	B	2	POLY ISOLATOR
3	1	LOWER CROSS BAR BRACKET	C	4	5/8 -11 HEX NUT
4	1	56" VERTICAL STANCHION	D	2	5/8 USS WASHER
5	1	FILTER SUPPORT BRACKET	E	11	1/2 - 13 X1-3/4 BOLT,NUT,WASHER,ASSY
			F	2	7/16 -14 X 2-3/4 BOLT AND NUT
			G	4	OUTLET ISOLATION SPRING
			H	4	7/16 -14 X 4 BOLT,NUT,WASHER,ASSY
			I	8	INLET ISOLATION SPRING
			J	10	7/16 WASHER

**DIESEL EMISSIONS SERVICE**  
 PORTLAND REDDING OAKLAND ONTARIO  
 888-792-2922

**SCP 13/17/20**

Size	Drawing No.	Rev
<b>A</b>	<b>DES VM6030</b>	
Scale	CAD File	Sheet
<b>NOT TO SCALE</b>		1 of 7

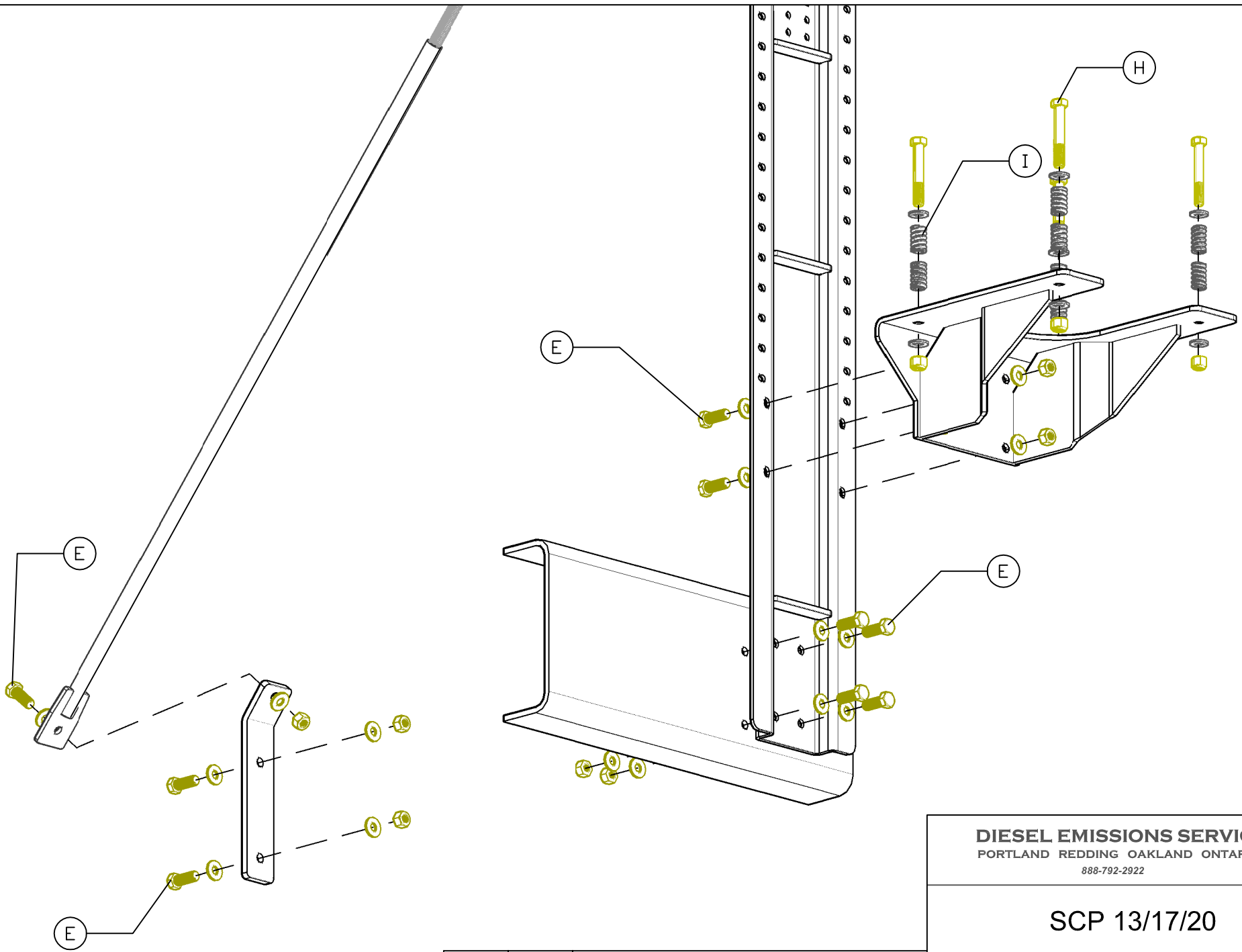

ITEM	QTY	HARDWARE DESCRIPTION
E	11	1/2 - 13 X 1-3/4 BOLT,NUT,WASHER,ASSY
H	4	7/16 -14 X 4 BOLT,NUT,WASHER,ASSY
I	8	INLET ISOLATION SPRING

<b>DIESEL EMISSIONS SERVICE</b> PORTLAND REDDING OAKLAND ONTARIO 888-792-2922		
<b>SCP 13/17/20</b>		
Size	Drawing No.	Rev
<b>A</b>	<b>DES VM6030</b>	
Scale	CAD File	Sheet
<b>NOT TO SCALE</b>		2 of 7

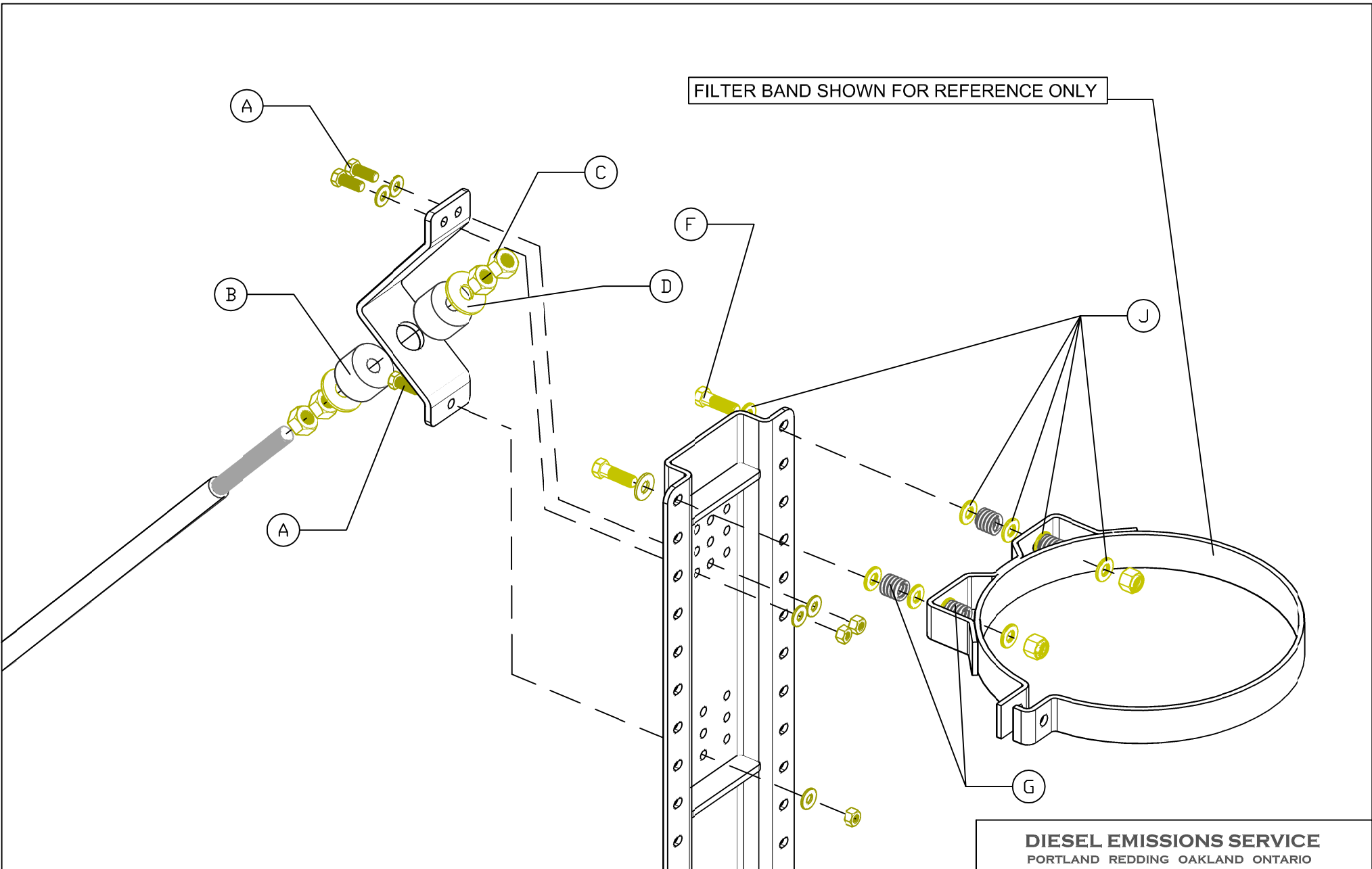

FILTER BAND SHOWN FOR REFERENCE ONLY

ITEM	QTY	HARDWARE DESCRIPTION
A	3	3/8 - 16 X1-1/2 BOLT,NUT,WASHER,ASSY
B	2	POLY ISOLATOR
C	4	5/8 -11 HEX NUT
D	2	5/8 USS WASHER
F	2	7/16 -14 X 2-3/4 BOLT AND NUT
G	4	OUTLET ISOLATION SPRING
J	10	7/16 WASHER

**DIESEL EMISSIONS SERVICE**  
 PORTLAND REDDING OAKLAND ONTARIO  
 888-792-2922

**SCP 13/17/20**

Size <b>A</b>	Drawing No. <b>DES VM6030</b>	Rev
Scale <b>NOT TO SCALE</b>	CAD File	Sheet 3 of 7

# CORRECT

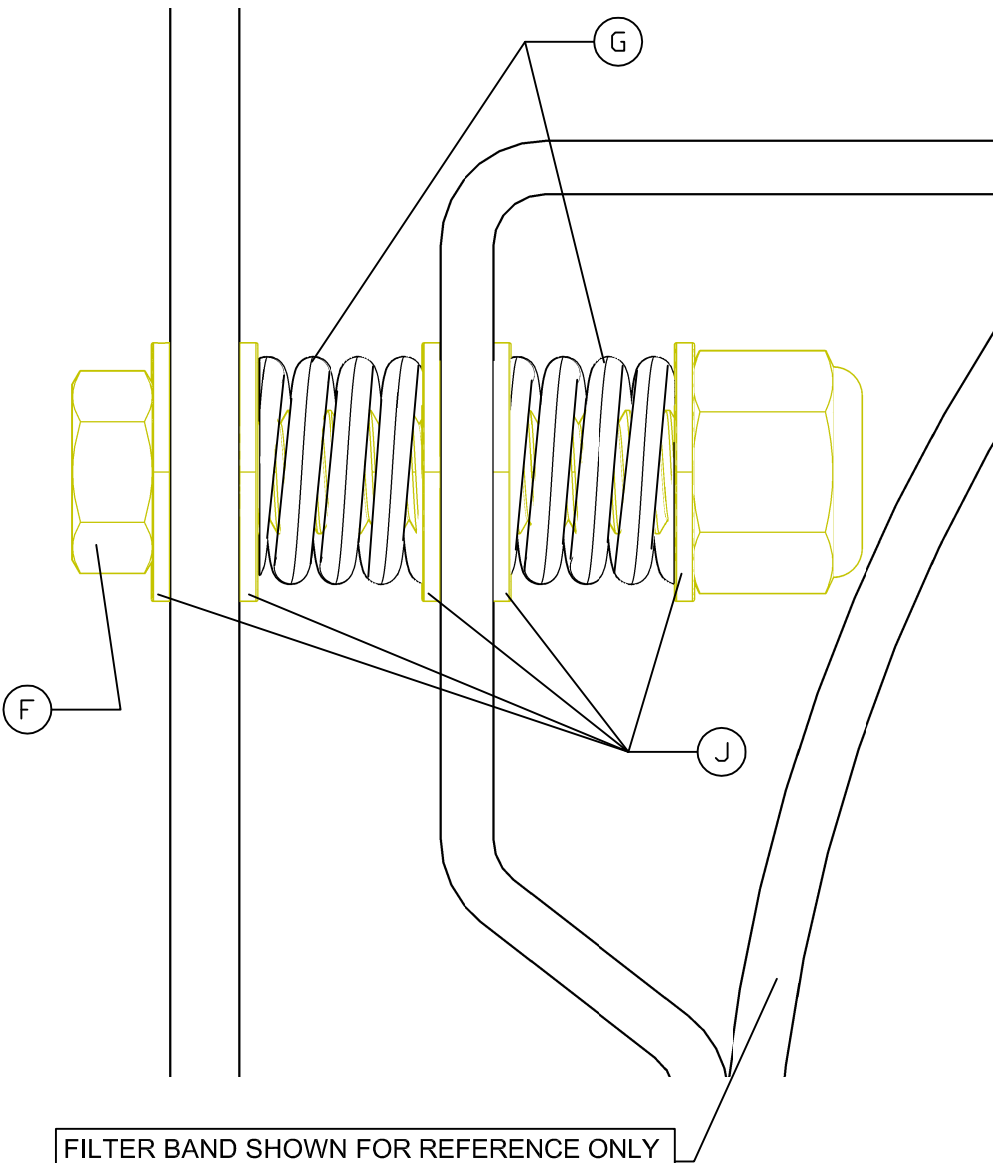

FILTER BAND SHOWN FOR REFERENCE ONLY

 OUTLET ISOLATION SPRINGS (G) MUST BE COMPRESSED EQUALLY

# INCORRECT

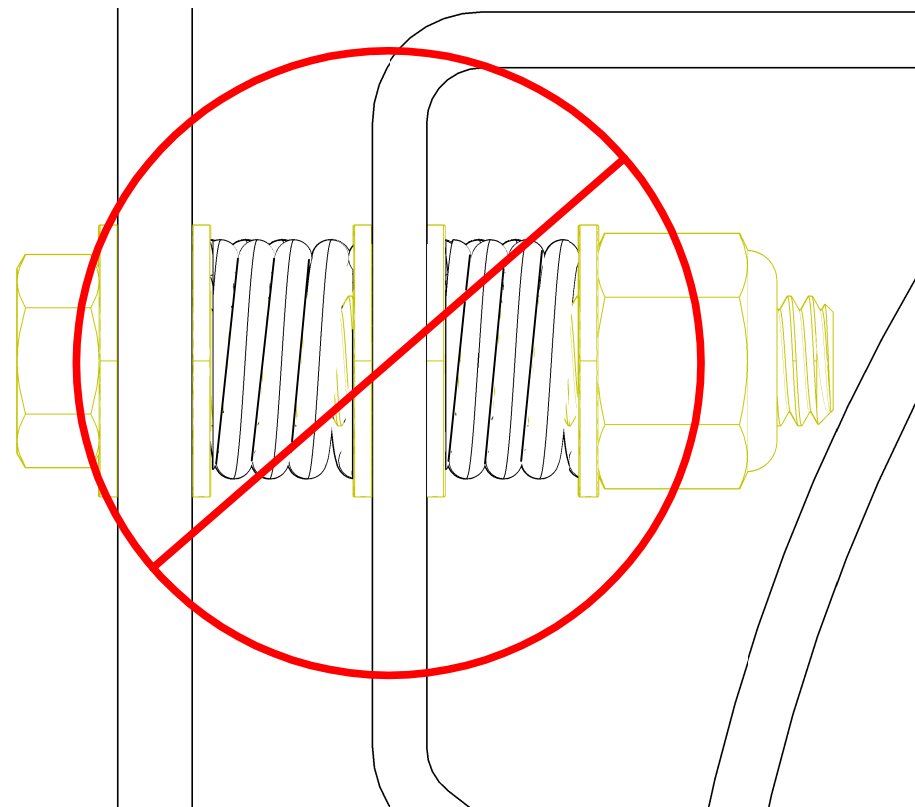

 DO NOT OVER COMPRESS SPRINGS TO THE POINT THAT THE SPRING COILS CONTACT ONE ANOTHER

**DIESEL EMISSIONS SERVICE**  
 PORTLAND REDDING OAKLAND ONTARIO  
 888-792-2922

SCP 13/17/20

ITEM	QTY	HARDWARE DESCRIPTION
F	2	7/16 -14 X 2 - 3/4 BOLT,NUT
G	4	3/4 LONG X 3/4 O.D. OUTLET SPRING
J	10	7/16 WASHER

Size	Drawing No.	Rev
<b>A</b>	<b>DES VM6030</b>	
Scale	CAD File	Sheet
NOT TO SCALE		4 of 7

FILTER BASE PLATE SHOWN FOR REFERENCE ONLY

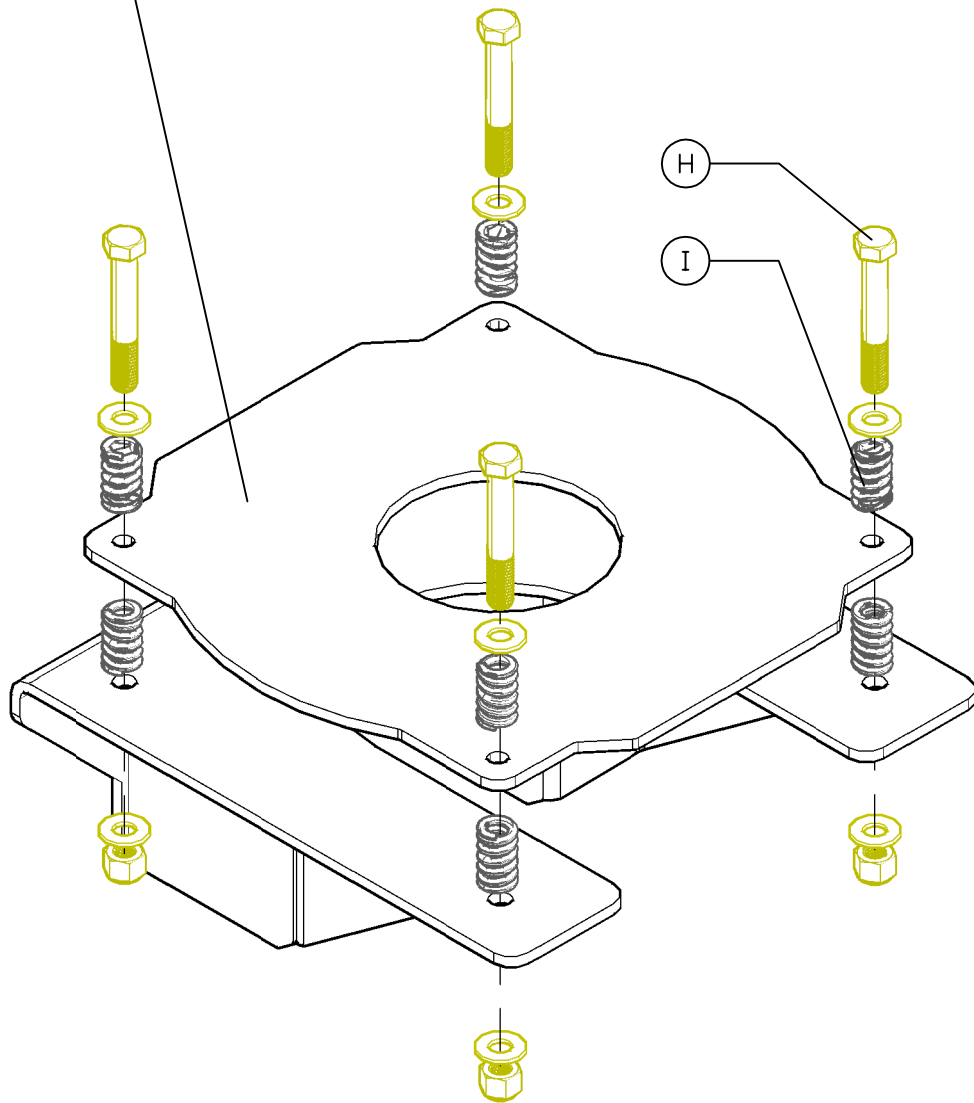

FILTER BASE PLATE SHOWN FOR REFERENCE ONLY

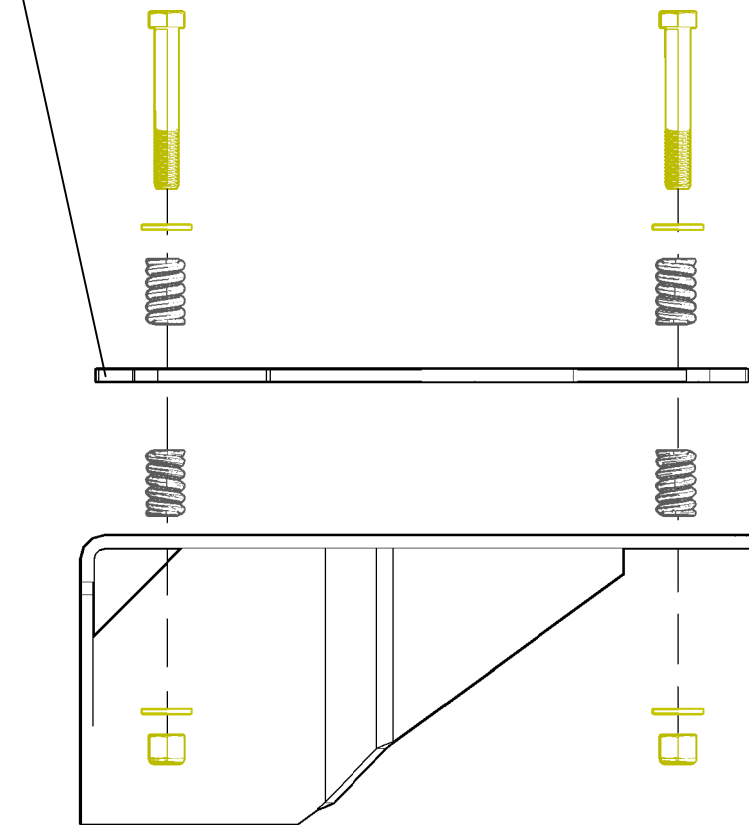

**DIESEL EMISSIONS SERVICE**  
 PORTLAND REDDING OAKLAND ONTARIO  
 888-792-2922

**SCP 13/17/20**

Size	Drawing No.	Rev
<b>A</b>	<b>DES VM6030</b>	
Scale	CAD File	Sheet
<b>NOT TO SCALE</b>		5 of 7

ITEM	QTY	HARDWARE DESCRIPTION
H	4	7/16 -14 X 4 BOLT,NUT,WASHER,ASSY
I	8	INLET ISOLATION SPRING

# CORRECT

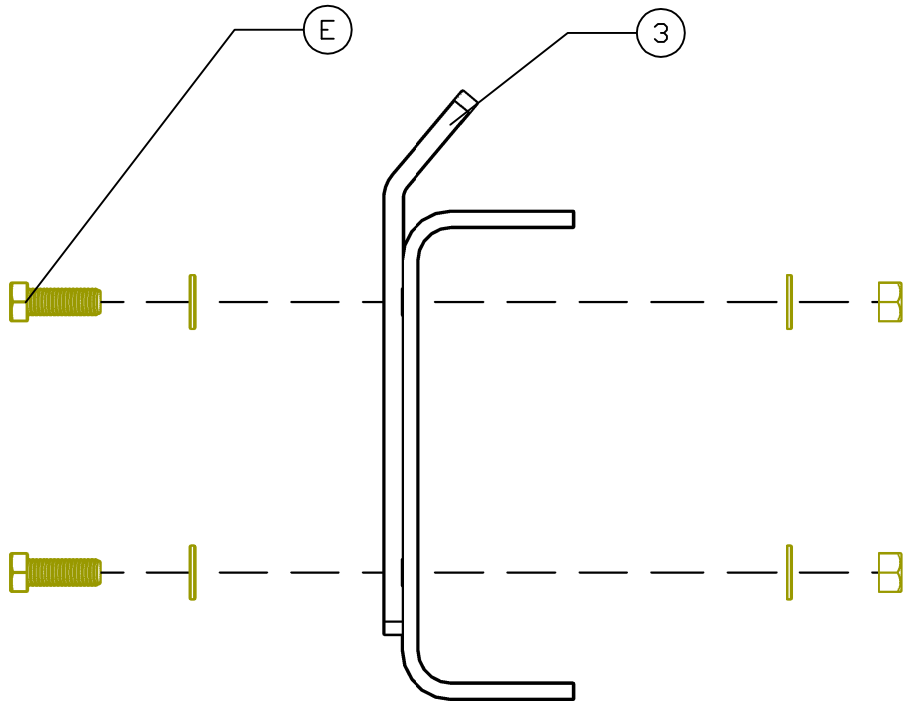

LOWER CROSS BAR BRACKET (3) MUST SEAT FLUSH TO FRAME RAIL

# INCORRECT

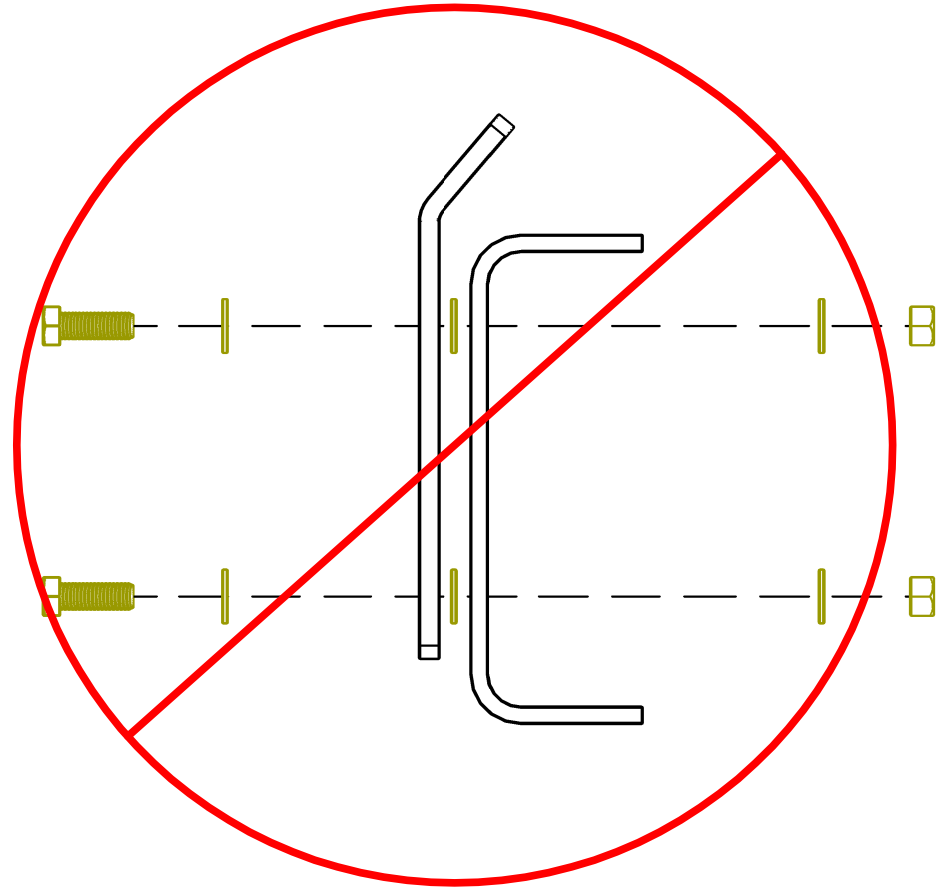

NEVER SPACE LOWER CROSS BAR BRACKET (3) AWAY FROM FRAME RAIL

**DIESEL EMISSIONS SERVICE**  
 PORTLAND REDDING OAKLAND ONTARIO  
 888-792-2922

Drawing No.

## DES VM6030

Scale NOT TO SCALE

Size A

Sheet 6 of 7

ITEM	QTY	COMPONENT DESCRIPTION	ITEM	QTY	HARDWARE DESCRIPTION
3	1	LOWER CROSS BAR BRACKET	E	11	1/2 - 13 X1-3/4 BOLT,NUT,WASHER,ASSY



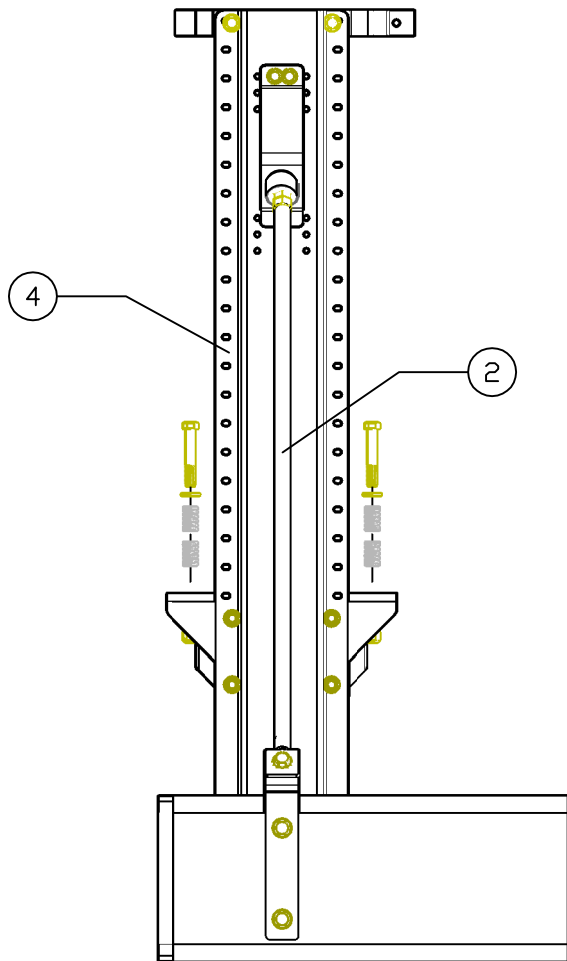

# CORRECT

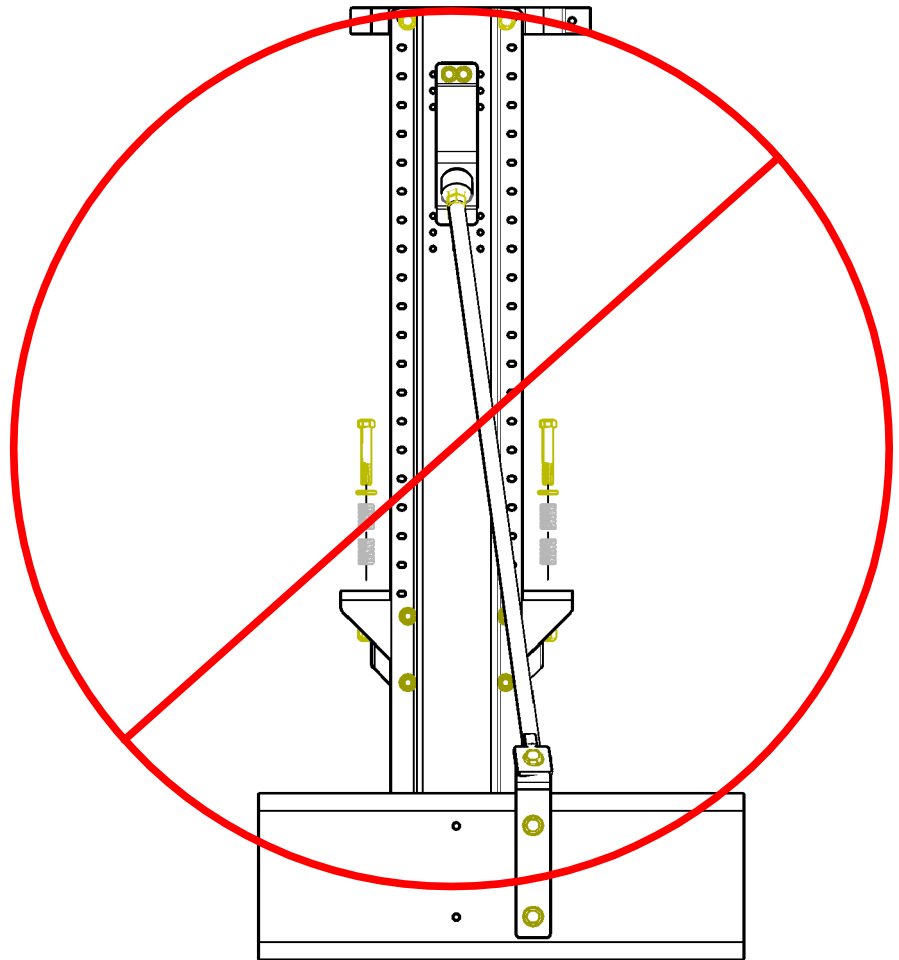

CROSS BAR (2) MUST BE PARALLEL TO VERTICAL STANCHION (4)

# INCORRECT



 FAILURE TO INSTALL CROSS BAR (2) PARALLEL TO VERTICAL STANCHION (4) CAN COMPROMISE BRACKET INTEGRITY AND RESULT IN BRACKET FAILURE AND OR DAMAGE TO FILTER

ITEM	QTY	COMPONENT DESCRIPTION
2	1	CROSS BAR
4	1	VERTICAL STANCHION

**DIESEL EMISSIONS SERVICE**  
 PORTLAND REDDING OAKLAND ONTARIO  
 888-792-2922

---

Drawing No. **DES VM6030**

Scale NOT TO SCALE	Size A	Sheet 7 of 7
--------------------	--------	--------------