

# **DIESEL EMISSIONS SERVICE**

RETROFIT AND REPOWER SPECIALISTS

**Portland | Redding | Oakland | Ontario**

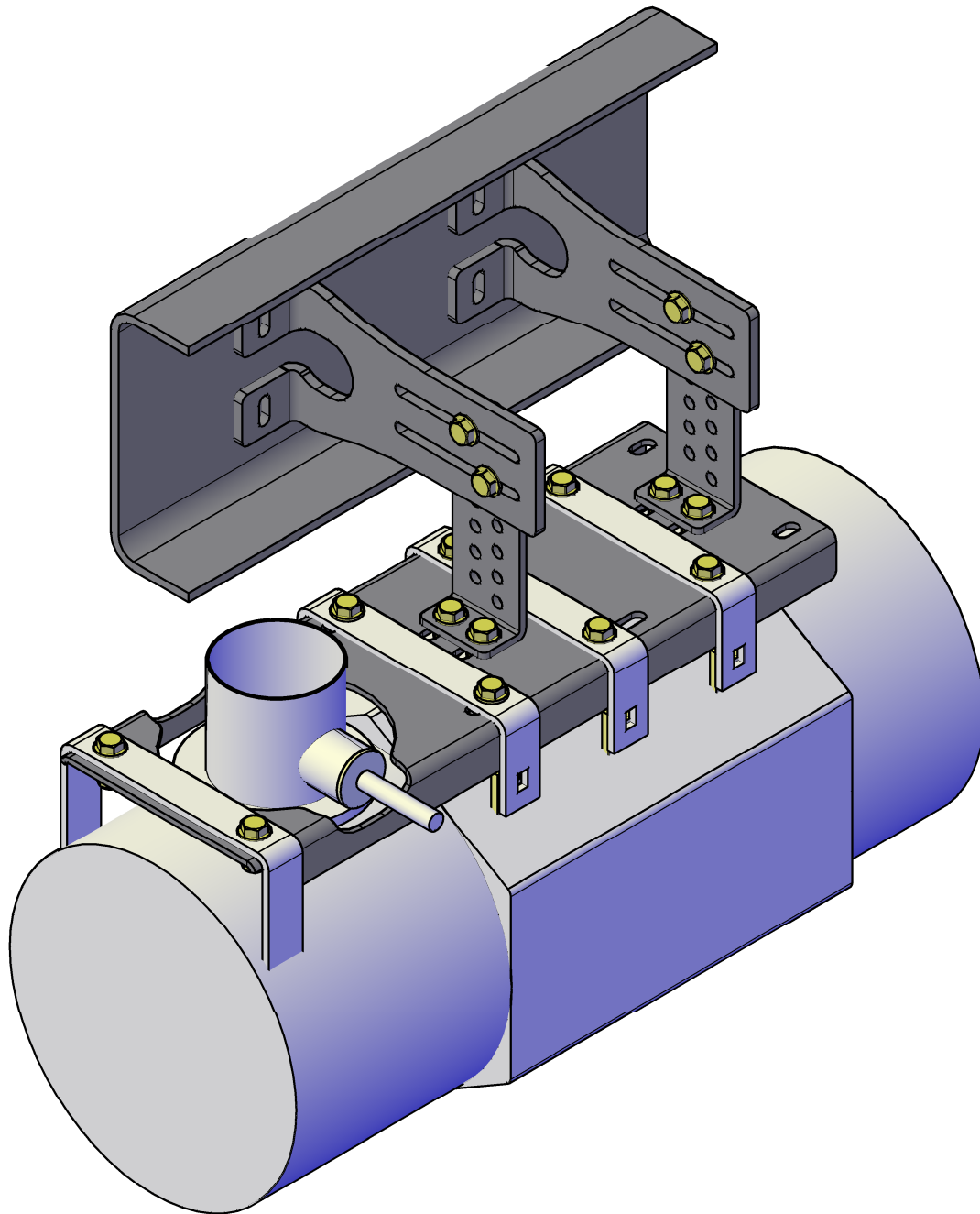

## **DES M8010 HUSS MK200/MK300**

**ALL INSTALLATION INSTRUCTIONS AND GUIDELINES MUST BE THOROUGHLY READ AND UNDERSTOOD BEFORE INSTALLING A DIESEL EMISSIONS SERVICE PRODUCT**



## **PRODUCT GUIDELINES**

**Diesel Emissions Service recommends its products be installed by a trained technician with proper tools and safety equipment. In addition all Diesel Emissions Service mounting brackets should be installed using good judgment and sound mechanical principles. Since all installations are unique, it is the sole responsibility of the installer to determine the best fit and function of the DPF mounting brackets.**

## **PRODUCT SAFETY**

**Diesel Emissions Service products are designed for “ON-ROAD” applications only. Modifications to any Diesel Emissions Service product are not recommended and can compromise the bracket performance. Diesel Emissions Service claims no liability or responsibility for the improper application or installation of its products.**

## **PRODUCT WARRANTY**

**Diesel Emissions Service warrants to the original purchaser of its products that such products will be free from defects in material and workmanship under normal use. Diesel Emissions Service’s obligation under this warranty is solely and exclusively limited to repair and or replacement, at Diesel Emissions Service option, of the product (or components thereof) which Diesel Emissions Service’s examination proves to its satisfaction to be defective. Diesel Emissions Service SHALL HAVE NO OBLIGATION FOR CONSEQUENTIAL DAMAGES TO PERSONAL OR REAL PROPERTY, OR FOR INJURY TO ANY PERSON.**

**This warranty does not apply to products which have been subject to improper use, accident, negligence, abuse or misuse.**

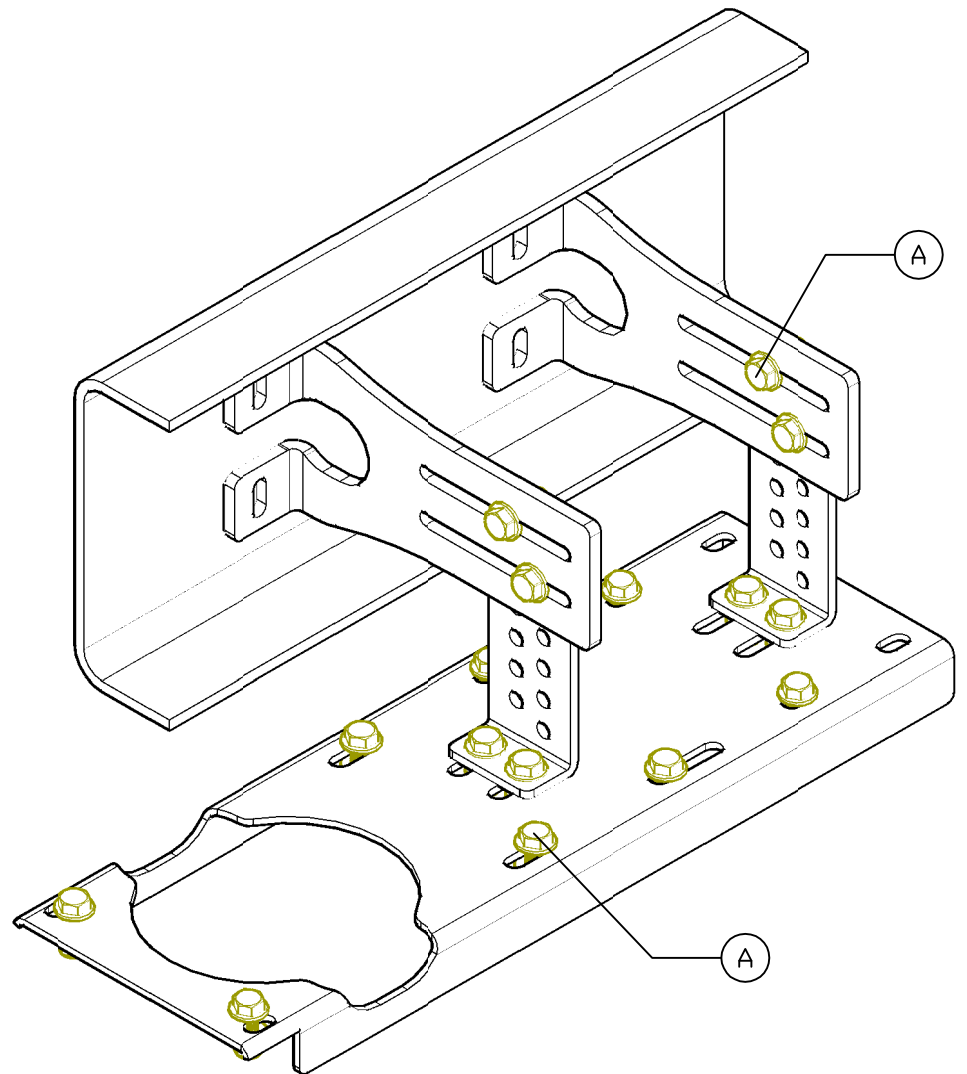
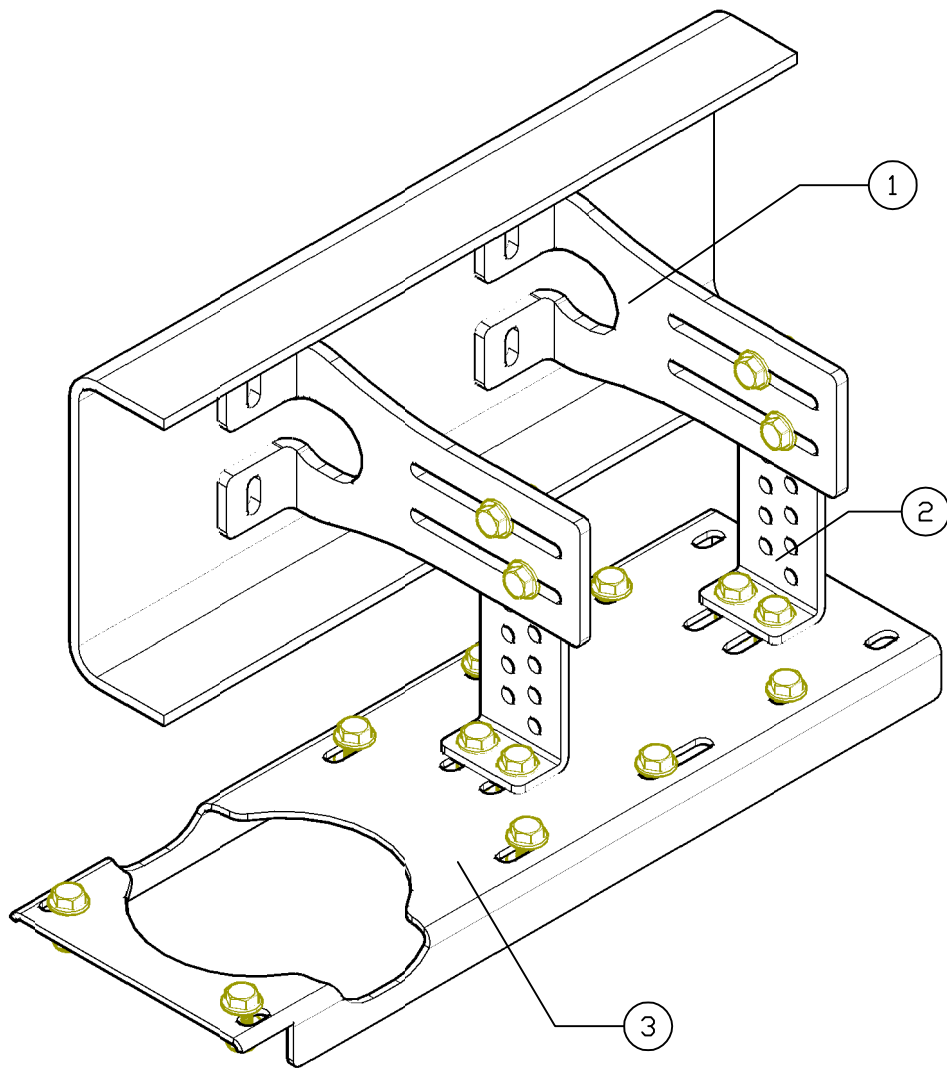

ITEM	QTY	COMPONENT DESCRIPTION
1	2	INSIDE FRAME BRACKET
2	2	ADJUSTABLE "L" BRACKET
3	1	FILTER MOUNTING PLATE

ITEM	QTY	HARDWARE DESCRIPTION
A	16	7/16-14 X1-1/2 BOLT,NUT,WASHER,ASSY

**DIESEL EMISSIONS SERVICE**  
 PORTLAND REDDING OAKLAND ONTARIO  
 888-792-2922

**HUSS MK200/MK300**

Size	Drawing No.	Rev
A	DES M8010	
Scale	CAD File	Sheet
NOT TO SCALE		1 of 6

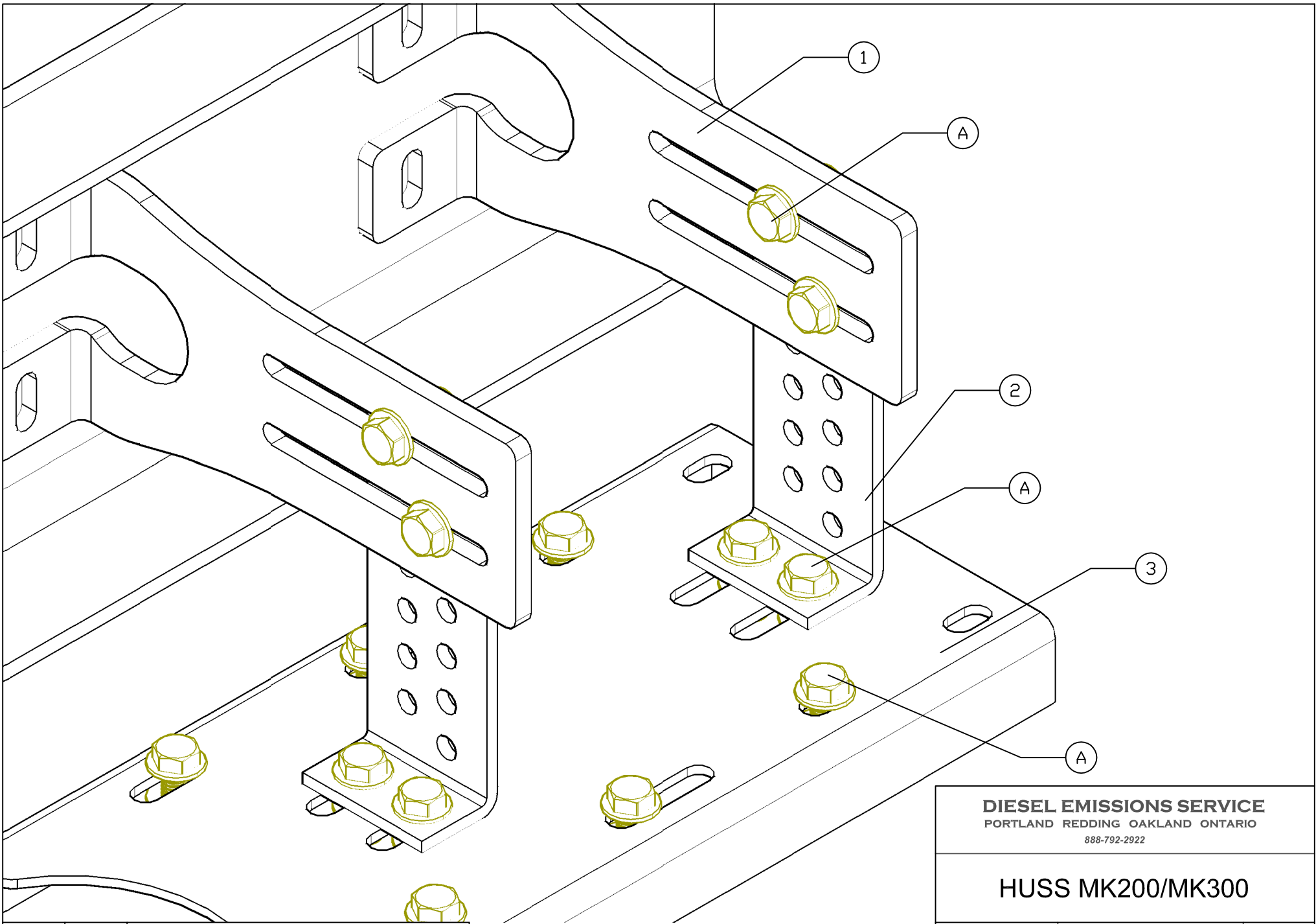

ITEM	QTY	COMPONENT DESCRIPTION
1	2	INSIDE FRAME BRACKET
2	2	ADJUSTABLE "L" BRACKET
3	1	FILTER MOUNTING PLATE

ITEM	QTY	HARDWARE DESCRIPTION
A	16	7/16-14 X1-1/2 BOLT,NUT,WASHER,ASSY

**DIESEL EMISSIONS SERVICE**  
PORTLAND REDDING OAKLAND ONTARIO  
888-792-2922

**HUSS MK200/MK300**

Size <b>A</b>	Drawing No. <b>DES M8010</b>	Rev
Scale <b>NOT TO SCALE</b>	CAD File	Sheet 2 of 6

## CORRECT

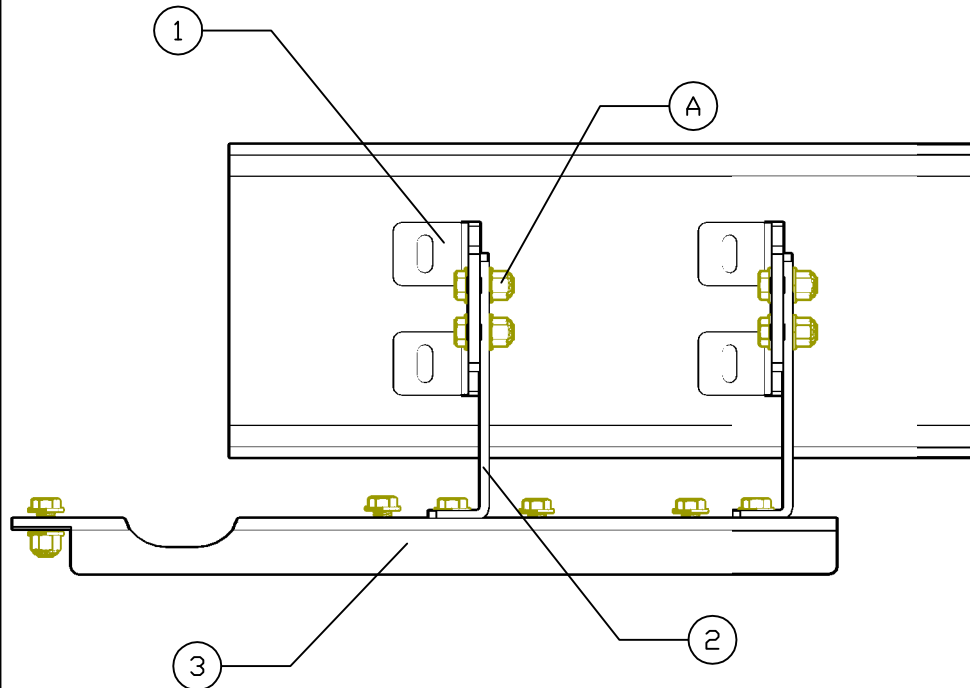

INSIDE FRAME BRACKET (1) AND ADJUSTABLE "L" BRACKET (2) MUST BE PARALLEL WITH ONE ANOTHER AND PERPENDICULAR TO FRAME RAIL

## INCORRECT

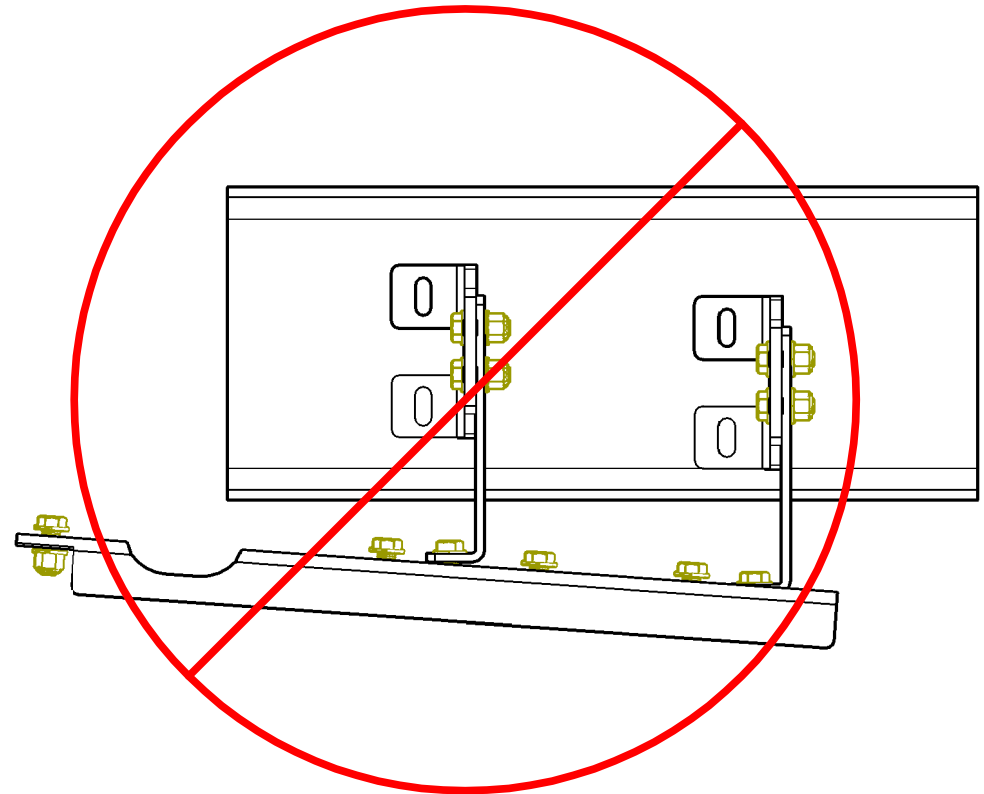

 FAILURE TO PROPERLY INSTALL DES M8010 BRACKETS CAN RESULT IN BRACKET FAILURE AND OR DAMAGE TO FILTER

ITEM	QTY	COMPONENT DESCRIPTION
1	2	INSIDE FRAME BRACKET
2	2	ADJUSTABLE "L" BRACKET
3	1	FILTER MOUNTING PLATE

ITEM	QTY	HARDWARE DESCRIPTION
A	16	7/16-14 X1-1/2 BOLT,NUT,WASHER,ASSY

**DIESEL EMISSIONS SERVICE**  
PORTLAND REDDING OAKLAND ONTARIO  
888-792-2922

Size <b>A</b>	Drawing No. <b>DES M8010</b>
Scale NOT TO SCALE	Sheet 3 of 6

## CORRECT

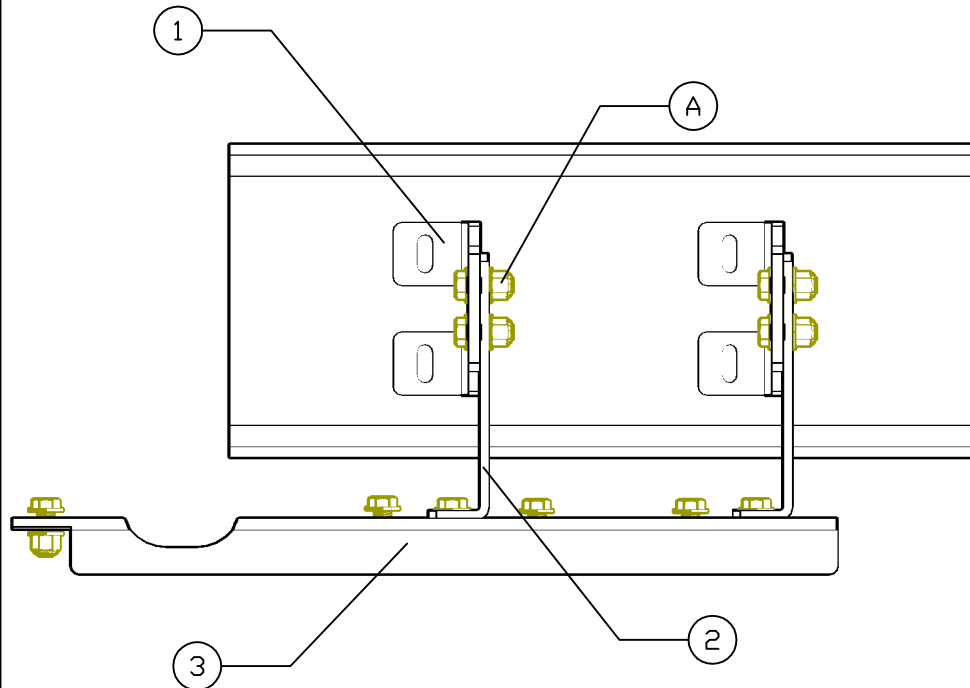

INSIDE FRAME BRACKET (1) AND ADJUSTABLE "L" BRACKET (2) MUST BE PARALLEL WITH ONE ANOTHER AND PERPENDICULAR TO FRAME RAIL

## INCORRECT

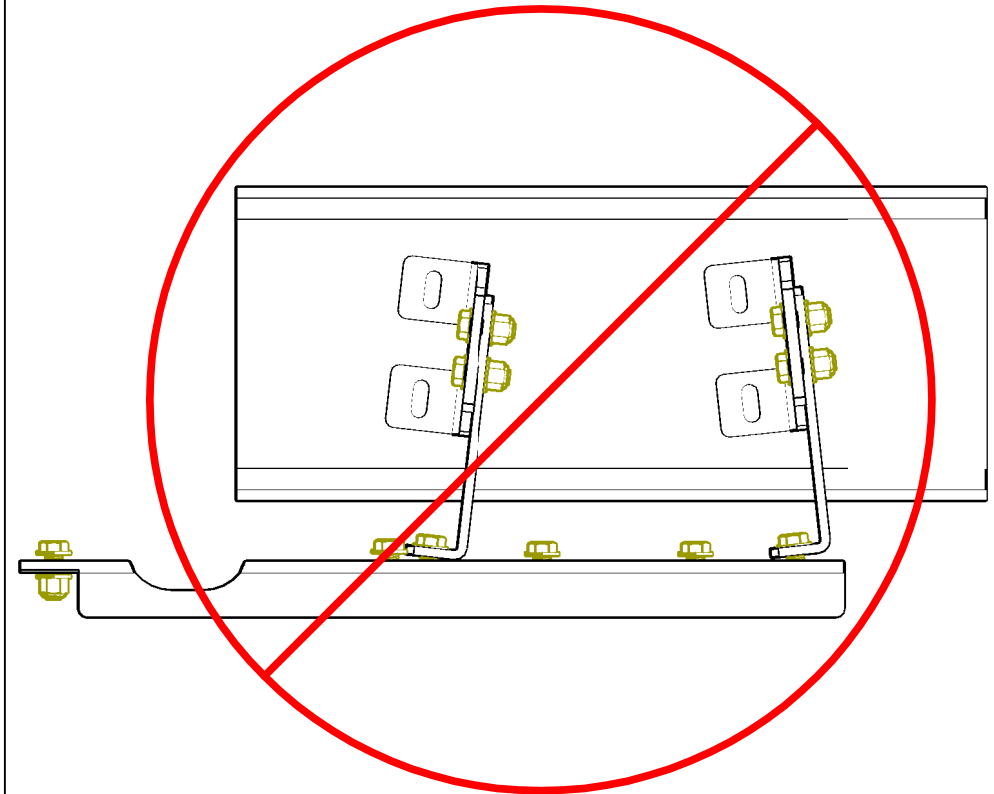

 FAILURE TO PROPERLY INSTALL DES M8010 BRACKETS CAN RESULT IN BRACKET FAILURE AND OR DAMAGE TO FILTER

ITEM	QTY	COMPONENT DESCRIPTION
1	2	INSIDE FRAME BRACKET
2	2	ADJUSTABLE "L" BRACKET
3	1	FILTER MOUNTING PLATE

ITEM	QTY	HARDWARE DESCRIPTION
A	16	7/16-14 X1-1/2 BOLT,NUT,WASHER,ASSY

<b>DIESEL EMISSIONS SERVICE</b> PORTLAND REDDING OAKLAND ONTARIO 888-792-2922	
Size <b>A</b>	Drawing No. <b>DES M8010</b>
Scale NOT TO SCALE	Sheet 4 of 6

## CORRECT

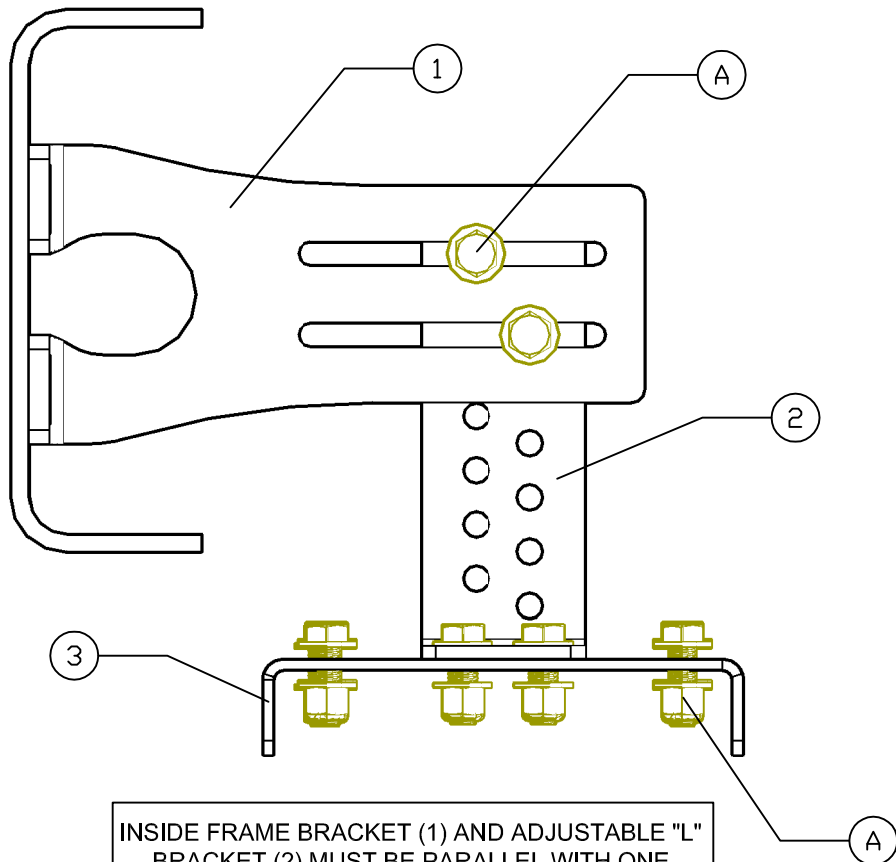

INSIDE FRAME BRACKET (1) AND ADJUSTABLE "L" BRACKET (2) MUST BE PARALLEL WITH ONE ANOTHER AND PERPENDICULAR TO FRAME RAIL

## INCORRECT

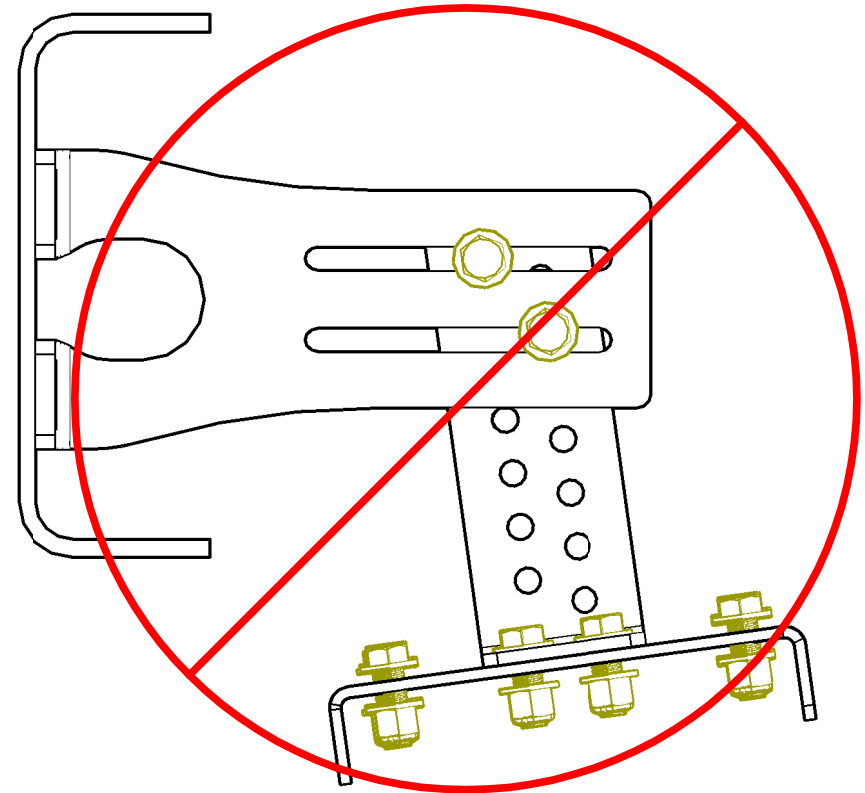

 FAILURE TO PROPERLY INSTALL DES M8010 BRACKETS CAN RESULT IN BRACKET FAILURE AND OR DAMAGE TO FILTER

ITEM	QTY	COMPONENT DESCRIPTION
1	2	INSIDE FRAME BRACKET
2	2	ADJUSTABLE "L" BRACKET
3	1	FILTER MOUNTING PLATE

ITEM	QTY	HARDWARE DESCRIPTION
A	16	7/16-14 X1-1/2 BOLT,NUT,WASHER,ASSY

**DIESEL EMISSIONS SERVICE**  
PORTLAND REDDING OAKLAND ONTARIO  
888-792-2922

Size <b>A</b>	Drawing No. <b>DES M8010</b>
Scale NOT TO SCALE	Sheet 5 of 6

## CORRECT

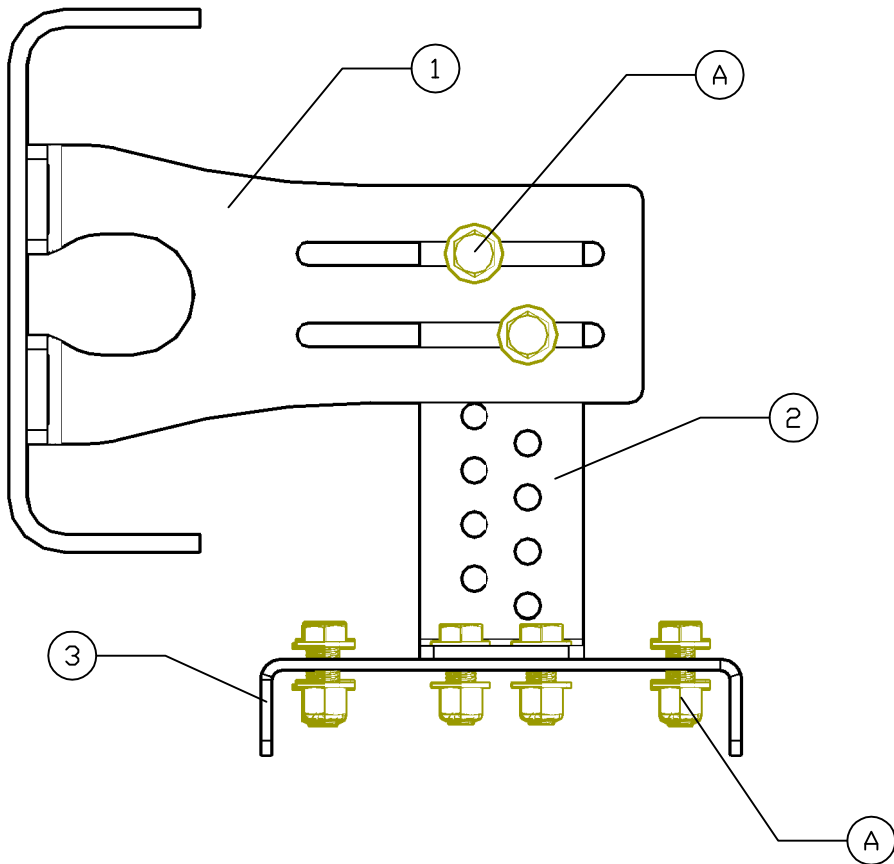

INSIDE FRAME BRACKET (1) MUST SEAT FLUSH  
TO FRAME RAIL

## INCORRECT

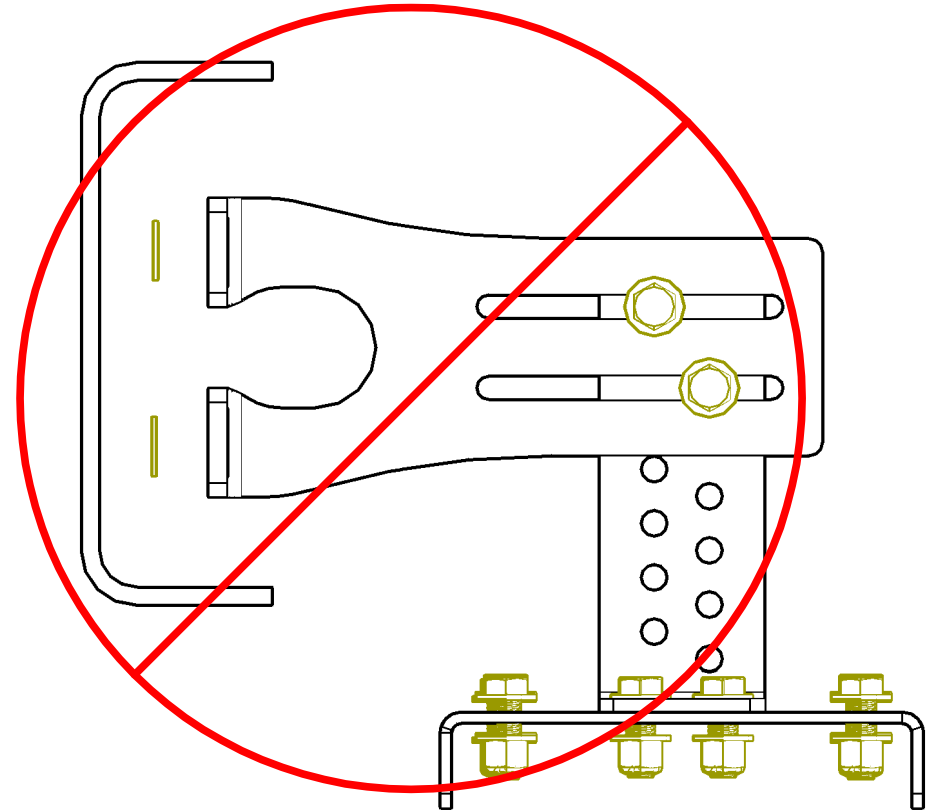

NEVER SPACE INSIDE FRAME BRACKET (1)  
AWAY FROM FRAME RAIL

ITEM	QTY	COMPONENT DESCRIPTION
1	2	INSIDE FRAME BRACKET
2	2	ADJUSTABLE "L" BRACKET
3	1	FILTER MOUNTING PLATE

ITEM	QTY	HARDWARE DESCRIPTION
A	16	7/16-14 X1-1/2 BOLT,NUT,WASHER,ASSY

**DIESEL EMISSIONS SERVICE**  
PORTLAND REDDING OAKLAND ONTARIO  
888-792-2922

Size <b>A</b>	Drawing No. <b>DES M8010</b>
Scale NOT TO SCALE	Sheet 6 of 6