

# DIESEL EMISSIONS SERVICE

RETROFIT AND REPOWER SPECIALISTS

Portland | Redding | Oakland | Ontario

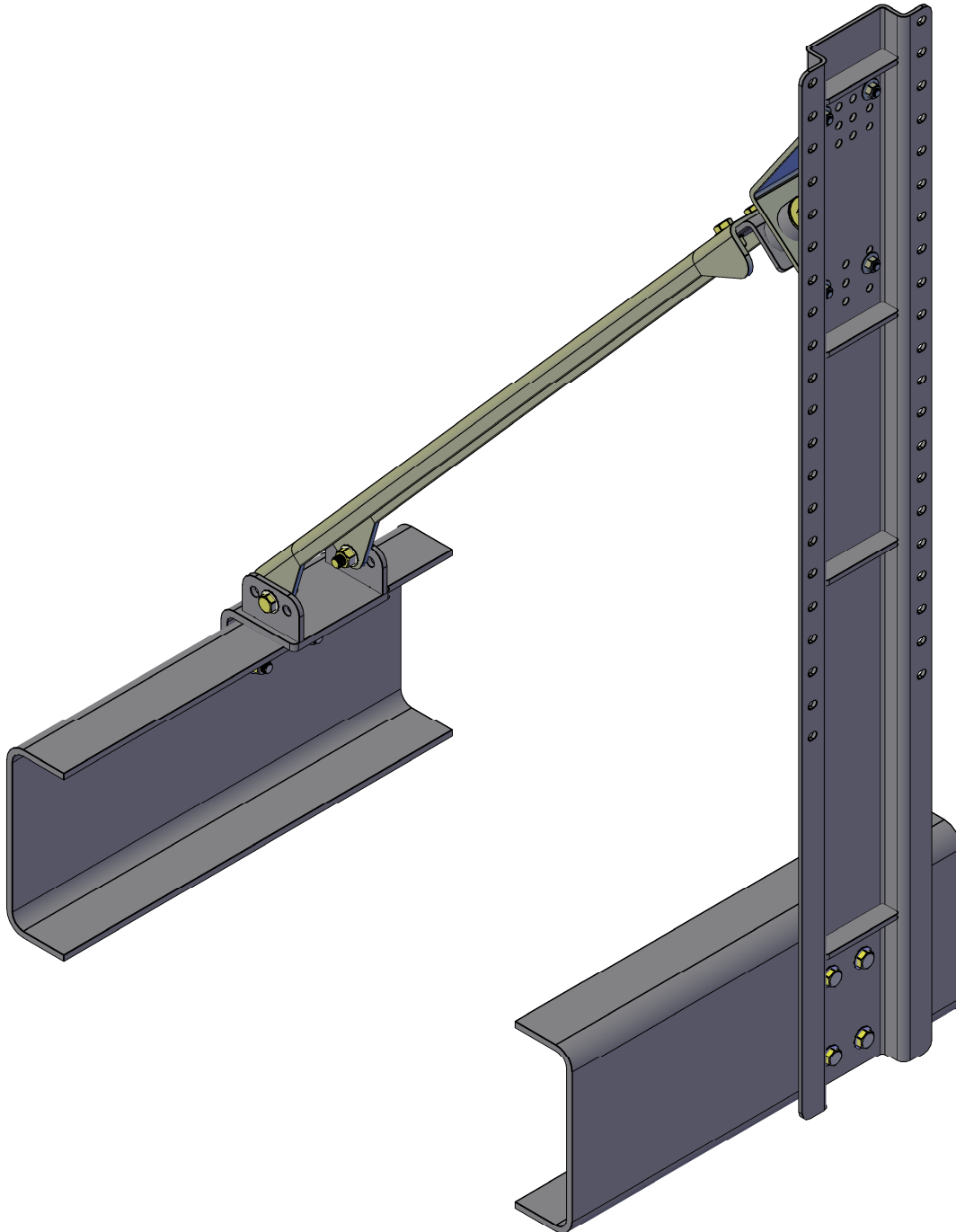

## DES VM6040 VERTICAL MOUNT

ALL INSTALLATION INSTRUCTIONS AND GUIDELINES MUST BE THOROUGHLY READ AND UNDERSTOOD BEFORE INSTALLING A DIESEL EMISSIONS SERVICE PRODUCT



## **PRODUCT GUIDELINES**

**Diesel Emissions Service recommends its products be installed by a trained technician with proper tools and safety equipment. In addition all Diesel Emissions Service mounting brackets should be installed using good judgment and sound mechanical principles. Since all installations are unique, it is the sole responsibility of the installer to determine the best fit and function of the DPF mounting brackets.**

## **PRODUCT SAFETY**

**Diesel Emissions Service products are designed for “ON-ROAD” applications only. Modifications to any Diesel Emissions Service product are not recommended and can compromise the bracket performance. Diesel Emissions Service claims no liability or responsibility for the improper application or installation of its products.**

## **PRODUCT WARRANTY**

**Diesel Emissions Service warrants to the original purchaser of its products that such products will be free from defects in material and workmanship under normal use. Diesel Emissions Service’s obligation under this warranty is solely and exclusively limited to repair and or replacement, at Diesel Emissions Service option, of the product (or components thereof) which Diesel Emissions Service’s examination proves to its satisfaction to be defective. Diesel Emissions Service SHALL HAVE NO OBLIGATION FOR CONSEQUENTIAL DAMAGES TO PERSONAL OR REAL PROPERTY, OR FOR INJURY TO ANY PERSON.**

**This warranty does not apply to products which have been subject to improper use, accident, negligence, abuse or misuse.**

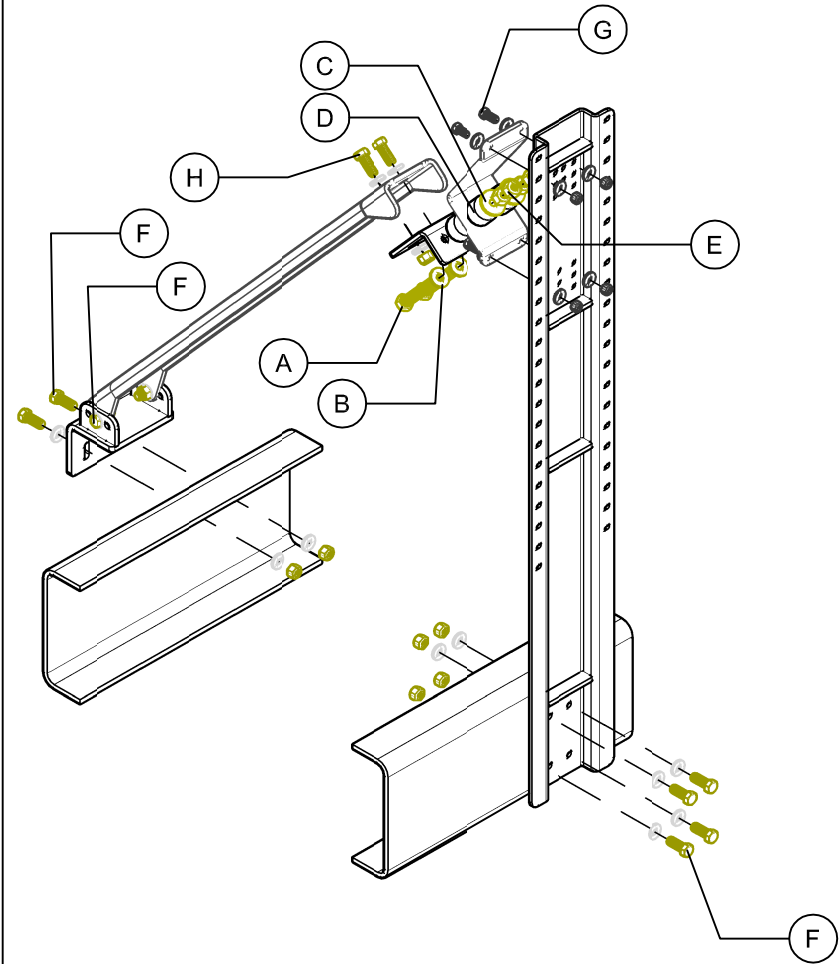
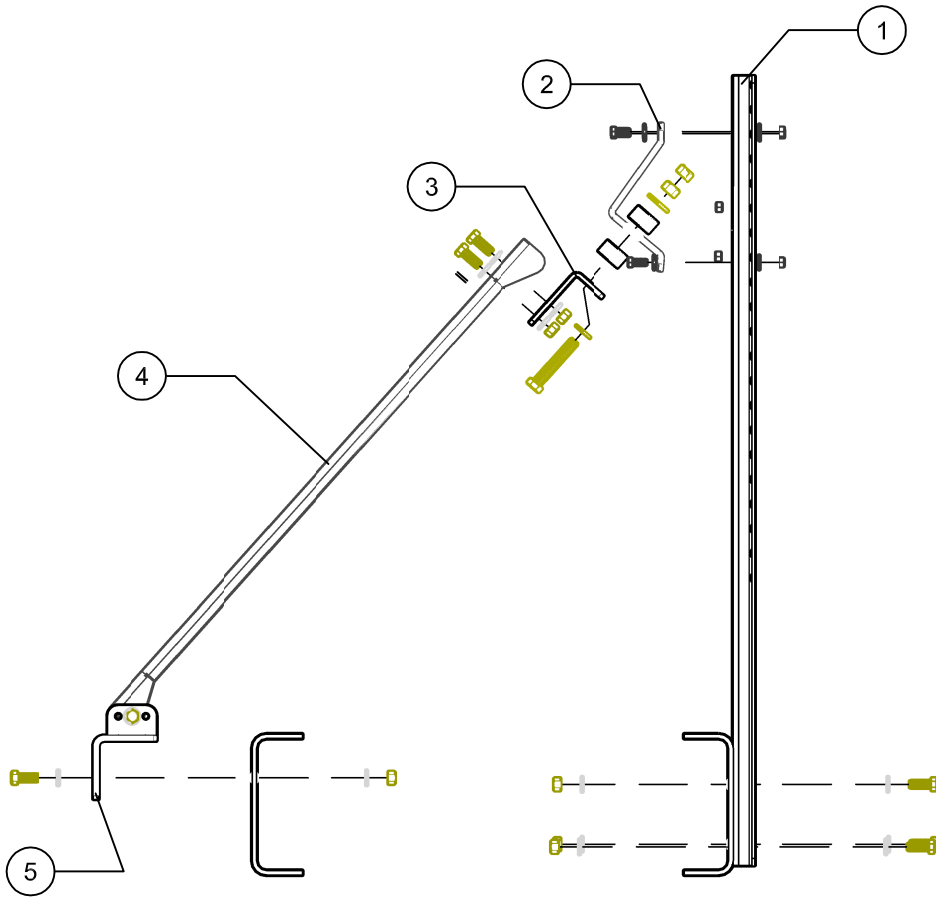

ITEM	QTY	COMPONENT DESCRIPTION	ITEM	QTY	HARDWARE DESCRIPTION
1	1	56" VERTICAL STANCHION	A	2	5/8 -11 X 4 INCH BOLT
2	1	UPPER ISOLATOR BRACKET	B	2	5/8 SAE WASHER
3	1	UPPER CROSS BAR BRACKET	C	2	5/8 USS WASHER
4	1	CROSS BAR	D	4	2" THICK POLY ISOLATORS
5	1	LOWER CROSS BAR BRACKET	E	4	5/8 -11 HEX NUTS
			F	8	1/2 - 13 X1-3/4 BOLT,NUT,WASHER,ASSY
			G	4	3/8 - 16 X1-1/2 BOLT,NUT,WASHER,ASSY
			H	3	7/16-14 X1-1/2 BOLT,NUT,WASHER,ASSY

**DIESEL EMISSIONS SERVICE**  
 PORTLAND REDDING OAKLAND ONTARIO  
 888-792-2922

**FITS HUG UP TO R40 AND  
 CDTi UP TO SC28  
 "ISOLATION REQUIRED"**

Size <b>A</b>	Drawing No. <b>DES VM6040</b>	Rev
Scale NOT TO SCALE	CAD File	Sheet 1 OF 7

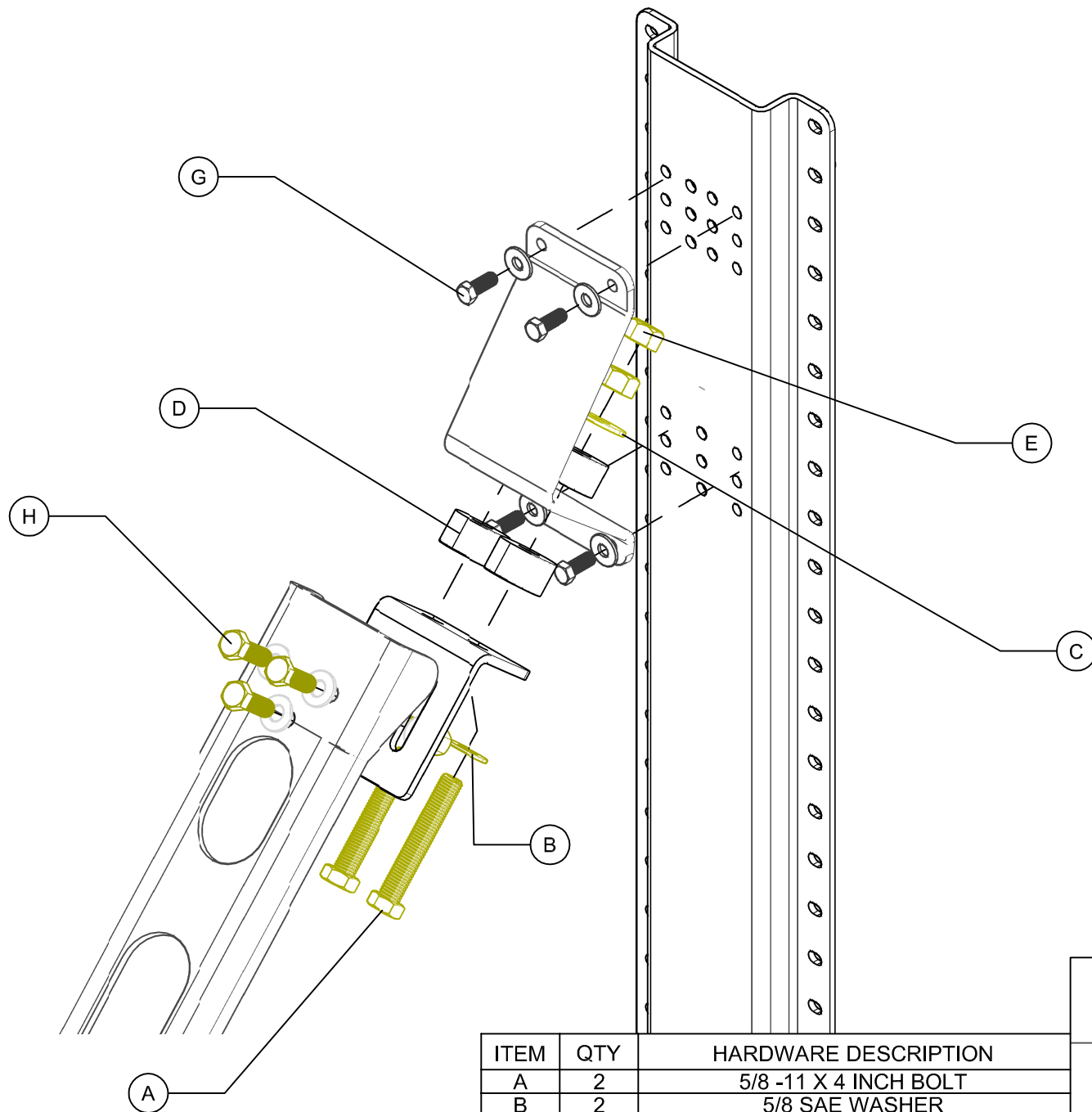

ITEM	QTY	HARDWARE DESCRIPTION
A	2	5/8 -11 X 4 INCH BOLT
B	2	5/8 SAE WASHER
C	2	5/8 USS WASHER
D	4	2" THICK POLY ISOLATORS
E	4	5/8 -11 HEX NUTS
G	4	3/8 - 16 X1-1/2 BOLT,NUT,WASHER,ASSY
H	3	7/16-14 X1-1/2 BOLT,NUT,WASHER,ASSY

**DIESEL EMISSIONS SERVICE**  
PORTLAND REDDING OAKLAND ONTARIO  
888-792-2922

**FITS HUG UP TO R40 AND  
CDTi UP TO SC28  
"ISOLATION REQUIRED"**

Size <b>A</b>	Drawing No. <b>DES VM6040</b>	Rev
Scale NOT TO SCALE	CAD File	Sheet 2 OF 7

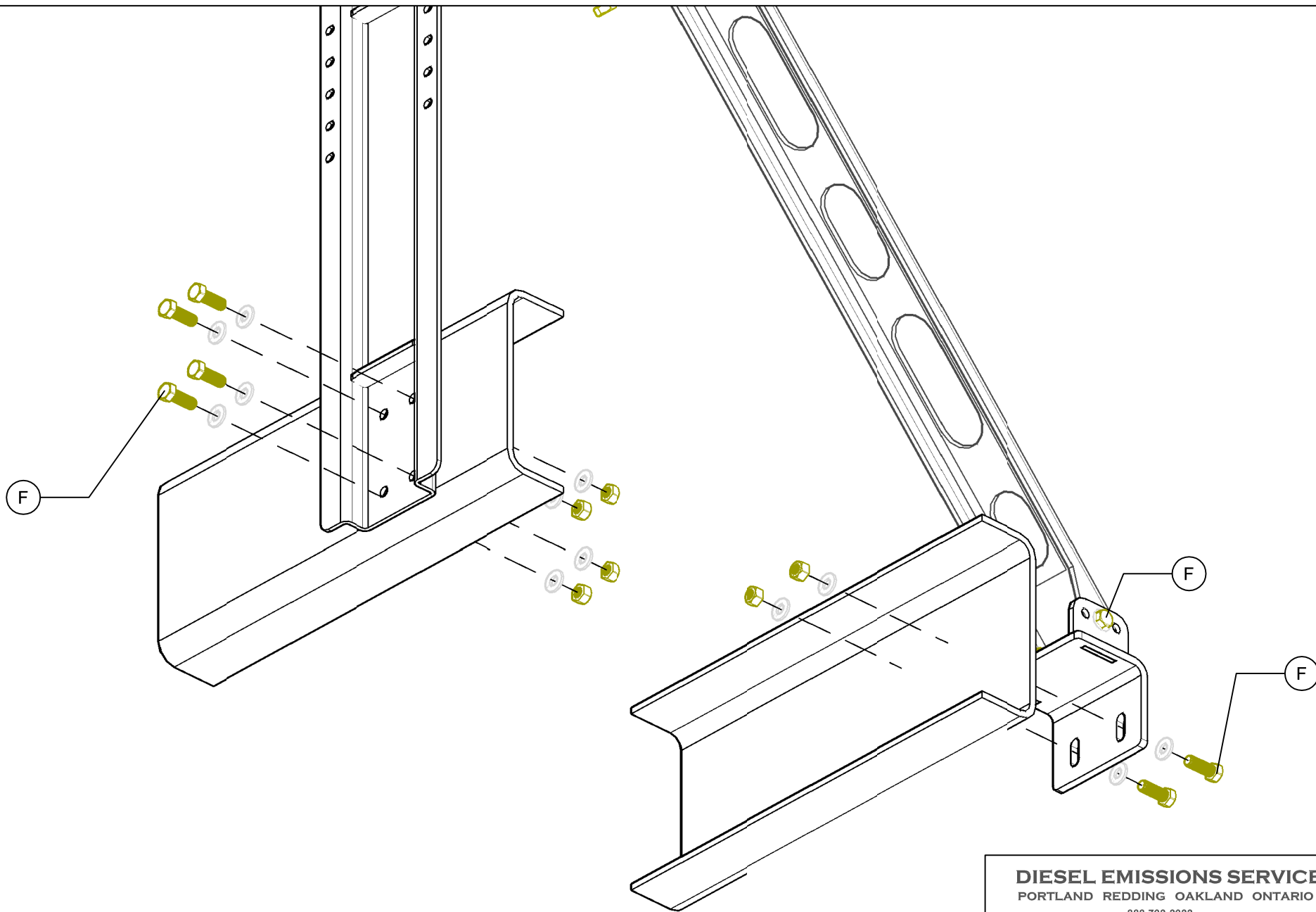

**DIESEL EMISSIONS SERVICE**  
PORTLAND REDDING OAKLAND ONTARIO  
888-792-2922

**FITS HUG UP TO R40 AND  
CDTi UP TO SC28  
"ISOLATION REQUIRED"**

Size <b>A</b>	Drawing No. <b>DES VM6040</b>	Rev
Scale NOT TO SCALE	CAD File	Sheet 3 OF 7

ITEM	QTY	HARDWARE DESCRIPTION
F	8	1/2 - 13 X1-3/4 BOLT,NUT,WASHER,ASSY

## CORRECT

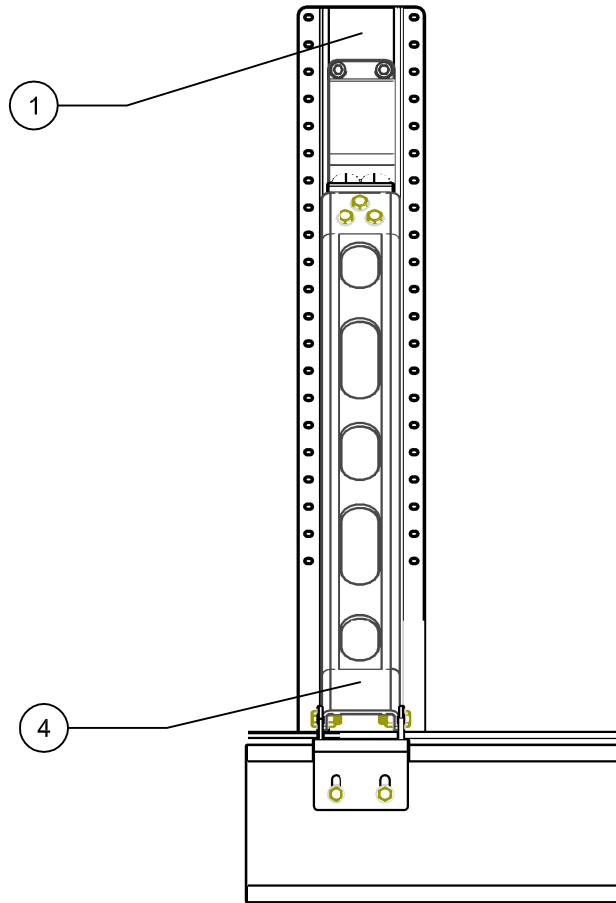

CROSS BAR(4) MUST BE PLACED  
PARALLEL TO 56"VERTICAL STANCHION(1)

## INCORRECT

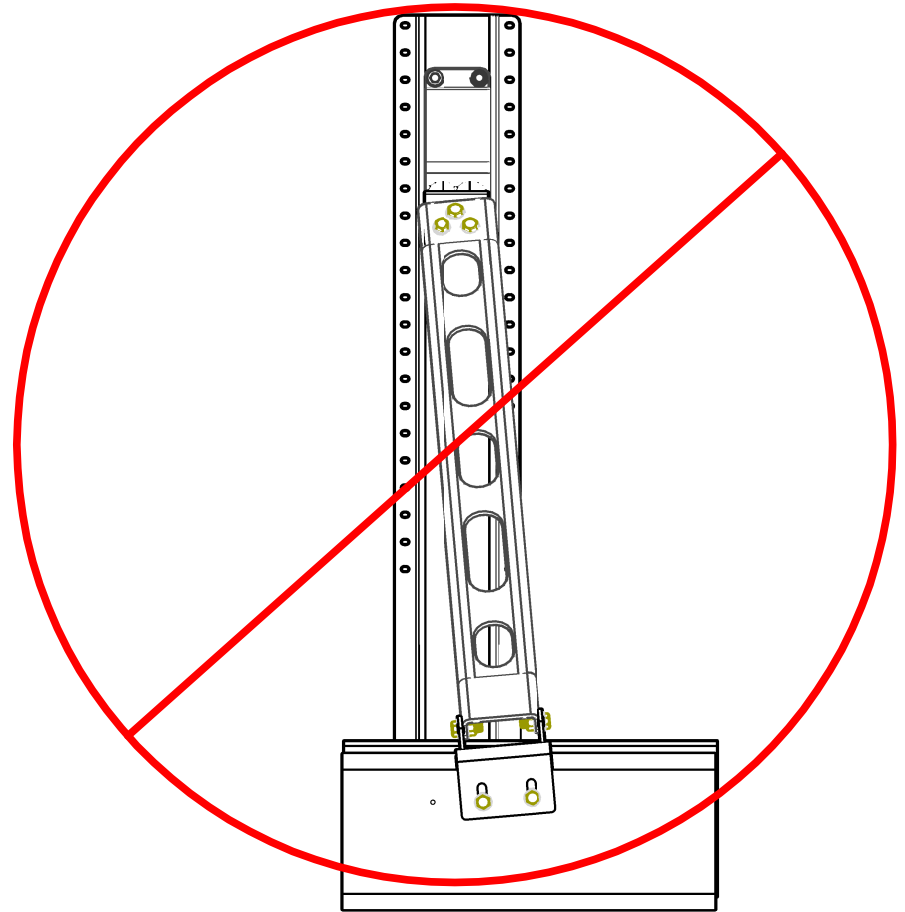

FAILURE TO INSTALL CROSS BAR (4) PARALLEL  
TO VERTICAL STANCHION (1) CAN COMPROMISE  
BRACKET INTEGRITY AND RESULT IN BRACKET  
FAILURE AND OR DAMAGE TO FILTER!

ITEM	QTY	COMPONENT DESCRIPTION
1	1	56" VERTICAL STANCHION
4	1	CROSS BAR

**DIESEL EMISSIONS SERVICE**  
PORTLAND REDDING OAKLAND ONTARIO  
888-792-2922

Drawing No.

**DES VM6040**

Scale NOT TO SCALE

Size A

Sheet  
4 OF 7

CORRECT

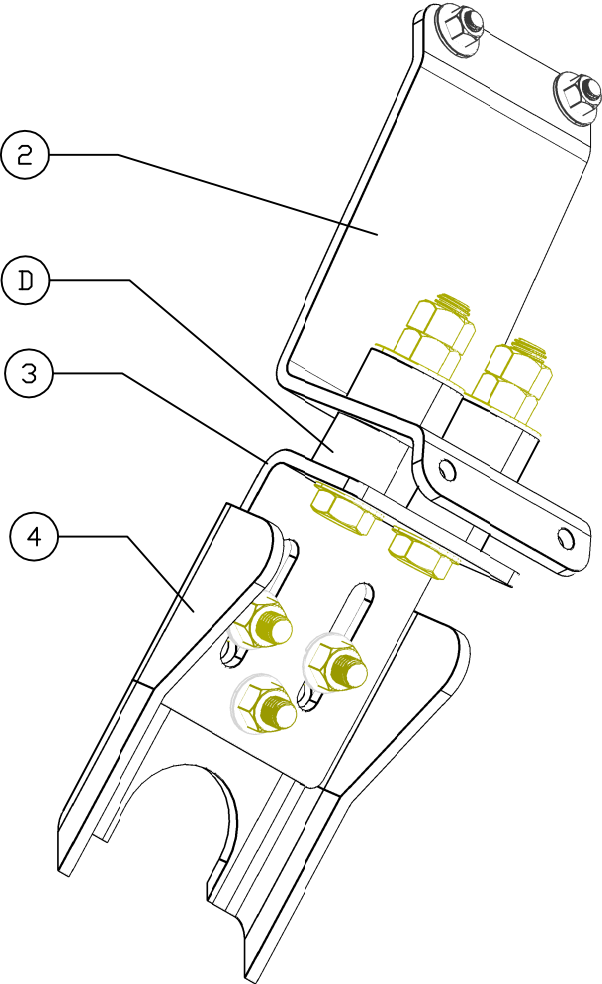

ISOLATORS (D) MUST BE  
COMPRESSED EQUALLY



ISOLATORS (D) SHOULD BE  
COMPRESSED APPROXIMATELY  
25-30%

ITEM	QTY	COMPONENT DESCRIPTION
2	1	UPPER ISOLATOR BRACKET
3	1	UPPER CROSS BAR BRACKET
4	1	CROSS BAR

ITEM	QTY	HARDWARE DESCRIPTION
D	4	2" THICK POLY ISOLATORS

INCORRECT

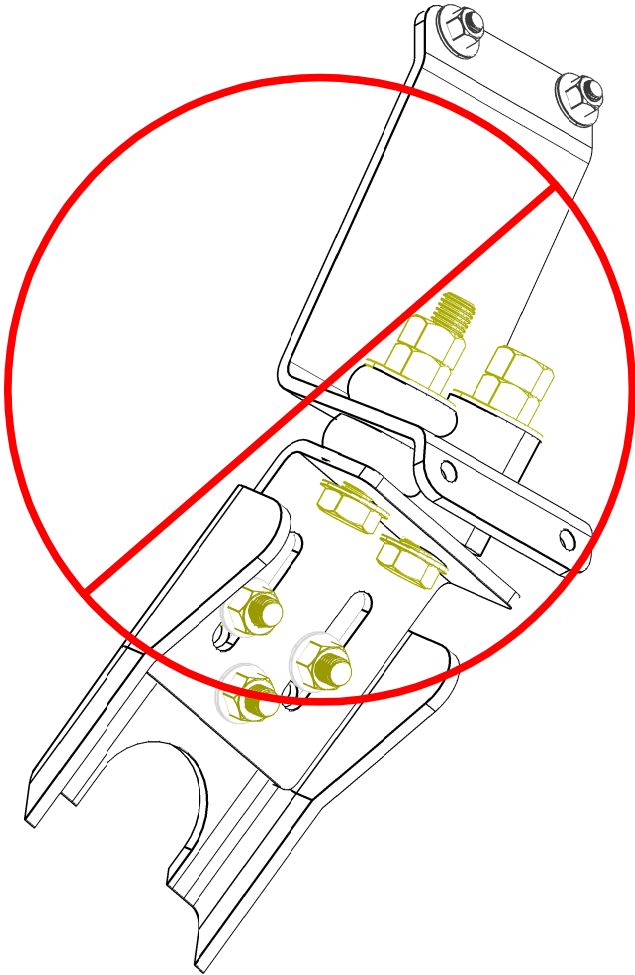

IMPROPER ISOLATOR COMPRESSION  
CAN LEAD TO ISOLATOR AND  
BRACKET FAILURE

**DIESEL EMISSIONS SERVICE**  
PORTLAND REDDING OAKLAND ONTARIO  
888-792-2922

Drawing No. <b>DES VM6040</b>		
Scale NOT TO SCALE	Size A	Sheet 5 OF 7

CORRECT

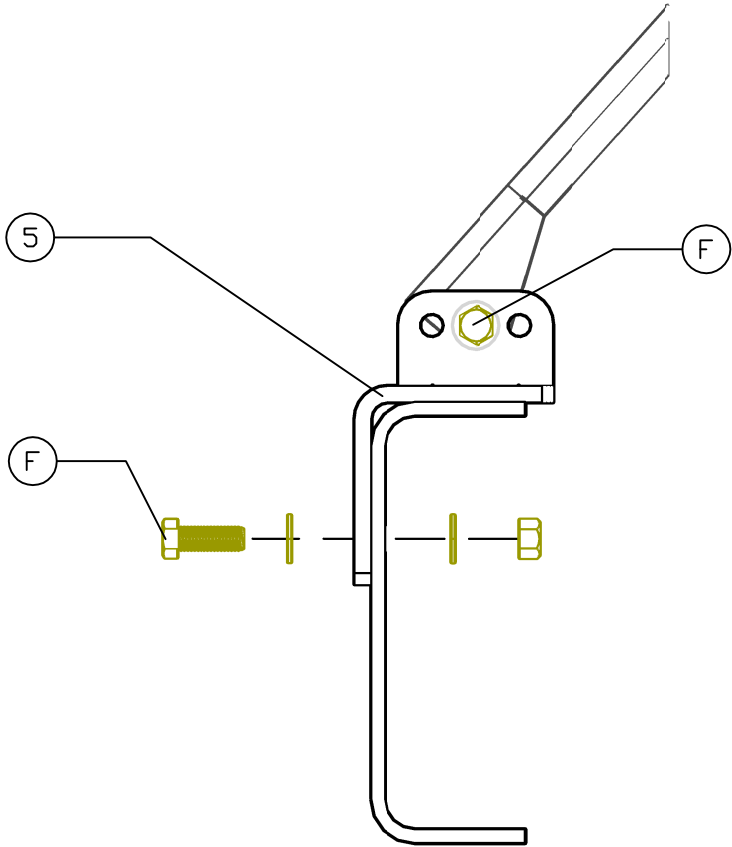

LOWER CROSS BAR BRACKET (5) MUST SEAT FLUSH TO FRAME RAIL

INCORRECT

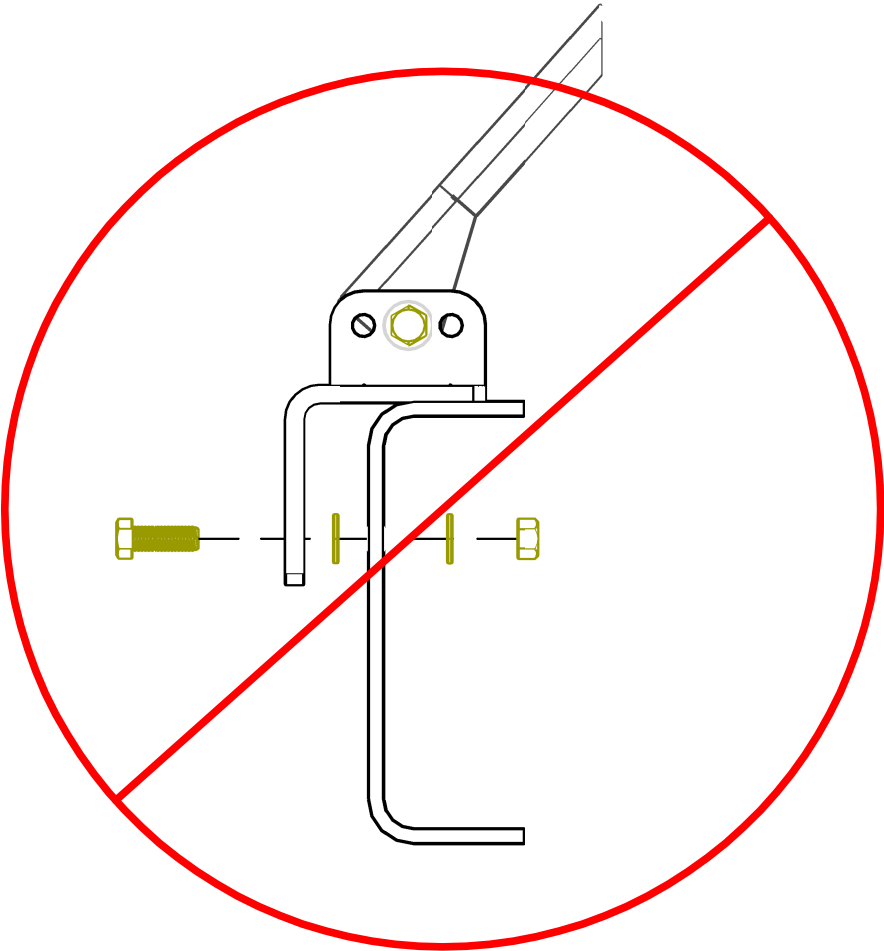

NEVER SPACE LOWER CROSS BAR BRACKET (5) AWAY FROM FRAME RAIL

**DIESEL EMISSIONS SERVICE**  
PORTLAND REDDING OAKLAND ONTARIO  
888-792-2922

Drawing No. **DES VM6040**

ITEM	QTY	COMPONENT DESCRIPTION	ITEM	QTY	HARDWARE DESCRIPTION	Scale	Size	Sheet
5	1	LOWER CROSS BAR BRACKET	F	8	1/2 - 13 X1-3/4 BOLT,NUT,WASHER,ASSY	NOT TO SCALE	A	6 of 7



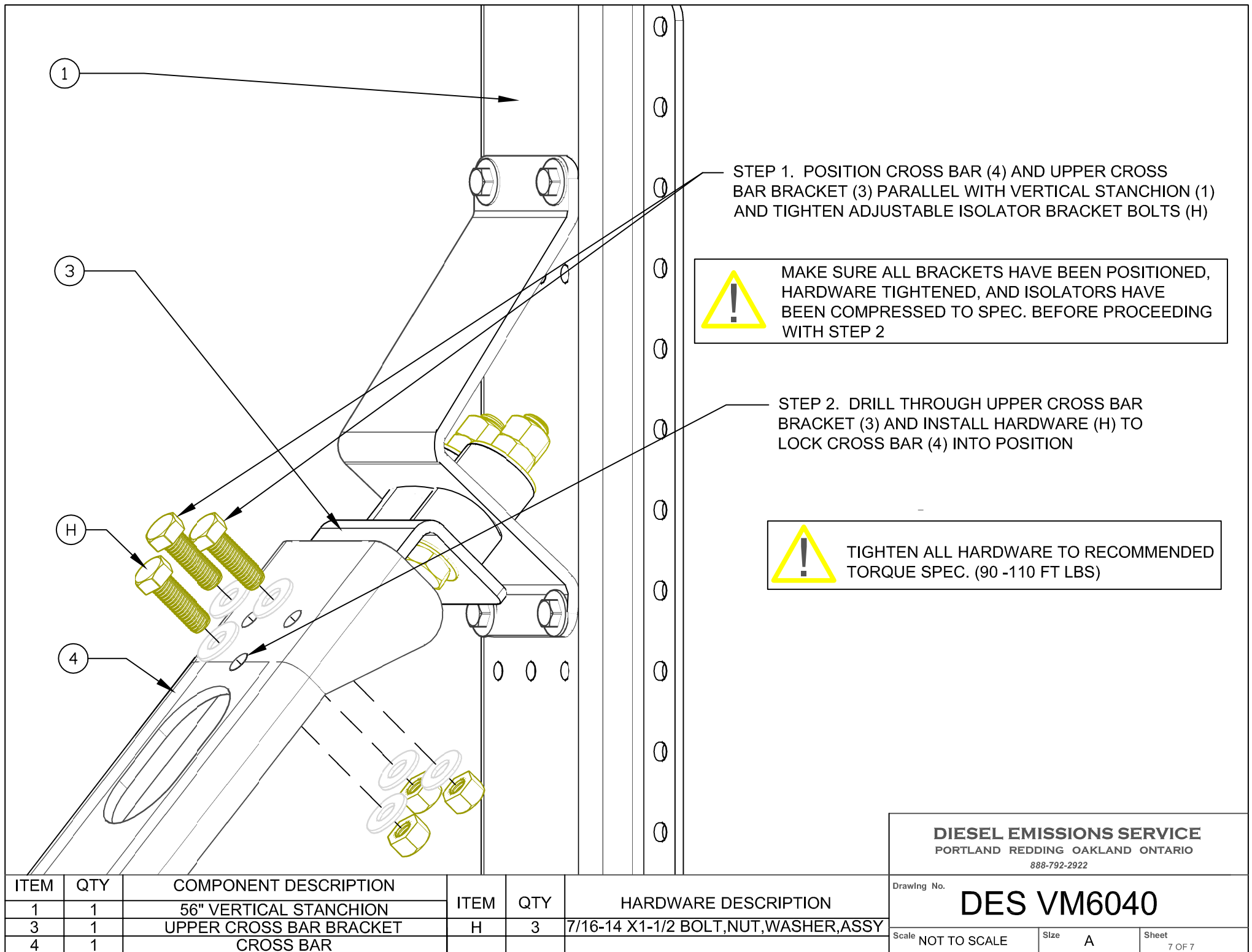

STEP 1. POSITION CROSS BAR (4) AND UPPER CROSS BAR BRACKET (3) PARALLEL WITH VERTICAL STANCHION (1) AND TIGHTEN ADJUSTABLE ISOLATOR BRACKET BOLTS (H)



MAKE SURE ALL BRACKETS HAVE BEEN POSITIONED, HARDWARE TIGHTENED, AND ISOLATORS HAVE BEEN COMPRESSED TO SPEC. BEFORE PROCEEDING WITH STEP 2

STEP 2. DRILL THROUGH UPPER CROSS BAR BRACKET (3) AND INSTALL HARDWARE (H) TO LOCK CROSS BAR (4) INTO POSITION



TIGHTEN ALL HARDWARE TO RECOMMENDED TORQUE SPEC. (90 -110 FT LBS)

**DIESEL EMISSIONS SERVICE**  
PORTLAND REDDING OAKLAND ONTARIO  
888-792-2922

ITEM	QTY	COMPONENT DESCRIPTION	ITEM	QTY	HARDWARE DESCRIPTION
1	1	56" VERTICAL STANCHION			
3	1	UPPER CROSS BAR BRACKET	H	3	7/16-14 X1-1/2 BOLT,NUT,WASHER,ASSY
4	1	CROSS BAR			

Drawing No. <b>DES VM6040</b>		
Scale NOT TO SCALE	Size A	Sheet 7 OF 7