

Tuttle Emergency Management

emtuttle.com

Floodplain Administration • Information Technology • Grants/Special Projects

PO Box 10 • 221 W Main St
Tuttle, OK 73089
Phone: 405.381.5900
Fax: 405.381.5901
Email: em@cityoftuttle.com
Facebook/Twitter: emtuttle

Office use only

Address _____

GPS: _____

Application for a 911 Address
For Residential & Commercial Addressing Requests
Revised 9/8/16

Owner's Name _____ Phones _____

E-Mail _____

Mailing Address _____

Subdivision/Lot/Block/Parcel Number/Legal Description of Site _____

REQUEST TYPE	Single Occupancy	Multiple Occupancy	Large Developments
	<input type="checkbox"/> Vacant Lot	<input type="checkbox"/> Duplex/Triplex/Quadplex	<input type="checkbox"/> Entire Subdivision
	<input type="checkbox"/> New Structure/Utility	<input type="checkbox"/> Apartments	<input type="checkbox"/> Entire Block
	<input type="checkbox"/> Change Existing Address	<input type="checkbox"/> Strip Mall	<input type="checkbox"/> Mobile Home Park (MHP)

Initial to indicate your understanding & acceptance of the following:

_____ If your driveway will have more than one address on it, it must be named as a street and the other addresses on that street must be re-assigned. This requires prior approval by the Planning Commission & City Council.

_____ Addresses & street names are assigned per City ordinance. They are not guaranteed permanent and could be changed to fix errors, allow for new development, or to improve emergency response.

_____ If your Application is for a subdivision, MHP, or multi-occupancy structure, it will not be processed without a legible copy of the plat map and/or building plans.

_____ Once an address is assigned, a copy of this Application will be sent to the US Postal Service, telephone & power companies & other government agencies so your new address can be set up in their systems.

_____ As part of this process, a floodplain determination will be completed. ALL development in the City is subject to the provisions of the City's floodplain ordinances and it Applicant's responsibility to fully comply with them.

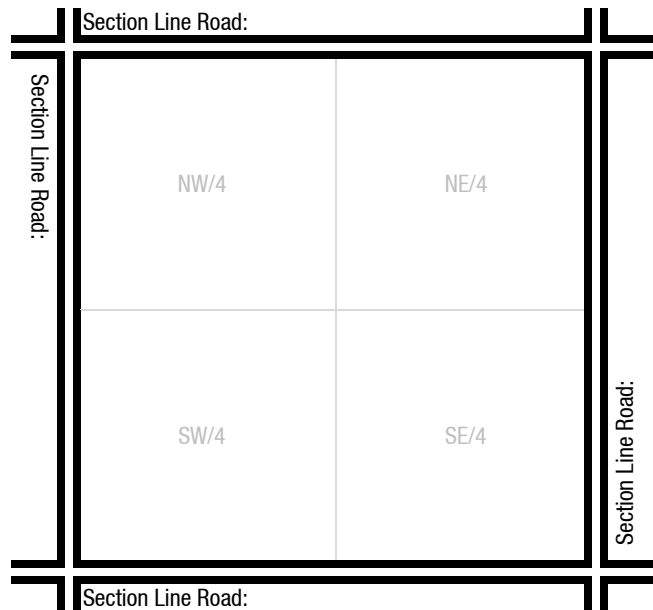

Inside the square: (1) Name the 4 Section Line Roads
(2) Put an X where your structure is/will be

I authorize City Staff to enter upon the above-described property to gather data needed to process this Application & maintain the City's 911 Address Program. I am the owner of the property described herein. The information provided is complete & accurate to the best of my knowledge.

Owner's Signature _____ Date _____

Office use only – Staff enter dates of notification, initials & notes. After notifications are complete, provide Applicant a copy & retain original in Property Files.

Property contains no floodplain as per current maps.
 Property contains floodplain as described:

Flood Zone _____ FIRM Panel _____ FIRM Date _____