

Tuttle Emergency Management

emtuttle.com

Emergencies happen. Prepare today.

PO Box 10 • 221 W Main St
Tuttle, OK 73089
Phone: 405.381.5900
Fax: 405.381.5901
Email: em@cityoftuttle.com
Facebook/Twitter: emtuttle

Application for a 911 Address

For Residential & Commercial Addressing Requests

911 Address # _____

Office use only

Street Name _____

Office use only

Latitude _____ Longitude _____

Office use only

Owner's Name _____ Phone _____ Fax _____ Date _____

Mailing Address _____

Subdivision/Lot/Block/Legal Description of Site _____

Name of Road that Driveway Accesses (if known, otherwise nearest intersection) _____

Type of Request (circle one) **Entire Subdivision or Block** **Existing Structure on Single Lot** **Vacant Single Lot**

Initial to indicate your understanding & acceptance of the following:

If your driveway will have more than one address on it, it must be named as a street and the other addresses on that street must be re-assigned. This requires approval by the Planning Commission & City Council.

City Staff will have to collect GPS information for your lot & street as part of this process. Your signature on this application authorizes City representatives to enter your property for that purpose if needed.

AUTHORIZATION: The City of Tuttle and their agents or designees, singularly or jointly, are authorized to enter upon the property described on the application for the purpose of gathering location data or for any reason consistent with the City of Tuttle's Code of Ordinances. I further verify that the information provided by me on this application is true, complete, and accurate to the best of my knowledge and belief. I understand that all plans, specifications, attachments, and applications for permit filed shall constitute by reference a part of this Application.

Applicant Signature _____

Date _____

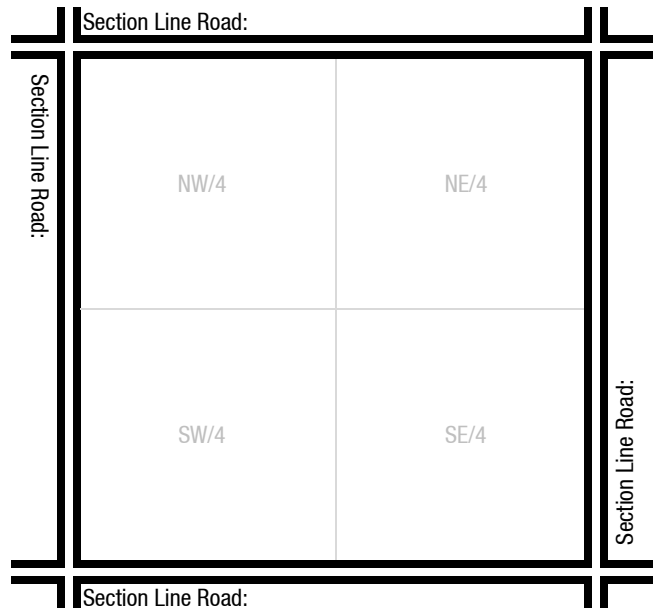

Inside the square: (1) Name the 4 Section Line Roads
(2) Put an X where your structure is/will be

Office use only – Staff enter dates of notification & initials. After notifications are complete, provide Applicant a copy & retain original in Property Files.

Address assigned by _____ ACOG (405-234-2200) _____ AT&T (405-278-3501) _____

Date assigned _____ OEC (405-217-6900) _____ GCSO (405-222-4561) _____

TPD (405-381-4112) _____ PSO (866-947-0378) _____ USPS (405-381-3514) _____