

# ASSEMBLE INSTRUCTION

## 5465T14DB-3

Ø14"\*H26"

110V E12 3\*40W MAX

- 1.PLEASE TAKE OFF THE PLASTIC SHEET FROM THE LAMP BODY.
- 2.PLEASE WEAR GLOVES WHEN INSTALLATION.

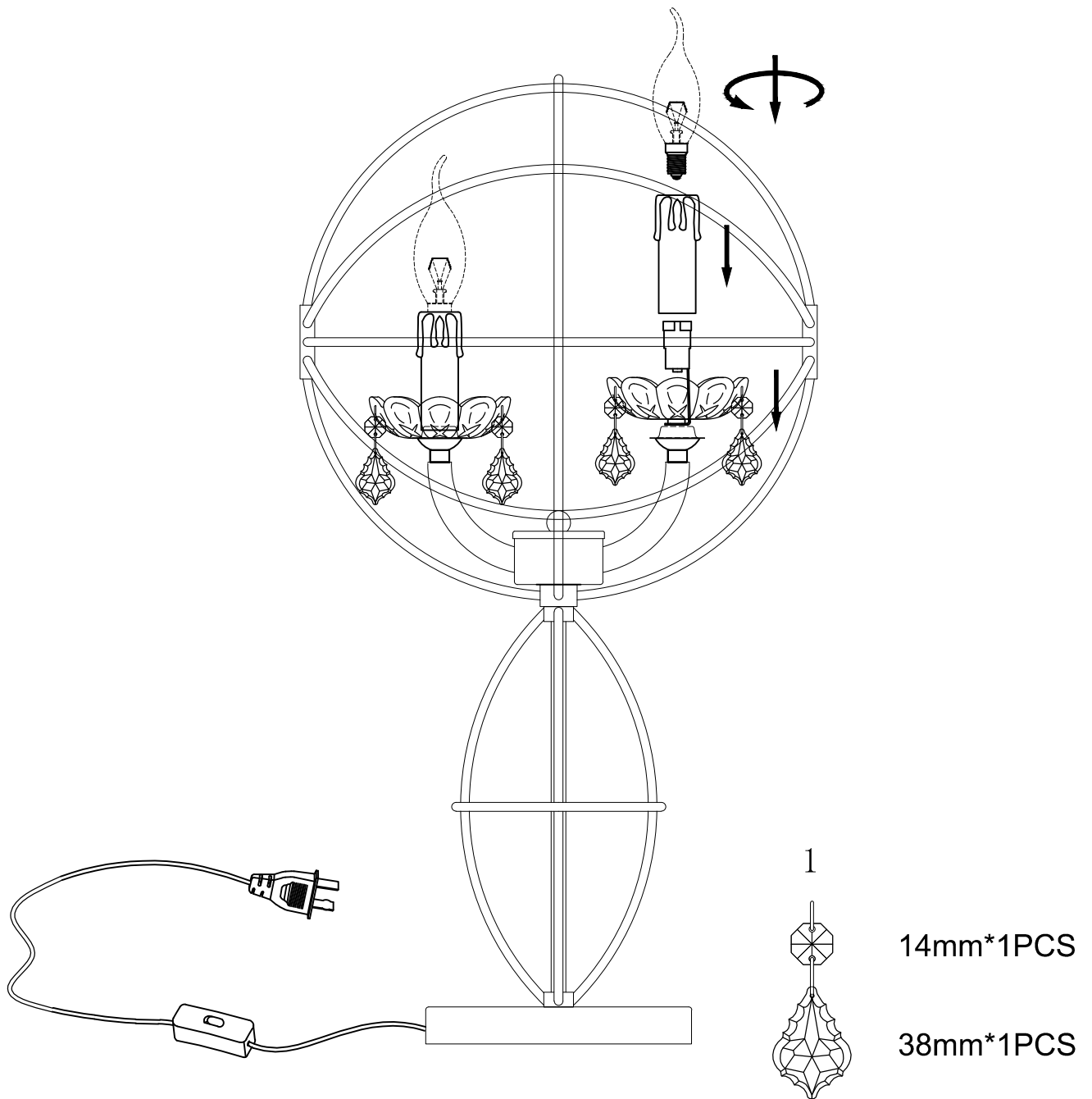

NO.	1		
Quantity	12		