

NOTICE OF NEIGHBORHOOD INFORMATION MEETING

Based upon the action requested below, the City of Topeka is requiring the listed developer to hold a neighborhood information meeting prior to the Planning Commission public hearing:

Thursday, July 27, 2017, at 6:00 pm

Reynolds Lodge at Lake Shawnee

3315 SE Tinman Circle

Topeka, Kansas

(See attached map for proposed project site and meeting location.)

You have been identified as a property owner of record (see attached map)

You have been identified as a property owner of record within **500' (if within City of Topeka)** and/or **1,000' (if within Shawnee County)** of a potential project site being proposed for a change in zoning, along with new development. The public is invited to attend this information meeting to learn more about the project from the applicant/developer and to have an opportunity to ask questions about their proposal as described below.

Project Information

Action Requested: Proposed zoning change for property located at northeast corner of the intersection of SE 29th Street and SE Wittenberg Road **from** "R-1 Single Family Residential" **to** "PUD Planned Unit Development," with specific uses consisting of indoor and outdoor self-service storage facility including onsite management office and future additional office spaces available for lease. Other impending development action within the project area includes processing of proposed subdivision plat consisting of ten (10) new lots including proposed PUD-zoned lot for self-service storage facility and nine (9) new residential lots to be accessed from new east-west street/cul-de-sac to be located off Wittenberg Road, approximately 850 feet north of 29th Street.

Size & Location of Development:

Entire project area consists of 21.51 Acres located at the northeast corner of SE 29th Street SE Wittenberg Road, with proposed PUD with self-service storage facility located in southerly portion of project area being approximately 10.74 acres in size.

Name of Applicant: Mr. Frank Meade

**Name of Applicant's
representative:** Mr. C.L. Maurer/ LandPlan Engineering,
E-mail: clm@landplan-pa.com

Comprehensive Plan Designation: Urban/Suburban Low Density Residential

Scope of Project: Proposed new zoning will provide for self-service storage facility and offices, as well as new single-family residential lot(s).

City Council District: District #4 – Tony Emerson

Anticipated Planning Commission Public Hearing: 6:00 PM Monday, August 21, 2017 in City Council Chambers

If unable to attend the Neighborhood Information Meeting, questions may be submitted prior to the meeting to be included in the developer's report to the City. Questions or comments may be sent to:

City of Topeka Planning Department
ATTN: Case Planner – John Neunuebel
620 SE Madison, Unit 11
Topeka, KS 66607
Phone: (785) 368-3011 | Email: jneunuebel@topeka.org

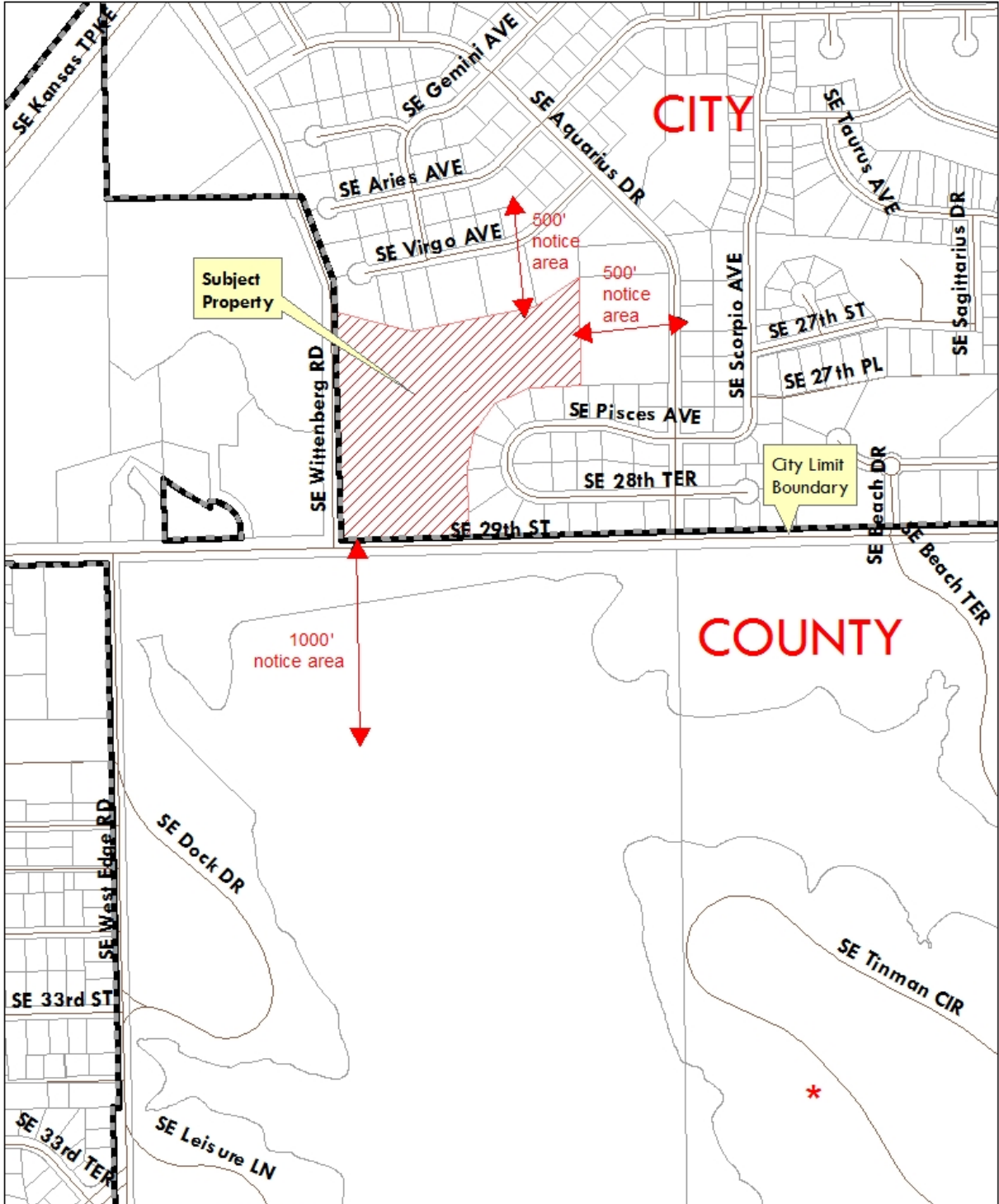

* = Neighborhood Information
 Meeting Location:
 Reynolds Lodge at
 Lake Shawnee
 3315 SE Tinman Circle

