

## **NOTICE OF NEIGHBORHOOD INFORMATION MEETING**

Based upon the action requested below, the City of Topeka is requiring the listed developer to hold a second neighborhood information meeting prior to the Planning Commission meeting as deferred to the meeting of October 16, 2017 after the Public Hearing held by the Planning Commission on August 15, 2015:

**Tuesday, September 26, 2017, at 6:00 pm**  
**Reynolds Lodge at Lake Shawnee**  
**3315 SE Tinman Circle**  
**Topeka, Kansas**  
(see attached map)

You have been identified as a property owner of record within **500' (if within City of Topeka)** and/or **1,000' (if within Shawnee County)** of a potential project site being proposed for a change in zoning along with new development. The public is invited to attend this second information meeting to learn more details from the project applicant/developer regarding changes in the proposed project and have an opportunity to ask questions about the application as described below.

### **Project Information**

**Action Requested:** Proposed zone change for property located at northeast corner of the intersection of SE 29<sup>th</sup> Street and SE Wittenberg Road **from** "R-1" Single Family Residential" **to** "PUD Planned Unit Development," with specific uses consisting of self-service storage facility within multiple buildings, along with offices within multiple buildings. Pursuant to Planning Commission direction, the applicant is proposing revisions to the layout and mix of self-service storage and office buildings.

**Size & Location of Development:** 10.7 acres located at northeast corner of the intersection of SE 29<sup>th</sup> Street and SE Wittenberg Road

**Name of Owner:** Marcia E. Herrman Living Trust

**Name of Applicant:** Mr. Frank Meade

**Name of Applicant's representative:** Mr. C.L. Maurer/; email: [clm@landplan-pa.com](mailto:clm@landplan-pa.com)

**Comprehensive Plan Designation:** Urban/suburban Low Density Residential

**Scope of Project:** Proposed new zoning will provide for self-service storage, along with commercial offices

**City Council District:** District #4 – Tony Emerson

**Anticipated Planning Commission Meeting:** Monday, October 16, 2017, in City Council Chambers (Action deferred from Planning Commission meeting of August 15, 2017)

If unable to attend the Neighborhood Information Meeting, comments or questions may be submitted prior to the meeting to be included in the developer's report to the City. Comments or questions may be sent to:

City of Topeka Planning Department  
ATTN: Case Planner – John Neunuebel  
620 SE Madison, Unit 11  
Topeka, KS 66607

Phone: (785) 368-3011 | Email: [jneunuebel@topeka.org](mailto:jneunuebel@topeka.org)

Notification mail date: September 15, 2017

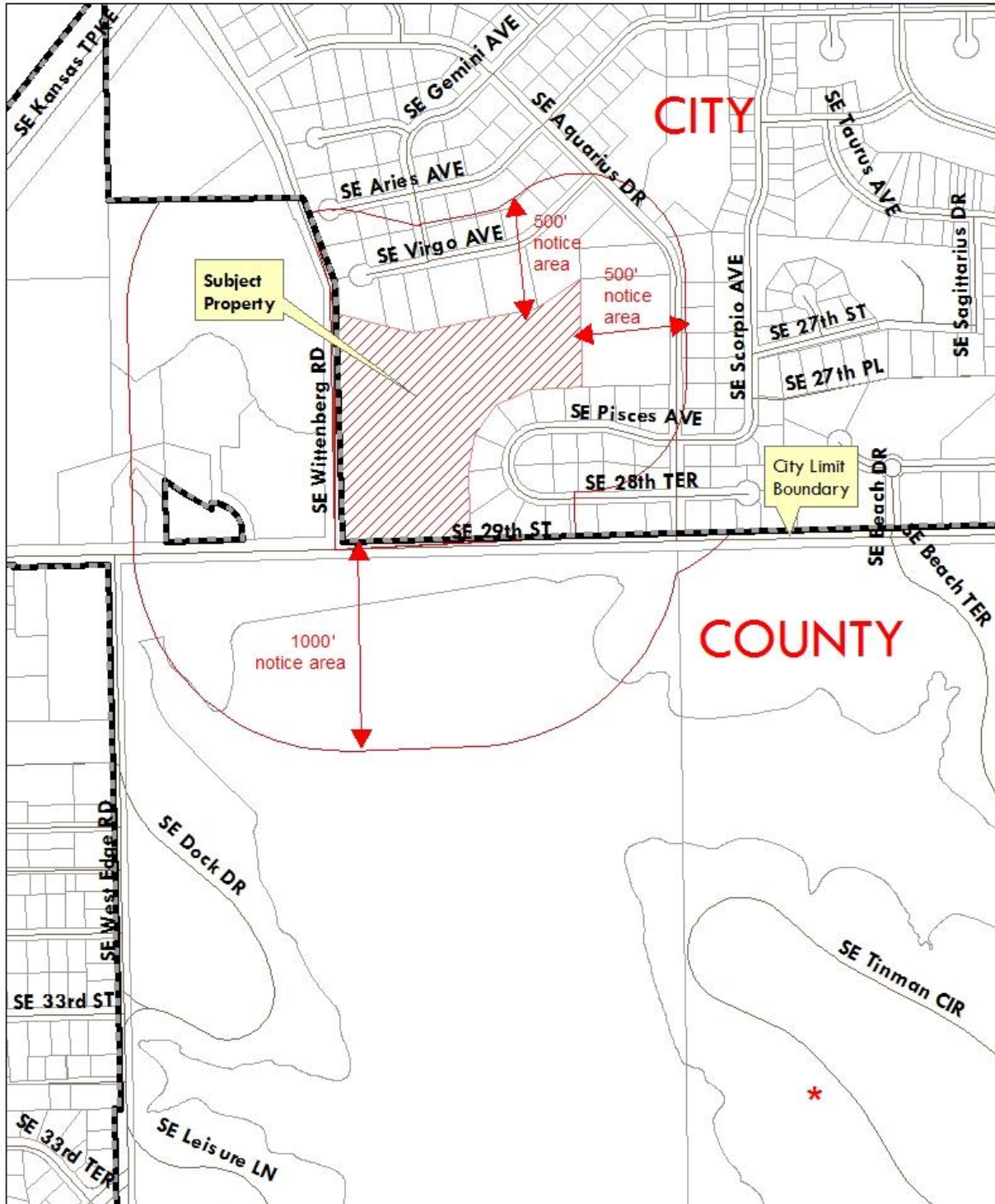

\* = Neighborhood Information  
 Meeting Location:  
 Reynolds Lodge at  
 Lake Shawnee  
 3315 SE Tinman Circle

