

General Data

Type Reference:	CTLF, CTF, CTF_250, CTF_250
Description:	Illuminated Electronic Contact Block with snap action
Approvals:	cCSAus, CE
Protection class:	II (protective insulation)
Operation travel:	3 mm
Connection type:	Faston terminals 2.8x0.8 mm
Contact material:	gold-plated 1.5µm
Max. storage temperature:	-50°C ... 85°C
Max. operating temperature:	-30°C ... 70°C, without illumination -30°C ... 55°C, using incandescent lamps -30°C ... 65°C, using LEDs
Mechanical life:	1 m switching cycles
Electrical life (rated load):	1 m operations at rated load
Contact resistance NO:	< 50 mOhm (new state)
Contact resistance NC:	< 100 mOhm (new state)
Bouncing time NO:	< 10ms
Bouncing time NC:	< 10ms

Technical Data - Lamp

Lamp socket:	T5,5K
Max. lamp voltage:	60V
Max. lamp output:	1.2W
Definition:	X1...anode, X2...cathode

Electrical Features

Rated voltage:	20mV ... 48V AC/DC
Rated current:	0.01mA ... 100mA

Electrical Data acc. to EN 61058-1 "micro disconnection", µ

Rated voltage:	250V~
Rated current:	max. 100 mA
Contact opening distance:	< 3 mm (µ)
Creepage resistance:	II / PTI 400V
Insulation resistance:	> 100 MOhm/500 V
Test voltage:	500V (61058-1 Tab.12)
Pollution degree :	2
Electrical life (additional test):	50000

Note

types CTF_250, CTF_250

The applicability of the "micro disconnection" (µ) acc. to EN 61058-1 is regulated in the relative product standards which have to be observed by the customer (product designer).

Faston terminals 2.8x0.8mm are not suitable for manual soldering.

Elektrische Daten nach C22.2 No. 14-10

Rated voltage:	20mV ... 48V AC/DC
Rated current:	0.01mA ... 100mA

Mounting Instructions

1.

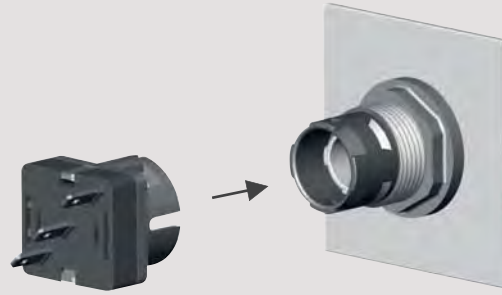

2.



3.

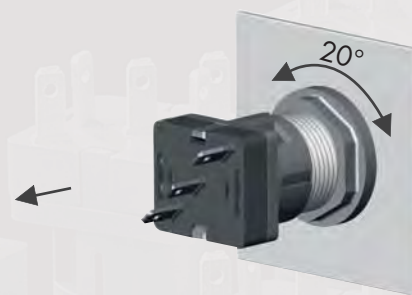

Illustration	Description	Type
	<p>Contact Unit, momentary 1 inverter Faston terminals 2.8x0.8 mm</p> <p>suitable actuators</p> <p>contact material gold-plated 1.5µm</p>	CTF
	<p>Contact Unit, momentary, for 250V~ 1 inverter Faston terminals 2.8x0.8 mm EN 61058-1 µ 250V~/100mA, µ micro-disconnection (µ)</p> <p>suitable actuators</p> <p>contact material gold-plated 1.5µm</p>	CTF_250
	<p>Illuminated Contact Unit, momentary 1 inverter Faston terminals 2.8x0.8 mm lamp socket T5,5K</p> <p>suitable actuators</p> <p>contact material gold-plated 1.5µm</p>	CTLF
	<p>Illuminated Contact Unit, momentary, for 250V~ 1 inverter Faston terminals 2.8x0.8 mm EN 61058-1 µ 250V~/100mA, µ micro-disconnection (µ) LED max. 60V</p> <p>lamp socket T5,5K</p> <p>suitable actuators</p> <p>contact material gold-plated 1.5µm</p>	CTLF_250
	<p>Lampholder Faston terminals 2.8x0.8 mm lamp socket T5,5K</p> <p>suitable pilot light heads</p>	CLF
	<p>Insulating Case for Faston clamp FH2,8, slip on from the front</p>	IH2,8
	<p>Faston Clamp 2.8 x 0.8 mm with snap-in pin Cross section 0.75 - 1.50 mm², tin-plated brass, with pin to snapfit into the sockets XA, XAL and the insulating case IH2.8</p>	FH2,8

Contact Blocks

Faston terminals 2.8x0.8 mm

made in germany



About Us

Control Units

← Contact Blocks

Panel Mount Jacks

Bus Technology

Enclosures

Terminal Blocks

Pedal Switches

Limit Switches

Type Index

Illustration

Description

Type



Double Faston

FD2,8

for the connection of 2 Faston clamps
FH2.8

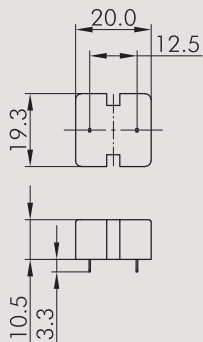

Plug-in Socket

CAFP2

PCB-mount terminals
with 2 contact pins to fit CLF lampholder

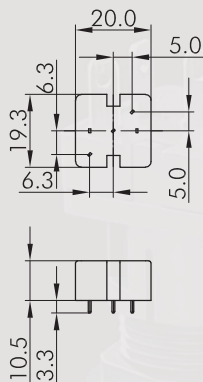
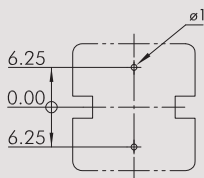

Plug-in Socket

CAFP3

PCB-mount terminals
with 3 contact pins to fit CTF contact unit

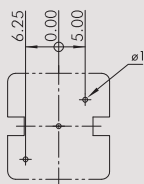

Illustration

Description

Type

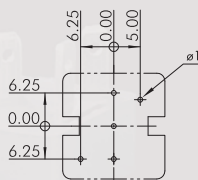
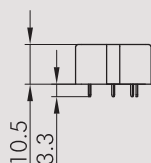
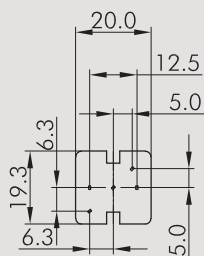

Plug-in Socket

PCB-mount terminals
with 5 contact pins to fit CTLF contact
unit

CAFP5



Ultra-bright LED, T5,5K socket, 12V

with integrated series resistor
and half-wave rectifier, for 12 V AC/DC
(7/14 mA)

When connecting to DC, the correct
polarity must be observed:

+ ... X1/- ... X2

storage temperature:

-25°C ... +80°C

ambient temperature:

-20°C ... +60°C

voltage tolerance:

+ 10 %

colour

white

L5,5K12UW

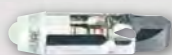

Ultra-bright LED, T5,5K socket, 24V

with integrated series resistor
and half-wave rectifier, for 24 V AC/DC
(7/14 mA)

When connecting to DC, the correct
polarity must be observed:

+ ... X1/- ... X2

storage temperature:

-25°C ... +80°C

ambient temperature:

-20°C ... +60°C

voltage tolerance:

+ 10 %

colour

white

L5,5K24UW

About Us

Control Units

→ Contact Blocks

Panel Mount Jacks

Bus Technology

Enclosures

Terminal Blocks

Pedal Switches

Limit Switches

Type Index

Contact Blocks

Faston terminals 2.8x0.8 mm

made in germany



Illustration

Description

Type



Two-colour LED, T5,5K socket - 24V

with integrated series resistor
 colour dependent on polarity
 Storage temperature:
 -25°C ... +80°C
 Ambient temperature:
 -20°C ... +60°C
 Voltage tolerance: + 10 %

Colour:	red	green
Rated current [mA]:	14	13
Brightness [mcd]:	2300	650
Dominant wavelength: [nm]	625	525

colour red/green **L5,5K24RG**



Ultra-bright LED

solder pins, grid 2.54 mm
 ready-made for CTP_485
 3680 mcd white

LED3UW

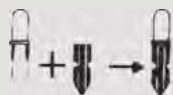

LED Adapter

for LEDs of 3 and 5 mm Ø to be used in T5.5K sockets, an external resistor must be provided.

LA5,5

lamp socket T5,5K

About Us

Control Units

Panel Mount Jacks

Bus Technology

Enclosures

Terminal Blocks

Pedal Switches

Limit Switches

Type Index

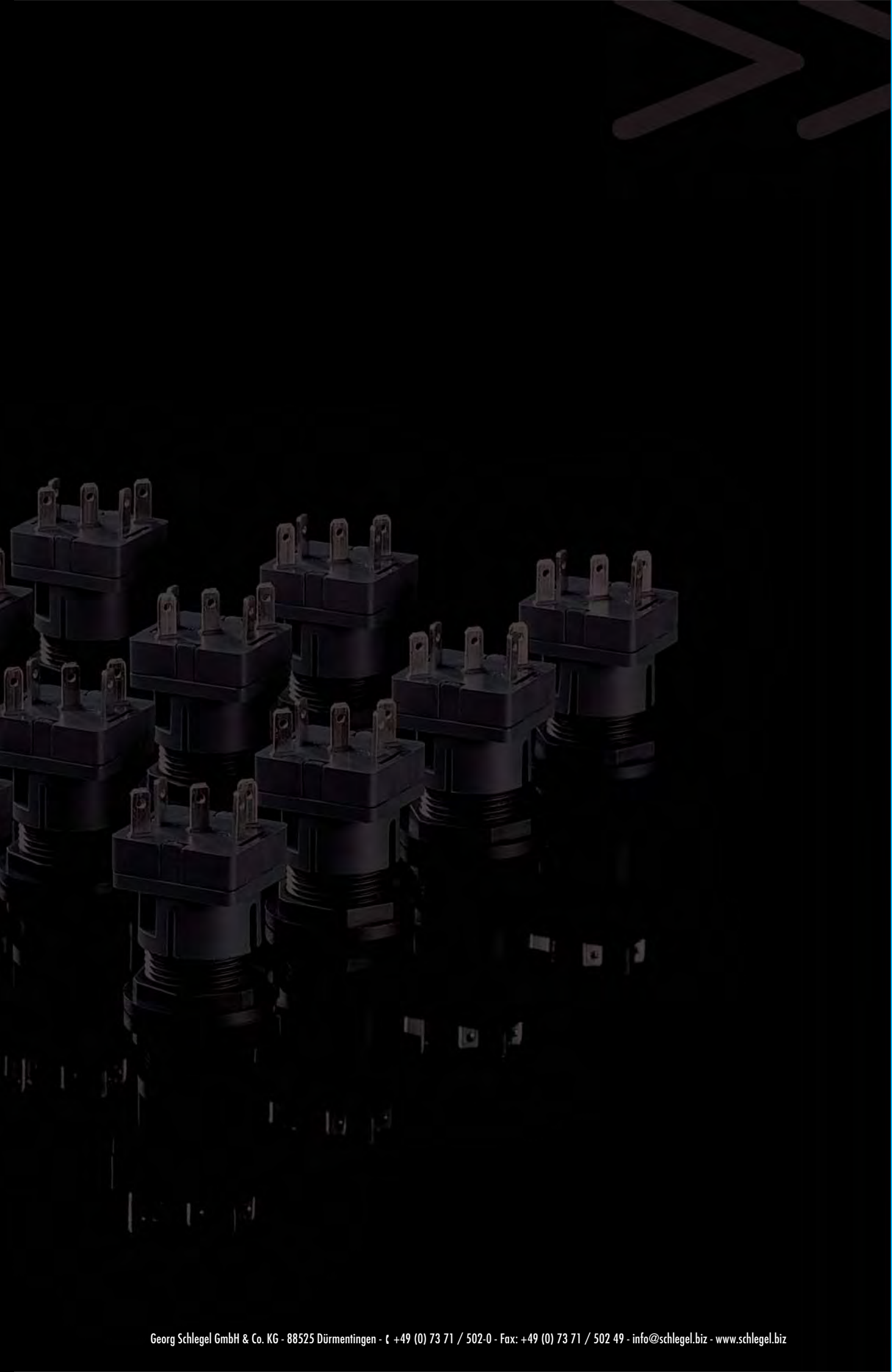

[About Us](#)

[Control Units](#)

[→ Contact Blocks](#)

[Panel Mount Jacks](#)

[Bus Technology](#)

[Enclosures](#)

[Terminal Blocks](#)

[Pedal Switches](#)

[Limit Switches](#)

[Type Index](#)