

Control Units for AS-Interface

AS-Interface is the one industrial standard for a cost-effective connection of binary sensors and actuators to a control system. This applies also to the construction of individually designed switchboards and operator control panels as well as to the assembly of decentralized control and signalling units.

Die AS-Interface slaves have two inputs and one output with dimming function to accept a pluggable LED with T5,5K socket. Easy screwless connection by insulation piercing (IDC technology).

Instead of up to 10 cables which were previously connected to one control unit, it requires now only 2 IDC-cables which are looped through from the control to all the assigned slaves. Up to 62 control units can be connected to one two-conductor cable. This system saves work, cuts installation times, reduces the number of potential failures and can be changed or extended in the twinkling of an eye.

Due to the flexible AS-Interface network structure, the Schlegel slaves can be connected arbitrarily. Each control and signalling unit at the AS-Interface line means a node with individual A/B address.

Technical Data:

- | | |
|-------------------------------|--|
| • AS-Interface profile: | S-B.A.E |
| • AS-Interface specification: | V2.11 |
| • Power supply: | full supply through the AS-Interface line (26.5..31.6 V) |
| • Total power consumption: | ≤ 30 mA |
| • Operating temperature | -25°C .. +70°C |
| • Signalling unit: | supply through the AS-Interface line |
| - rated voltage: | 24 V DC (+10%) |
| - max. output current: | 20mA |
| - socket | T5,5K |
| - LED | T5,5K LED 24V/14mA, Schlegel ref.: L5,5K24U... |
| • AS-Interface Certificate: | 50401 |



Control Units for AS-Interface

Characteristics:

- Certified AS-Interface slave with two inputs and one output (dimnable in four steps) to accept a pluggable LED with T5,5K socket
 - Output with short-circuit and overload protection
 - Easy screwless connection via 2-pole ID-connector (3.96mm) with detent and strain relief
 - AS-Interface profile S-B.A.E (expanded address mode)
 - Suitable for 3-position selector and key switches
 - Same size as on the standard contact blocks of the QUARTRON series
 - Fail-safe operation of the Schlegel AS-Interface slaves even under extreme environmental conditions (EMC), e.g. welding facilities, frequency converters
 - Up to 62 slaves can be connected to one single line
 - Open and manufacturer-independent bus system for the lower field level of industrial automation
 - Optional topology of the AS-Interface network, easy project development
- **Type: ASI_BZLI15, ASI_BZII15**

Norms and Standards

- EN50295
- Specification AS-Interface, Version 2.11 Revision 1
- UL, CSA

I/O Data Bits:

Output			Inputs		
Data Bit	Info (Interface 3)	Status	Data Bit	Info (Interface 3)	Status
D0	0	LED off	D2	0	switch 1 inactive
	1	LED on		1	switch 1 activated
			D3	0	switch 2 inactive
				1	switch 2 activated

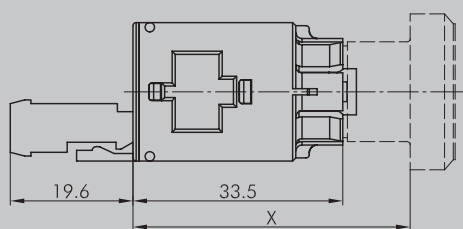

Mounting Depths:

	Dimension X in mm	mounting hole in mm
Oktron:	44.50	Ø16
Oktron-R:	44.50	Ø16
Oktron-Juwel:	50.00	23x23
RX-Juwel:	57.00	Ø22