

**GRAND TRUNK RY. STATION YARD**  
**CORINTH C. CO.**  
 SCALE 200 FT. = 1 INCH

GRAND TRUNK RY. PROPERTY  
 WITHIN LINES BORDERED GREEN

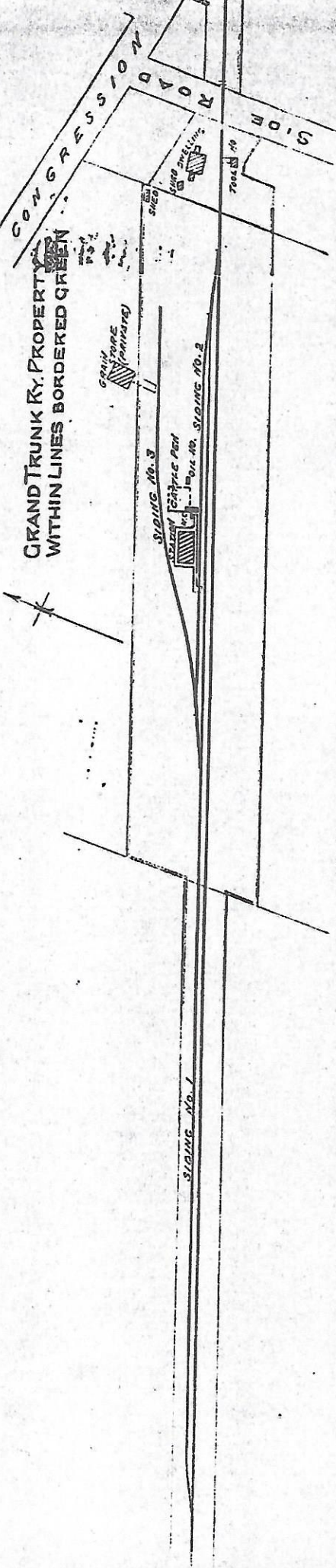

**BUILDINGS**

STATION DWELLING	WOOD	60' x 30'
W.C.	"	41' x 30' wind lean to
SHED	"	12' x 7'
"	"	13' x 10'
TOOL NO.	"	23' x 14'
OIL NO.	"	14' x 10'
CATTLE PEN	"	11' x 9'
		49' x 47'

**SIDINGS**

SIDING No. 1	LEYS IN	24.13 FT.
"	"	855 "
"	"	7.87 "
TOTAL LENGTH		4055 FT.