

GRAND TRUNK RY. STATION YARD
W. AYLMER
 SCALE 200 FT = 1 INCH

GRAND TRUNK RY PROPERTY
WITHIN LINES BORDERED GREEN

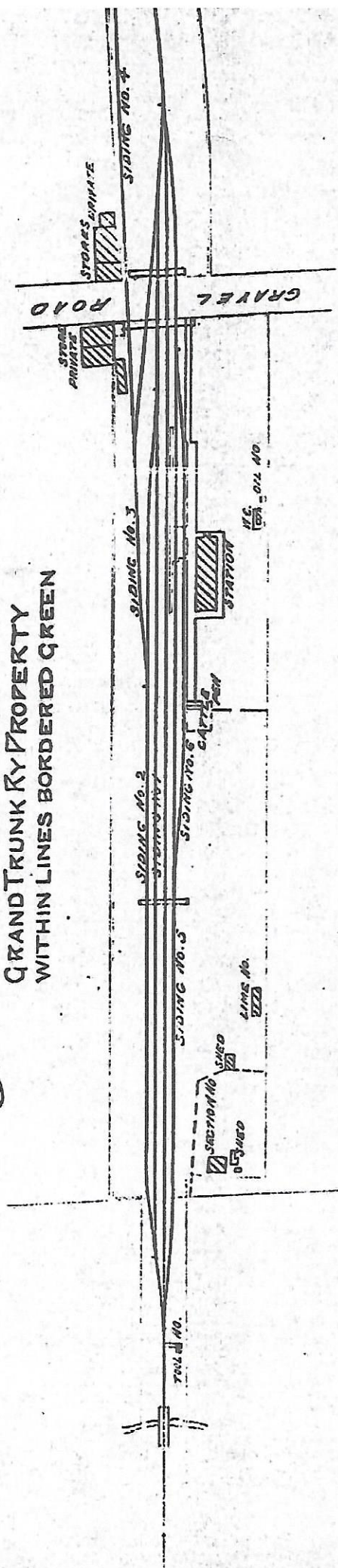
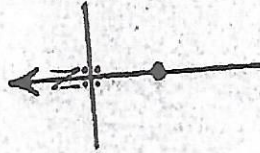

BUILDINGS

SECTION NO	WOOD	SIZE
1	WOOD	13' x 33'
2	"	25' x 24'
3	"	22' x 6' and 12' x 4'
4	"	10' x 8'
5	"	22' x 15'
6	"	10' x 6'
7	"	19' x 5' and 11' x 5'
8	"	14' x 10'
9	"	41' x 39'

SIDINGS

SIDING NO	LENGTH	FEET
1	"	1865
2	"	1319
3	"	786
4	"	759
5	"	1865
6	"	810
TOTAL LENGTH		7404 FT.