

GRAND TRUNK RY.  
 NEW SARUM STATION YARD  
 SCALE 200 FT = 1 INCH

GRAND TRUNK RY PROPERTY  
 WITHIN LINES BORDERED GREEN

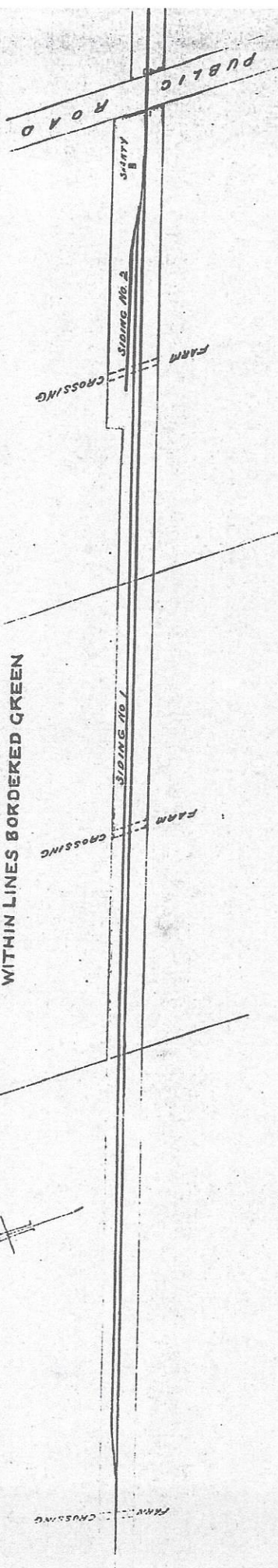

BUILDING  
 SHED 11000 7' x 7'

SIDINGS

SIDING NO. 1	LENGTH	2516 FT.
"	"	350 "
"	TOTAL LENGTH	2866 FT.

GRAND TRUNK RY.  
 M.C.R.R. CROSSING NEW SARUM  
 SCALE 200 FT = 1 INCH

GRAND TRUNK RY. PROPERTY  
 WITHIN LINES BORDERED GREEN

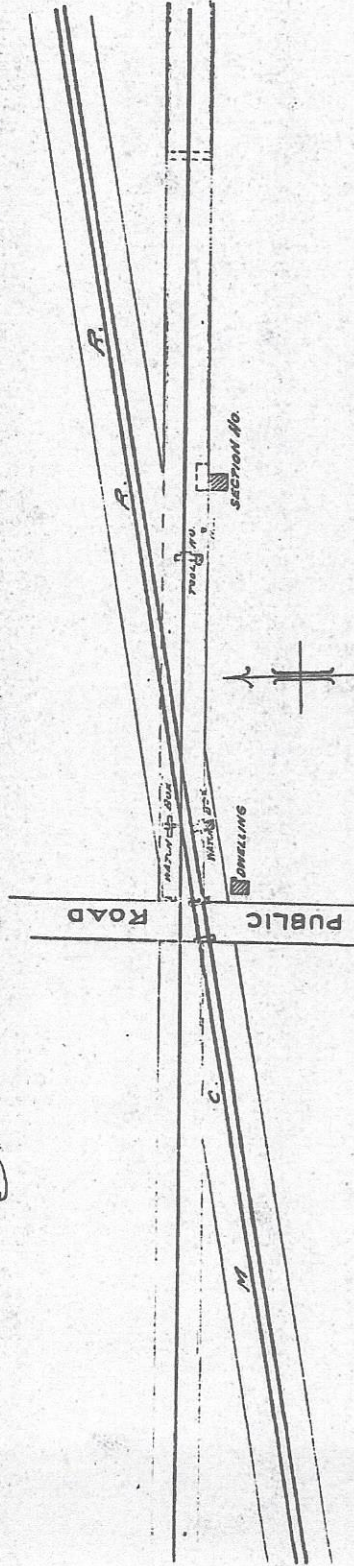

**BUILDINGS**  
 SECTION No. WOOD 29' x 24'  
 TOOL No. " 14' x 10'  
 MATCH BOX " 10' x 8'