

GRAND TRUNK RY. STATION YARD
FORT ERIE Bag. Div.
 SCALE 200 FT. = 1 INCH

GRAND TRUNK RY. PROPERTY
 WITHIN LINES BORDERED GREEN

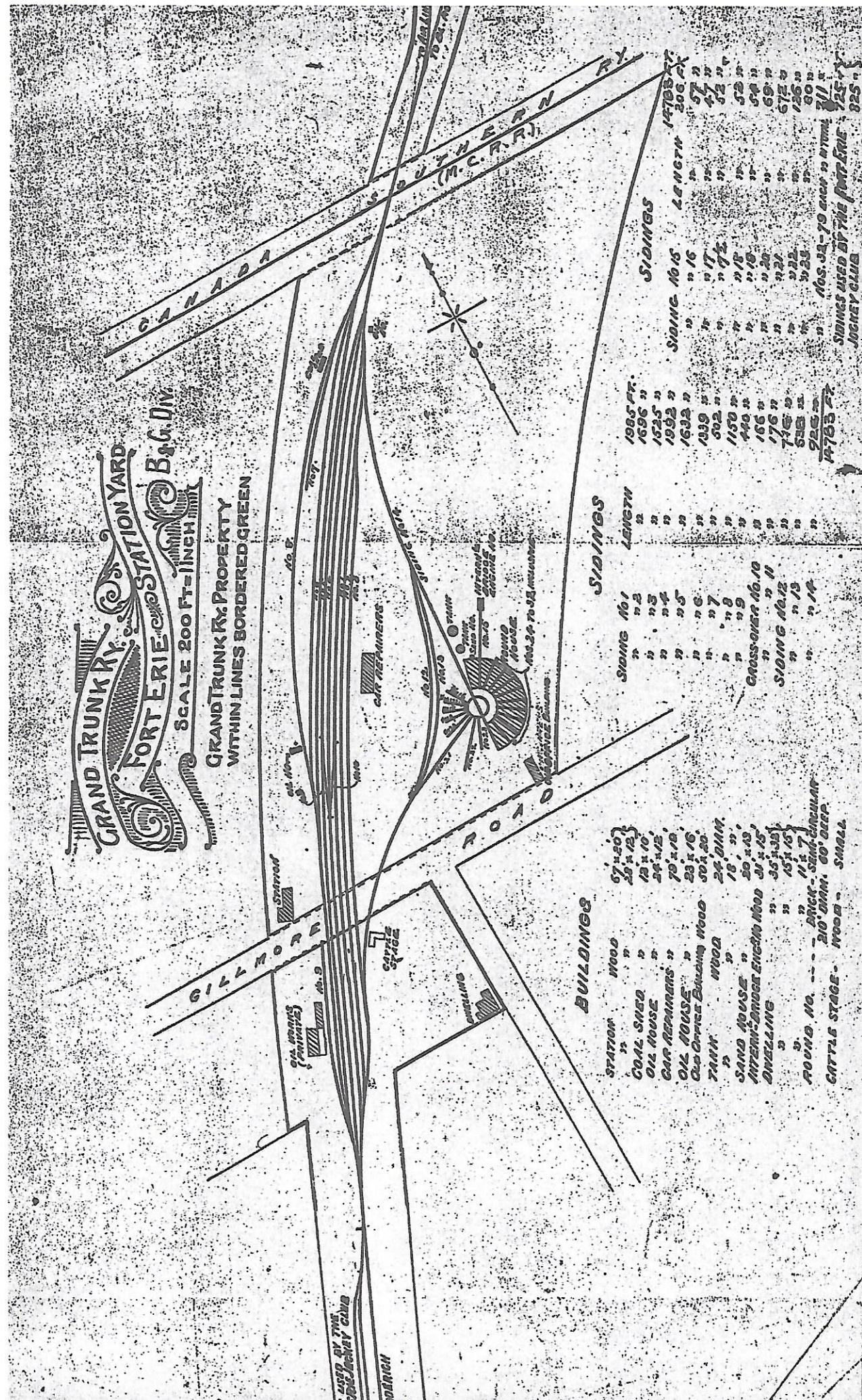

BUILDINGS

STATION	WOOD	67 x 50
COAL SHED	"	28 x 12
OIL HOUSE	"	12 x 10
CAR REPAIRERS	"	24 x 12
OIL HOUSE	"	79 x 18
Old Office Building	WOOD	23 x 16
TANK	WOOD	30 x 50
"	"	25 DIAM.
"	"	18 " "
SAND HOUSE	"	50 x 43
INTERCHANGE ENGINE HOOD	"	31 x 15
DWELLING	"	35 x 33
"	"	15 x 16
ROUND HO.	"	11 x 7
CATTLE STAGE - ROOM - SMALL	BRICK - SEMI-CIRCULAR	210 DIAM. 60' DEEP

SIDINGS

SIDING No. 1	LENGTH
" 2	"
" 3	"
" 4	"
" 5	"
" 6	"
" 7	"
" 8	"
" 9	"
GROSS-OVER No. 10	"
SIDING No. 11	"
" 12	"
" 13	"
" 14	"

1985 FT.	SIDINGS	LENGTH
1696 "	" 15	"
1525 "	" 16	"
1992 "	" 17	"
1632 "	" 18	"
1339 "	" 19	"
502 "	" 20	"
1150 "	" 21	"
440 "	" 22	"
176 "	" 23	"
745 "	" 24	"
585 "	" 25	"
925 "	" 26	"
1978 FT.	" 27	"

165.55 - 79 each 22 items 711
 SIDINGS USED BY THE PORT ERIE JOCKEY CLUB 325