

GRAND TRUNK RY. STATION YARD
LEWISVILLE
 SCALE 200 FT-1 INCH

GRAND TRUNK RY. PROPERTY
 WITHIN LINES BORDERED GREEN

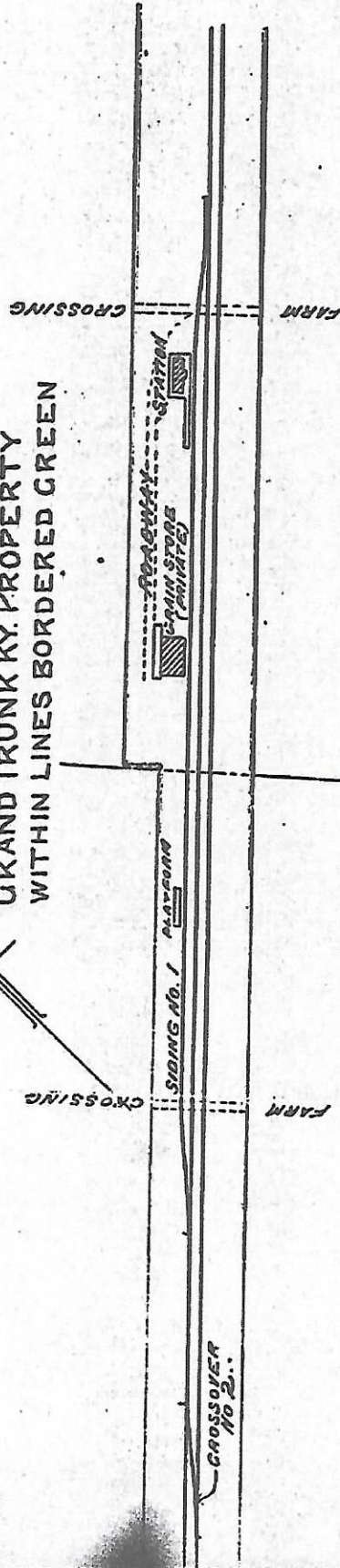

BUILDING

STATION 11000 40' x 12'

SIDINGS

SIDING No. 1 LENGTH 1242 FT
 CROSS-OVER No. 2 " 161 "
 TOTAL LENGTH - 1403 FT