

# FOR LEASE

RETAIL SPACE

# Midlothian Station

13541-13591 Midlothian Turnpike | Midlothian, VA 23113



COMMONWEALTH  
COMMERCIAL  
Comprehensive Property Solutions



## PROPERTY HIGHLIGHTS

- › 1,020± SF of retail space available in 30 days, minimum 3 year term
- › Anchored by Youfit Health Club, Pleasants Hardware and Coalfield Station Antiques
- › Next to Midlothian Middle School
- › Strong demographics
- › Area retailers include Publix, Walmart, Sam's Club, Food Lion, Kroger and more
- › Traffic Count: 41,000 VPD

DEMOGRAPHICS	1 MILE	3 MILE	5 MILE
TOTAL POPULATION	7,835	45,751	105,136
AVERAGE HH INCOME	\$97,258	\$132,161	\$127,187
DAYTIME EMPLOYEES	4,101	24,391	46,151

## FOR MORE INFORMATION:

### TODD BUTTNER

Senior Associate

410-382-7109

tbuttner@commonwealthcommercial.com

### LIZ GRAY

Senior Associate

804-433-1814

lgray@commonwealthcommercial.com

### HARTLEY JORDAN

Sales & Leasing Associate

804-964-2391

hjordan@commonwealthcommercial.com

Commonwealth Commercial Partners, LLC represents the Landlord of this property. Information contained herein is deemed reliable but is not guaranteed.

# SITE PLAN

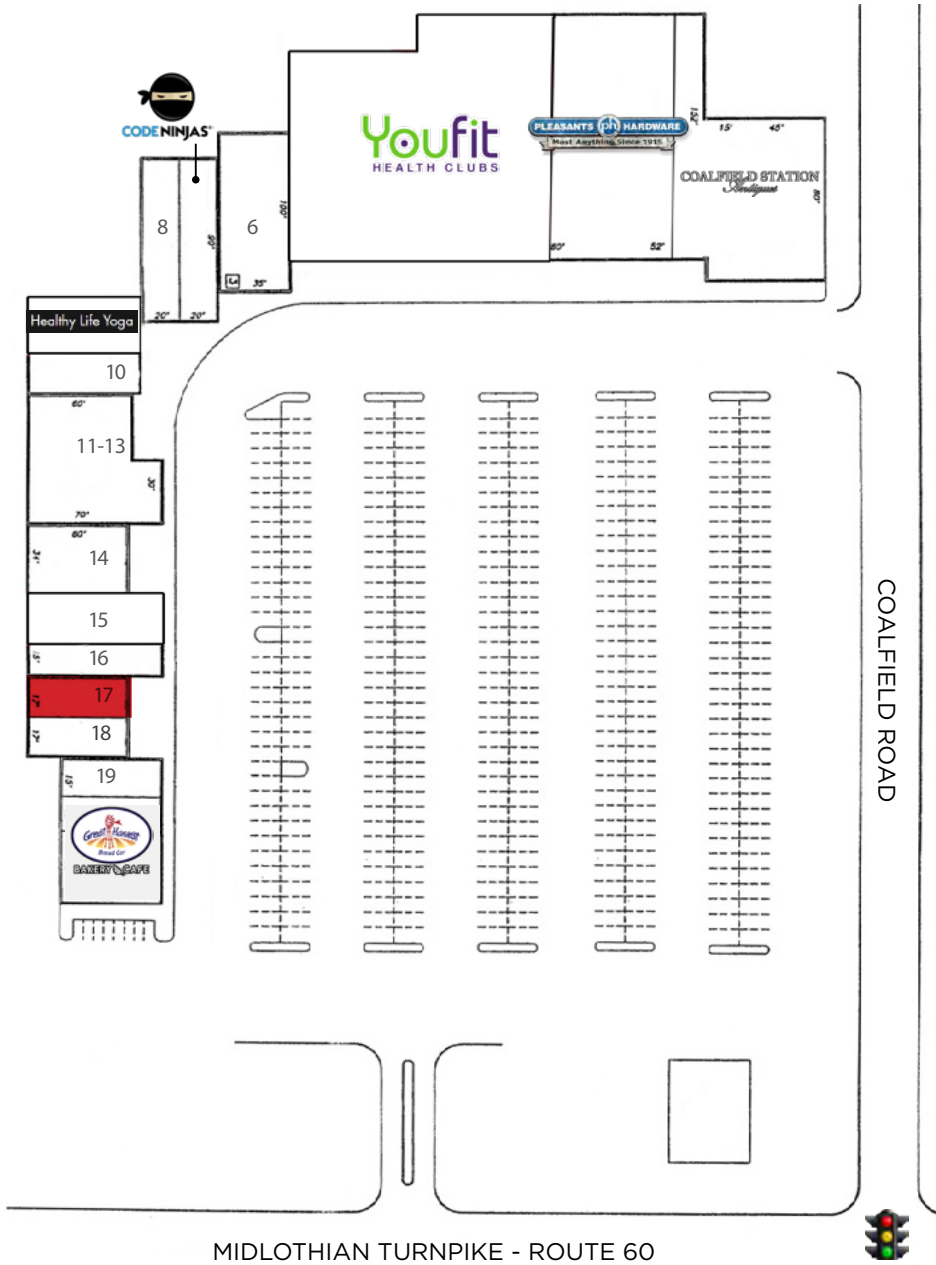

UNIT	TENANT	SF
1-2	Coalfield Station Antiques	15,000
3	Pleasants Hardware	10,000
4-5	Youfit Health Club	21,368
6	Leased	3,500
7	Code Ninjas	1,800
8	Thrifty Quaker	1,800
9	Healthy Life Yoga	1,495
10	Sandra Mykich Hair	1,062
11-13	El Cerro Azul	4,420
14	Fuji Sushi	2,040
15	Live Well Consulting	1,330
16	Glitz A Salon	1,050
17	<b>Available</b>	1,020
18	Embellish Salon	1,020
19	Natural Nails	900
20-21	Great Harvest Bread Co.	2,700



FOR LEASE | MIDLOTHIAN STATION