



## Transmission shifter Isolator bushing installation and removal tool instructions

### Bushing kit part number **MS99-63399**

#### Removal tool **PT99-63399** **Sold Separately!**

(Removal tool is used to remove O.E. bushing and polyurethane bushings from shifter housing.)

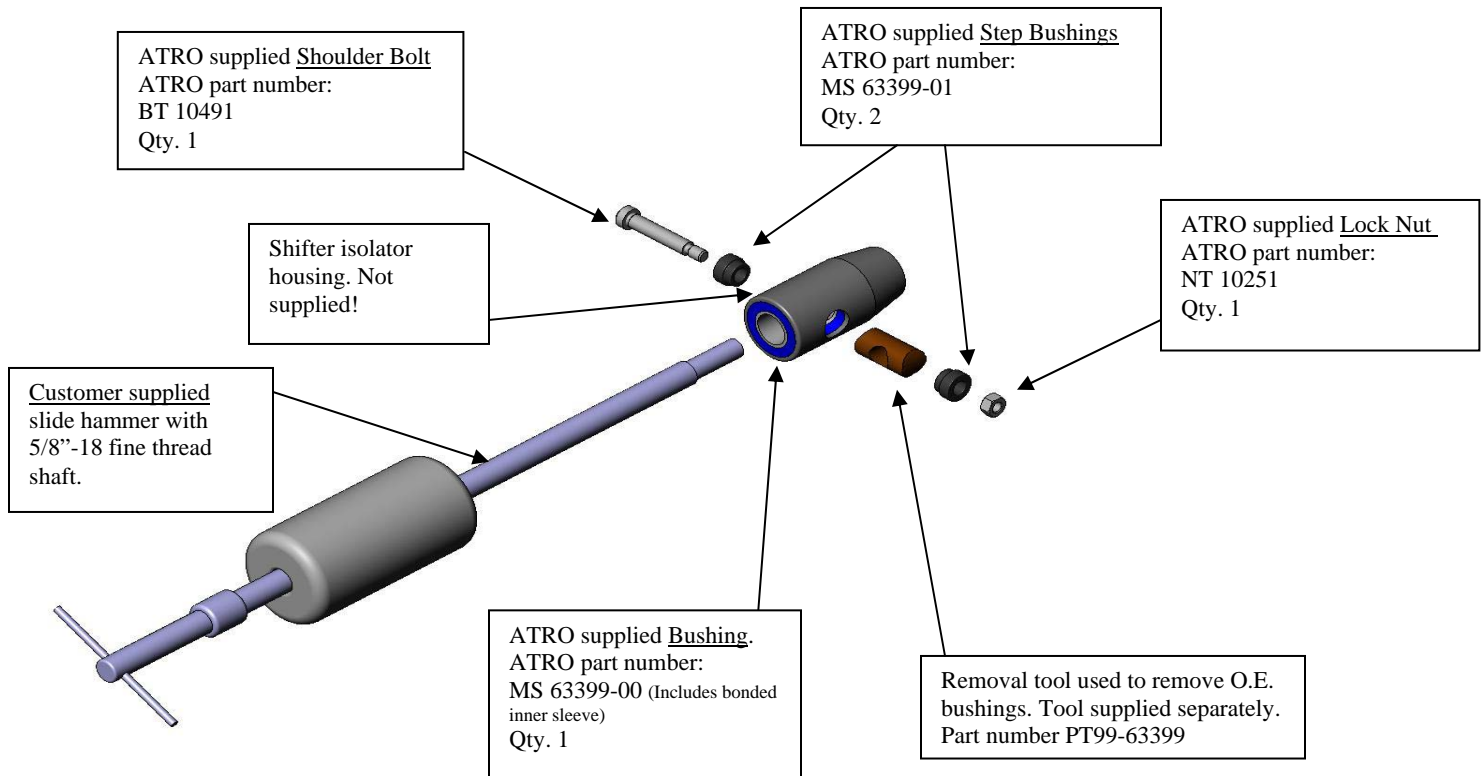

### **ATRO Bushing removal/installation instructions**

1. Remove housing and/or shifter from vehicle.
2. Remove original bushing from housing using your standard removal technique or ATRO removal tool sold separately.
3. After removal of bushing inspect inside diameter. Clean if necessary.
4. Align ATRO bushing cross hole with cross hole in housing (Note: Pre-alignment marks on bushing). Press bushing into hole until aligned. If needed a slight amount of glass cleaner or soapy water can be applied to bushing O.D. and inside of housing to help installation and alignment.
5. Using supplied fasteners and illustration above make sure bushing thru hole alignment is correct prior to installing into vehicle.
6. Install components onto vehicle and fasten securely.

### **ATRO Removal tool instructions**

1. Remove housing and/or shifter from vehicle.
2. Securely hold housing without distorting.
3. Install removal tool into cross hole.
4. Align threaded hole with "Customer Supplied" slide hammer or equivalent device that has a 5/8"-18 threaded shaft.
5. Make sure that the removal tool has equal depth side to side to allow for clearance. The overall length of removal tool is slightly shorter than the inside diameter of housing.
6. Use slide hammer in normal manner or device to remove used bushing. Note: For stubborn bushings, a slight amount of heat can be applied to the housing to aid removal.
7. Inspect inside diameter of housing and clean if necessary.
8. Re-install ATRO bushing as described above.