

1 TYPICAL RACK ELEVATIONS
SCALE: NTS

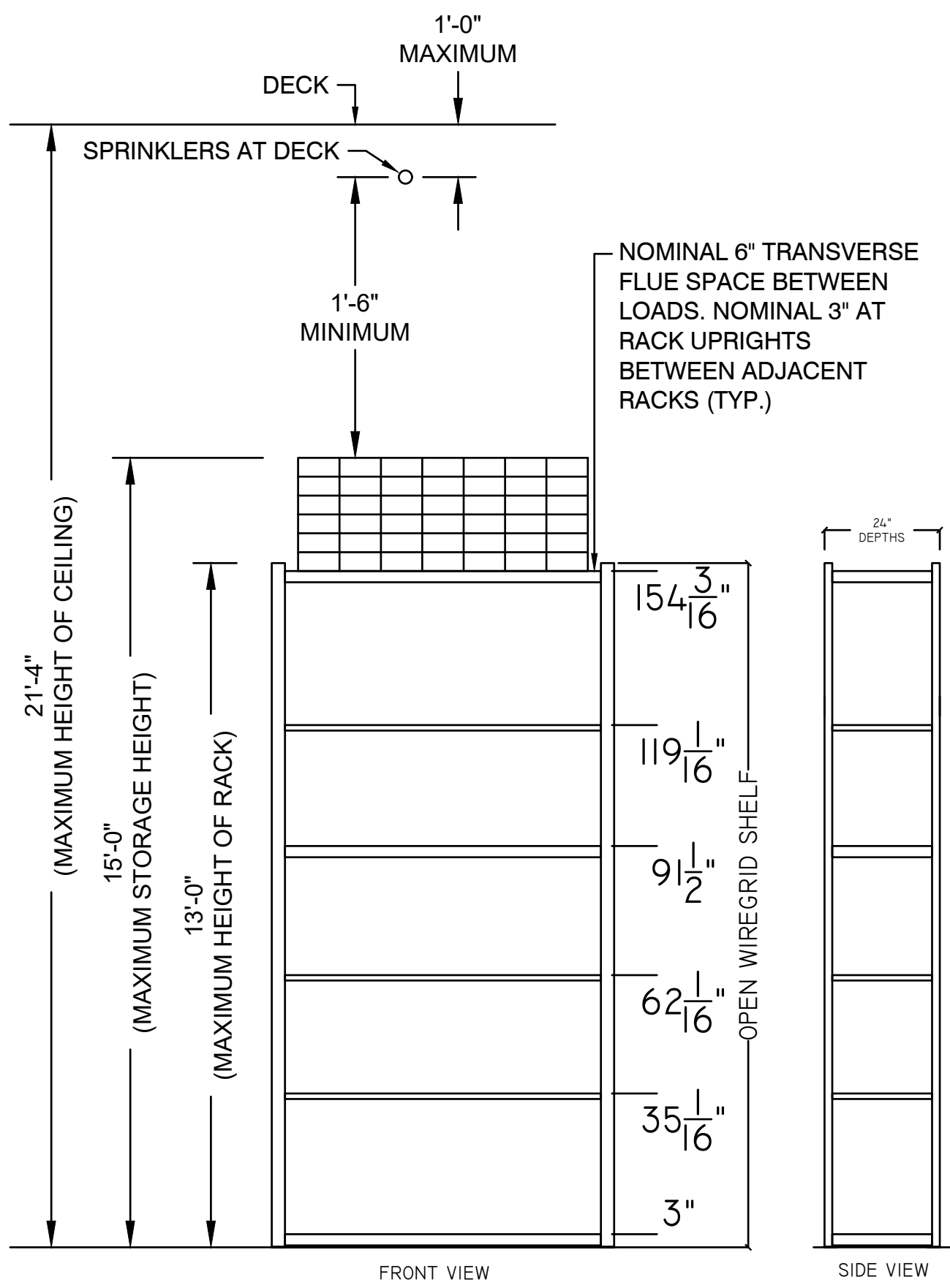

2 TYPICAL RACK ELEVATIONS
SCALE: NTS

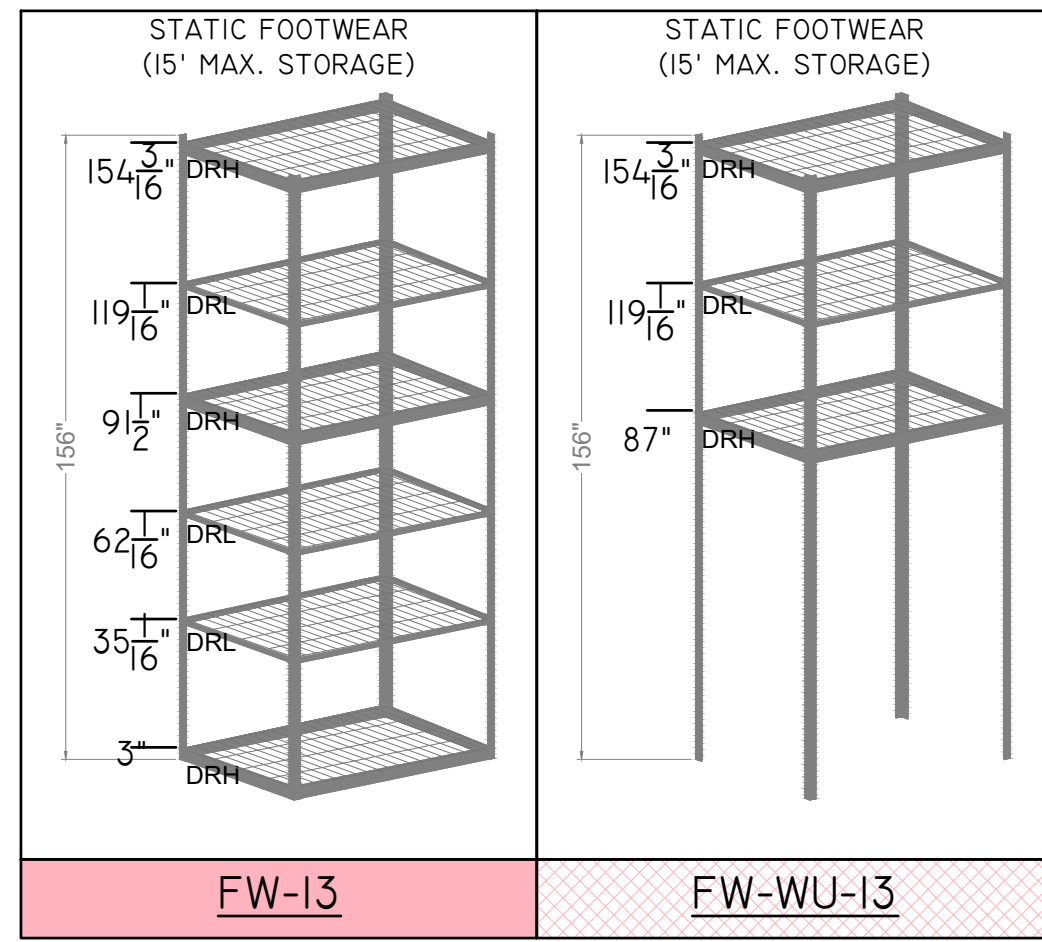

4 TYPICAL RACK DETAILS
SCALE: NTS

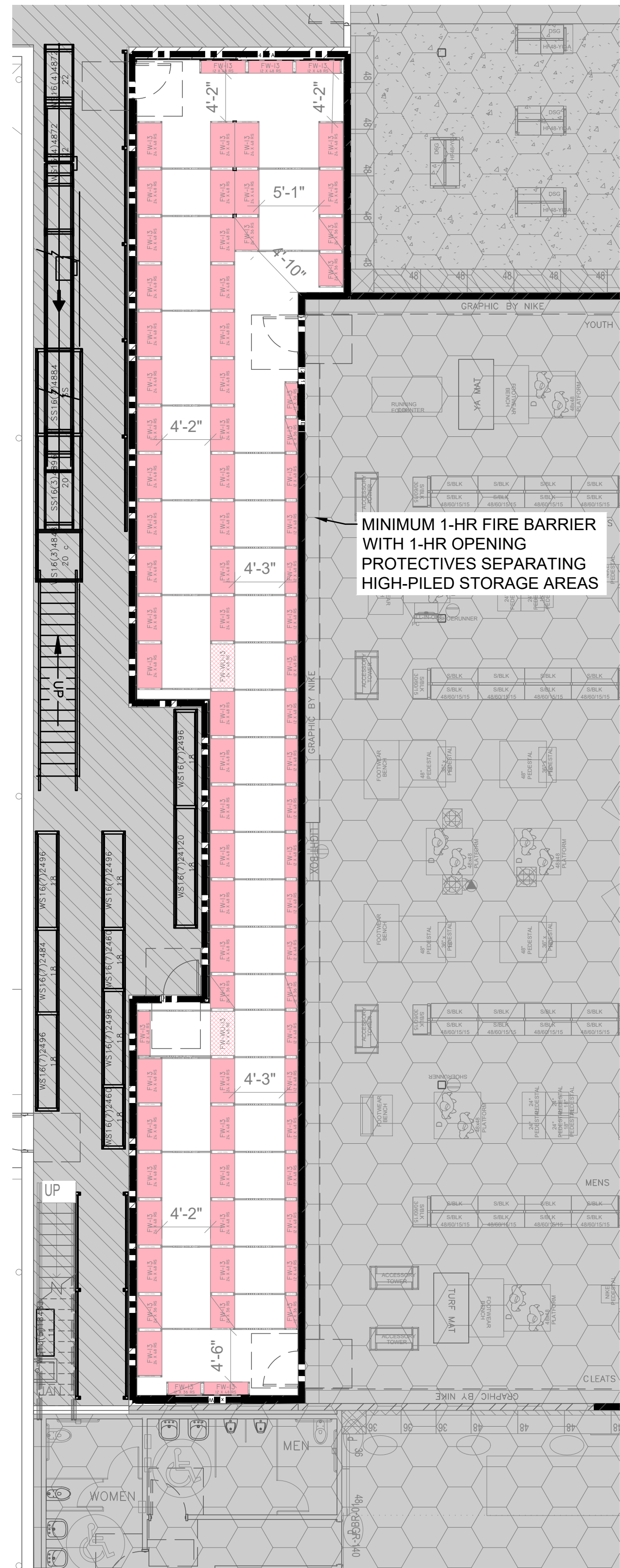

3 HIGH-PILED STORAGE PLAN - HPS AREA #1
SCALE: 1/8" = 1'-0"

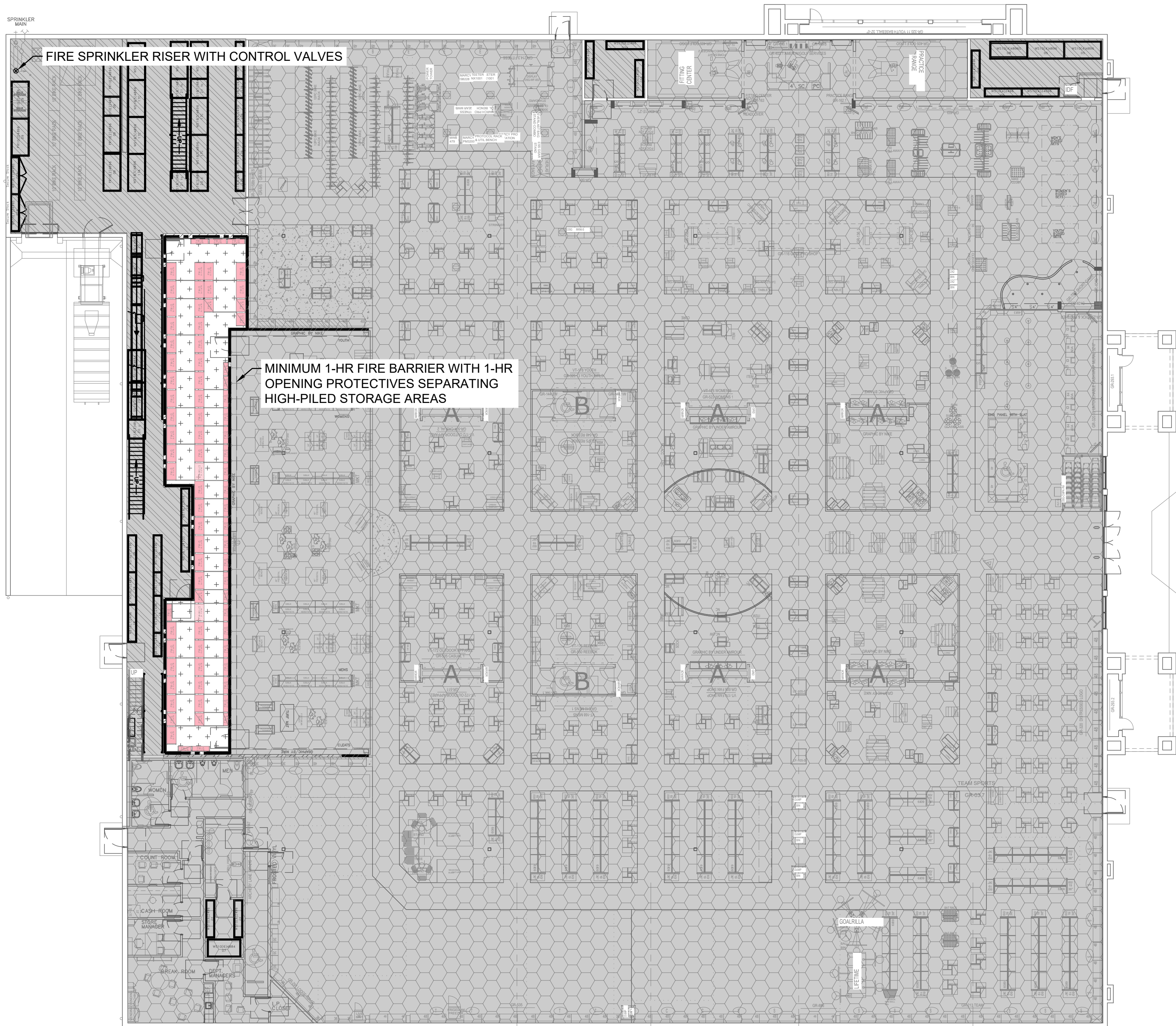

5 OVERALL HIGH-PILED STORAGE PLAN
SCALE: 1/16" = 1'-0"

HATCHING LEGEND	
HATCH	DESCRIPTION
	HPS AREA 1 - FOOTWEAR STOCK: HIGH-PILED STOCK AREA (HIGH-HAZARD COMMODITIES CARTONED UNEXPANDED GROUP A PLASTICS UP TO 15 FT. IN HEIGHT).
	STORAGE AREAS OUT OF SCOPE. AREAS ARE EXISTING AND SEPARATED.
	EXISTING STORE AREAS OUT OF SCOPE.

