

Before assembly, please remove all parts from the carton, verifying that you have the correct quantities, and read all the instructions.

**\*\*Please Note: When attaching the metal legs to the laminate tops, not all of the provided holes on these metal legs will line up with the metal inserts on the laminate tops. The provided wood screws may also need to be used\*\***

PLTLEG - U - 24NB / 30NB

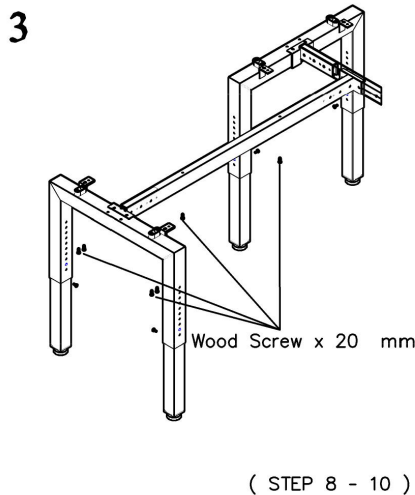
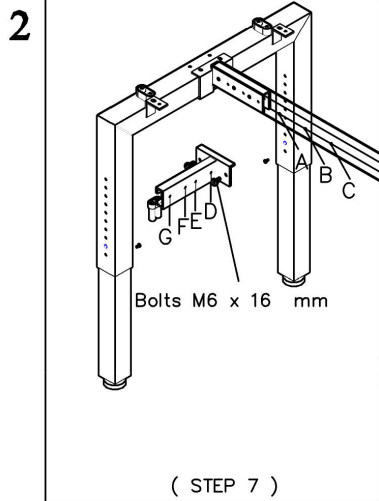
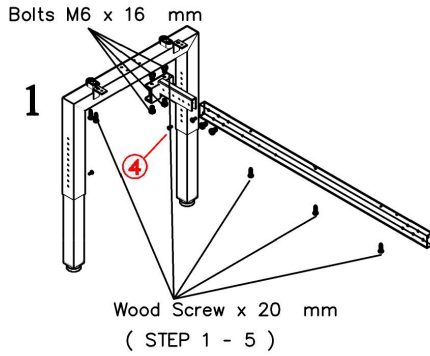

PART LIST  
Main Desk Beam

<b>1</b>		Wood Screw x 20 mm	11pcs
<b>2</b>		Sticker	4pcs
<b>3</b>		Bolts M6 X 12MM	4pcs
<b>4</b>		Security Screw	4pcs

PART LIST  
Return Beam

<b>1</b>		Wood Screw x 20 mm	6pcs
----------	--	--------------------	------

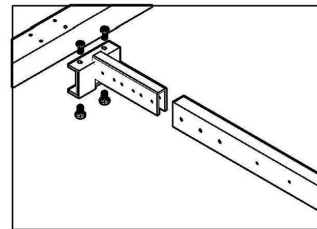
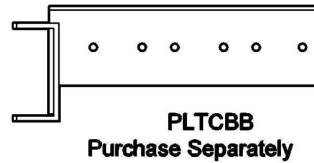

- Performance Work Surfaces Are Used In Many Applications. Preinstalled Existing Metal Inserts In The Top Are Not Required For The Element Series, 20 mm Wood Screw Are Provided .

**DESK**

1. Place work surface up side down on a clean surface.
2. Place both legs up side down on work surface with tabs PLTCBB facing each other .
3. Slide cross beam over both tabs on leg.
4. Attach cross beam to legs using M6 x 12mm ( Part 3 ) .
5. Attach center legs on the surface by using wood screw ( Part 1 ) .  
**Note : The wood screw pack is inside the beam.**
6. Flip table over to correct position .

**RETURN ( IF USED )**

7. Attach tab to desk cross beam using M6 x 12 mm bolts ( Part 3).  
\* Use holes AB for 24" deep return.  
\* Use holes BC for 30" deep return.
8. Attach cross beam to return leg using M6 x 12 mm ( Part 3 ) bolts.
9. Slide cross beam over tab that is attach to desk cross beam. attach using M6 x 12 mm bolts ( Part 3 )
10. Mount top on to return assembly using wood screw ( Part 1 ) .  
**Note : The wood screw pack is inside the return beam.**

Before assembly, please remove all parts from the carton, verifying that you have the correct quantities, and read all the instructions.

#### 4. Possible Performance Element Series Configurations

##### When USING 24" Deep Main Top

1. Always use holes DE when main desk is 24" Deep.

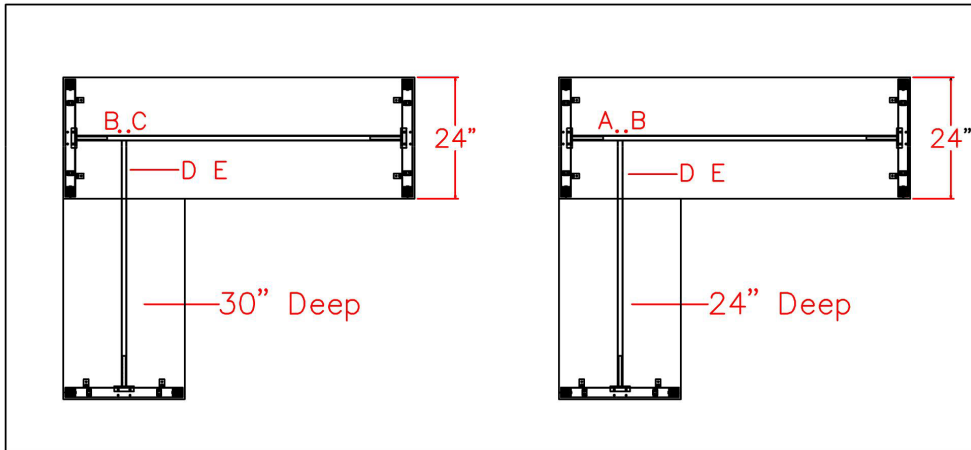

##### When USING 30" Deep Main Top

1. Always use holes FG when main desk is 30" Deep.

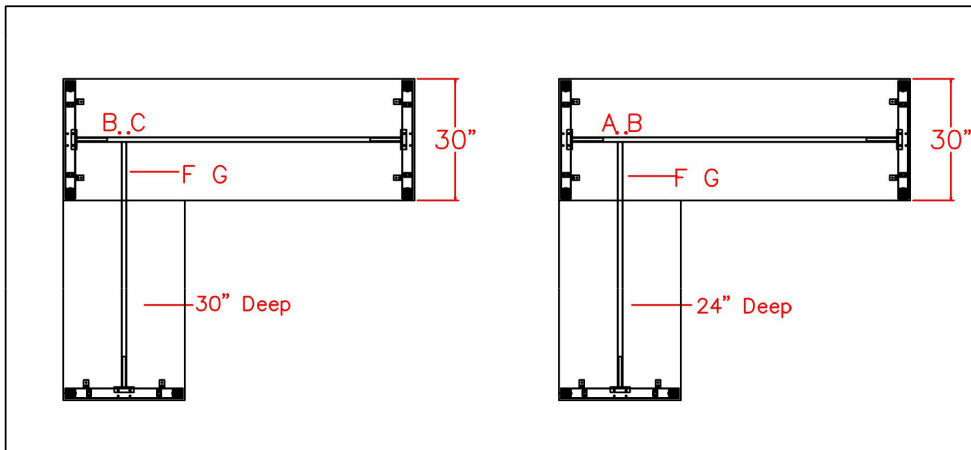

- # Always use holes AB when return is 24" Deep
- # Always use holes BC when return is 30" Deep

Before assembly, please remove all parts from the carton, verifying that you have the correct quantities, and read all the instructions.

FOR GLIDES

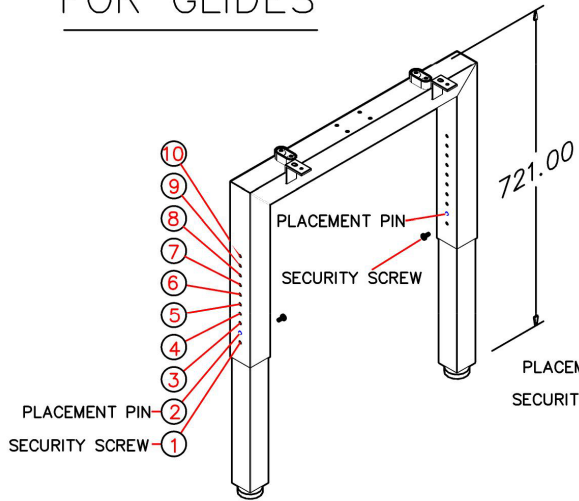

SECURITY SCREW AT HOLE NO. 1  
PLACEMENT PIN AT HOLE NO. 2

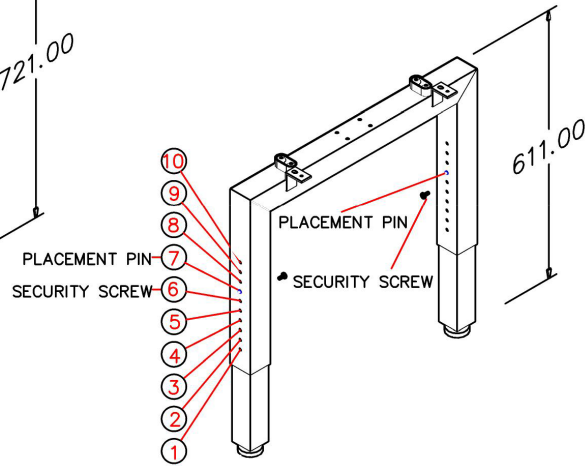

SECURITY SCREW AT HOLE NO. 6  
PLACEMENT PIN AT HOLE NO. 7

FOR CASTERS

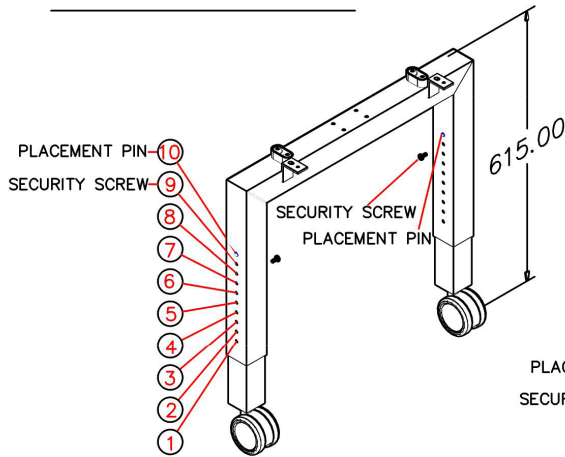

SECURITY SCREW AT HOLE NO. 9  
PLACEMENT PIN AT HOLE NO. 10

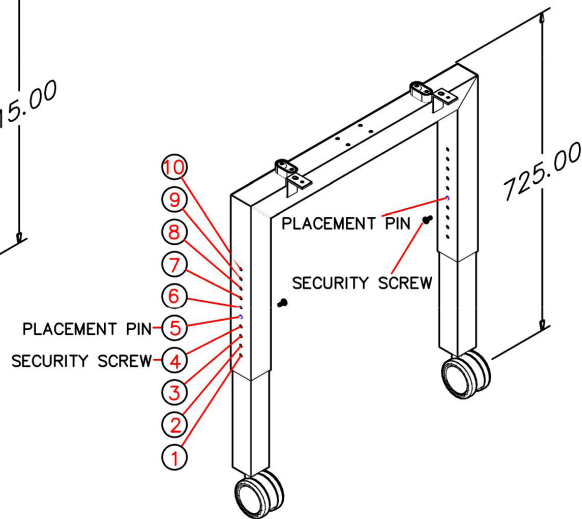

SECURITY SCREW AT HOLE NO. 4  
PLACEMENT PIN AT HOLE NO. 5

**⚠ ATTENTION ⚠**

Ensure all bolts and screws are tightened, check bolts and screws every 6 months.  
If any parts are missing, broken, damaged or worn, stop use of product until repairs have been made using factory authorized parts.  
Failure to follow these warnings may result in injury.