

## Heritage Collection Guest Chair

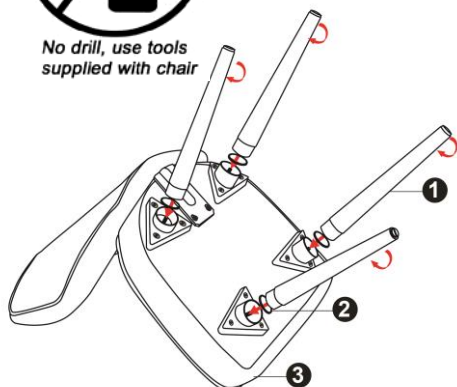

No drill, use tools  
supplied with chair



### PARTS LIST

Part #	Description	Quantity
1.	Wood Legs	4
2.	Plastic Washers	4
3.	Assembled Chair	1
4.	Allen Key	1



### ASSEMBLY INSTRUCTIONS

- Remove all parts from carton and separate them into part number groups as indicated in the parts list.
- Insert Wood Legs (1) with Plastic Washers (2) to the bottom of the Seat Cushion (3) and turn the legs clockwise as shown. Tighten four legs completely. Place chair upright on level floor. Make any necessary adjustments to plastic nails under the legs to ensure chair sits flat on floor without rocking.
- Periodically (every 90 days) make sure that the screws are still fully tightened.

**ATTENTION:** Make certain all screws are fully tightened before using chair.

Item Number: 49353

# OfficeSource®